

Rev.7

Design data

Vessel category	Normal pressure	
Description of parameter	Vessel	Jacket
Working pressure	psi	22
Design pressure	psi	22
Level testing pressure	psi	45
Medium	Beer	Glycol
Material	SUS 304	SUS 304
Working temperature	°F	15 to 100
Design temperature	°F	15 to 100
Gross volume	BBL	37.4
Net volume	BBL	30
Heat exchanger area	m2	6.8
Glycol Jacket Max Volume	Gallon	9.5
Insulation material	Chloride Free Polyurethane	
Insulation thickness	mm	80
Total Tank Weight Empty	lbs	1740
Total Tank Weight Full	lbs	9498

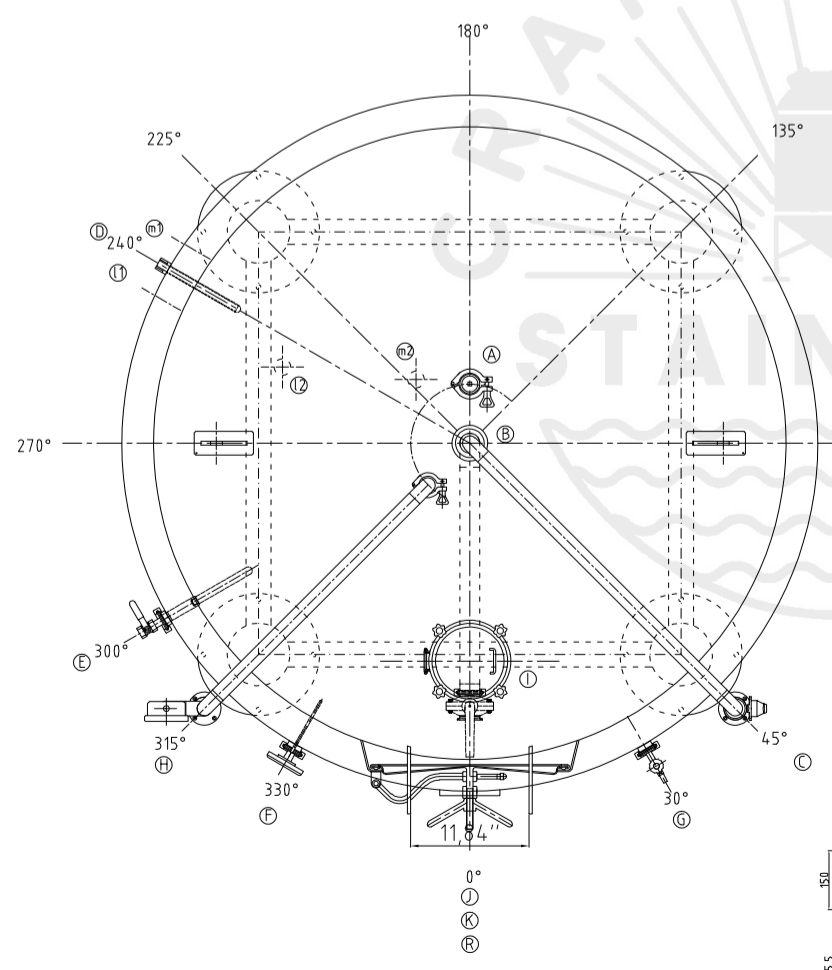
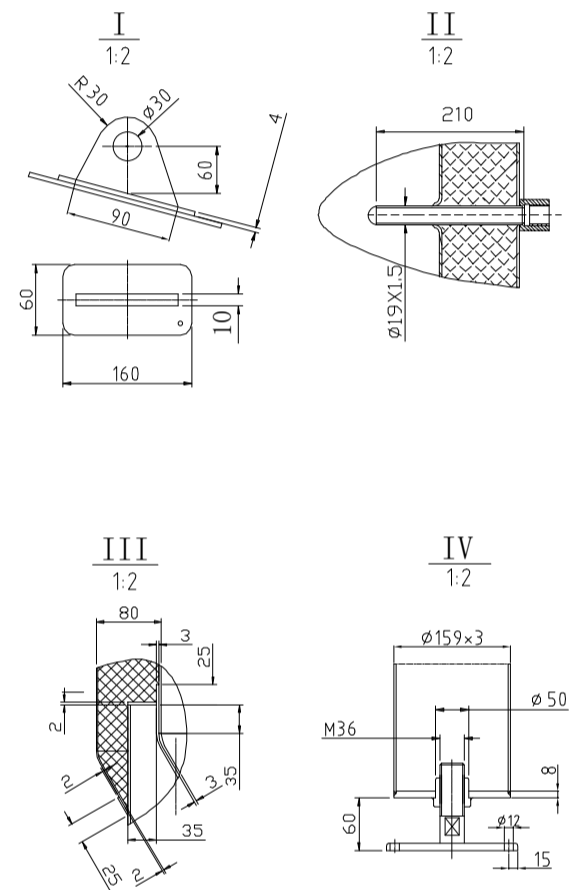
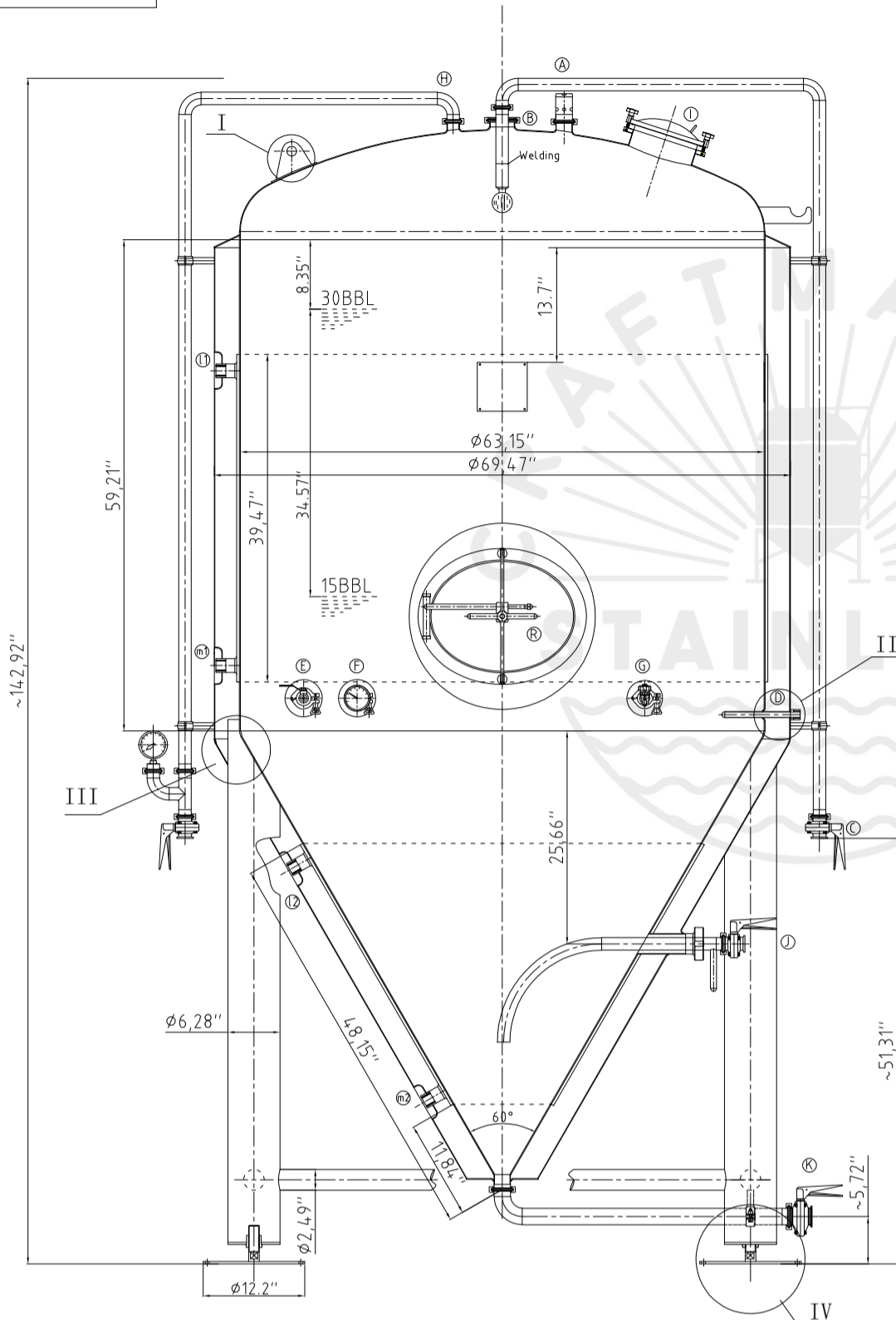

CONNECTIONS

MARK	DN	DESCRIPTION	CONNECT SIZE	REMARKS
A	2"	PVRV FERRULE	2"	ISO
B	3"	PORT	3"	ISO
C	15"	CIP APM FERRULE	15"	ISO
D	1/2"	TEMPERATURE CONN	1/2"	NPT
E	15"	CO2 INLET	15"	ISO
F	15"	TEM-GAGE	15"	ISO
G	15"	SAMPLE FERRULE	15"	ISO
H	15"	OVER FLOW	15"	ISO
I	8"	HOP PORT	8"	ISO
J	DIN63-15"	DRAIN FERRULE	DIN63-15"	ISO
K	2"	OUTLET	2"	ISO
R	21"x17"	MANWAY	21"x17"	ISO
l	3/4"	COOLING OUTLET	3/4"	NPT
m	3/4"	COOLING INLET	3/4"	NPT



04/28/2021  
30BBL FERMENTER