

Adjustable Folding Kicker Ramp



Disclaimers and Other Notes

First of all, thank you so much for your interest in my design.

As you know, I am American. We still use Imperial measurements (feet, inches, fractions) so all of my designs are originally built that way. It's not that I don't understand the value of the metric system. I totally do, but having grown up with the Imperial system that's all I know. But take heart, the kids today, MY kid included, are growing more and more familiar with the metric system and soon I'm sure we will convert over. Until then, please forgive me if the metric measurements are a bit wonky or, at the very least, inelegant.

I am also not an engineer or a professional draftsman. There might be things in these plans that are missing, unclear, or maybe even flat out wrong. I am assuming that you, the builder, are a competent person, of sound mind, and will use your own common sense and best judgement in building this ramp. I trust you to grade and double check my work before you ride this ramp. Remember, mountain biking is an inherently dangerous sport, you are solely responsible for your safety as well as anyone else who rides the ramp that you built. I offer up these plans as merely a starting point. Build and ride only what you think is safe.

These plans are also a work in progress. These plans are as I built my ramp in the Lunch Ride episode. They could be improved and I will (maybe) issue revisions and improvements in the future. If you have any suggestions on how it might be improved, let me know.

But also, please remember that this design is my own. Do not copy or distribute these plans. They are totally Patent Pending, okay?

Having said all that, have fun, enjoy creating something with your hands, be smart, be safe, and catch some air!



Cody

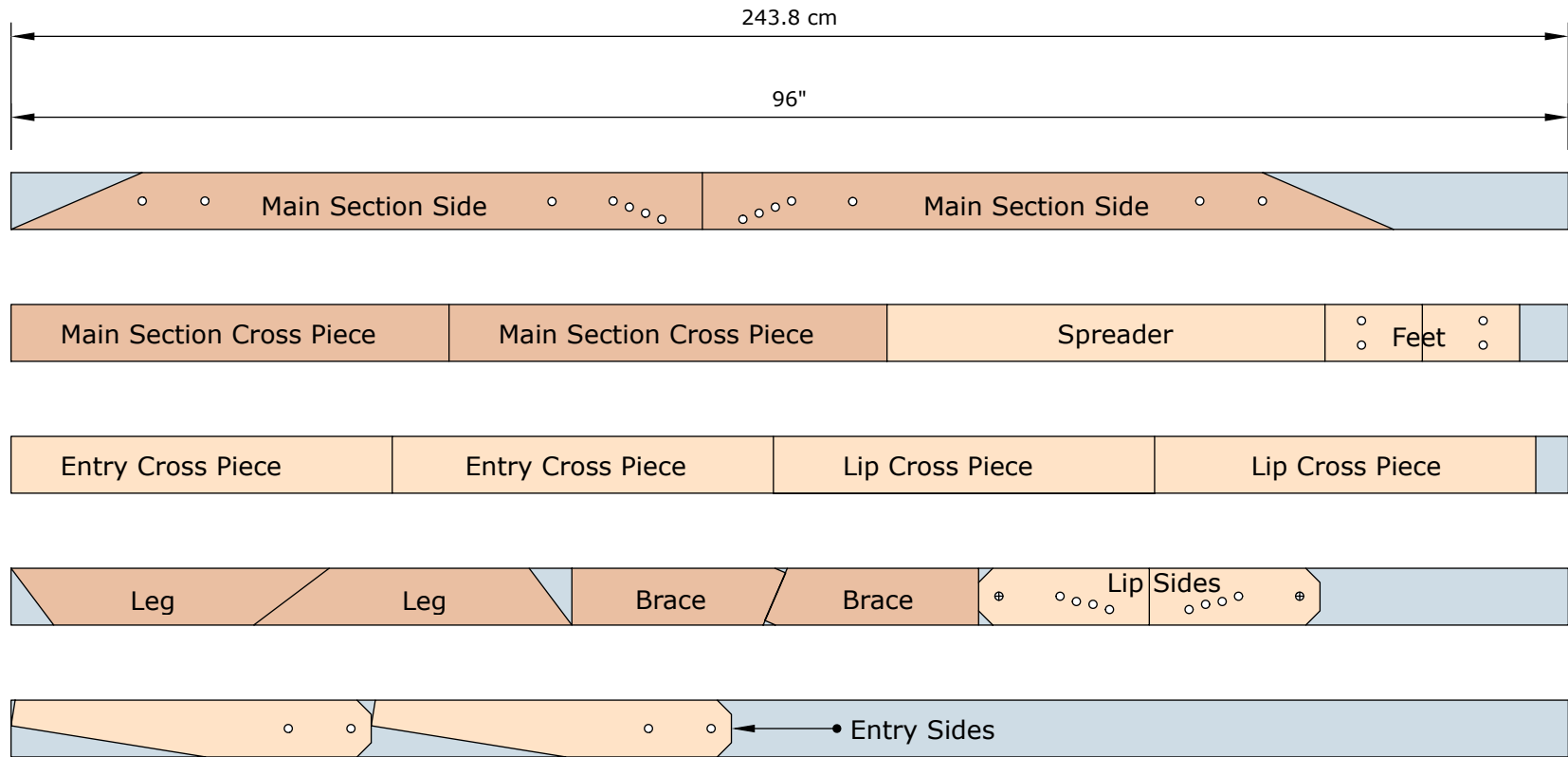

Materials List

- 5- 8' 2x4
- 1 Sheet 1/2" Plywood
- 4- Standard Door Hinges
- 2- Nail Hooks
- 2- 1/2" Hitch Pins
- 1' 1/2" Dowel Rod
- 1 Box 3" Deck Screws
- 1 Box 1 1/4" Drywall Screws

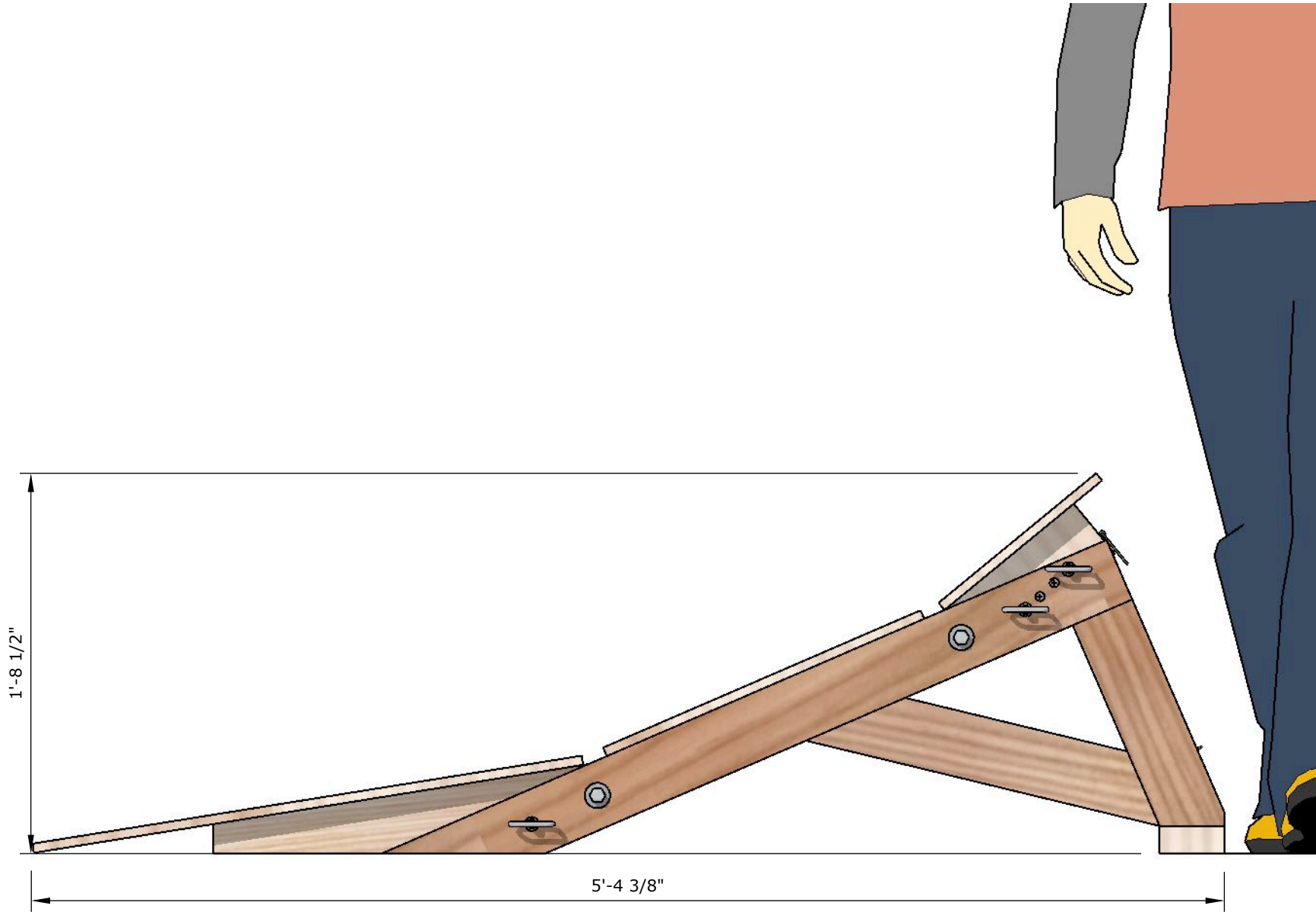

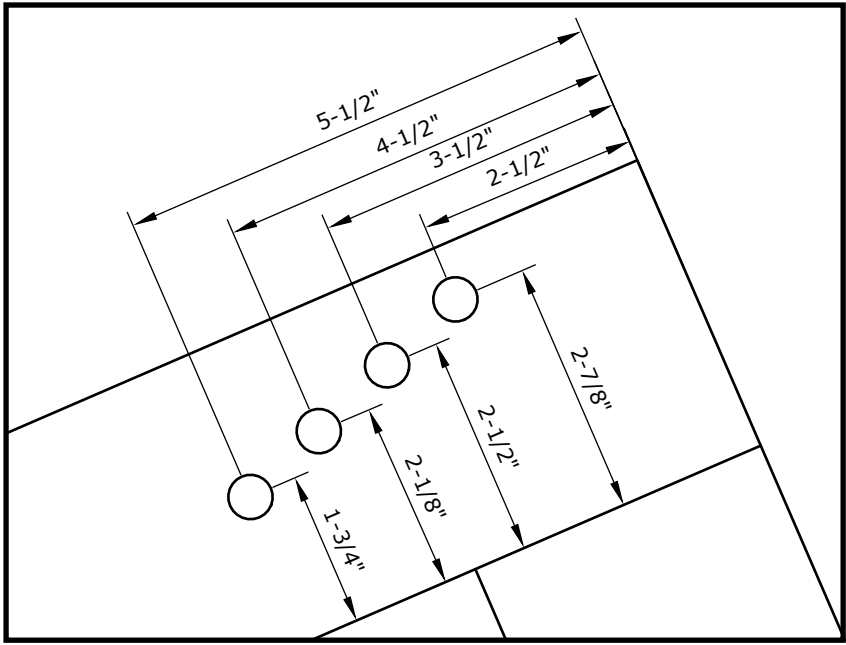

Pin Layout Detail

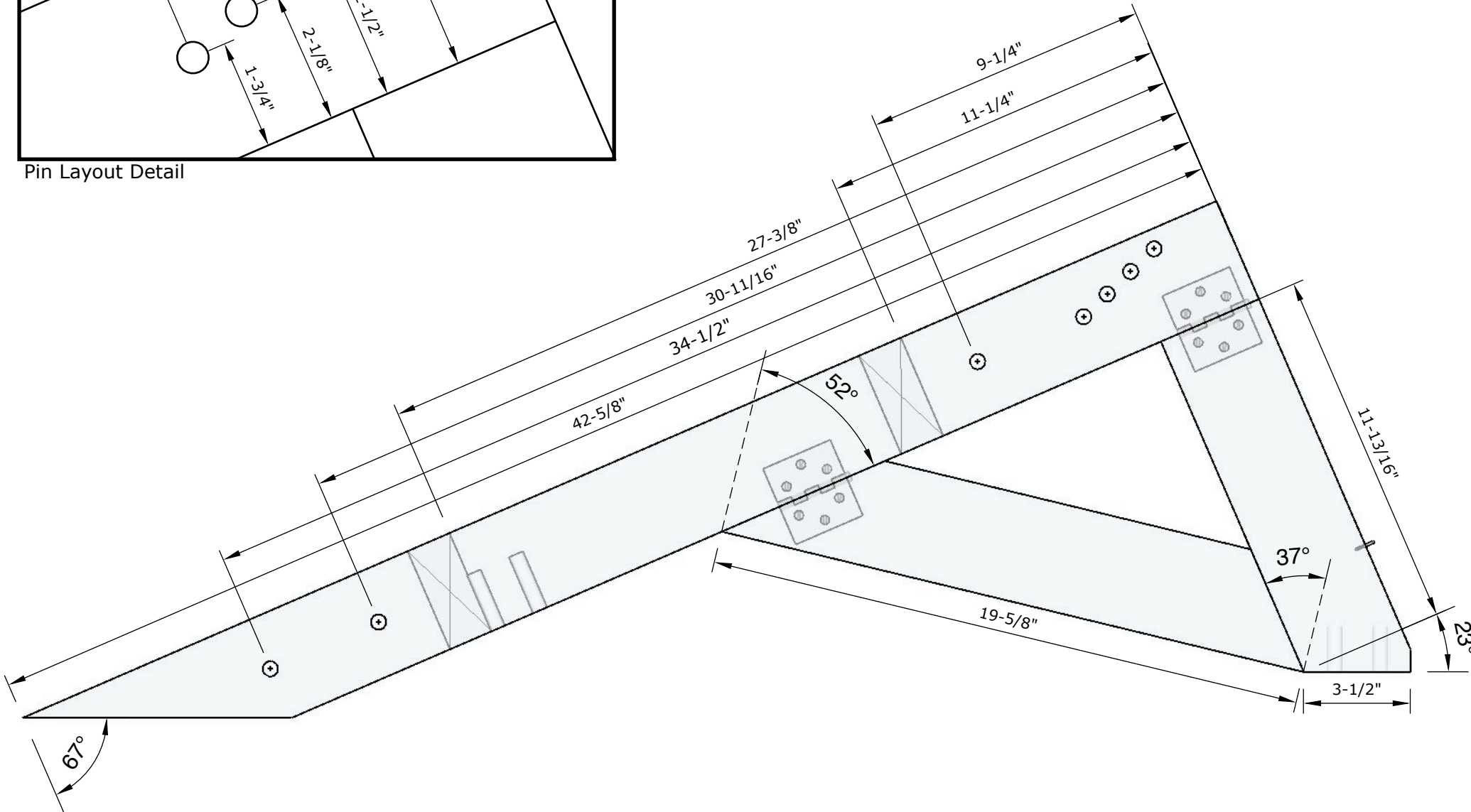

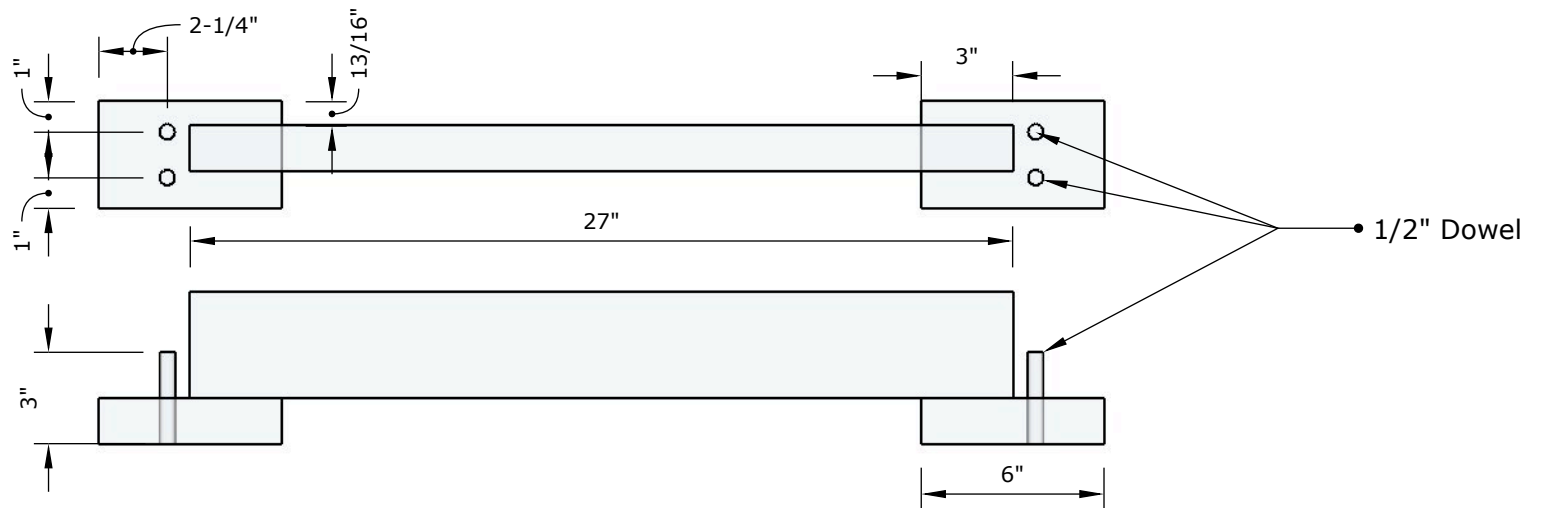
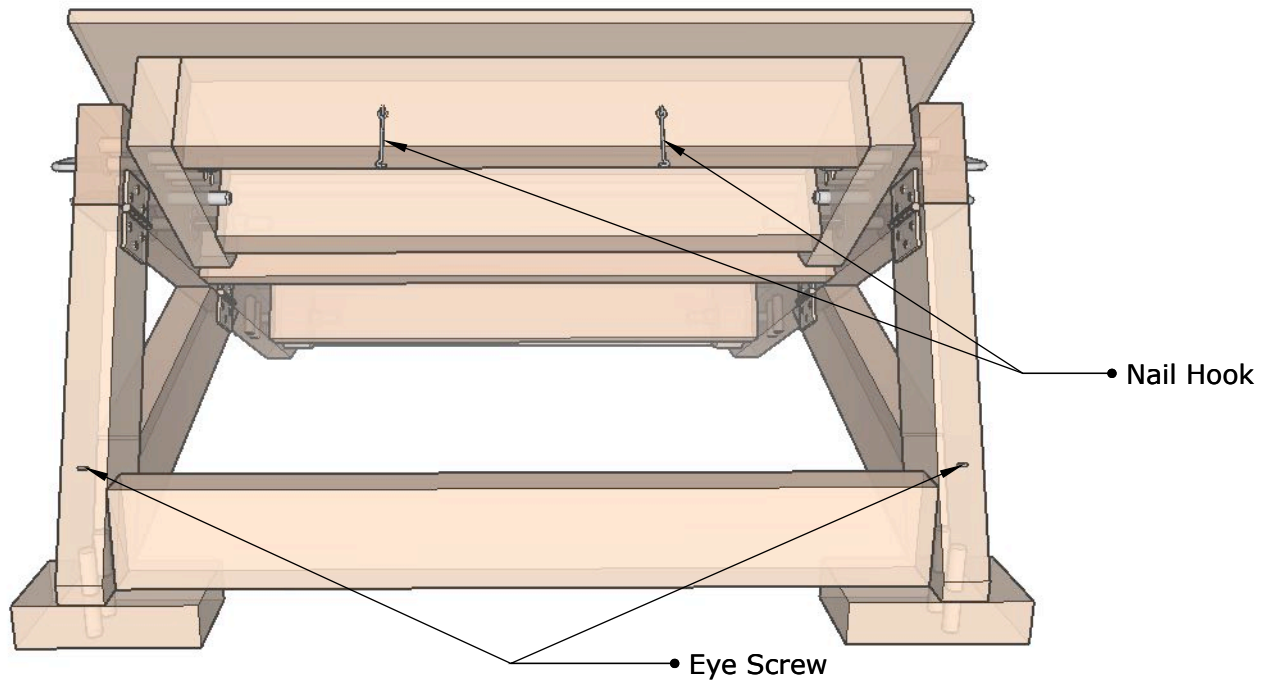

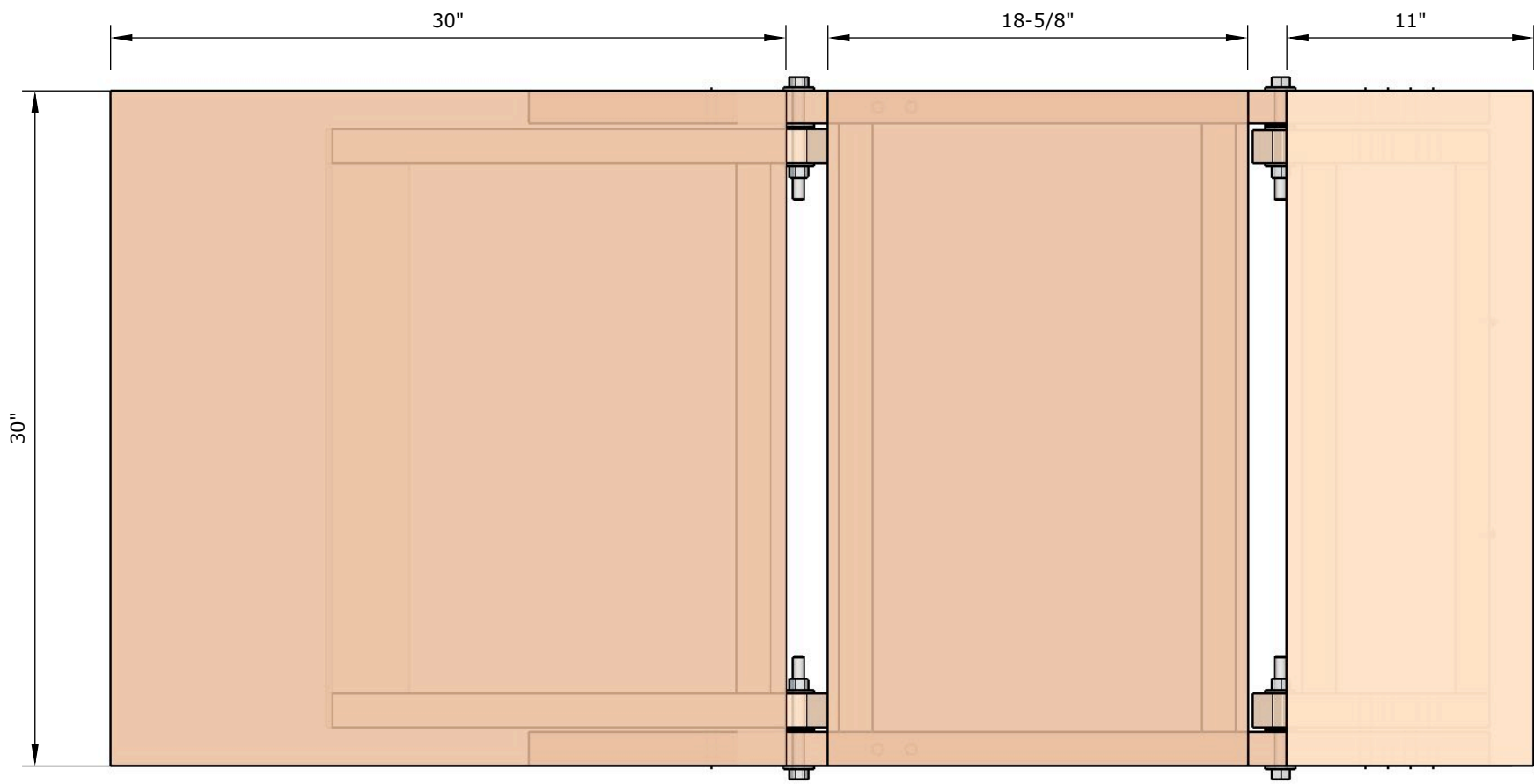

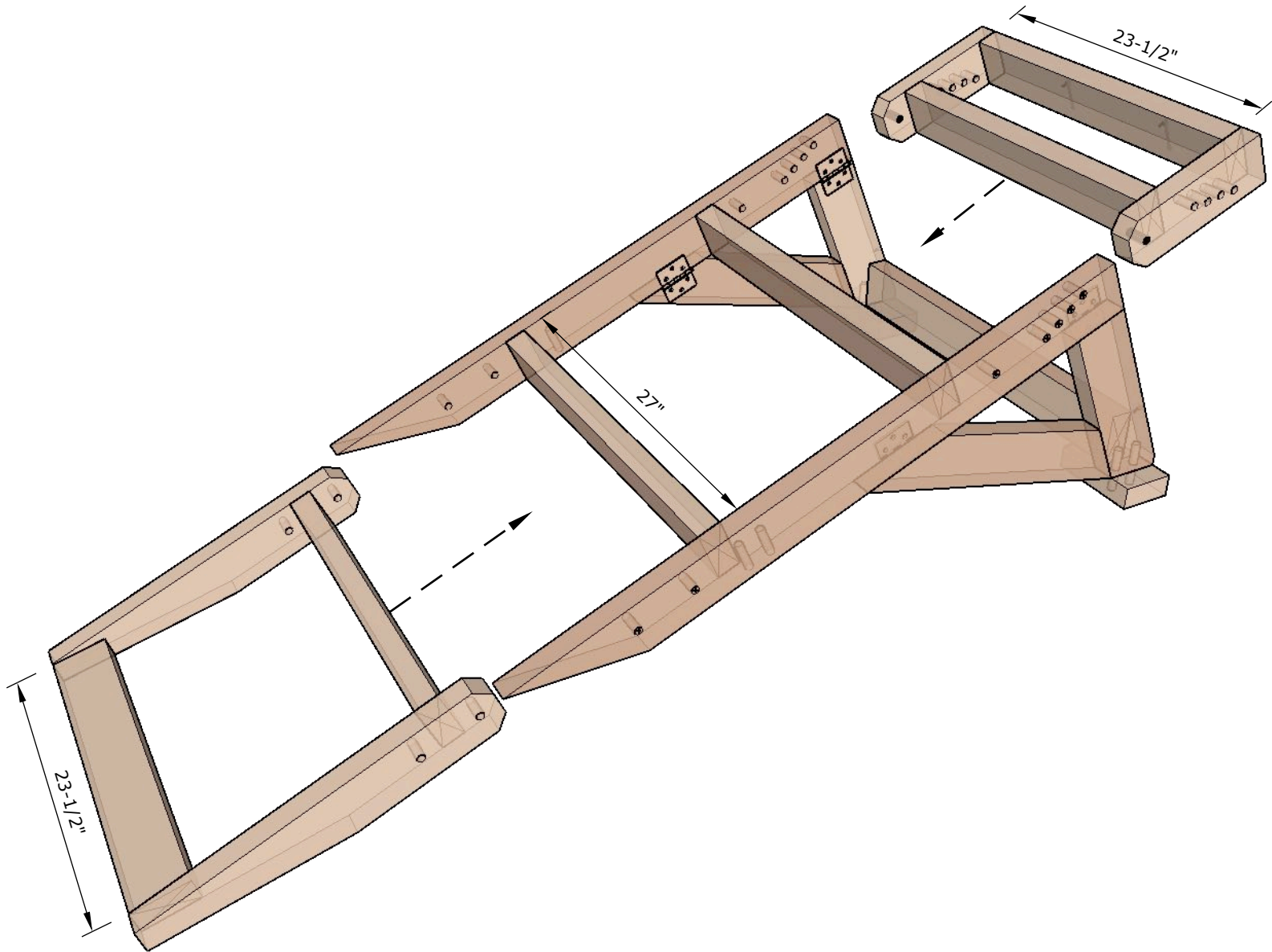

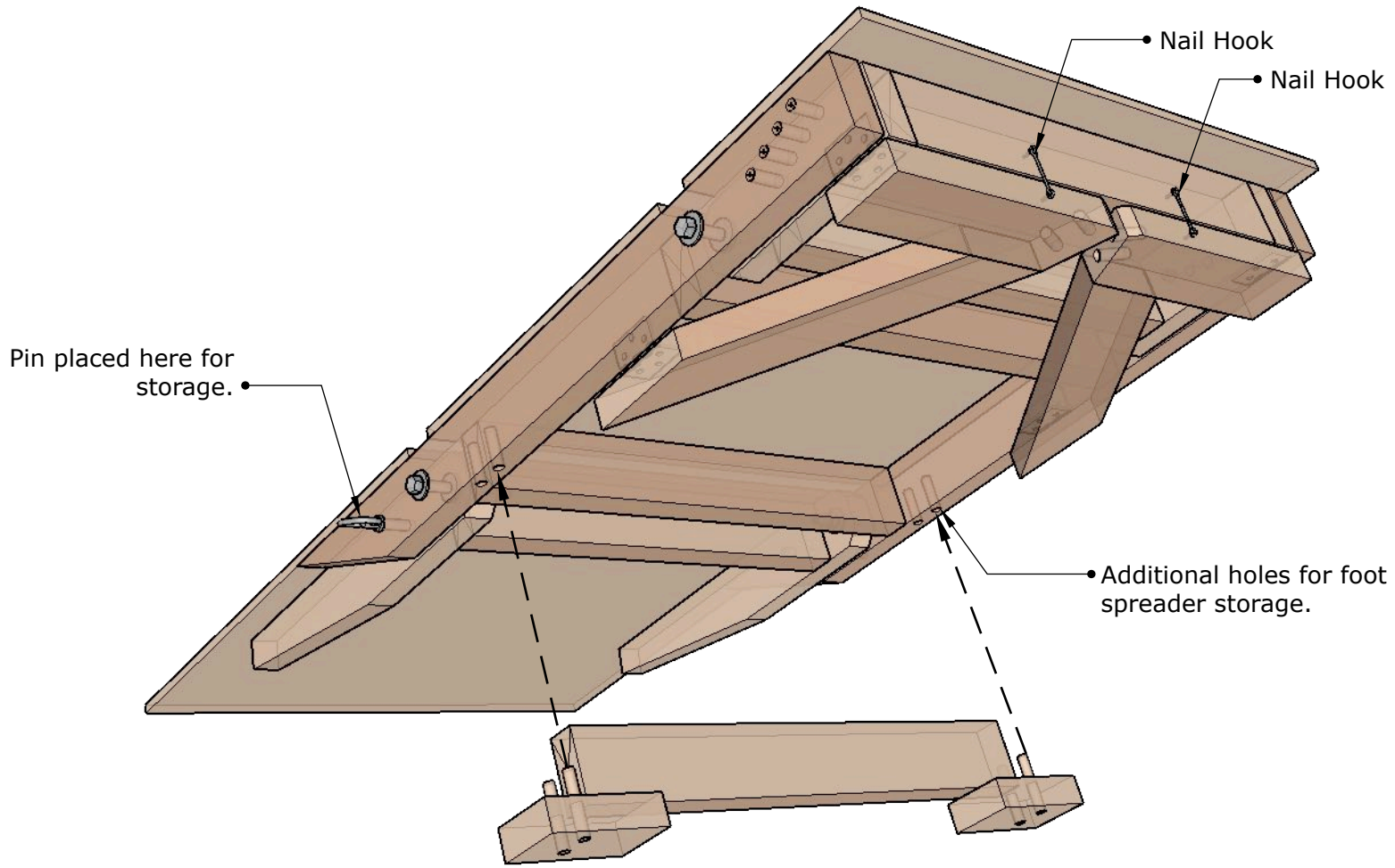

• Nail Hook

• Nail Hook

Pin placed here for storage.

• Additional holes for foot spreader storage.

Adjustable Folding Kicker Ramp

Metric Edition

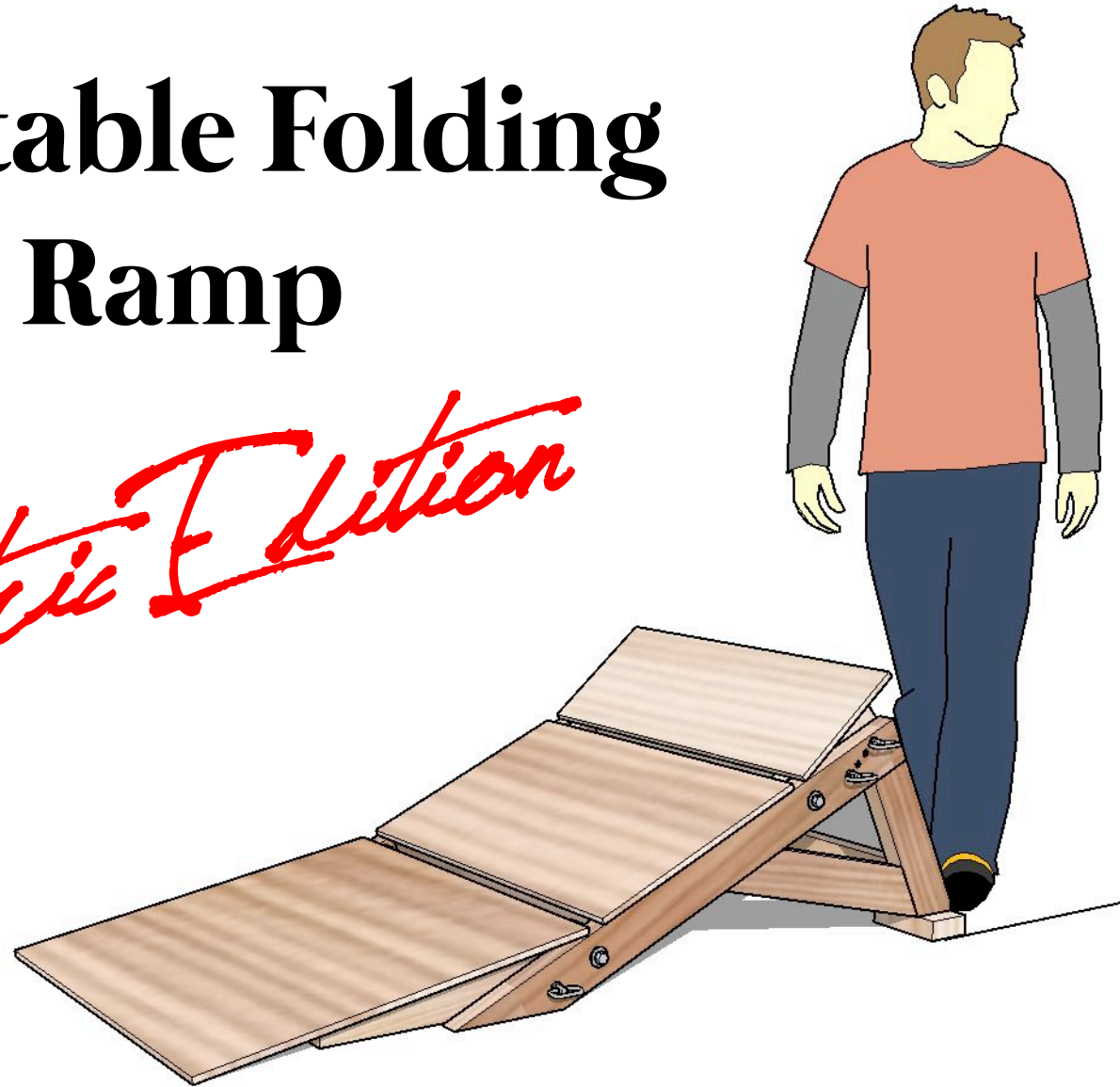

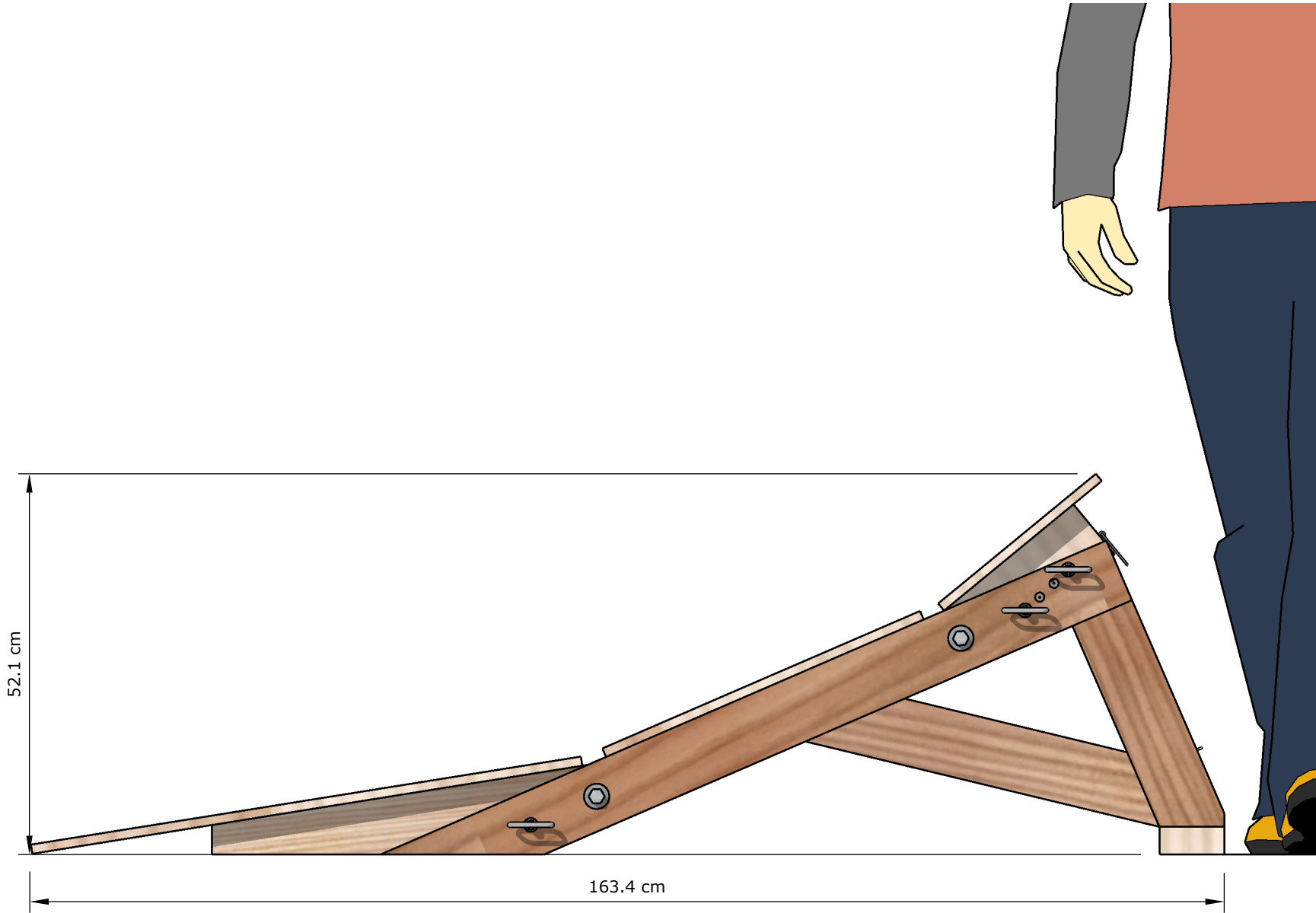

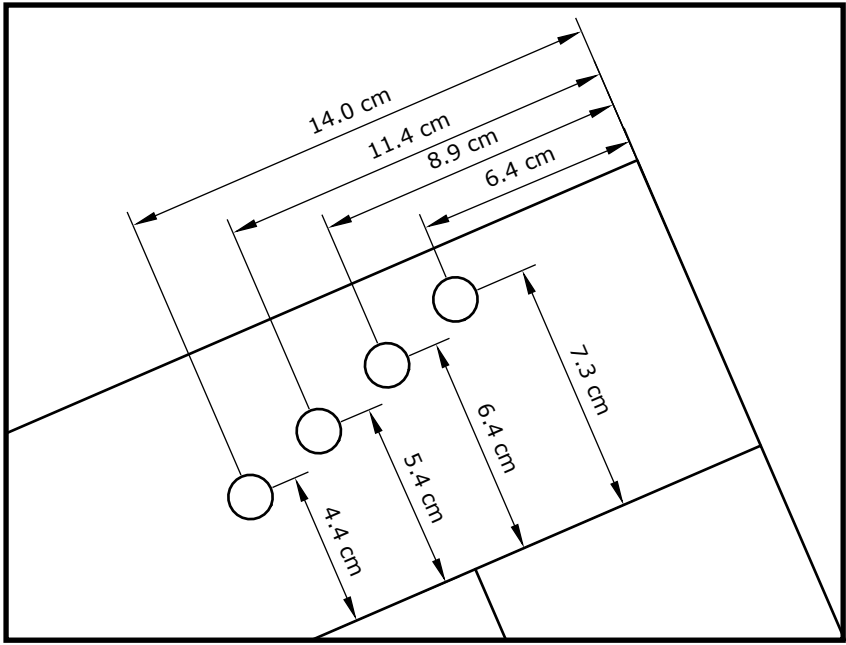

Pin Layout Detail

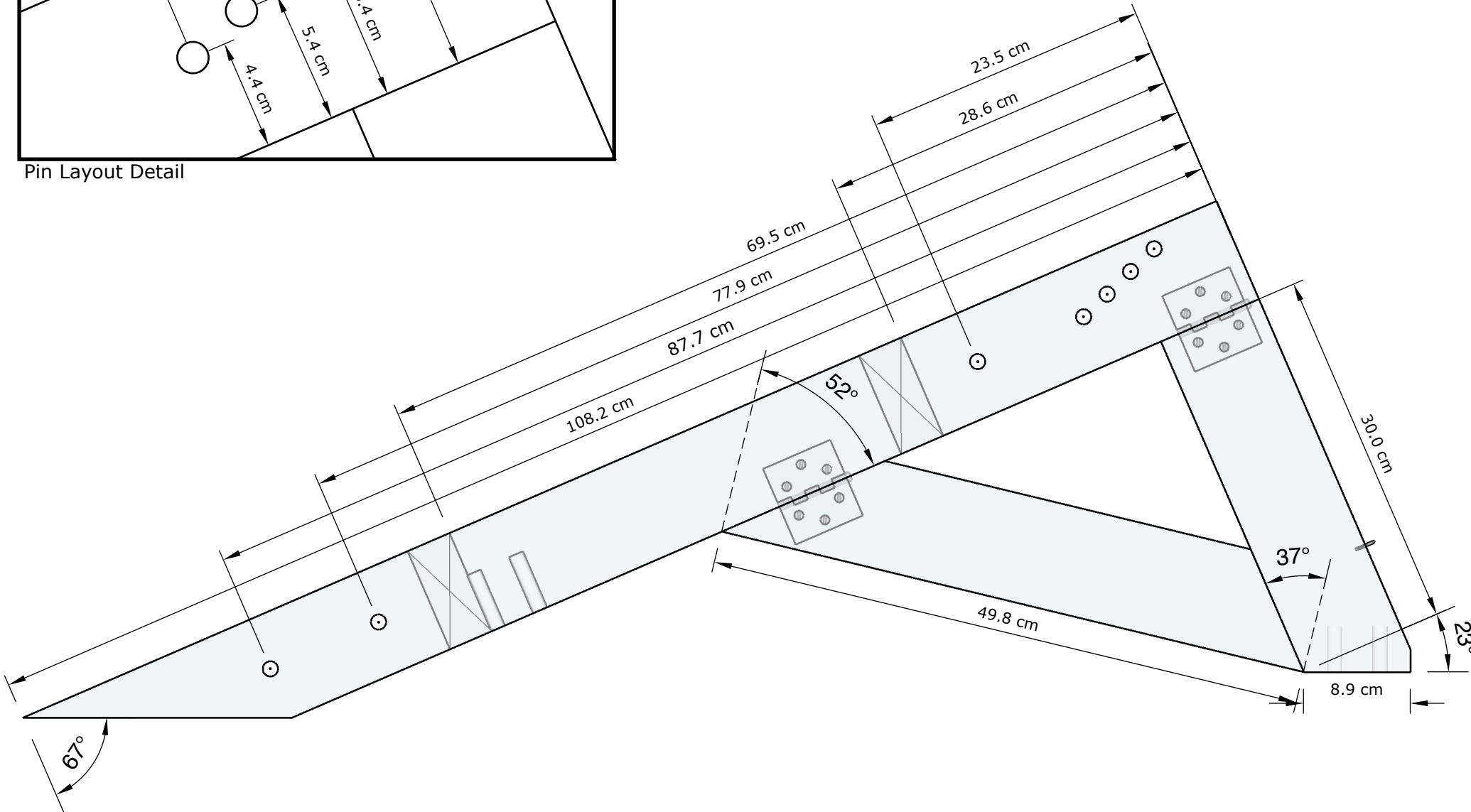

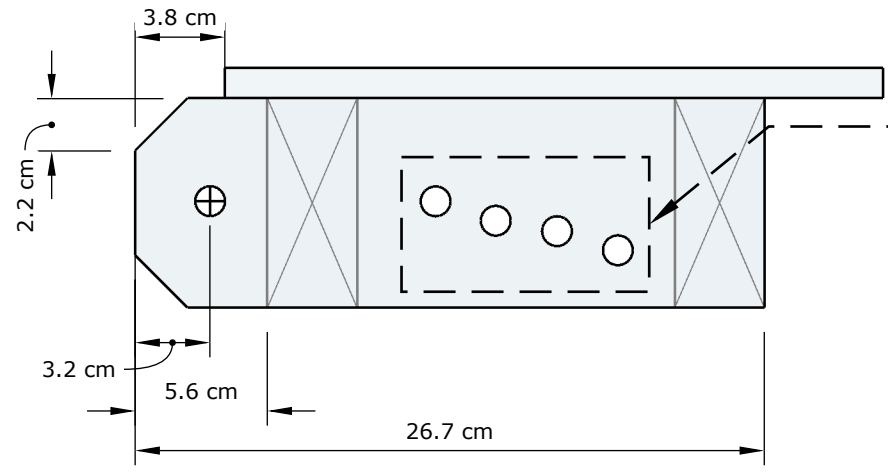

● These hole will be drilled after assembly.

