

A) Flanged Post

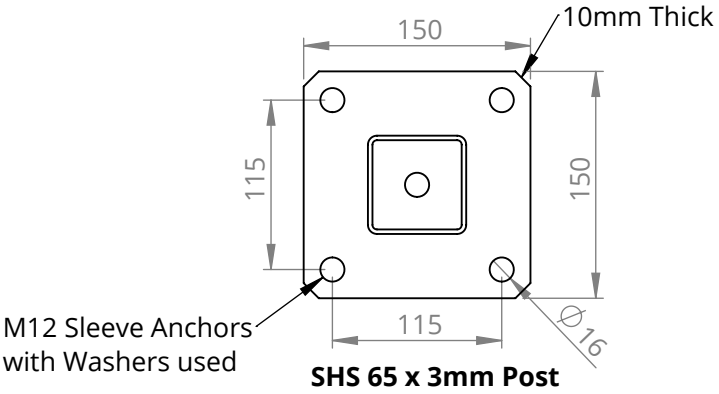

B) Inground Post

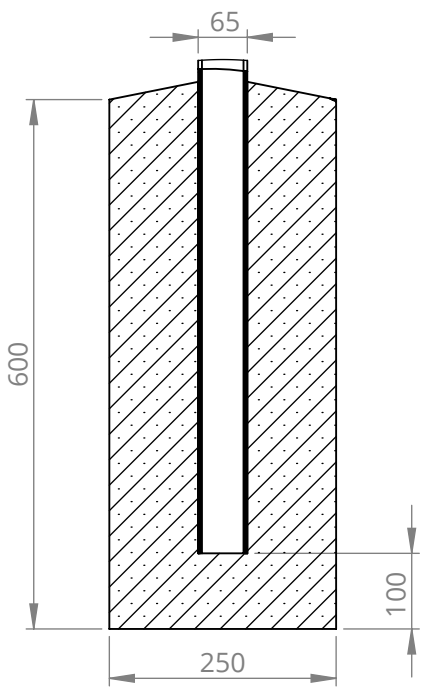

Fixing Details

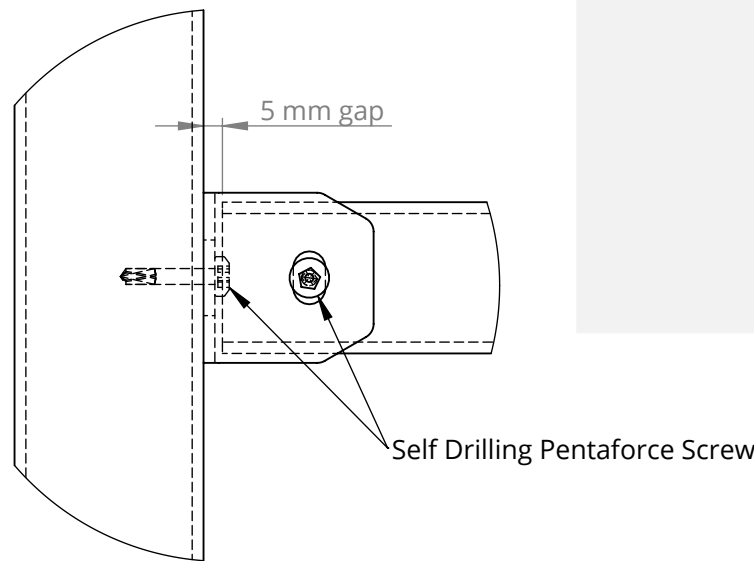

Bracket Details

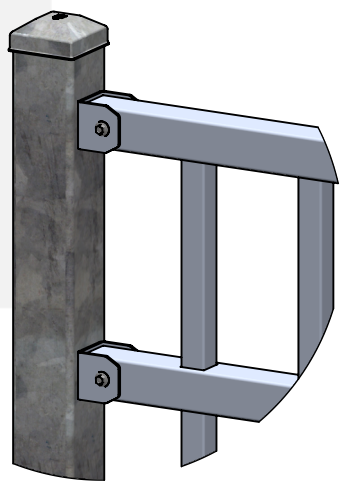

Specs :

- Post Size: SHS 65 x 3mm (Ali)
- Post Size: SHS 50 x 2.5mm (Steel)
- Pickets: SHS 25 x 1.2mm
- Rails: 40 x 40mm Mercury Channel

Description :

Mercury 1500h Flat Top  
Aluminium Panel

Material :

Aluminium 6063-T5

Finish :

Standard Powder Coat

Panel Weight : 16 Kg

Drawn : KSB

Notes :

- Footing dimensions subject to change to suit ground conditions

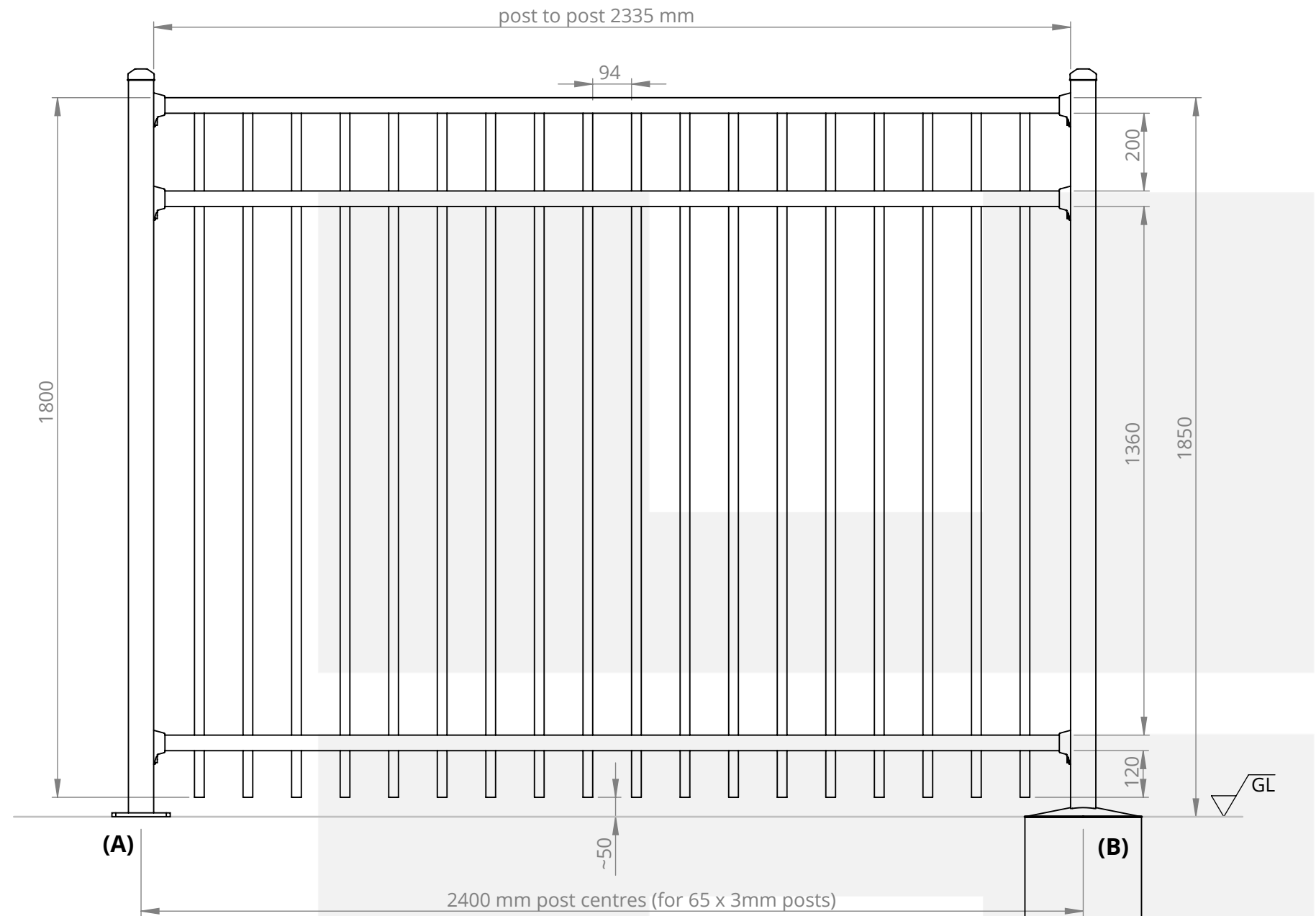

A) Flanged Post

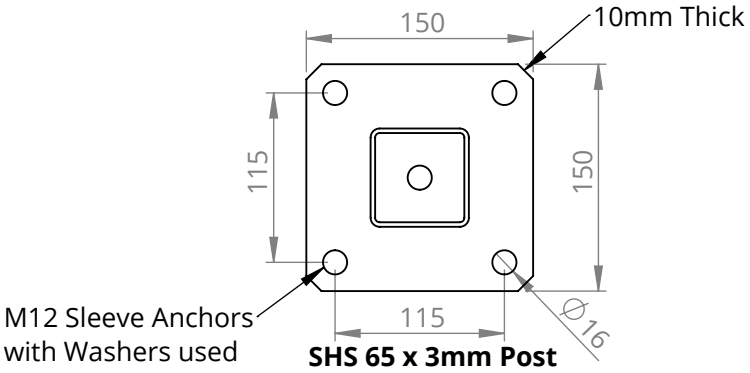

B) Inground Post

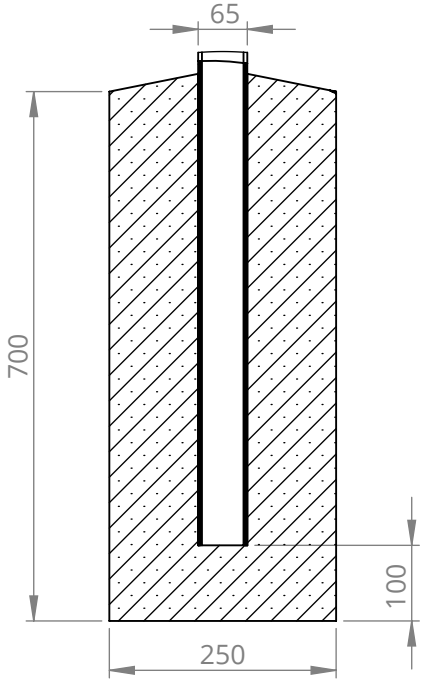

Fixing Details

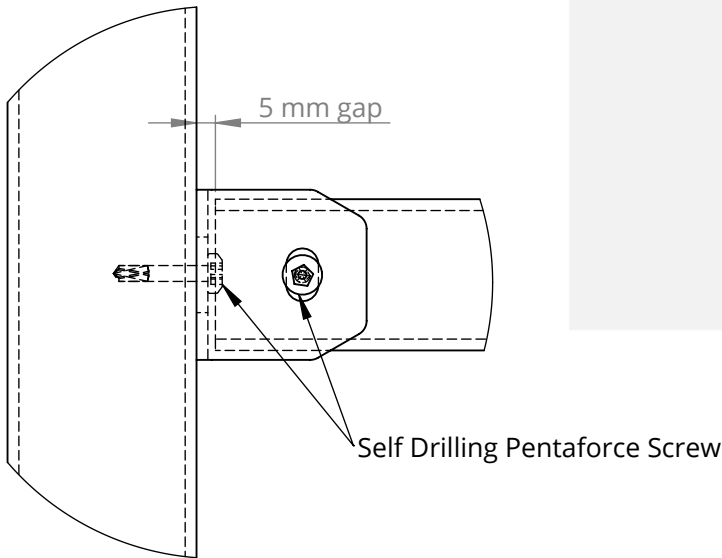

Bracket Details

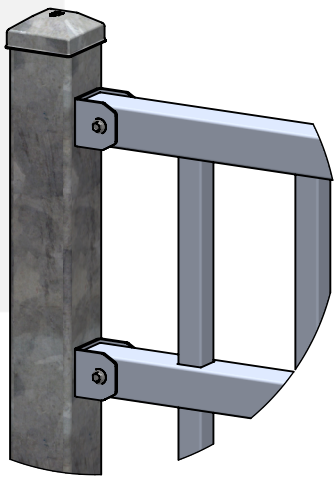

Specs :

- Post Size: SHS 65 x 3mm (Ali)
- Post Size: SHS 50 x 2.5mm (Steel)
- Pickets: SHS 25 x 1.2mm
- Rails: 40 x 40mm Mercury Channel

Description :

Mercury 1800h Flat Top  
Aluminium Panel

Material :

Aluminium 6063-T5

Finish :

Standard Powder Coat

Panel Weight : 18 Kg    Drawn :    KSB

Notes :

- Footing dimensions subject to change to suit ground conditions

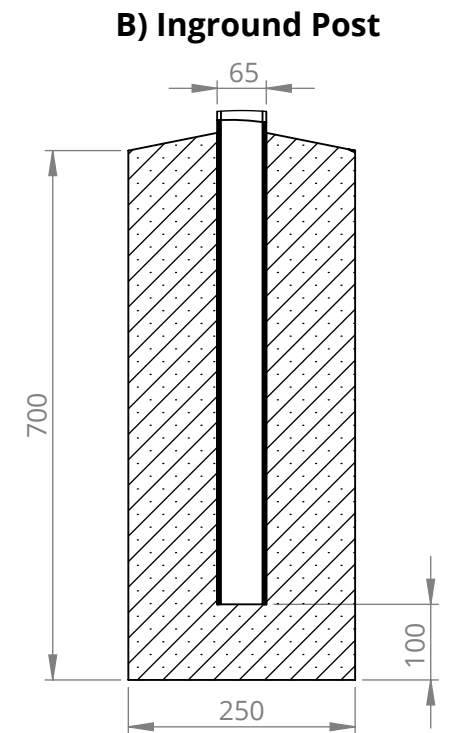
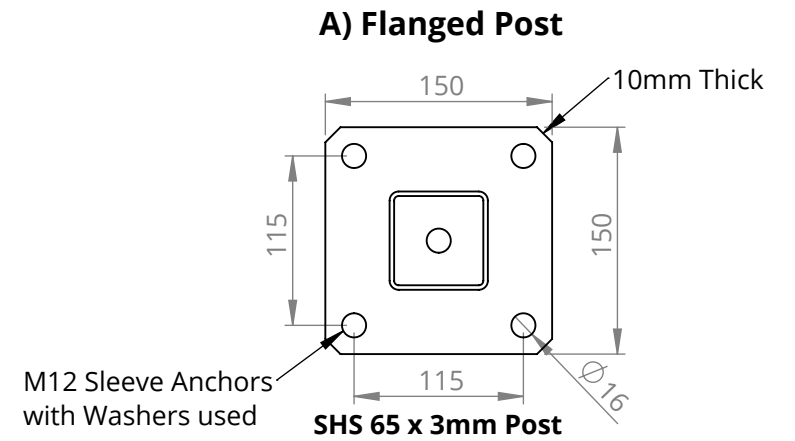
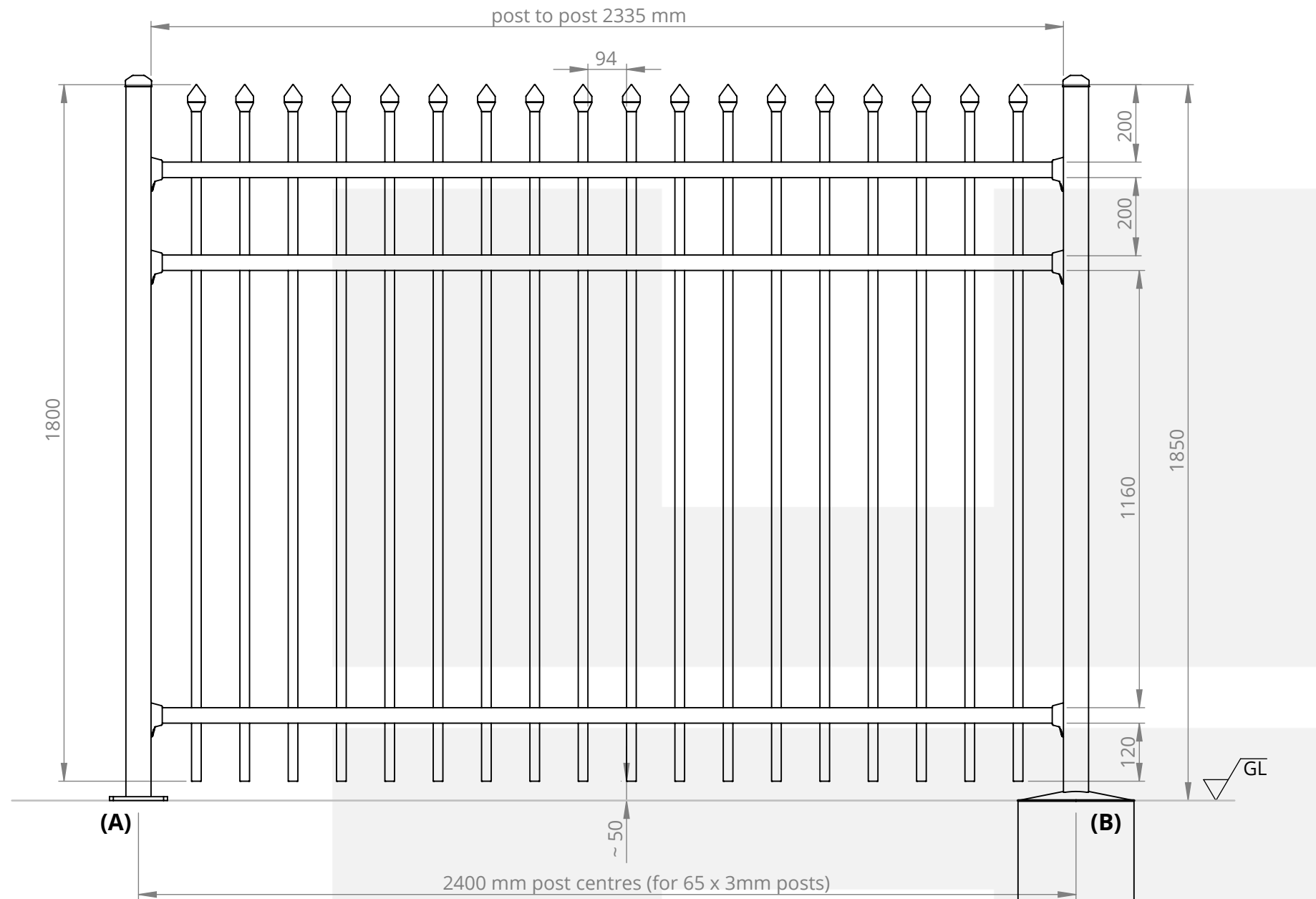

**Fixing Details**

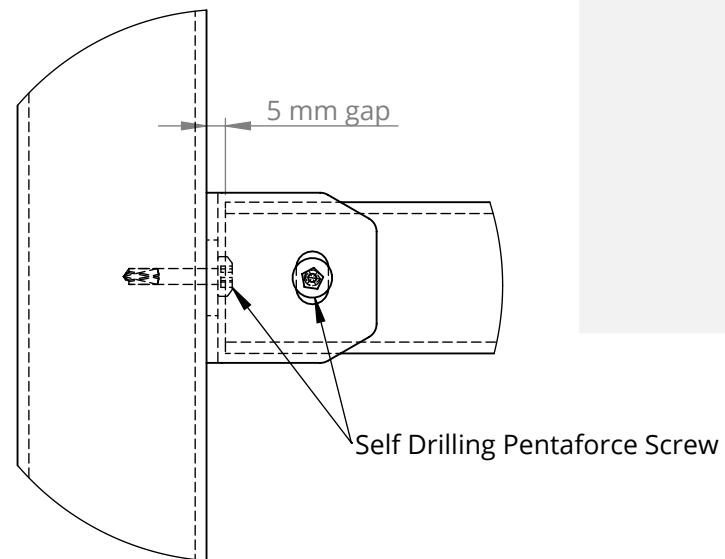

**Bracket Details**

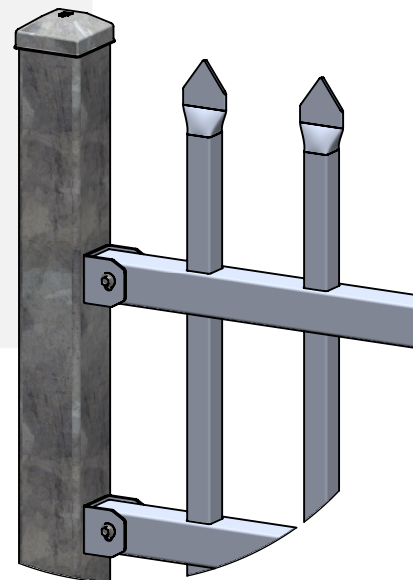

**Specs :**

- Post Size: SHS 65 x 3mm (Ali)
- Post Size: SHS 50 x 2.5mm (Steel)
- Pickets: SHS 25 x 1.2mm
- Rails: 40 x 40mm Mercury Channel

**Description :**

Mercury 1800h  
Aluminium Security Panel

**Material :**

Aluminium 6063-T5

**Finish :**

Standard Powder Coat

**Panel Weight :** 18 Kg **Drawn :** KSB

**Notes :**

- Footing dimensions subject to change to suit ground conditions

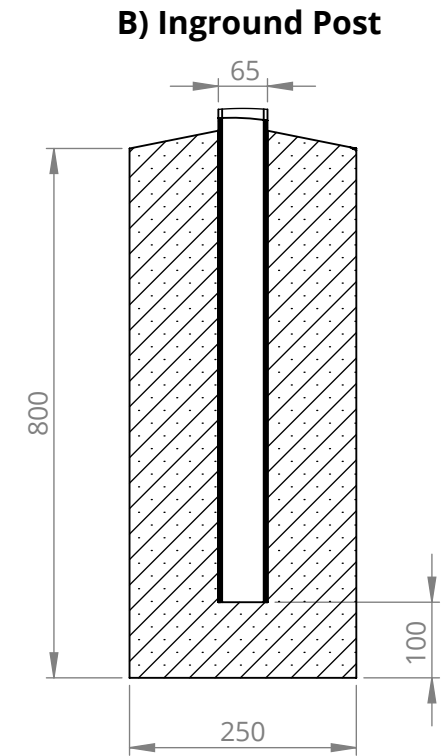
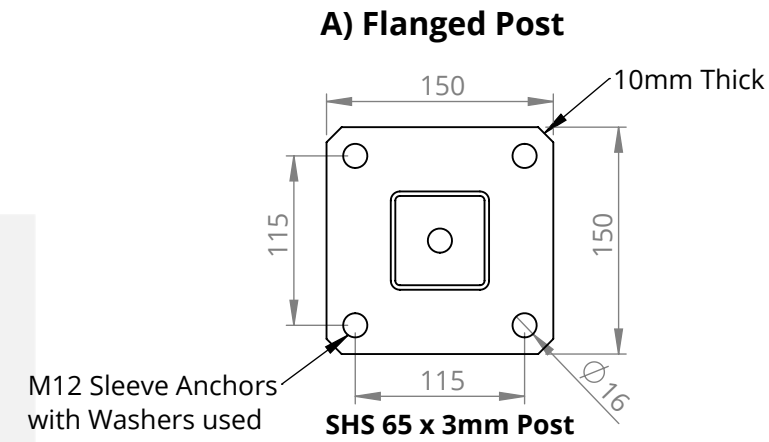
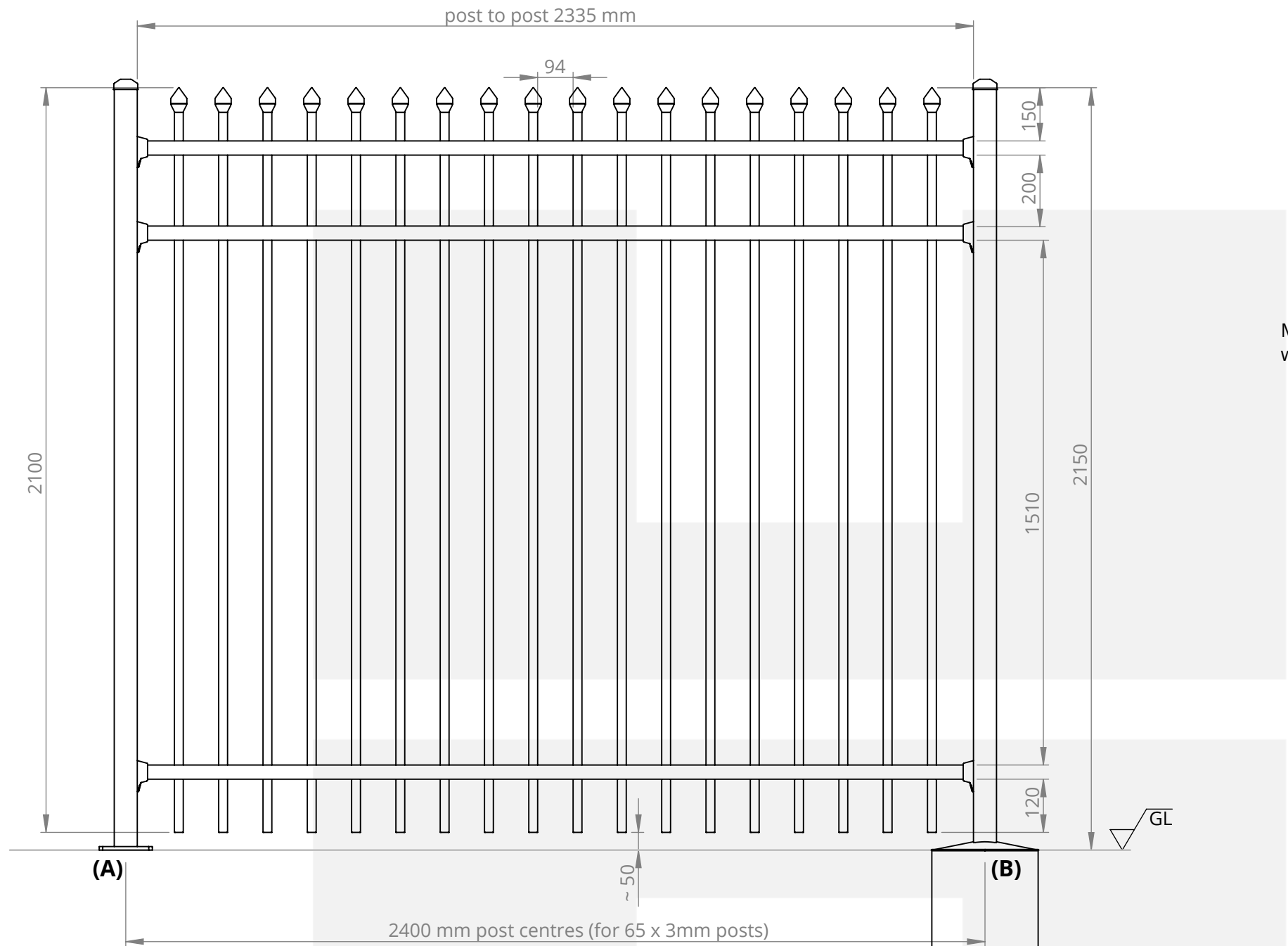

Fixing Details

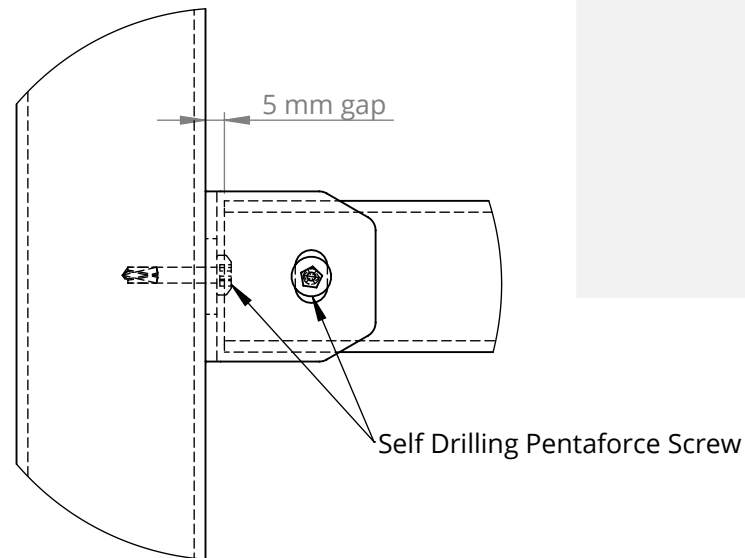

Bracket Details

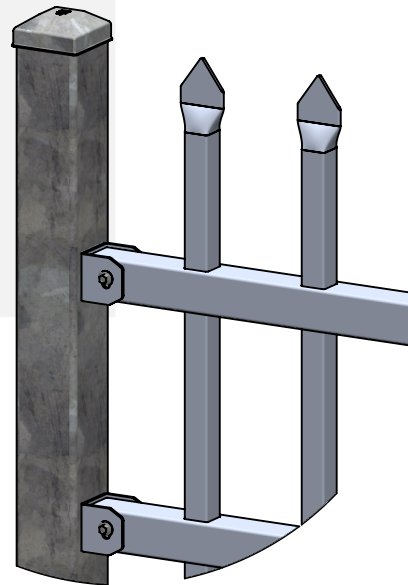

Specs :

- Post Size: SHS 65 x 3mm (Ali)
- Post Size: SHS 50 x 2.5mm (Steel)
- Pickets: SHS 25 x 1.2mm
- Rails: 40 x 40mm Mercury Channel

Description :

Mercury 2100h  
Aluminium Security Panel

Material :

Aluminium 6063-T5

Finish :

Standard Powder Coat

Panel Weight : 23 Kg    Drawn :    KSB

Notes :

- Footing dimensions subject to change to suit ground conditions