

# *Nirvana* NV14



## Quick Start Guide

## **Precautions !**

Before using this product, please download and read the "Disclaimer & Warning" document and user manual from our official website:[www.flysky-cn.com](http://www.flysky-cn.com)

## Front:

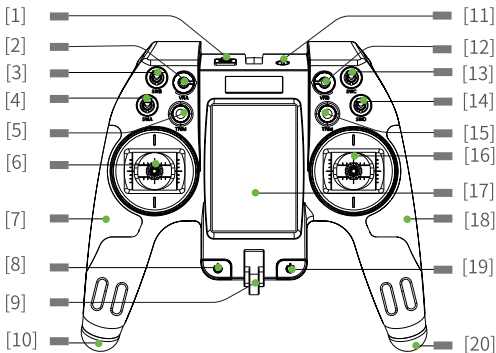

[1] USB Port

[2] VRA

[3] SWB

[4] SWA

[5] Trim

[6] Left Gimbal

[7] Grip

[8] Power Button

[9] Lanyard Eye

[10] Bat Compartment

[11] Trainer Port

[12] VRB

[13] SWC

[14] SWD

[15] Trim

[16] Right Gimbal

[17] Screen

[18] Grip

[19] Power Button

[20] Bat Compartment

## Back:

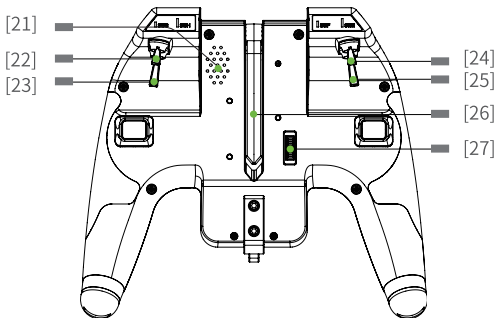

- [21] Speaker
- [22] SWG
- [23] SWH
- [24] SWF

- [25] SWE
- [26] Antenna
- [27] Module Port

- For more information, please read the NV14 User Manual

## Battery Installation

1. Unscrew the two battery compartment covers.

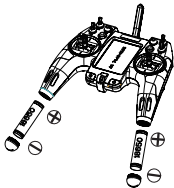

2. Insert 18650 batteries, one in each handle.
  - Pay attention to battery polarity when installing the batteries. See diagram above.
  - To ensure a stable power supply use 2 batteries.
3. Screw the battery compartment covers back into place.

## Power On

1. Make sure that all switches are in their highest position and the throttle is at its lowest position.
2. Press and hold both power buttons for 3 seconds. When the NV14 powers up the screen will turn on.

## Binding with FS-X8B

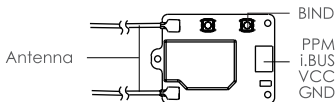

1. Press and hold the bind button while powering on the receiver.
  - The receiver's LED will flash when in bind mode.
2. Enter the **【BIND】** submenu, touch the bind function, then confirm when prompted.
3. If binding is successful the receiver's LED will stop flashing.
4. Check to make sure that the transmitter and receiver work as expected.

## Binding with FS-iA8X

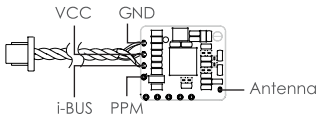

1. Powering on the receiver will activate bind mode.
  - When in bind mode the receiver LED will flash quickly.
2. Enter the **【BIND】** submenu, touch the bind function, then confirm when prompted.
3. If binding is successful the receiver's LED will stop flashing.

4. Check to make sure that the transmitter and receiver work as expected.

## Power Off

1. Power off the receiver.
  - To ensure safety, be sure to turn off the receiver before turning off the transmitter.
2. Press and hold both power buttons at the same time until the screen turns off.

## Lanyard Eye and SD Card Slot

1. Loosen the two hex screws on the back Lanyard Eye.
2. Remove the lanyard eye to expose the SD card slot.
3. Press the SD card inwards and release to remove.

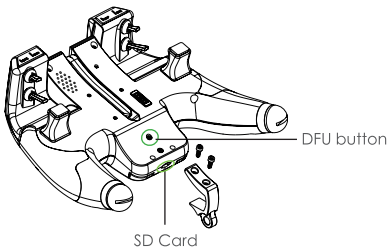

As shown marked in the above fig, the DFU button located in the a screw hole. The DFU button is used to update the Nirvana's firmware. For details please refer to the "Update Firmware" section in the Nirvana's User Manual.

## RF Module Adapter Installation

As shown below, there are 4 screw holes and one port for the RF Module. The screw holes are used to fix the module adapter to the transmitter and the port is used by the RF module to interface with the transmitter.

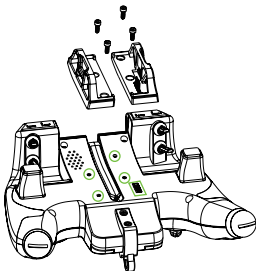

Align the adapters holes up to the holes on the transmitter, then insert and tighten the screws.



## Specifications

Product Number	NV14
Channels	14
Frequency Range	2.408-2.475GHz
RF standard	AFHDS 2A
Modulation	FHSS
Antenna	Built-in and External
Battery	2*18650
Online Update	Yes
Dimensions	205.2*183.7 mm
Weight	726.2g
Certification	CE, FCC ID: N4ZNV1400

## 注意事项！

开始操作前请务必在 Flysky 官网下载并阅读《免责声明 & 警告》了解安全注意事项，并在 Flysky 官网下载阅读使用说明书。

Flysky 官网地址：[www.flysky-cn.com](http://www.flysky-cn.com)

## 前视图:

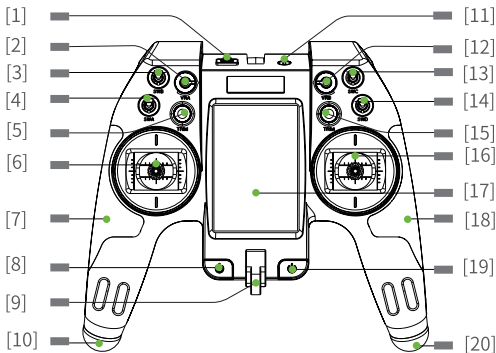

[1] USB 接口

[2] VRA

[3] SWB

[4] SWA

[5] TRIM

[6] 左摇杆

[7] 手胶

[8] 电源键

[9] 吊环

[10] 电池仓盖

[11] 教练接口

[12] VRB

[13] SWC

[14] SWD

[15] TRIM

[16] 右摇杆

[17] 触摸屏

[18] 手胶

[19] 电源键

[20] 电池仓盖

## 后视图：

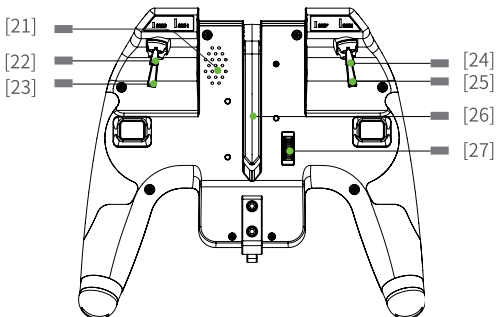

[21] 喇叭  
[22] SWG  
[23] SWH  
[24] SWF

[25] SWE  
[26] 天线  
[27] 高频头转接口

- 关于 NV14 发射机的更多操作请阅读使用说明书。

## 电池安装

1. 从遥控器手柄处分别拧下两个电池仓盖；

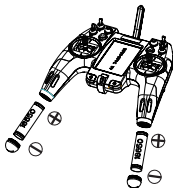

2. 将两节 18650 电池分别置入电池仓内；
  - 请注意电池的正负极，请勿反接。电池的正负极安装如图所示。
  - 为保证电池的供电能力，请使用双电池供电。
3. 将电池仓盖拧回手柄处，并拧紧，保证电池的良好接触。

## 开机

1. 将所有档位开关拨至最上档位，油门最低；
2. 同时长按两个电源键 3 秒，NV14 屏幕亮起，表示开机成功；

## 与 FS-X8B 对码

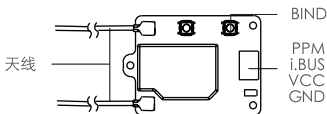

1. 按住接收机上的对码按键，并为接收机接通电源；
- 接收机指示灯快闪进入对码状态；
2. 进入发射机菜单中【对码】子菜单，点击对码功能，确认进入对码模式；
3. 对码成功后，接收机状态指示灯由快闪变为常亮。
4. 检查发射机、接收机、模型是否工作正常。如需重新对码请重复以上步骤。

## 与 FS-iA8X 对码

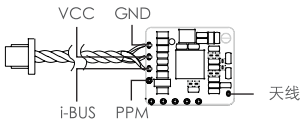

1. 接收机接通电源即进入对码状态；
- 此时接收机指示灯快闪；
2. 进入发射机菜单中【对码】子菜单，点击对码功能，确认进入对码模式；
3. 对码成功后，接收机指示灯由快闪变为常亮；

4. 检查发射机、接收机、模型是否工作正常。如需重新对码请重复以上步骤。

## 关机

1. 关闭接收机电源；
  - 为保证安全，请务必在关闭发射机前关闭接收机电源；
2. 同时按下两个电源键，直至遥控器屏幕熄灭。

## 吊环以及 SD 卡的拆装

1. 拧出吊环背面处两颗内六角螺丝；
2. 取下吊环，同时露出 SD 卡插槽；
3. 向里轻按 SD 卡，SD 卡会自动弹出。

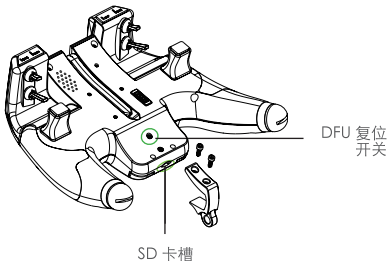

如图所示，在图中标注的位置螺丝孔内有 DFU 复位开关，通过使用此开关可直接更新程序。详细操作请查看《Nirvana 使用说明书》中“更新程序”章节。

## 高频头转接件安装

如图，在发射机背后有四个螺丝孔和一个转接孔。螺丝孔用于安装固定高频头转接件的螺丝；转接孔用于连接高频头转接件的转接头。

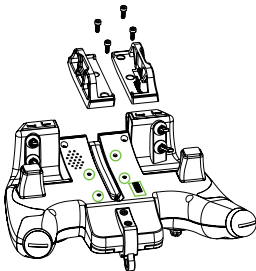

如图将转接件的螺丝孔位与发射机螺丝孔位对齐，同时将转接头插入转接孔，然后拧紧螺丝，即安装成功。



## 规格参数

产品型号	NV14
通道个数	14
频率范围	2.408-2.475GHz
RF 标准	AFHDS 2A
传输方式	FHSS
天线类型	内置天线和外置天线
输入电源	2*18650
在线更新	有
外型尺寸	205.2*183.7 mm
机身重量	726.2g
认证	CE, FCC ID: N4ZNV1400



FCC ID: N4ZNV1400

出版日期 :2018-11-13

Copyright ©2018 Flysky Technology co., ltd

