

Site Hazard Analysis to facilitate “Strategic CDM Design” decisions

The Problem/Challenge

To find the best building location on the site, from the site analysis, and the optimum footprint, orientation, size, scale, geometry and sculptural form?

The Risks

Hazardous local gas installations, railway structures, tracks, viaducts, roads, etc. below ground services, tunnels and foundations, retained structures etc.

The Solution

Drawings were produced that show proximity to the gasholders and railway viaduct. Shows how close structure, temporary works, scaffolding, hoardings, welfare facilities, etc. can be built to the railway.

The Benefits

Safe theoretical maximum building envelope “the jelly mould” was agreed early together with safe site set up principles avoiding later costs and changes eg. Roads, access etc. This can include a party wall.

Key Points

All such hazards require analysis before the footprint and form of the intended structure can be finalised. The Client should provide survey information to clarify all such site issues but analysis drawings needed especially if scheme revised at later stages.



Site Plan with significant hazards indicated

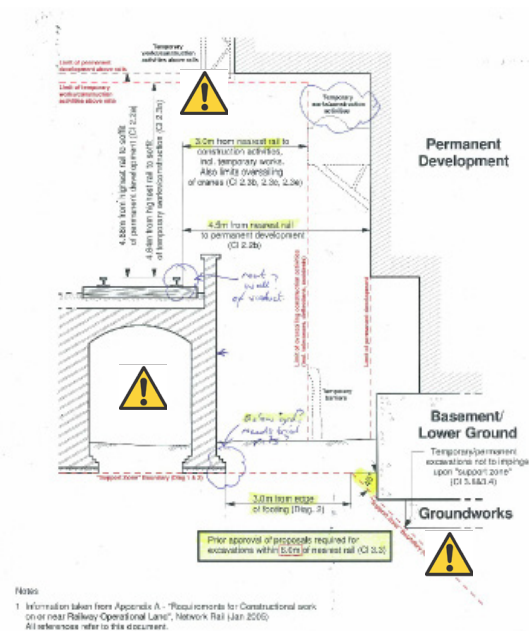

Boundary section to railway viaduct

Subscan Survey - hazards identified with symbols

