

Although both deer and rabbits are notorious nibblers, all the plants in this landscape plan are seldom severely damaged.

Your new garden will need full sun and moderate water. Designed for six months or more of bloom, this critter resistant garden plan can be expanded to cover a larger space by planting multiples of the small perennials and choosing a larger Rose of Sharon. Add wood mulch from Stone Market to conserve moisture around your new plants and complete the look!

The deer and rabbit resistant garden plan is presented below. We'll help you get to know the plants on the next page.

The Plan

Plant List:

- A. One **Miscanthus Grass**
- B. One **Lil' Kim Rose of Sharon** (see plant notes)
- C. One **Butterfly Bush** (see plant notes)
- D. One **'Bevan's Variety' Hardy Geranium**
- E. One **Siberian Iris** (see plant notes)
- F. Three **Dwarf Beebalm**
- G. One **Allium**
- H. One **Stonecrop Sedum**
- I. One **Catmint**

Approximate cost of plant material: \$250

Dimensions as shown: 12'x10'

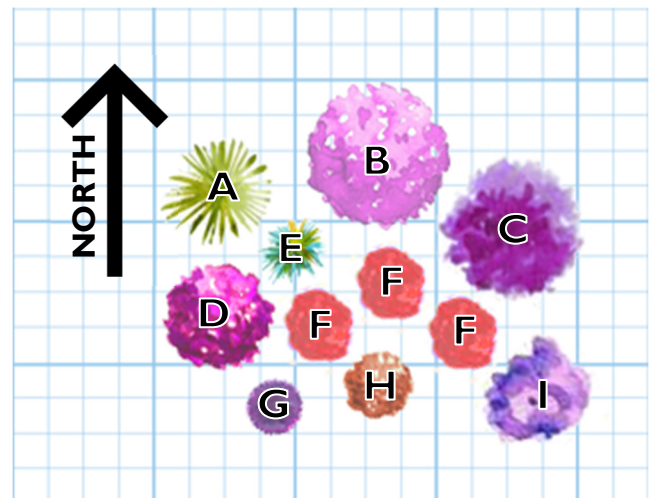

Each small square represents one square foot

The Plants



A. Miscanthus Grass adds texture and motion to the garden, with graceful plumes that emerge late summer and add interest late in the year. Like many of the plants in this plan, once it's established it's impervious to drought as well as hungry herbivores. It's available in a range of sizes and varieties, so choose your favorite. The only care it needs is to be cut down each spring, just before the new growth emerges. Wearing gloves, bind it tightly with cord, and cut it off 6" from the ground with hedge shears.



B. Rose of Sharon is a vigorous shrub that covers itself in hibiscus flowers from the start of summer through to frost. If space is limited in your yard, pick up one of the Lil' Kim cultivars, which grow just 3-4'x tall and wide, or one of the Pillar varieties, which are tall, but very narrow. For a different look, you could also use a Rose of Sharon patio tree. If you'd prefer a Rose of Sharon that can't set seed, sterile varieties include 'Azurri Blue,' 'Aphrodite,' 'Lucy,' 'Minerva,' and the entire 'Chiffon' series.



C. Butterfly bush is famously attractive to pollinators, but deer and rabbit aren't fond of it. In Central Illinois butterfly bushes die to the ground each winter, which is fine, because they only bloom on new growth. They're easy to grow if you plant them in very well drained soil as early in the season as possible, and use root stimulator when planting. As long as they're well established by winter, they need no extra protection. Choose a dwarf variety if you're short on space.



D. Bevan's Variety Hardy Geranium gives off a clean, fresh scent of lemon and spruce when the leaves are brushed, which doesn't agree at all with deer, rabbits, or rodents. It emerges from the ground very early and regales gardeners with cheery pink flowers in spring, reblooming in summer. Tough once established, thanks to the thick, fleshy root system that's unique to this species of Hardy Geranium.



E. Siberian Iris is more resistant to deer and rabbit damage than the more familiar German Iris, and it's also quite attractive! (That being said, German Iris is rarely seriously damaged either, and should also perform well in this garden plan if you prefer it.) Siberian Iris has narrow, grassy leaves and forms seed pods after bloom that may either be cut off or left in place, depending on your preference. Tolerates a wide range of soil conditions, but likes regular water.

Continued on next page



F. Dwarf Beebalm is an herb with a flavor similar to bergamot, and can be steeped along with black tea to make a mock Earl Grey. Native Americans used our native Beebalm to flavor wild game meat. Like most herbs, deer and rabbit find it unpalatable. Bright, round clusters of flowers appear during summer.

Any color of Dwarf Beebalm is fine for this plan, as long as it harmonizes well with the other flowers in the planting.



G. Allium is actually the name of the onion family, to which these attractive flowers belong. Their grassy leaves remain deep green through hot, dry spells, and they bear bubble-like clusters of purple flowers that float above the foliage on strong stems. For stronger visual impact, group several of them together.



F. Stonecrop Sedum is a widely varied group of succulents, many with colorful leaves that are just as interesting as their flowers! Their height ranges considerably, but since this plant is at the front of the bed, any variety will work. For stronger visual impact, group several of them together.



I. Catmint has always been an enthusiastic bloomer, but the new Proven Winners varieties add more intense color and neater habit to this garden classic. Cats are somewhat attracted to this herb, but deer and rabbit are less enthused, and tend to avoid it. Once established it pretty much takes care of itself, although you can shear it off once it's finished blooming to keep it looking trim and prompt rebloom. Like its close relative mint, the leaves of Catmint are sometimes used in herbal tea.

Tips for installing your new garden:

- It's fine to plant during summer, as long as you're prepared to water deeply once or twice a week.
- We recommend using Root Stimulator at the time of planting during summer and fall.
- If you have sand or heavy clay soil, amend the soil by mixing in 50% compost around each plant.
- A deep wood mulch will help the soil hold water and suppress weeds around your new plants. Bulk wood mulch is available at Stone Market for pickup or delivery.
- If you have questions, we're here for you! To speak with one of our experts you can visit the Garden Center, email us at expert@hoerrnursery.com, message us on Facebook or Instagram, or call (309) 691-4561 any time during business hours.