

Please use this product responsibly

Warning this product is not intended for use while in motion consumers assume all liability.

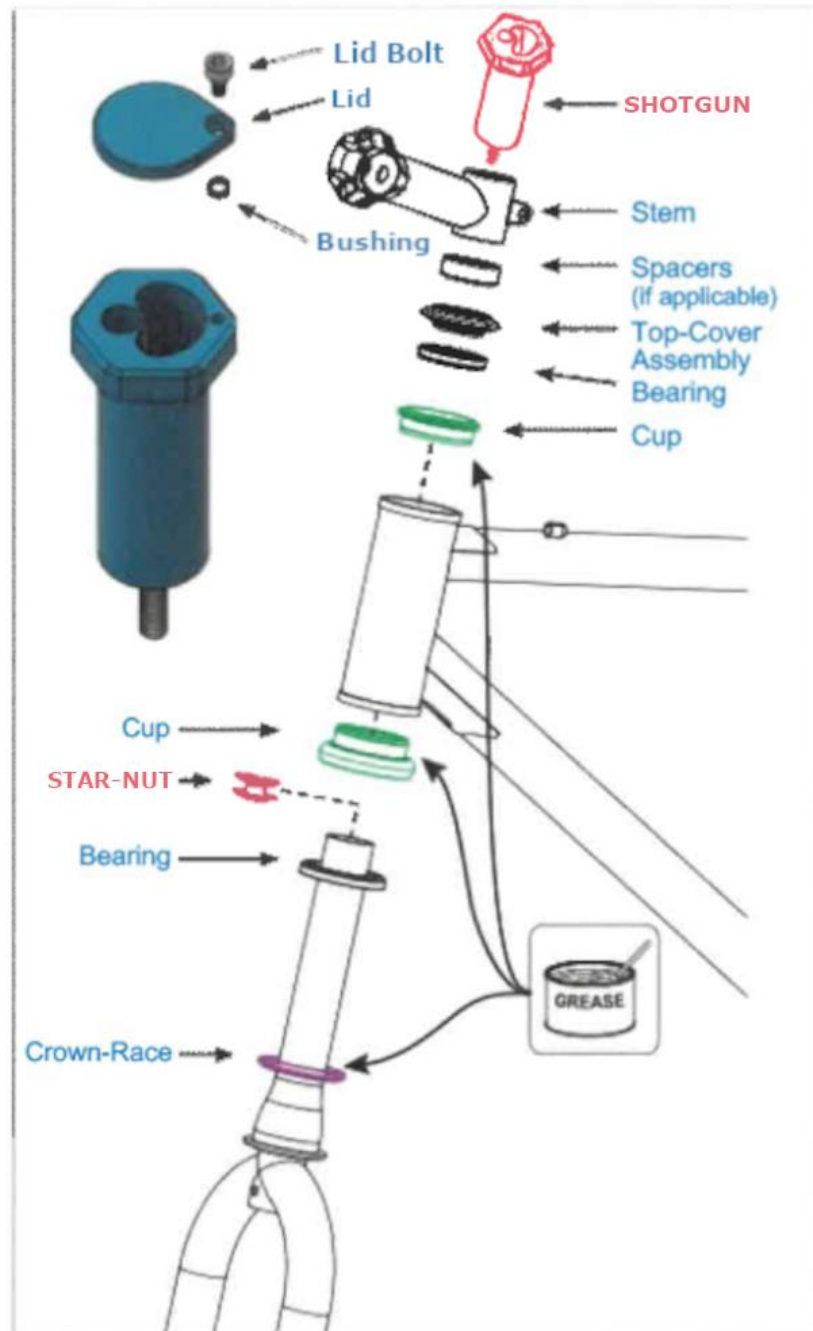

Installing your SHOTGUN.

**First method - M6 Bolt. (To prevent damage to the SHOTGUN'S body and anodized finish.)**

The walls of the SHOTGUNS outside diameter (OD) are relatively thin in some places (.7mm).

*Please install it with care.*

Clean your steer tube of any burs that can damage the SHOTGUNS body.

Purchase an M6 bolt approximately 100mm long. (McMaster.com Part number [91292A205](#))

Thread M6 bolt into STAR-NUT in steer tube. (7-8 turns is full thread engagement.)

Using a rubber mallet gently hammer STAR-NUT deeper into steer tube.

**Be sure that the M6 bolt is hammered in straight.**

**DO NOT HAMMER BOLT FLUSH TO STEERTUBE.**

Traditionally a socket head screw has a head height of 6mm. The SHOTGUN'S hex is 8mm in height.

You can swap the bolt for the SHOTGUN at any time to measure depth if you are uncertain about how far to hammer.

If you feel uncomfortable installing, bring it to a bike shop!

Remember the Purpose of a top cap is to provide compression to your headset while allowing the cockpit to move freely. [GCN](#) has a useful video on headset adjustments.

**Second Method. (Direct Install)**

**FOR BEST GASKET SEAL REMOVE LID BOLT AND NYLON BUSHING. DO NOT OVER TIGHTEN DURING REASSEMBLY.**

Remove lid and all hardware. Be sure to keep all hardware parts. There is a small Delrin bushing under the lid bolt that helps the lid to seal properly. Damage to this bushing might affect the lid seal.

Punch the SHOTGUN'S M6 bolt through a paper towel or two.

Thread the SHOTGUN into the STAR-NUT (7-8 turns).

Gently hammer with rubber mallet to recess the STAR-NUT. Alternatively, use a piece of wood on the face of the part to dampen the blow of the hammer.

Tighten SHOTGUN until the headset is properly adjusted.

**Third Method. (Carbon Steer Tube)**

The SHOTGUN'S (OD) is 23.6mm.

This makes it compatible with many modern carbon steer tubes.

Here is a link to the corresponding [J&L Carbon Steer Compression Plug](#) needed for installation.

### Installing your Top-Secret Top Cap

The Top Secrets Top Cap contains a trapped M6 bolt. The bolt is used to fashion the **STAR-NUT** in your bicycles steer tube. The part is approximately 83mm in length.

The same methods as the Shotgun installation apply.

**If you are not confident in your abilities to install the device, please take it to a bike shop.**

If further assistance is required, please feel free to email [iozziocycles@gmail.com](mailto:iozziocycles@gmail.com)

Or call (718)-360-6695

