

# THE RECORD PLAYER

SG-1 Super Groove Motor Drive MkIII



User Manual

# User Manual

## Introduction

Thank you for your purchase of the SG-1 MkIII Record Player Motor Drive. Please study these instructions carefully. Your SG motor drive is designed and manufactured to the highest standards and its correct installation will greatly enhance the sound quality of your record playing system rewarding you with many years of listening pleasure.

## Guarantee

Your Vertere SG motor drive is guaranteed against any defect in materials and workmanship for a period of two years from the date of purchase. You can extend this period to **ten years** by registering your warranty on the Vertere website - [vertereacoustics.com](http://vertereacoustics.com)

Make a note of the serial number(s) on your warranty card for future reference - please retain the card

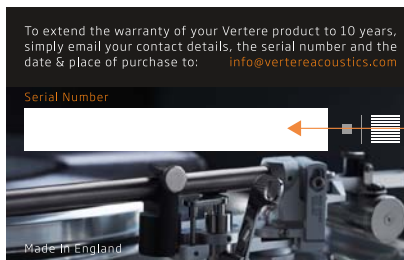

Serial Number(s)

This guarantee excludes:

1. Damage caused due to accident, misuse, neglect and incorrect installation, adjustment or repair.
2. General wear & tear.
3. Liability for damage or loss during transit from the retailer or purchaser to Vertere or its authorised distributor for the purposes of repair or inspection.

Carriage costs to Vertere shall be borne by the consignor.

All claims under this guarantee must be made through an authorised Vertere retailer.

If equipment returned for repair to Vertere is found on inspection to comply with the product specification Vertere reserves the right to make a charge for examination and return carriage.

There are no user serviceable parts inside your record player.

Unauthorised servicing will void this guarantee.



This product is designed to comply with the legal provisions of EU Directives 89/3336/EC and 72/23/EC. The standards which have been applied are those which were in force at the time of the introduction of this product.

This product bears the CE mark.

This product is compliant to EN 60065.

This product must be earthed.

Please ensure that other equipment connected to it is earthed according to the manufacturer's instructions.



## Maintenance

After disconnecting the unit from the mains supply, the unit may be cleaned with a lightly dampened soft cloth or chamois leather. Avoid using abrasives or solvents.

33 Level Adjustment Pot

33 & 45  
Phase Adjustment Pots

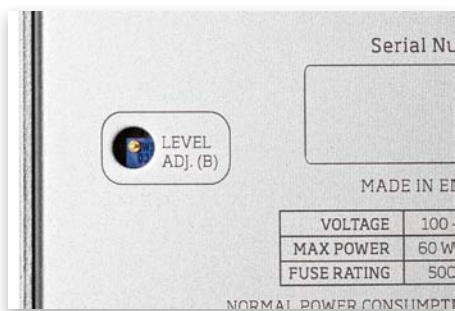
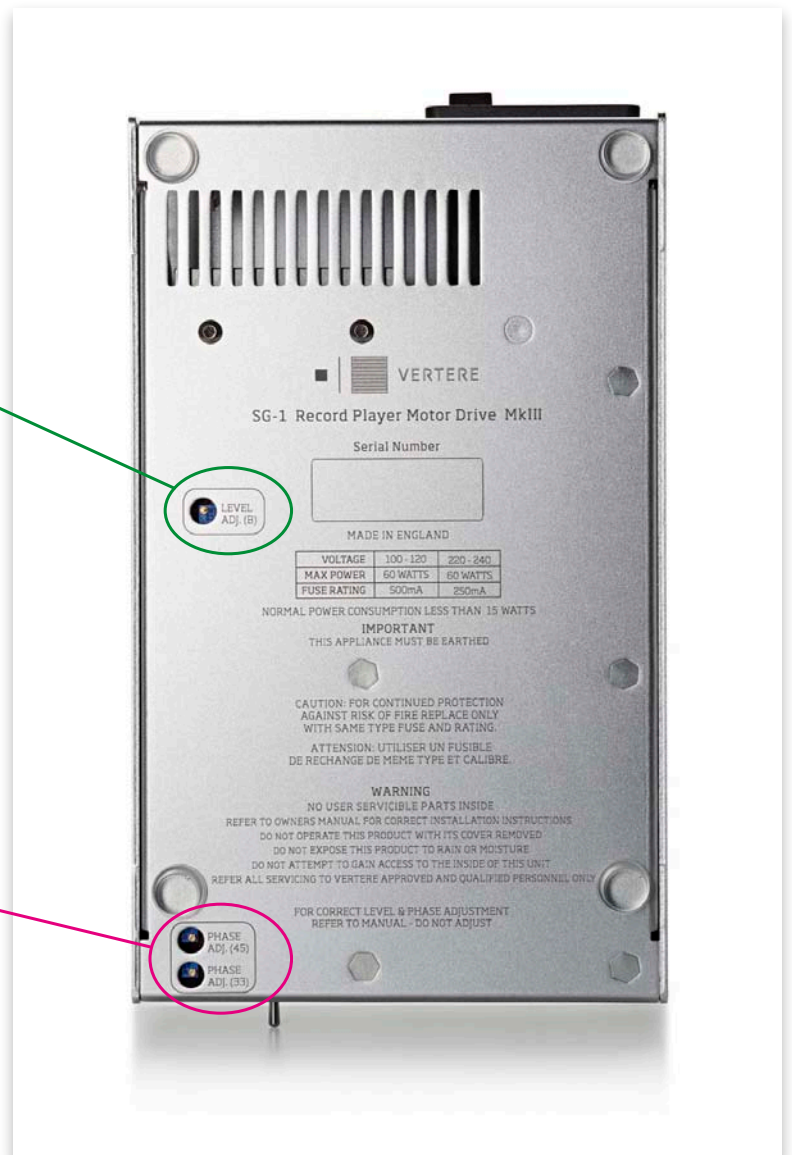

## Motor Noise Fine-tuning Procedure

Connect the motor drive to the record player and select **33** rpm and let it run for approximately 10 minutes to allow the unit to get to operating temperature and internal voltages to settle down.

To fine-tune and minimise motor noise to achieve optimum performance, you will require a small Pozi or Flat screw driver suitable for the internal pots as shown below.

Place your finger gently on motor body as shown in the picture to feel the 'noise'/vibration of the motor while driving the platter.

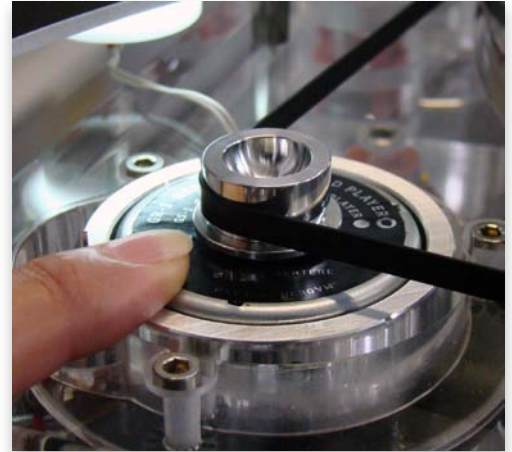

## Fine-tune Adjustment for **33** rpm

**A** In **33** rpm, adjust **P1** by gently turning it clockwise and then anti-clockwise as shown opposite.

While turning the pot you will feel the motor vibration go through a minimum and then increase again. Slowly home in on the minimum noise position by keep going past it on either side and reducing the adjustment span.



**B** Now locate **P4** and further adjust as above for minimum motor noise. Again homing in on the minimum noise position by going past it either way and reducing the adjustment span.

**C** Now repeat **A** and then **B** for a couple of more times to home in on lowest noise point.

The SG Motor Drive is now fine-tuned for minimum motor noise in **33** rpm.



## Fine-tune Adjustment for **45** rpm

Now select **45** rpm and locate **P2**. Again using your finger to feel the motor vibration, adjust **P2** as above to minimise the noise in 45 rpm.

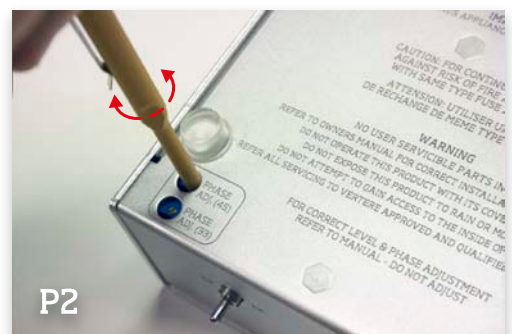

**NOTE:**  
MkIII version has Multi-turn Pots accessible from the underside of the unit that require a trimmer tool.

# User Manual

- 1 Motor Drive Output Socket
- 2 Mains Voltage Label
- 3a Mains Power Switch
- 3b Mains Fuse Holder
- 3c Mains Power Input Socket

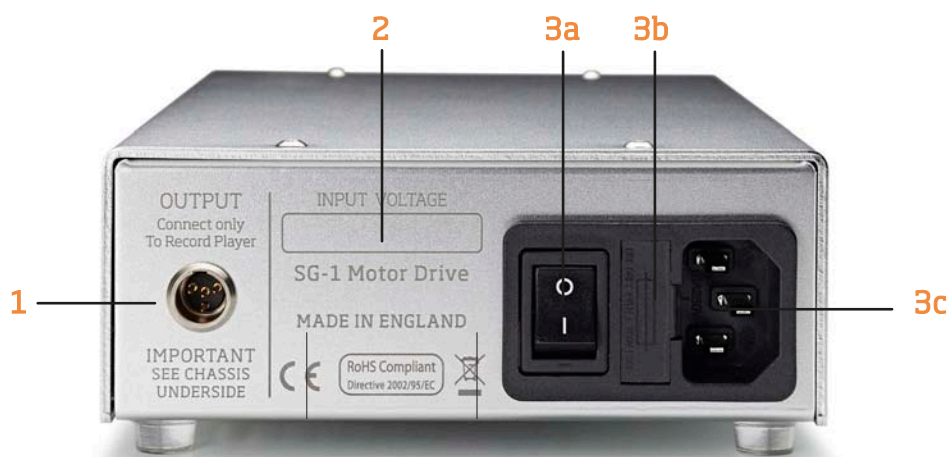

- 5 Power Indicator LED
- 6 Speed Indicator LED
- 7 RPM Selector Switch



## Connecting Motor Drive To Record Player

Carefully attach the supplied motor drive cable to the output socket (1) on the rear of the unit. Please observe polarity - see below.

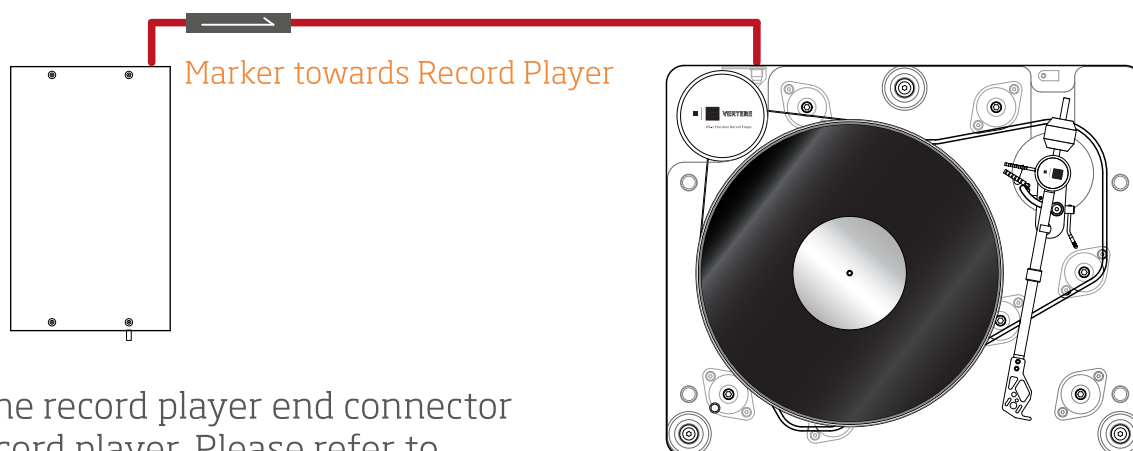

Connect the record player end connector to your record player. Please refer to your record player user manual.



## Specifications

SG Motor Drive P/S \_\_\_\_\_ Precision Crystal Referenced  
Input Voltage \_\_\_\_\_ 100 - 120 Or 220 - 240 Vac 50/60 Hz  
Output Voltage (Motor Drive) \_\_\_\_\_ 20.5 Vac  $\pm$  Vac rms (33 & 45)  
Two Phase Supply \_\_\_\_\_ 90° (Adjustable)  
Output Voltage (LED Power) \_\_\_\_\_ 12 Vdc (Fixed)  
THD+N \_\_\_\_\_ < 0.1%  
Power Consumption \_\_\_\_\_ < 60 Watts Max.  
Dimensions \_\_\_\_\_ 125 x 220 x 52 (WxDxH)mm

All specifications are liable to change without prior notice. E & OE

Made in England



VERTERE™

### RECORD PLAYING SYSTEMS

RG-1 Reference Groove Record Player  
SG-1 Super Groove Record Player  
MG-1 Magic Groove Record Player  
DG-1 Dynamic Groove Record Player

### MOTOR DRIVES

RG-1 Reference Motor Drive  
SG-1 MkIII Super Groove Motor Drive

### TONEARMS

Vertere Reference Tonearm **New Gen.**  
SG-1 MkII Tonearm PULSE-HB Internal Wiring  
SG-1 MkII Tonearm Standard PULSE Internal Wiring

### PHONO CARTRIDGES

**Mystic** Moving Coil Cartridge

### PHONO PREAMPLIFIER

PHONO-1 MkII

### ANALOGUE INTERCONNECT CABLES

PULSE-HB  
PULSE-R  
PULSE-**Redline**  
D-Fi  
RCA, XLR Balanced, DIN & 5-Pin Tonearm

### SPEAKER CABLES

PULSE-HB  
PULSE-XS Reference  
PULSE-XS  
PULSE-XminiS  
D-Fi  
7mm, 4mm Banana & Spade - Single Ended Or Bridged Balanced

### DIGITAL INTERCONNECT CABLES

PULSE-HB  
PULSE-R  
D-Fi  
USB TypeA, TypeB, Mini, Micro, Ethernet RJ45  
COAX-75 Ohm RCA & BNC, AES/EBU Balanced XLR

### MAINS POWER CABLES & DISTRIBUTION

PULSE-HB & HB MAINS DISTRIBUTION BLOCK  
PULSE-**Redline**  
UK, EU, US: IEC & IEC 20A

### RECORD PLAYER SUPPORT

STAGE-1 REFERENCE ISOLATION PLATFORM

### EQUIPMENT SUPPORT

STAND-1 REFERENCE EQUIPMENT SUPPORT



5 Oliver Business Park Oliver Road London NW10 7JB UK  
T +44 (0)20 3176 4888 E info@vertereacoustics.com

vertereacoustics.com

Printed In England

All specifications are liable to change without prior notice. E & OE