



Bolechow Stryj Synowodsko Wyzne

Once thriving municipalities populated by thousands of Jewish people. This area was once the home to our families.

For more than sixty years, the Jews have not been a part of Bolechow or the nearby communities. August, 2009 descendents of Bolechow and nearby will travel from all over the world to honor our ancestors and to see how and where they lived. We will honor the lives of our parents and grandparents and we will remember and honor those who were brutally killed.

For many on the trip, this will be the first visit to a land where our families thrived for generations. For others it will be a trip of remembrance of times long past.

It is our hope that sixty years from now, people will continue to understand how the actions of a small group of people enabled the memories of the Jewish community in Bolechow to live forever.

We thank all who will be returning to Bolechow and the region with us and all who in their way made this extraordinary trip possible. Welcome home!



BOLECHOW JEWISH HERITAGE SOCIETY

*Cordially invites you to join us
At the Dedication of the new wall
and Memorial Plaque at the
Bolekhiv Jewish Cemetery
August 18, 2009 at 10:15 in the Morning*



*At the Dedication of a Memorial Plaque
At the site of the former DKA House
In Bolekhiv
August 19, 2009 at 10:15 in the morning*



*At a Memorial Service and
The Dedication of a new Memorial Plaque
At the site of the mass grave
In the Taniava Forest
August 19, 2009 at 11:15 in the morning*



*At Dinner
Oasis, Bolekhiv
August 19, 2009 at 19:00 in the evening*



Please respond regarding your attendance at each of the above to:

infobolechow@aol.com

Or to Mr. W. Lutsyk (Bolekhiv Municipality) at 343734455



Hosted by:

*Bolechow Jewish Heritage Society
The ex-Bolechow Immigrants in Israel
Bolekhiv Municipality*

Bolechow

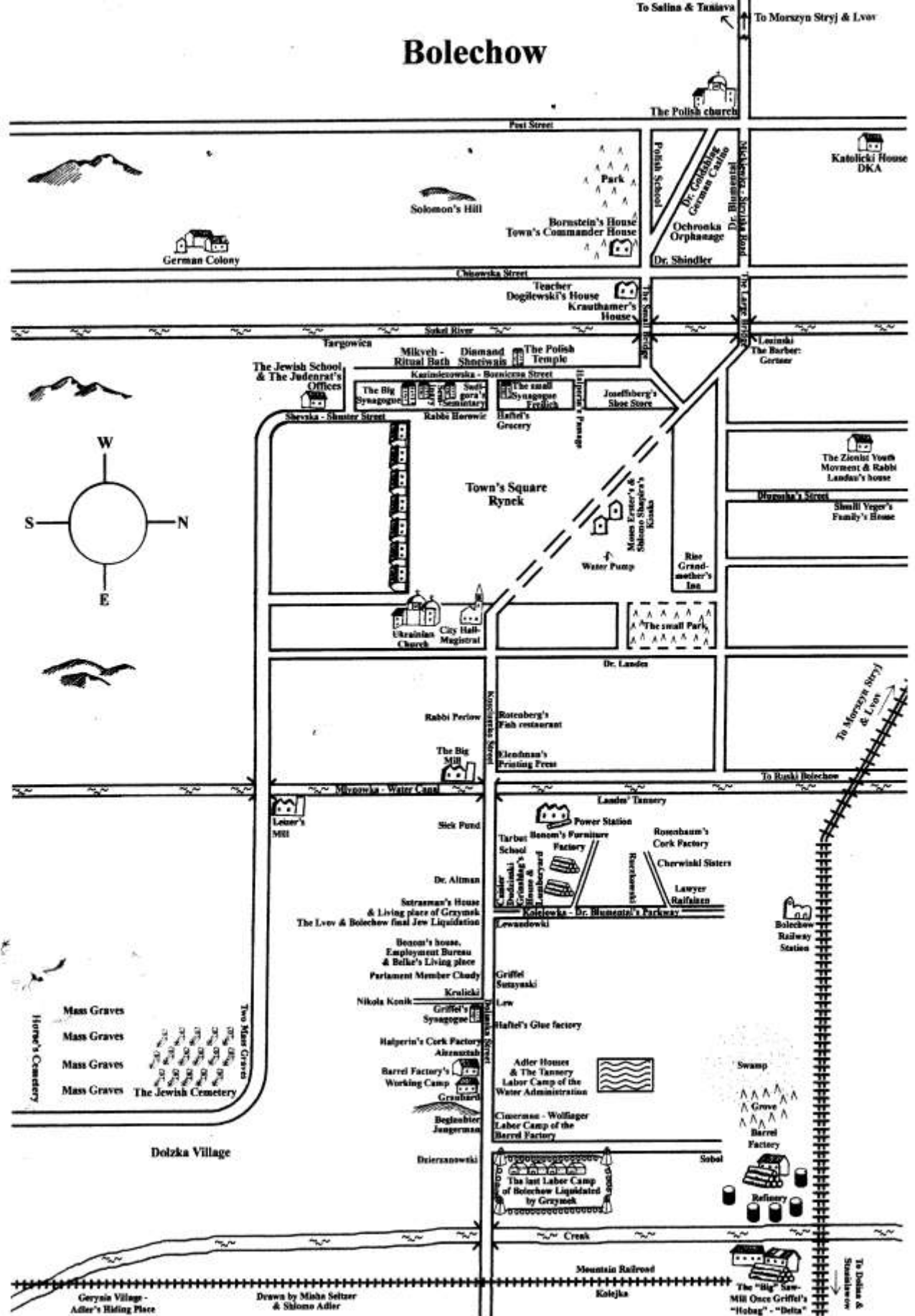

The Town (Not to scale and details based on memory may be updated after visit)

The Streets Of Bolechow

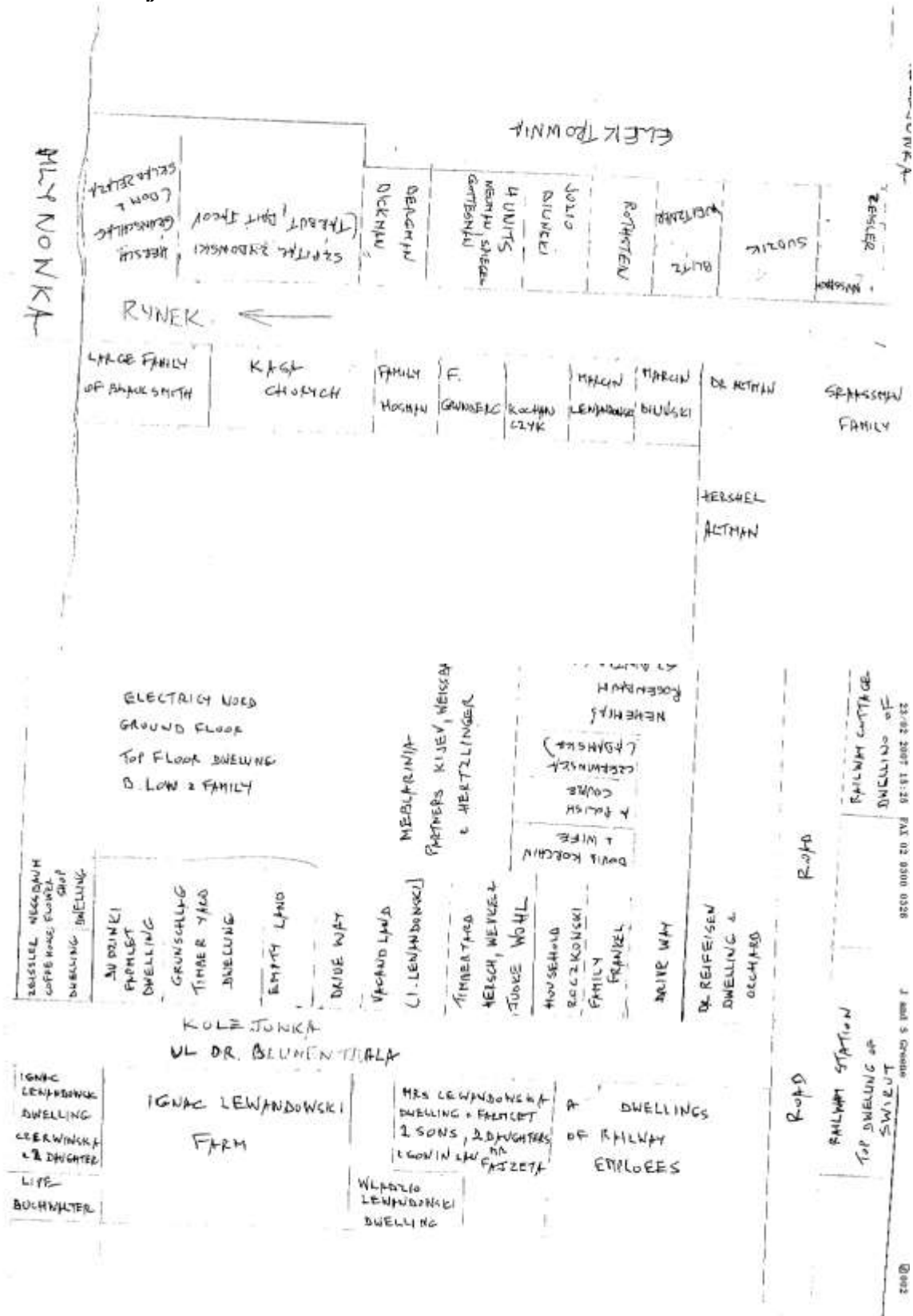

*The Bolechow Cemetery and
Taniawa Mass Grave
(photos taken between 1996 – 2003)*



The old Jewish cemetery dates from the end of 16 century at the time of the first Jewish settlement The most well known grave is that of Dr. Dov Ber well-known to Jewish historians.

Taniawa Mass Grave

Almost 1000 Jews were killed here in the first Akcja in Bolechow October 28 and 29, 1941. The photograph was taken in August 1996. Also shown is text of original plaque.

НА ЧЕСТЬ ТА ПАМ'ЯТЬ ЖИТЕЛІВ
БОЛЕХОВА ТА ОКОЛИЦЬ,
ЯКІ З ПОГРОЗОЮ ДЛЯ ЖИТТЯ
ДОПОМАГАЛИ І ВРЯТУВАЛИ
ЄВРЕІВ ВІД КАТАСТРОФИ ПІД
ЧАС ФАШИСТСЬКОЇ ОКУПАЦІЇ
1941 – 1944 р.р.

ОБ'ЄДНАННЯ ВИХОДЦІВ З БОЛЕХОВА ТА ОКОЛИЦЬ



לכבוד ולזכר
בני בולחוב והסביבה
אשר בגבורתם תוך סיכון חייהם
עזרו והצילו יהודים מהשואה
בזמן הכבוש הנאצי 1941 – 1944
ארגון יוצאי בולחוב והסביבה



IN HONOR AND REMEMBRANCE
UKRAINIANS AND POLES
WHO ENDANGERED AND SACRIFICED
THEIR LIVES IN THE HEROIC EFFORT
TO HELP AND SAVE JEWISH PEOPLE
OF BOLECHOW & VICINITY
DURING THE NAZI OCCUPATION 1941-1944
ASSOCIATION OF EX-BOLECHOWER JEWS

JULY 1996

ЛИПЕНЬ 1996

אב תשנ"ו



DKA House

Trip Schedule

Monday, August 17, 2009

- | | |
|---------------|-------------------------------|
| 7:00 – 8:45 | Breakfast on own at hotels |
| 9:00 – 17:00 | Guided Tour of L'viv |
| 17:00 –19:00 | Personal Time |
| 19:00 – 21:00 | Welcome Dinner at Hotel Opera |

Tuesday, August 18, 2009

- | | |
|---------------|---|
| 7:00 – 7:45 | Breakfast on own at hotels |
| 8:00 – 9:45 | Drive to Bolechow |
| 10:15 – 10:45 | Wall Dedication Ceremony at Jewish Cemetery |
| 10:50 – 11:20 | Memorial Service at Mass Grave site inside Cemetery |
| 11:25 - 13:00 | Photography and note-taking inventory in Cemetery |
| 13:15 - 14:00 | Group Lunch at Oasis Restaurant |
| 14:05 - 14:30 | Visit to Synagogue - note entry may not be possible due to condition of structure |
| 14:40 - 17:00 | Tour of Region including Village of Gerynia and the Jewish streets of Bolechow |
| 17:15 - 20:00 | Return to L'viv |
| Evening | Dinner on your own |

Wednesday, August 18, 2009

- | | |
|---------------|---|
| 7:00 – 7:45 | Breakfast on own at hotels |
| 8:00 – 9:45 | Drive to Bolechow |
| 10:15 – 10:40 | Ceremony at former DKA House |
| 10:50 – 11:50 | Memorial Ceremony at Taniava Forest Mass Grave Site |

| | |
|---------------|---|
| 12:00 - 13:00 | Visit to Town Museum and Library |
| 13:00 - 13:45 | Group Lunch at Oasis Restaurant |
| 14:00 - 15:30 | Return to Cemetery to continue inventory |
| 15:30 - 18:45 | Tour of Region including Villages of Knieszoluka, Vitvica, Stankowice, Rostoczki and Kalna and more of the Jewish streets of Bolechow |
| 19:00 – 21:00 | Group Dinner with Invited Guest at Oasis in Bolechow |
| 21:15 - 23:00 | Return to L'viv |

Thursday, August 19, 2009

| | |
|---------------|---|
| 7:00 – 8:45 | Breakfast on own at hotels |
| 9:00 – 9:45 | Drive to Stryj |
| 10:00 – 12:30 | Tour of Jewish Sites of Stryj |
| 12:45 – 13:15 | Drive to Synowodsko Wyzne and have Box Lunch on Bus |
| 13:15 - 14:00 | Tour Synowodsko Wyzne Adlersberg (Wolf) Family home |
| 14:00 – 14:45 | Drive to Drohobycz |
| 15:00 – 16:30 | Tour Jewish Sites of Drohobycz |
| 16:45 - 18:15 | Return to L'viv |
| Evening | Dinner on your own |

Friday, August 20, 2009

| | |
|-------------|--------------------------------------|
| 7:00 – 8:45 | Breakfast on own at hotels |
| 9:00 - | Group Tour to be arranged |
| 9:00 | Carpathian Excursion to depart L'viv |

Saturday, August 20, 2009 - Open Day

| | |
|-------|-----------------------|
| 19:00 | Group Farewell Dinner |
|-------|-----------------------|



This Family Tree was the connection and the book “The Lost” gave us the momentum to create the Bolechow Jewish Heritage Society as a U.S. based non-profit organization to preserve the Jewish heritage of the region while it is still possible to gain understanding from those who were born and lived there prior to World War II and to provide a focal point for those doing genealogical and historical research about the town and surrounding region.

The Bolechow Jewish Heritage Society was founded in February 2007 by Daniel Mendelsohn, Susan Turnbull and Shlomo Adler with Bruce Turnbull serving as General Counsel. We increased the Board in 2008 with the addition of Board Members Laurence Kirsch, Fred Fogelson and Michael Turteltaub.

On behalf of the Board of Director of BJHS we welcome you on this trip and hope that your visit is one that meets brings you and your family closer to those who came before us.

www.bolechow.org

The Participants

The Adler Family of Bolechow

Josef Adler

What is your connection to Bolechow?

I was born in Bolechow & lived there until I was 14 years old

Do you have connections with others who are on the trip?

My cousins Shlomo and David Adler, Susan Wolf Turnbull and Paul Wolf

Have you been to this area before?

Born in Bolechow

I am a Holocaust survivor, living in Israel. I participated in the independence war for Israel. I live in Haifa with my wife Ilana.

Traveling from Israel

Shlomo Adler

What is your connection to Bolechow?

I was born in Bolechow & lived there until I was 14 years old

Do you have connections with others who are on the trip?

My son David, My cousins Josef Adler, Susan Turnbull, Paul Wolf & Joan Adler

Have you been to this area before?

Visited in 1996 and 2003

*I am a Holocaust survivor, living in Israel since 1947. Participated in the independence war for Israel. Worked many years for El Al Israel Airlines. Established my own company. Since 1993-4 I am the head of the "Ex Bolechow Immigrants in Israel"
I have written a book*

Traveling from Israel

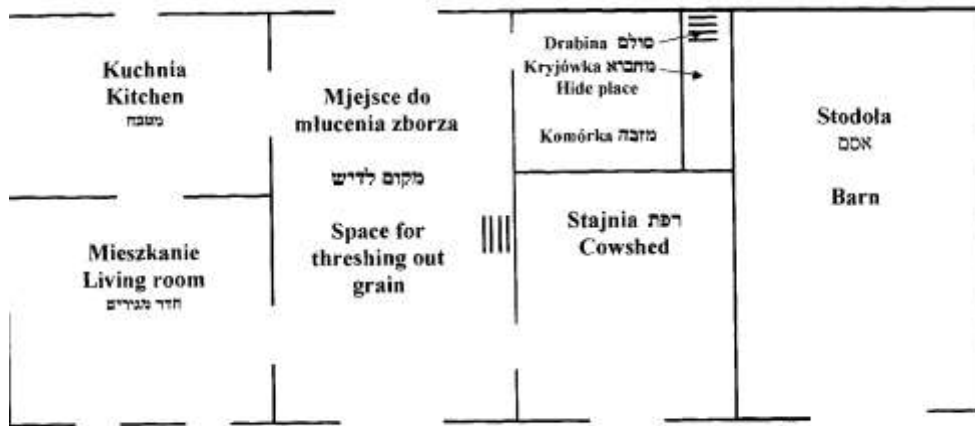

Above is a floor plan of Shlomo and Josef Adler's hiding place.

David Adler

What is your connection to Bolechow?
My father, Shlomo Adler

Do you have connections with others who are on the trip?
Shlomo Adler – father Josef Adler -cousin

Have you been to this area before?
Yes, in 2003

I'm the son of Shlomo Adler, a survivor of the Holocaust. I am an Airplane technician posted recently in Dallas, Texas. I am 47 years old and married with two children.

Traveling from Israel

Bracha Alterovits

What is your connection to Bolechow?

My great grandparents Abraham Zlman and Sabina Strahal had a store in Bolekhov. Their pictures are below. They died before the war. They were born in Rozdole and moved to Bolechov where my we believe my grandmother and my father were born. My father is named after his grand father Abraham.

My other great grand parents are Shaie and Eida (Eitta) Ellner. They lived in "ruski Bolechiov" and are probably buried in one of the mass graves.

Do you have connections with others who are on the trip?

I know Shlomo Adler and the Elnekaves

Have you been to this area before? No

All of my grandfather's sisters and brother vanished in the war and we don't have a clue where.

My grandmother lost three sisters who vanished. My father grew up in a poor family, my grandfather was a "balegule". During the war they ran away into Russia arriving in Asian Russia and living through the mercy of workers in "kochozes" agricultural settlements. When they came back to a ruined Bolechov, my grand parents were separated and my grandmother stayed in Bolechov with my eldest aunt. My father and his other sisters moved with their father to Ivano Frankivsk,

In 1956 our family decided to immigrate to Israel, they had the right as ex-polish citizens to do it via Poland. I was born during the two years while they waited for the permit papers. In August 1960 we came to Israel.

I hope I'll find to find my great grandparents graves. I also hope we will be visiting Rozdole.

More stories will be told when we meet.

Traveling from Israel



Ilana, Mordehai(Moti) and Barak Elnkave

What is your connection to Bolechow?

Ilana's parents, Avraham Weber & Matilda Strasman-Weber were born in Nadvurna in 1911 and their family moved to Bolechov after World War I in 1919. They came to Israel in 1933 -34.

Do you have connections with others who are on the trip?

We know Shlomo Adler, Bracha Alterovitz, Osnat Steinberger

Have you been to this area before? No

Ilana: I am 67 years old, married to Moti and live in a community village named Yuvalim. I was a teacher. I have 3 children and 4 grand children.

Moti: I am 66 years old. I am an industrial engineer and now work in a college.

Barak: I am 39 years old, I am a guide for Feldencrize and deal with Music

Traveling from Israel

Bill and Ellen Gottdenker

What is your connection to Bolechow?

Bill's grandfather, Morris Gottdenker, was born in Bolechow and emigrated to the US around 1900.

Do you have connections with others who are on the trip?

Not that we know

Have you been to this area before?

Closest has been Hungary

Bill is a retired from a New York City brokerage firm. He worked exclusively with municipal bonds. Ellen is a learning consultant with a private practice dealing with assessments of individuals with learning disabilities. Ellen and Bill have two children, a son, 28, and a daughter, 25. We live in a New Jersey suburb of New York City. Bill's nephew, David, is the family genealogist. David's involvement with the Bolechow society has resulted in the discovery of another branch of the family living in Krakow and Paris.

Traveling from U.S.A.

The Haftel Family

Giselle Haftel

What is your connection to Bolechow?

My grandfather Jacob Haftel (z'l) was born in Bolechow. Matilda Gelernter Haftel (z'l) (witness account in "The Lost") was his sister.

Have you been to this area before?

No

I was born in Lima, Peru. I have been living in the USA since early 1986. I now live in Denver, CO where I work as a nutritionist. I am very interested in Holocaust history and in making sure the world does not forget.

Traveling from U. S. A.

Esther Haftel

What is your connection to Bolechow?

Jacob Haftel (z'l) was my father in law. He was born in Bolechow in 1909. Matilda Gelernter Haftel (z'l) (witness account in "The Lost") was his sister.

Have you been to this area before? No.

I was born in Lima, Peru where I lived until early 1986. Since then I live in Miami where I do real estate.

Traveling from U. S. A.

Michel Haftel

What is your connection to Bolechow?

My father Jacob Haftel (z'l) was born in Bolechow in 1909. Matilda Gelernter Haftel (z'l) (witness account in The Lost) was his sister.

Do you have connections with others who are on the trip?

My wife and my daughter Giselle.

Have you been to this area before?

No

I was born in La Paz Bolivia in 1948. I live with my immediate family in the USA since 1986. I work with fresh and frozen fruits and vegetables from Peru and export groceries and food products to Peru.

Traveling from U. S. A.

Harriette Hinderstein

What is your connection to Bolechow?

My mother was born in Bolechow in 1909. The Goldfisher family all came from Bolechow. .

Do you have connections with others who are on the trip?

Will be traveling and sharing hotel with Joan Adler.

Have you been to this area before? No

I am a retired High School teacher and former Peace Corps Volunteer from New York and now living in Los Angeles. I enjoy reading, tennis, golf and researching my family trees, and particularly in this case, my mother's birthplace – Bolechow. I am researching Goldfisher, Rheinhart

Traveling from U.S.A.

Larry Kirsch

What is your connection to Bolechow?

My father was born in Bolechow in 1911. My grandfather left to the US when my father was about a year old, trying to earn enough to bring my grandmother and my father over to the US. They were separated by World War I. Somehow they found each other after the war, and my grandmother and father left to the US in 1921 and were reunited with my grandfather. I strongly suspect that each of my grandparents left siblings behind when they came to the US. My grandfather's family name was Kirschenbaum, but my father later shortened the name to Kirsch in the US. My grandfather's mother's family name was Zirklus. My grandmother's family name was Friedman, although I have seen some references in documents to the name as Friedlander. My grandmother's mother's family name was Landmann.

Do you have connections with others who are on the trip?

Friend of BJHS Board members.

Have you been to this area before? No.

I am an environmental lawyer with a developing side interest in genealogy. I am married to another lawyer, Celia, and we have two children, ages 20 and 17. My 20-year old daughter Rachel is a math major at the University of Maryland Honors Program and my 17-year old son Max will be beginning at Brown University this fall. My grandmother (family name Friedman, although I have seen some references in documents to the name Friedlander; her mother's family name was Landmann) was born in Kalna in 1888, near Bolechow, and I believe that my grandfather (family name Kirschenbaum; his mother's family name was Zirklus) was born in Rozdo'l in 1884 and moved to Bolechow. My grandmother's mother's name was Landmann. I have one sister who is 17 years older than I am, so my parents and grandparents were relatively older than parents of many other people my age. My mother's side of the family was from Kiev and Odessa.

Traveling from U.S.A.

Stanley Ostern

Connection to Bolechow:

Born in Stryj 1935. Survived the Stryj ghetto. Went into hiding in a bunker in Stryj with 35 people 1942-1944. You can hear my story by googling "Stan Ostern" then clicking on the first entry (my hero) it's a 12 minute film. Also I have a web site for Stryj- go to www.jewishgen.org click shtetel stryj

Connections with others who are on the trip?

I have developed a friendship with Bruce and Susan Turnbull –possibly related?

Have you been to this area before?

Left Stryj in 1944 – No, not recently.

Came from Europe to us in 1946. Retired physician. Graduated New York Medical

College in 1960- next year will be 50 years since graduation. Lived in NYC until 1964. US Air Force Captain medical corp 1964-66 . Practiced in Santa Barbara for 32 years. Six children, ten grandchildren. Involved with the Jewish Federation in Santa Barbara. We have a unique program working with kids " at risk". Also we have a pictorial exhibit of holocaust survivors-called portraits of survival. On the board of ADL. I recently discovered that I have a half-brother in Poland that I did not know I had.

Traveling from U.S.A.

Anatol Regnier (No information submitted)

Traveling from Germany

Serene Seebol

Connection to Bolechow:

My grandfather and his family is from Bolechow

Connections with others who are on the trip?

My cousins from Israel will be coming on the trip, Margo and Amiel Schotz

Have you been to this area before? No

I have gotten involved in searching out my heritage since reading Daniel's book. I am very interested in finding out what happened to a great Aunt that was sent back to Bolechow after trying to enter the US in the early 1900's. I am looking forward to this trip, and hope to meet some interesting people that have similar interests in looking for their family roots.

Traveling from U.S.A.

Margo Tepper-Schotz & Amiel Schotz

What is your connection to Bolechow?

Amiel: My wife's father's family came from Bolechow.

Margo: My grandfather's family came from Bolechow.

Do you have connections with others who are on the trip?

Yes, Serene Seebol is Margo's cousin. Serene and Margo's grandfathers were brothers.

Have you been to this area before?

Neither of us have been to this area.

Amiel: My father was born in Estonia and went to Scotland in 1912. He became a sculptor and head of the Sculpture Dept. in the Glasgow School of Art. I made aliya in 1965 and taught university for many years. I am an actor, poet, folk singer, and teacher. My daughter, Avigail, lives and works in Los Angeles.

Margo: My father's family comes from Bolechow, although my grandfather immigrated with his family to the States in the early 1900s. After I made aliya in 1973, I was always in contact with Shumik and Miriam Reinhartz, my cousins from Bolechow, since, I, too, lived in Beer-Sheva. After reading Daniel's book, I was made more aware of what happened in Bolechow, although Miriam had told her story of survival to us for my daughter's 7th grade "Roots" project many years ago (my daughter is now 32 and living in England with her husband). I was a learning disabilities specialist in Israel and then an English language editor/Hebrew to English translator/grant writer for Bedouin researchers and the Bedouin Center at Ben-Gurion U. in the Negev. I have just retired.

Traveling from Israel

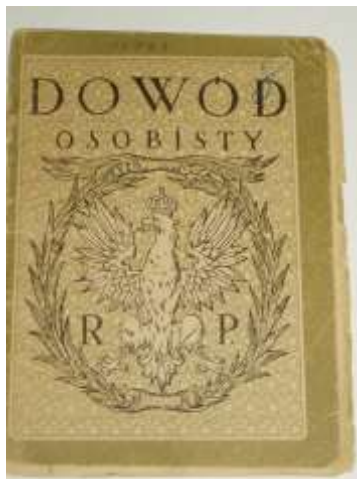

Typical Polish Passport post World War I

Menachim and Osnat Steinberger

What is your connection to Bolechow?

My grandfather family is from Bolechow – Kornbluh, David

Do you have connections with others who are on the trip?

I know Shlomo Adler and Ilana Elnekawe

Have you been to this area before? Yes, in 2006

My name is Osnat Steinberger- Kornbluh. My grandfather David Kornbluh was born in Bolechow, all his family lived there and most of them died in the holocaust there.

I was born in Poland in 1956 and immigrated to Israel in 1957 with my parents. My father was Jacob Kornbluh- he died in Israel in 1996.

I now live in the Galilee near Haifa. I am an artist and an art teacher. After being in Bolechow I have created a series of art works about the Bolechow cemetery and the memory of the Kornbluh family. My works have been exhibited in several exhibitions in Israel. I will be showing a presentation about my works to tell you about the cemetery and the unique tombstones there according to a research project that was done in recent years.

My husband is an accountant and we have three daughters: Two of them are in Tel Aviv now and our youngest is serving in the army.

Traveling from Israel

Yael Tal

What is your connection to Bolechow?

My father was from Bolechow and my mother from Lvov.
Shlomo Mehring and Nelly Graubard (her youth name).

Do you have connections with others who are on the trip?

I got acquainted with Shlomo Adler recently as he was in connection with my father.

Have you been to this area before? No.

I was born in Poland, Warsaw in 1956. In 1957 my parents, my brother and I immigrated to Israel. My father died 12 years ago but my mother is still alive. Today, I live in Haifa. I have 3 children, two of them are students and the younger is still in high school. I'm a classical guitar teacher and also help my husband in his business.

Traveling from Israel

The Turnbull/ Wolf Family

Bruce Turnbull

What is your connection to Bolechow?

Shlomo and Josef Adler are my wife's cousins and my wife's extended Adlersberg family lived in Bolechow.

My father-in-law was born and grew up in nearby Synowodsko Wyzne

Do you have connections with others who are on the trip?

Yes, my wife Susan and our sons Josh and David Turnbull, my Brother-in-law and Sister-in-law Paul and Helen Wolf and Shlomo and Joseph Adler are relatives. We also know most participants through correspondence about this trip

Have you been to this area before? Yes, in 2003

I am Susie's husband and Josh and David's father. Susie and I met in 1974, when we both worked for the late Senator Howard Metzenbaum. We were married in 1976 in the same synagogue and by the same Rabbi and Cantor who married Susie's parents. I was born in Iowa City, Iowa in 1951 and moved with my family to Columbus, Ohio in 1965. I am a partner in the law firm of Weil, Gotshal & Manages LLP, where I have worked since 1979. My practice is

focused on technology policy issues, mainly representing Panasonic. I graduated from Cornell University and George Washington University Law School. My interest in genealogy -- and, hence, Galician Jewish history -- is driven both by a desire to help Susie and our sons discover their family heritage and by my long interest in history more generally.

Traveling from U.S.A.

David Turnbull

Have you been to this area before? Yes, in 2003

I grew up in Bethesda, Maryland – just outside of Washington DC and graduated from Dartmouth College in New Hampshire in 2004. During my time in University, I studied for a semester in Prague, directly after which was the first opportunity for my parents and me to travel to Galicia. Since graduating, I have worked in various environmental organizations in Washington DC. I worked at the World Resources Institute, an environmental think tank, for two years helping to coordinate an international network of organizations in over 40 countries working to improve public participation in environmental decision-making around the world. For the past three years, I have changed my focus to efforts to address climate change. I served for two years as Communications Director of the US Climate Action Network, working to coordinate media and outreach efforts of over 70 organizations in the US. Since October 2008, I have served as Director of the Climate Action Network – International, a network of close to 500 nongovernmental organizations in over 70 countries around the world, focused on the United Nations climate change negotiations.

Traveling from U.S.A. via Germany

Josh Turnbull

Have you been to this area before? No

I grew up in Bethesda, MD, just outside Washington DC. I graduated with a Business Management degree from Indiana University in 2002. Upon graduation I moved to Sacramento, California where I completed a year of Americorps work. Following that I worked for a non-profit agency that provided low-income housing for individuals in Sacramento and San Francisco. Three years ago I came back to the DC area and now work as a Commercial Property Manager in Northern Virginia, where I manage about 1.5 million square feet of space. This will be my first trip to the region and I will be joining my parents, Susan and Bruce and my brother, David, on the trip.

Traveling from U.S.A.

Susan Wolf Turnbull

Have you been to this area before? Yes, in 2003

After visiting Ukraine in 2003, I discovered my relationship to Shlomo and Josef Adler. Our grandmothers were first cousins. Shlomo and Josef are the only known survivors of my father's family that had remained in the area after my father emigrated in 1925. My father lost two sisters, their families and approximately 100 members of his extended family during the war. He rarely spoke of his childhood prior to his death in 1983. The research we have done with our sister-in-law Helen Wolf has led us back to Bolechow and to Synowodsko Wyzne. Our

grandfather Zallel Wolf's birthplace Kolachava is the driving force to our trip to the Carpathian Mountains.

*I am a consultant to several Congressional offices. I serve as Chair of the Maryland Democratic Party and Chair of the Board of Trustees of Jewish Women International.
I recently joined the Board of Hillel: The Foundation for Jewish Campus.*

I am thrilled to share this amazing experience with our sons and brother and sister-in-law and look forward to getting to know all the adventurers joining us on this wonderful trip.

Traveling from U.S.A.



Wolf Family

Helen F. Wolf

What is your connection to Bolechow?

I am Susie & Bruce Turnbull's sister-in-law.

Shlomo and Josef Adler are my husband's cousins and the Adlersberg family had family in Bolechow. There may be some family buried in the cemetery.

Do you have connections with others who are on the trip?

Yes. See above plus my nephews Josh and David Turnbull

Have you been to this area before? No

I have been researching the Wolf/Adlersberg family for many years as well as other branches of both my husband and my family trees. I have been looking forward to doing this trip for over three years when it was first suggested to go to Synowodzko Wyzne to commemorate the 100th birthday of my husband's father. I am looking forward to this experience very very much.

Traveling from U.S.A.

Paul Wolf

What is your connection to Bolechow?

Father (Sol Wolf) grew up in Synowodzko Wyzne, nearby to Bolechow.

Cousin to Shlomo & Josef Adler.

Do you have connections with others who are on the trip?

Brother of Susie Turnbull
Brother-in-law of Bruce Turnbull
Uncle of Josh & David Turnbull
Cousin of Shlomo & Josef Adler

Have you been to this area before? No

I'm 62, mostly retired as a traffic engineer. I grew up in Cleveland, Ohio, which is my current home. I have 2 married children, Howard Wolf, who lives in Cleveland, with his wife Marla, and their 2 children - Rachel (2) and Samuel (5 months), and Deborah Goldsmith, who lives in Alon, Israel, with her husband Josh, and their 3 children – Yael (6), Kerem (3) and Shai (6 months).

Traveling from U.S.A.

Tomasz Wasilewski and Christine Larre-Larrouy

What is your connection to Bolechow?

Several generations of my father's family originated from Bolechow

Do you have connections with others who are on the trip?

Yes, I will be traveling with my wife Christine Larré-Larrouy and know Shlomo Adler

Have you been to this area before? Yes, most recently earlier this year

The family of my father originated from Bolechow where my great-grandfather Ferdynand Wasilewski settled down in 1840 and my grandfather Wiktor spent all his life working as a clerk at the "Salina" until 1919-20. My father Marian was his younger son and was born in 1912. He told me a lot about his youth spent in Bolechow, and on my continuous requests he wrote about it over 100 pages.

I have visited Bolechow only once in 1956. I have been living in Warsaw until 1980 when I left for France where I have been teaching Economics at the University Montpellier I. I am retired now and I am interested in the multi-cultural life of Bolechow before the Second World War. Last March I have undertaken an action to search the support to the BJHS Taniava Mass Grave Project among the Polish Bolechovers living in Poland and individuals from the different communities in present Bolechow (during my short visit in May 2009).

Traveling from France