

20
23

EMPLOYMENT SUMMIT
**NAVIGATING
BARRIERS**

December 6 - 7, 2023
502 East Event Centre
502 East Carmel Drive
Carmel, IN 46032

LEVEL UP Indiana

The Level Up Indiana Employment Summit
 December 6 – 7, 2023
 The 502 Event Centre
 Carmel, IN
 Schedule of Events

Wednesday, December 7, 2023	Day One
8:00 AM – 9:00 AM	Registration and Networking
9:00 AM – 10:30 AM	Welcome and Keynote Address
10:30 AM – 10:45 AM	[BREAK]
10:45 AM – 12:00 PM	Concurrent Session #1
12:00 PM – 1:00 PM	PROVIDED LUNCH
1:00 PM – 2:15 PM	Concurrent Session #2
2:15 PM – 2:25 PM	[BREAK]
2:25 PM – 3:40 PM	Concurrent Session #3
3:40 PM – 3:50 PM	[BREAK]
3:50 PM – 4:25 PM	Closing Session
4:25 PM – 4:30 PM	Day One Closing

Thursday, December 6, 2023	Day Two
8:00 AM – 9:00 AM	Registration and Networking
9:00 AM – 10:00 AM	Concurrent Session #4
10:00 AM – 10:10 AM	[BREAK]
10:15 AM – 11:15 AM	Concurrent Session #5
11:15 AM – 11:20 AM	[BREAK]
11:20 AM – 11:55 AM	Closing Session
11:55 AM – 12:00 PM	Summit Closing



The Level Up Indiana Employment Summit
 Concurrent Session 1 Options

	Session Topic	Presenter	Location
Concurrent Session # 1 10:45 AM – 12:00 PM	How the ADA Applies to Job Seekers with Additional and Recovery	Barry Whaley	Eller Room
	Using Discovery to Ensure Person – Centered Services	Katie Wolf Whaley	Greyhound Room
	Winning Employment Strategies: Phone a Friend for Technical Assistance	Virginia Chiaccira Joe Land Kristy Russell	Sycamore Room

Concurrent Session #1 Descriptions

How the ADA Applies to Job Seekers with Additional and Recovery

Barry Whaley

In this session, we'll explore how the Americans with Disabilities Act (ADA) applies to jobseekers throughout the employment process, starting with the application and continuing on the job. The session will cover the rights of both jobseekers and their eventual employers.

Using Discovery to Ensure Person – Centered Services

Katie Wolf Whaley

We all want to provide person-centered services but how do this in the real world? This session will engage us to think about what “discovery” means in practical ways. We will actively strategize ways to get to know people and to connect who they are with potential types of work.

Winning Employment Strategies: Phone a Friend for Technical Assistance

Virginia Chiaccira, Joe Land, and Kristy Russell

LIFE as employment specialists and program managers is challenging. Every day we are dealt new CARDS that can present unique TROUBLEs in our OPERATIONs. Policy changes, paperwork, and CARF monitoring can cause AGGRAVATION. Sometimes we don't have a CLUE which strategies will be most effective. As part of Level-Up Indiana's Coaching Network, our panel of MASTERMINDs will share the top 20 QUESTIONs they are asked during peer training. We will share WINNING strategies from billing, hiring, staff training, to discovery, job development, accommodations and job retention. Take a RISK and join us!



The Level Up Indiana Employment Summit
Concurrent Session 2 Options

	Session Topic	Presenter	Location
Concurrent Session # 2 1:00 PM – 2:15 PM	Trauma Informed Support and Employment	Karen Harvey	Eller Room
	ABLE Accounts	Emily Munson	Greyhound Room
	Discovery Debunked: Making the Discovery Process Work for You	Kara Critchlow	Sycamore Room

Concurrent Session #2 Descriptions

Trauma Informed Support and Employment

Karen Harvey

This session will explore the aspects of trauma that directly affect many individuals with disabilities. It will talk about the effects of that trauma and key ingredients for healing. Finally, there will be an emphasis on post traumatic recovery and growth through employment and employment supports.

Discovery Debunked: Making the Discovery Process Work for You

Kara Critchlow

This session will focus on several unique and multi-faceted approaches to Discovery service delivery with an emphasis on “Informal Discovery” – activities not formally arranged with an employer and how they can often be more informative and much easier to access - and how to maximize results achieved through the Discovery process overall.

ABLE Accounts: Overcoming the Benefits Cliff

Emily Munson

TBA



The Level Up Indiana Employment Summit
 Concurrent Session 3 Options

	Session Topic	Presenter	Location
Concurrent Session #3 2:25 PM – 3:40 PM	In Our Own Voices	NAMI Indiana	Sycamore Room
	Building a Collaborative Relationship With VRC	Denise Smith Steve Upchurch Martina Tovar Denise Loaring	Greyhound Room
	Assistive Technology: The Missing Link to Success in the Workplace	Josh Anderson	Eller Room

Concurrent Session #3 Descriptions

In Our Own Voices

NAMI Indiana: Steve and Linh

This presentation will change attitudes, assumptions, and ideas about people with mental health conditions. We will share a personal perspective of mental health conditions, as leaders with lived experience talk openly about what it's like to have a mental health condition. Attendees will hear open and honest perspectives on a highly misunderstood topic. You will also have a chance to ask leaders questions, allowing for a deeper understanding of mental health conditions and dispelling stereotypes and misconceptions.

Building a Collaborative Relationship With VRC

Denise Smith, Steve Upchurch, Martina Tovar, Denise Loaring

This panel presentation will provide session participants with practical strategies for building strong, collaborative relationships with VR through regular, effective communication. Through active partnership, VR and Employment Services providers can provide coordinated services and supports to help our mutual customers achieve their employment goals. This session will be interactive and allow for questions and feedback from participants.

Assistive Technology: The Missing Link to Success in the Workplace

Josh Anderson

This presentation will begin with an overview of assistive technology and how it can be implemented to accommodate individuals on the job with a myriad of needs. The evaluation process will be discussed with important considerations necessary for successful assistive technology interventions. Attendees will then be shown free apps, programs and resources that they can utilize with their individuals. Different accommodation scenarios will be presented and discussed with the audience so that they can brainstorm different accommodations in varied work settings. All attendees will be challenged to work together to solve the complex needs of individuals with disabilities on their jobs.



The Level Up Indiana Employment Summit
Concurrent Session 4 Options

	Session Topic	Presenter	Location
Concurrent Session #4 9:00 AM – 10:00 AM	Transportation and Mobility Management Network PART 1	Judy Shanley	Eller Room
	Acquired Brain Injury 101	Wendy Waldman	Greyhound Room
	Creative Business Development	Natalie Weisenbach Kristy Russell Matt Edwards	Sycamore Room

Concurrent Session #4 Descriptions

Transportation and Mobility Management Network PART 1

Judy Shanley

This session will focus on strategies to build the capacity of interdisciplinary teams, including vocational rehabilitation professionals, to identify and implement mobility services for youth. The session will include a focus on a pilot program, funded by the National Science Foundation, that educates youth about sidewalk accessibility, teaches youth advocacy skills to communicate this information to community planners, and use this knowledge to identify career opportunities. Attendees will acquire tangible Concurrent content that can be replicated within their own programs.

Acquired Brain Injury 101

Wendy Waldman

Acquired Brain injury (ABI) is a lifelong chronic condition that is frequently unrecognized and total incidence is unknown. The epidemiology of brain injury and common issues that happen after brain injury including cognitive, physical and emotional/behavioral effects will be discussed. We will also focus on strategies, accommodations and interventions specific to the most common challenges individuals with brain injury face, especially in the community and in the workforce. Participants will learn about appropriate access to supports, services and professionals that can minimize and treat complications and optimize function in these individuals. We will explore strategies for supporting individuals to assisting them to return to school, work and reintegrate back into their community.

Creative Business Development

Natalie Weisenbach, Kristy Russell, and Matt Edwards

Business development is often a challenge for many providers but crucial for job placement success. Finding creative ways to reach businesses can make the difference in building lasting relationships in your local community. Bosma Employment Services will present ways that we have been successful in reaching a larger audience and building stronger community partners through bimonthly virtual sessions, monthly podcasts, and an annual Reverse Job Fair.



**The Level Up Indiana Employment Summit
Concurrent Session 5 Options**

	Session Topic	Presenter	Location
Concurrent Session #5 10:15 AM – 11:15 AM	Employer Outreach and Engagement: Getting to Hired	Kristina Blankenship	Eller Room
	Transportation and Mobility Management Network PART 2	Judy Shanley	Greyhound Room
	Charting the Life Course: A Familial Perspective	Maya Cox	Sycamore Room

Concurrent Session #5 Descriptions

Employer Outreach and Engagement: Getting to Hired

Kristina Blankenship

This session will be a panel conversation with employers and employment specialists. We will hear about their partnerships and what made them successful and ongoing. Panelists will speak candidly and answer the following questions: What is/are the most common barriers for employers and diversity hiring? What are the best strategies for overcoming them? How do you approach an employer with a candidate when there is no job opening? What employment specialists should know when approaching employers and HR managers? Strategies for success will be given to employment specialists seeking to build on their outreach and job development skills.

Transportation and Mobility Management Network PART 1

Judy Shanley

This session will focus on strategies to build the capacity of interdisciplinary teams, including vocational rehabilitation professionals, to identify and implement mobility services for youth. The session will include a focus on a pilot program, funded by the National Science Foundation, that educates youth about sidewalk accessibility, teaches youth advocacy skills to communicate this information to community planners, and use this knowledge to identify career opportunities. Attendees will acquire tangible Concurrent content that can replicated within their own programs.

Charting the Life Course: A Familial Perspective

Maya Cox

Employment specialists work alongside the job seeker, and often family members, to navigate barriers. Charting the LifeCourse is a framework that helps structure conversations and solutions for individuals, families, and practitioners and navigate these barriers. Maya is a CtIC Ambassador, professional, and sibling and will share lessons she has learned both personally and professionally. Join this session to learn more about Charting the LifeCourse, examples of application, and a facilitated conversation in how attendees can learn more and apply the framework.

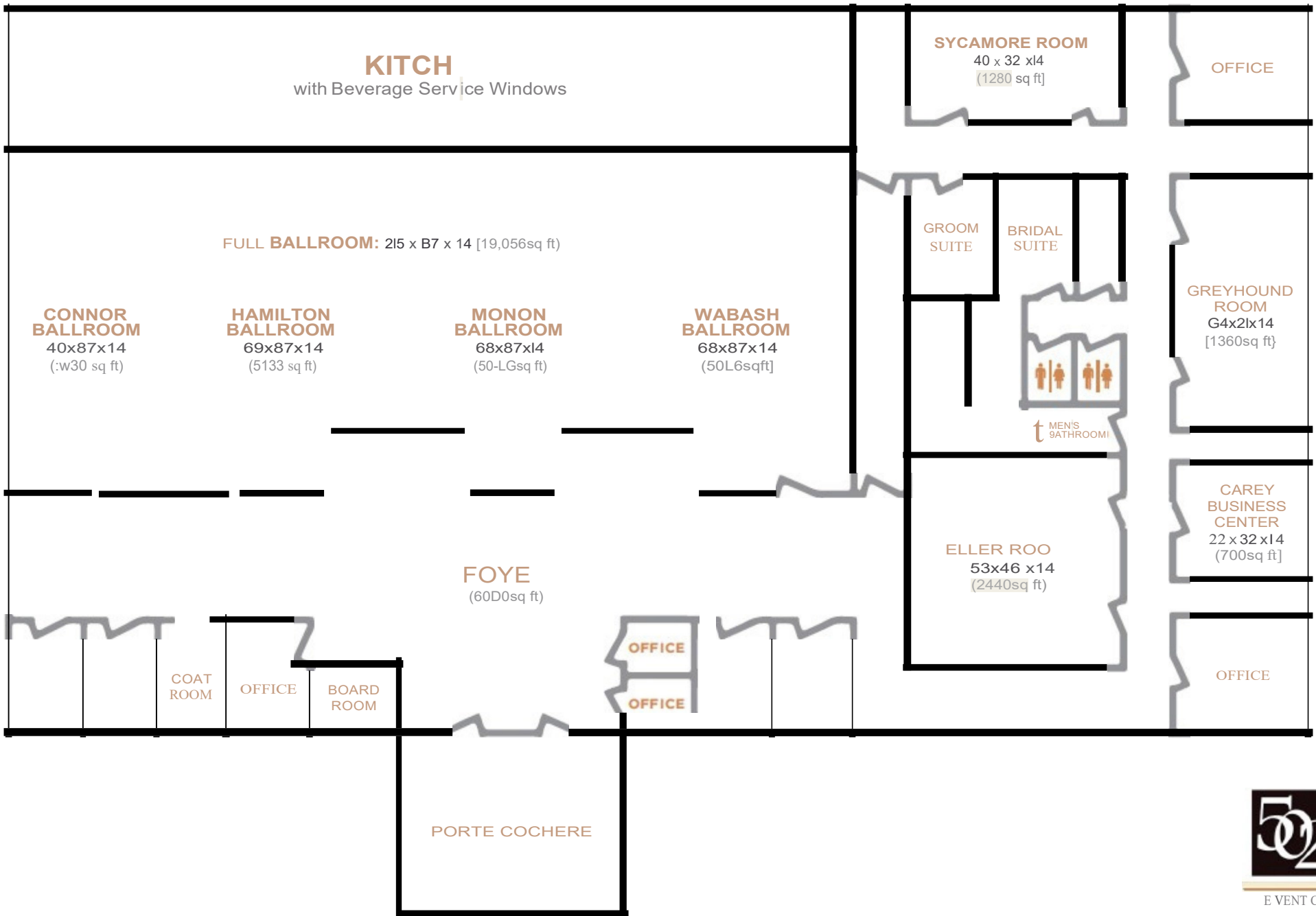



The Level Up Indiana Employment Summit
Key Note Speaker
Dr. Karen Harvey



Karyn Harvey has worked as a clinician in the field of intellectual disabilities for over 35 years. She has her Ph.D. in Applied Developmental Psychology from the University of Maryland. She has written three books: Positive Identity Development, Trauma – Informed Behavioral Interventions and Trauma and Healing. She currently does individual and group therapy with people with intellectual disabilities. In addition, she regularly conducts trainings on trauma-informed support for people with IDD, trauma-informed leadership, and trauma-informed behavioral interventions for both state and individual organizations throughout the US and Canada.



The Level Up Indiana Employment Summit
Feature Presenter
Barry Whaley



Barry Whaley works at the Burton Blatt Institute, Syracuse University. He is the Co-Principal Investigator and Project Director of the Southeast ADA Center, Principal Co-Collaborator with the University of Leeds (UK) Inclusive Public Spaces project, Co-Collaborator with the University of Queensland (AU) Gender, Equity, Disability, and Social Inclusion Mainstreaming Short Course, and Principal Investigator of the Mid-Atlantic Youth and Self-Advocacy project. His current research is examining the impact of intersectionality of race and disability, on three ADA-related issues: 1) employment, 2) access to digital technology, 3) long and short-term poverty. Barry is an alumnus of Indiana University and holds a Master of Science in Mediation, Arbitration, and Alternative Dispute Resolution from Sullivan University.



The Level Up Indiana Employment Summit

Featured Presenter

Katie Wolf Whaley



Katie Wolf Whaley, MSW, is a Principal Investigator and Project Director at the University of Kentucky's Human Development Institute. In her work she coordinates training and technical assistance on employment strategies for people with disabilities to service providers, job seekers, family members, and businesses. She works, in collaboration with partners across the state and nation, to build effective systems of support to increase opportunities for people to gain and maintain competitive integrated employment. Katie serves by Gubernatorial appointment as Chairperson of Kentucky's Employment First Council, serves as the President of the Kentucky Chapter of APSE (Association of People Supporting Employment First) and has served on the national board of APSE.



The Level Up Indiana Employment Summit
Featured Presenter
Wendy Waldman



Wendy Waldman, BSW, CBIST worked as a Resource Facilitation Coordinator for Brain Injury Association of Florida for 9 years until moving back to Indiana in 2013. She worked as a Brain Injury Continuum Outreach Manager with the Rehabilitation Hospital of Indiana (RHI) from 2013 to 2022. Wendy now works as a NeuroResource Facilitator and a Clinical Research Coordinator for the Department of Physical Medicine and Rehabilitation at Indiana University School of Medicine. In this role, Wendy educates and presents on acquired brain injury throughout Central Indiana to build professional capacity. She also provides information and navigation to various programs and services available for individuals with acquired brain injury. In addition, Wendy assists survivors and families to access these resources and services, both brain injury specific and instrumental. Wendy is the current President for the Brain Injury Association of Indiana and also the past President for INAPSE (Indiana Association for Persons Supporting Employment First). Wendy is nationally certified as a Brain Injury Specialist Trainer (CBIST) and provides trainings all over the state to professionals through ACBIS and BIAA. Wendy is an active member of the Brain Injury Special Interest Group through the American Congress of Rehabilitation Medicine and has coauthored several publications regarding brain injury and various topics.



The Level Up Indiana Employment Summit
Featured Presenter
Judy Shanley



Judy Shanley, Ph.D. is the Assistant Vice President Education and Youth Transition and National Director of Transportation and Mobility at Easterseals. Dr. Shanley has provided technical assistance throughout the United States and has a long history of working on mobility and transportation topics during her 12-year career at Easterseals. Dr. Shanley worked at the American Institutes for Research (AIR) in Washington, DC for 8 years, serving as a director of various national projects funded by the US Departments of Education (US ED) and Health and Human Services (HHS). She turned her interest in policy to a position at the US ED, Office of Special Education Programs (OSEP) – never moving too far away from her interest in furthering outcomes for individuals with disabilities. Dr. Shanley works across several projects at Easterseals including overseeing the national network of affiliates on the topic of youth transition and served. She has also served as President of the International membership organization representing youth transition and workforce professionals (Division on Career Development and Transition).



The Level Up Indiana Employment Summit
Conference Closing Speaker
Steve Upchurch



Steve Upchurch has served as the Training Director for Indiana Vocational Rehabilitation (VR) since November 2016. Prior to his current role, he served in both counselor and supervisory roles. Steve earned a Master of Arts degree in Education and Human Development from George Washington University and is a Certified Rehabilitation Counselor. He serves on the board of Indiana APSE – the Association of People Supporting Employment First, is a member of the Advisory Council for the Center for Innovative Training in VR, and is a part of the CSAVR DEI&A Professional Network. Steve lives in Indianapolis, Indiana with his wife, son, and their two dogs, and enjoys public speaking and travel.



LEVEL UP
Indiana

