

REGION XII CHAMPIONSHIPS

ARABIAN & HALF ARABIAN HORSE SHOW



WORLD
EQUESTRIAN CENTER
WILMINGTON, OH • OCALA, FL

4~8 | MAY | 2022

Entries Close April 1, 2022 | Post Entries Accepted

USEF - AHA - USDF Recognized | Show Secretary Ryan Chambers 314-717-7683

1390 NW 80th Avenue, Ocala, FL 34482 | www.WorldEquestrianCenter.com | www.AHARegion12.org



Region 12 Championships 12 Reasons Why!

1. **The most premier NEW equine facility built in the United States.**
2. **Sunshine and Warm Weather.**
3. **New Classes, New schedule, Many opportunities to showcase your horse.**
4. **New affordable accommodations and shopping close to WEC.**
5. **Multiple areas to work horses, huge arenas, great footing.**
6. **All climate-controlled arenas and stabling.**
7. **Restaurants, Gas Station, Convenience Store, Laundry Mat, RV Park All ON SITE!**
8. **Best Family Entertainment anywhere in the world within 100 miles.**
9. **Region 12 Celebration Event including Spotlight Futurity & Stallion Auction.**
10. **New Location, New Facility, New Show, New Opportunities.**
11. **Fun, Friendly, Welcoming staff ready to serve you.**
12. **Help us support the Arabian Horse Industry at a World Class Facility!**

***If you missed last year, don't miss this Championship!
None other like it!***

For more information click the links below:

www.aharegion12.com
www.worldequestriancenter.com

Show Manager: Myron Krause 218-205-6066 myronkrause@gmail.com
Show Secretary: Ryan Chambers 314-717-7683 ryan@ringsideproductionsllc.com
Show Chairman: John Rannenberg 352-266-6466 jprannenberg@aol.com
Director: Laurie Salmi 407-866-5767 laurie@level59.com



Dear Exhibitor,

As the returning Manager of Region XII Arabian Horse Association Championship Horse Show, I would like to welcome you to the Premier World Equestrian Center in Ocala, Fla. We are excited about this fabulous, extraordinary facility and the opportunity to see old friends and meet new ones. Your support is and has been an integral part of our success. Here are several Opportunities available for you to support the show and receive valuable benefits. 2022 is going to be the best year yet!

Thank you, Myron Krause

Sponsorships: / Diamond Sponsor / Gold Sponsor, Silver Sponsor, Bronze Sponsor Corporate Advertising Sponsor –various advertising opportunities, class sponsor, mezzanine access, video advertising, live streaming, seating, golf cart, hotel discount, premium stabling, (see details for benefits)

Contact **Co-Chair: Molly McGraw** mtmcgraw@bellsouth.net 205-616-2242

Co-Chair: Cindy Krause cindyjkrause@gmail.com 218-205-6066

Garland Sponsor: Pick your favorite class; sponsor the garland and you or your farm will be recognized and announced.

Contact **Chair: LaRue Allen** alarueallen@sprintmail.com 828-508-0406

Vendor: Setup a booth and sell your wears to others – such as art, jewelry, leather goods, clothing, tack, equipment or trailers.

Contact **Vendor Chair: Kathy Villanova** – marxtoytrains@yahoo.com 336-380-2093

Show Management:

Contact: **Show General Manger: Myron Krause** myronkrause@gmail.com 218-205-6066

Show Secretary: Ryan Chambers ryan.chambers.rc@gmail.com 314-717-7683

Barn Manager: Mike Moak ammoakga@gmail.com 706-540-7326

Dressage/Sport Horse/Hunter Jumper Manager: Marie Taylor 804-314-5216

Please feel free to contact any of our team members above for additional information.

Best Regards,

Myron Krause

Myron Krause

Region XII Show Mgr.

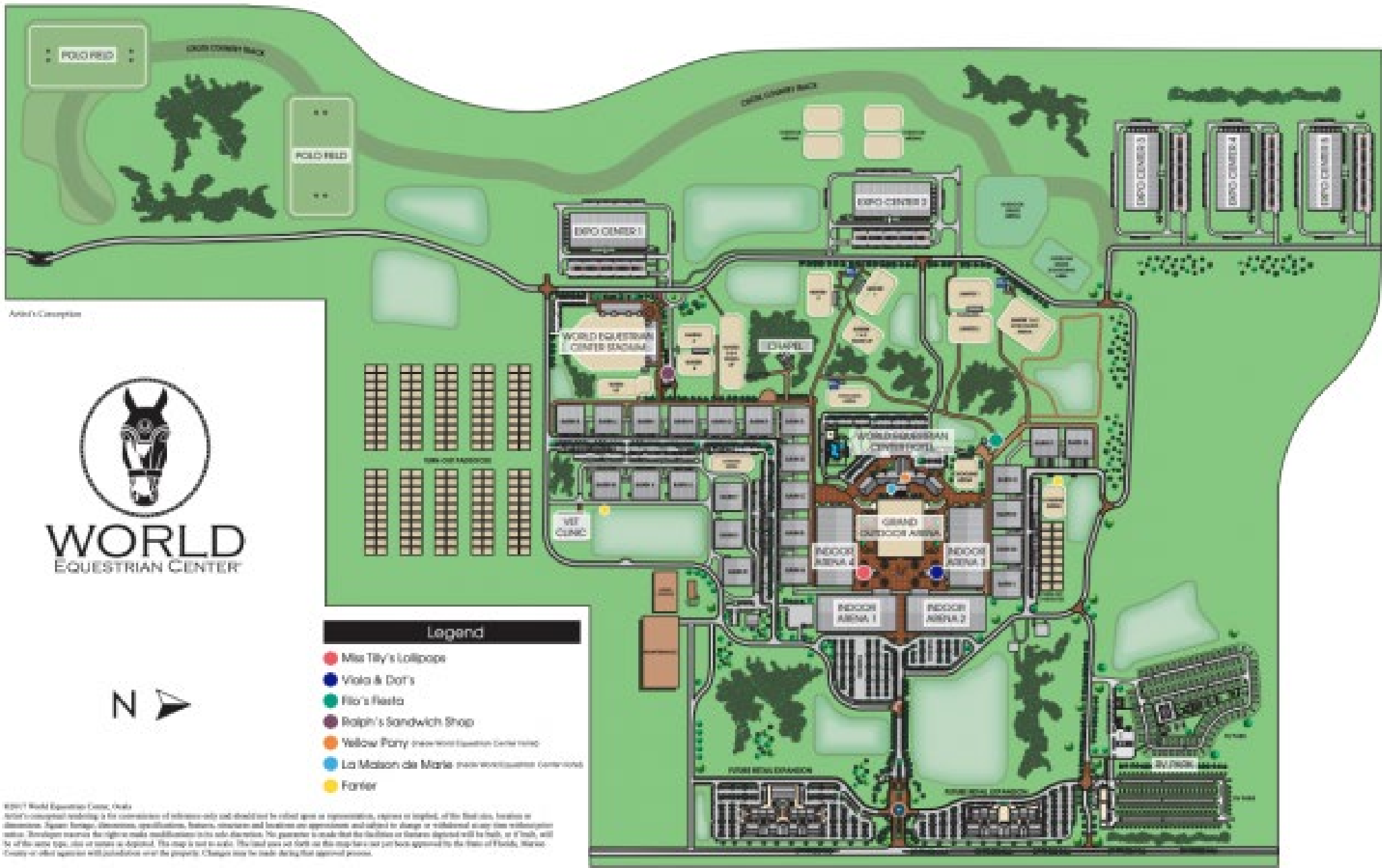

Artist's Conception



- Legend**
- Miss Tilly's Lollipop
 - Viola & Dot's
 - Filo's Fiesta
 - Ralph's Sandwich Shop
 - Yellow Pony (near World Equestrian Center Mall)
 - La Maison de Marie (near World Equestrian Center Mall)
 - Fortier



©2017 World Equestrian Center, Inc. All rights reserved. This map is not to scale. The actual plan set forth on this map has not yet been approved by the State of Florida, Florida County or other agencies with jurisdiction over the property. Changes may be made during that approval process.

2022 – 44th Annual Region XII Championship Horse Show

Region 12 Officers

Laurie Salmi.....Director
 Rob Bick.....Vice Director
 Lindsey Dowling.....Secretary
 Phyllis Ramey.....Treasurer
State Directors: Eric Wolfe, JB Blanset, Dale Brown
 Virginia Godwin, Ted Carson, Eric Reuter

Region 12 Show Committee

Chairman: John Rannenberg, **Treasurer:** Sue Rothman
 Nan Harley Mike Haggan Rob Bick
 Molly McGraw Kathy Villanova Suzie Cook
 Lindsey Dowling Phyllis Ramey Victoria Shaw

Judges

Brian Ferguson "R"..... Judge
 Bob Gordon "R"..... Judge
 Scott Brumfield "R"..... Judge
 Anne Gribbons "S".....Dressage
 Karen Winn "R".....Dressage / Dressage SpH
 Lisa El-Ramey "S".....Dressage SpH
 Douglas Bruce "R".....Hunter/Jumper / H/J-SpH
 Robin Swinderman Mitchell "R".....H/J-SpH
 Chen Kedar.....Egyptian Classes

Region 12 Championship performance classes will utilize the MOS Scoring System as described in the AHA Handbook. Halter classes will use the In Ring Procedure Comparative score cards. The emergency backup system for scoring will be the Three Judge total Points System

Region 12 Fees

Regular Classes \$65
 Dressage Classes \$65
 Hunter/Jumper Regular Classes (Hunter Hack- Eq.- Jumper) ... \$65
 Hunter Division Classes \$100
 Hunter Warm-up per Round \$20
 Spotlight Futurity Classes \$65
 Egyptian Classes..... \$65
 TBA Classes - To Purchase.....\$100. + Entry fee
 TBA Classes - To Enter..... \$65
 Leadline.....-0-
 Horse Stalls\$165
 Tack Stalls.....\$165
 Shavings per Bag.....\$9.50
 Early Arrival Fee / per stall - per day \$30
 Office Fee per horse \$30
 Spotlight Futurity Stallion Office Fee (non-showing)..... \$20
 Post Entry per horse (Entries postmarked after April 1) ... \$50
 AHA Res. 9-90/Results Fee per horse \$25
 USEF Fee (\$15 Drug & Medication, \$8 USEF) \$23
 USEF Show Pass Fee (Non-Member Fee)..... \$45
 Garland Class Sponsor \$65
 Incomplete Entry Form Fee / per horse \$10
 Failure to close out show account by 6:00 pm Sunday..... \$25
 Declined Credit Card Charge..... \$65
 Insufficient Check Charge \$100

Show Officials

Show Manager: Myron Krause.....218-205-6066
myronkrause@gmail.com
 Dressage/SH Coordinator.....Marie Taylor.....804-314-5216
dabneymill@aol.com
 Barn Manager: Mike Moak 706-540-7326 ammoakga@gmail.com
 Barn Manager Assistant Eric Rueter
 Show Secretary.....Ryan Chambers 314-717-7683
ryan@ringsideproductionsllc.com
 Show Secretary Assistant..... Bonnie Chatten
 Steward & Technical Delegate Cheryl Tobey
 Ringmasters Juan Stuckey & Carl Malicote
 Announcer / Sport Horse Rosie Mareno-Jones
 Announcer.....Peter Fenton
 Music A/V Jason Gillespie
 Awards and Gate..... Beverly Ross
 Paddock Master.....Tim Ross
 Scorer.....Tim Moerbe
 Sponsor/FB/Hotel/Floater :Cindy Krause
cindykrause@gmail.com 218-205-4666
 Sponsorships:Molly McGraw
mtmcgraw@bellsouth.net 205-616-2242
 Garland Sponsor Chair..... 828-508-0406 LaRue Allen
 Vendor Coordinator 336-380-2093 Kathy Villanova
 Arena & Gate Crew: Amy Ann Sullivan & Carolyn Camp
Dressage/Sport Horse/H/J Ring
 Eli Hanson/Tony Monopoli/ Kathy Villanova/ Karen Edwards
 Jenn West/ Mike Moak/ Wanda Funk/ Cindy Walk
 Photographer ...815-243-5989..... Jon McCarthy
 www.jonmccarthyphoto.com
 Sport Horse Photographer.... 864-415-3018 Liz Crawley
www.lizcrawley.com
 Spotlight Event Coordinator.....404-409-8904 .. Allison Mehta
 Spotlight Co-Event Coordinator.. 843-601-0569..Melissa Bradshaw
 Veterinarian..... 517-643-1091 during show..... Brad Hill, DVM
 EMT.....TBD
 Farrier..... Jeremy Miller
 Farrier..... Chris Jones
 Hunter Course Designer..... Marie Taylor
 Trail Course Designer..... TBD
 Videographer Live Streaming SeeHorse Video
orders@seehorsevideo.com 1-317-984-5286

Awards

Top Five Awards will be made regardless of the number of entries in a class. However, only awards made to the top 50% of the class (rounded up and not to exceed 5 awards) will receive Arabian Breeders Sweepstakes payout, AHA Horse Achievement Award, Amateur Achievement Awards, High Point Horse Achievement Award, High Point Amateur Achievement Award and Distance Award Points. **Please Note:** All awards not claimed by the close of the awards room on the last day of classes, will be forfeited. Awards will not be mailed to exhibitors after the event.

Champion Ribbon and Garland
 Reserve Champion..... Ribbon and Garland
 Remaining Top Five..... Ribbon

EMERGENCY INFORMATION

Nearest Hospital

Ocala Regional Medical Center
 1431 SW 1st Ave, Ocala, Florida, 34471
 352-401-1101

Nearest Level 1 Trauma

Center University of Florida Shands Hospital
 1515 SW Archer Road Gainesville, FL 32608
 352-733-0111

GOLF CARTS

Reserve only through WEC at
www.worldquestriancenter.com
 Under Ocala, click Golf Cart Rentals



REGION 12 SPONSORSHIP PROGRAMS



DIAMOND SPONSOR \$5000.00

Limited availability

- WEEKLY GOLF CART RENTAL
- HOTEL ROOM AT THE NEW 5 STAR WEC GRAND HOTEL FOR 5 DAYS
- FRONT ROW TABLE FOR EVENING RING SIDE SEATING
- \$225.00 FOOD VOUCHERS FOR WEC RESTAURANTS
- PRIORITY ASSIGNMENT IN PREMIER STABLING
- UNLIMITED ACCESS PASSES TO PRIVATE MEZZANINES
- PRIORITY SEATING IN ALL ARENAS
- VIDEO TO BE PLAYED ON ALL JUMBO LED SCREENS INSIDE AND OUT (EXPOSURE TO THOUSANDS OF PEOPLE)
- WEB PAGE LINK ON REGIONAL WEB SITE
- ADVERTISING ON LED OVERHEAD SCREENS
- PREMIER GIFT PACKAGE
- PRIORITY ASSIGNED PARKING
- HILTON HOTEL DISCOUNTED RATES (INCLUDING SUITES)
- 10X10 VENDOR BOOTH

GOLD SPONSOR \$1200.00

- WEEKLY GOLF CART RENTAL
- PRIORITY ASSIGNMENT IN PREMIER STABLING
- 10 ACCESS PASSES TO PRIVATE MEZZANINES
- WEB PAGE LINK ON REGIONAL WEB SITE
- ADVERTISING LISTING ON LED OVERHEAD SCREENS
- RESERVED PRIORITY RINGSIDE SEATING
- VIP GIFT
- CLASS SPONSOR

SILVER SPONSOR \$600.00

- PRIORITY STABLING
- 5 ACCESS PASSES TO PRIVATE MEZZANINES
- WEB PAGE LINK ON REGIONAL WEBSITE
- VIP GIFT
- CLASS SPONSOR

BRONZE SPONSOR \$250.00

- 3 ACCESS PASSES TO PRIVATE MEZZANINES
- CLASS SPONSOR

GARLAND SPONSOR \$65.00

CLASS CHOICE OF SPONSORING A GARLAND
Contact: Larue Allen alarueallen@sprintmail.com 828-508-0406

PREMIER CORPORATE ADVERTISING SPONSOR \$5000.00

- WATERMARK ON ALL VIDEOS AND ADVERTISING
- VIDEO ADVERTISING WITH SOUND ON ALL LED SCREENS INDOORS AND OUTDOORS
- STILL IMAGE ADVERTISING
- SIGNAGE AND BANNER ADVERTISING IN ALL ARENAS
- LINKS TO ADVERTISER ON WEBSITE, SOCIAL MEDIA
- 10X10 VENDOR BOOTH TO DISPLAY OR ADVERTISE PRODUCTS
- WEB PAGE ADVERTISING
- E-BLASTS
- DIRECT MAIL
- SOCIAL MEDIA POSTS
- LIVE STREAM ADVERTISING
- PUBLIC ADDRESS ANNOUNCEMENTS

CORPORATE ADVERTISING SPONSOR \$300.00

- ADVERTISING ON THE HUGE LED JUMBOTRONS IN THE INDOOR ARENA AND THE OUTDOOR ARENA
- LINKS TO ADVERTISER ON WEBSITE, SOCIAL MEDIA
- SIGNAGE AND BANNER ADVERTISING

Co-Chair: Molly [McGraw mtmcgraw@bellsouth.net](mailto:McGrawmtmcgraw@bellsouth.net) 205-616-2242

Co-Chair: Cindy Krause cindyjkrause@gmail.com 218-205-4666



Sponsorship Form

SPONSOR NAME _____ CONTACT NAME _____

FARM/TRAINER AFFILIATION _____

ADDRESS _____

CITY _____ STATE _____ ZIP _____

TELEPHONE # _____ Cell: _____

E-MAIL _____ WEBSITE _____

If paying with credit card, please add 4% = _____ for a total of \$ _____

Check Enclosed # _____

PLEASE NOTE:

- MEZZININE PASSES WILL ALL HAVE SPONSORS NAME
- GOLF CART TO BE RESERVED IN SPONSORS NAME
- ADS & LOGOS TO BE USED IN ALL ARENAS ON LED BOARDS AND LIVE FEED
- ADS & LOGOS NEED TO BE CAMERA READY ART, CAN NOT USE PHOTO OF BUSINESS CARD ADS
- NEED SPONSOR ADS AND LOGO NO LATER THAN **APRIL 22, 2022** – TO BE ON LIFE FEED TRAILER
- **AD/LOGO SPECIFICATIONS:** 1920 X 1080 OR LARGER, NO SMALLER PLEASE. CAN ACCEPT PDF, JPG, PNG
- VIDEOS: MUST BE SUBMITTED NO LATER THAN **APRIL 22, 2022**
- VIDEOS: MAY BE UP TO BUT NOT EXCEED 2 MINUTES
- **◆ ◆ NOTE: PREMIUM STALLING WILL NOT BE ASSIGNED UNTIL SPONSORSHIP MONIES HAVE BEEN RECEIVED BY THE SHOW SECRETARY ◆ ◆**

Please send a copy of this form along with your check or credit card form to the Show Secretary:
Ryan Chambers P.O. Box 508 Boone Terre, MO 63628 ryan@ringsideproductionsllc.com

For questions regarding sponsorship, please contact: Co-Chair: Molly McGraw - mtmcgraw@bellsouth.net - 205-616-2242 Co-Chair: Cindy Krause - cindyjkrause@gmail.com - 218-205-4666

office use only: Postmark _____ Amt. Paid \$ _____ Check # _____ C.C. # _____ Bal. Due \$ _____



Region 12 – CREDIT CARD FORM:

Visa / MasterCard / Discover / American Express / Credit Card Form

NOTE: When using credit, a 4% Service Charge will be added

Business/Farm Name _____ (Office Use Only)
FILE NAME _____ (Name as it appears on card)
CARD NUMBER _____ EXPIRATION DATE _____
3 or 4 Digit Security code on back or front of card _____
BILLING Address _____
City _____ State _____ Zip _____
Mailing Address (if different from Billing)
Address _____
City _____ State _____ Zip _____
E-Mail _____ Phone: Cell _____ Home _____

TOTAL Fees \$ _____ x 4% Service Charge \$ _____ = TOTAL TO BE CHARGED \$ _____

Check here if this card is to pay for additional fees that accumulate while at the show:

Print your name _____ SIGNATURE _____

Office Use Only

Date _____ Amt. \$ _____
Approval Code _____ EB # _____
Posted to Computer _____ Date _____ Amt. \$ _____
Approval Code _____ EB # _____
Posted to Computer _____ Date _____ Amt. \$ _____



**2022 Region 12 Championship
Arabian and Half-Arabian Horse Show
May 4-8, 2022**



VENDOR INFORMATION

The World Equestrian Center Ocala, FL 'WEC'
<https://worldequestriancenter.com/ocala-fl/>



Application Requirements - Applications will only be accepted if it is filled out and legible. Please read the contract stipulations on Vendor space on the Vendor Agreement page for additional requirements.

Booth Location Assignments - Booth location assignments are based on the following criteria:

- 1) Contract application must be received by the first deadline date. Vendor Agreement to exhibit and full payment are due March 15, 2022. Failure to comply with result in loss of booth space and no refunds will be issued.
- 2) Exhibitor seniority based on continuous years of exhibiting at the Region 12 Championship Show and Sponsorship Program participation.
- 3) Any contract application received after the requested deadline date will be assigned based on availability on a first come, first served basis.

Check In - All Vendors must check in before setting up to confirm space. **NO EXCEPTIONS** Check in will be located at the Show Office of Arena 1, beginning Monday, May 2, 2022.

Deadline for Vendor Applications & Payments - **March 15, 2022**

Hours of Operation - Vendor Exhibit areas will be open to the public from May 4 - 8, 2022. Hours of operation are the daily start time of the show and end time of the show.

Services - Pipes, drapes, tables, chairs, and any other services needed will be the responsibility of the Vendor to coordinate with WEC.

For additional information or questions, please contact:
Kathy Villanova, Vendor Coordinator - 336-380-2093 - marxtoytrains@yahoo.com



May 4-8, 2022 World Equestrian Center Ocala, FL

VENDOR AGREEMENT

EXHIBITOR CONTACT INFORMATION THIS INFORMATION WILL APPEAR ON SIGNAGE, ETC.

Business Name: _____

Contact/Owner: _____

Address: _____ City: _____ State: _____

Zip: _____ Phone: _____ Cell: _____

Email: _____ Website: _____

EXHIBITOR CATEGORY/MERCHANDISE INFORMATION

Type of Exhibit and Description of Merchandise:

Vendor Charges for Entire Show

Total amount Due by March 15, 2022

Inside Concourse Area *Includes One-time \$35.00 Electrical fee

10X10 Space = \$200.00 Number of Spaces Required: _____ TOTAL: _____

Outside Vendors Trailers, RVs, Tents etc.

\$200.00** ea Number of Spaces Required: _____ TOTAL: _____

**** +\$50.00 per day Electrical for outside Vendors**

Enclosed Check, Cashier's Check or Money Order. Check# _____ Payable to: Region 12 Horse Show

Application and Payment Deadline: March 15, 2022

When using credit card, a 4% Service Charge will be added.

Move in date is no earlier than Monday May 2, 2022 after 2 pm.

THE REGION 12 ARABIAN & HALF ARABIAN HORSE SHOW AND THE WEC will not be responsible for any loss, personal injury or damage to vendors or for any article of any kind or nature that may be lost or destroyed or in any way damaged. Each vendor will be responsible for any injury that may be occasioned to any kind of person or any damage to any property while on the grounds by any product owned or sold by him and shall indemnify the management against all legally established claims or damages of any kind or nature that may grow out of any injury occasioned by any product owned or sold by him. Presentation of this form shall be deemed acceptance of these rules.

Signature _____ Date _____

Mail Agreement form, check or completed credit card form to:
Kathy Villanova 2000 Old Hillsborough Rd Mebane, NC 27302 marxtoytrains@yahoo.com



Garland Sponsorship Form

2022 Region XII Championship

May 4 - 8, 2022

◀ ◀ ◀ Show your support for Region 12 ▶ ▶ ▶

Name (To be listed on Website)

Preferred Class(es) to Sponsor (\$65/class)
Give class # and class name.

Class Choices if preferred are not available

Complete name(s), address and telephone numbers of sponsor(s) must be listed below.

NAME: _____

ADDRESS: _____

CITY: _____ STATE: _____ ZIP CODE: _____

PHONE: _____ EMAIL: _____

Garland Sponsorship Includes:

* Choice of Region XII Championship Class(es) (classes assigned on a first come, first served basis)

* Sponsorship announced during the Region XII Championship Class

* Sponsorship listed on the Region XII Web site

Number of Classes Sponsored: _____ @ \$65.00 ea. = \$ _____ Check payable to Region XII # _____

If paying with credit card, please add 4% = _____ for a total of \$ _____

Also include the credit card form from page 9 of this prize list

Questions?? Contact Garland Chair: LaRue Allen - alarueallen@sprintmail.com - 828-508-0406

Mail or e-mail your form and mail payment before April 19th to the address below:

LaRue Allen; P.O. Box 94, Maggie Valley, NC 28751; Phone: 828-508-0406 - email: alarueallen@sprintmail.com

● ● ● PLEASE DO NOT SNAIL MAIL CHECK OR FORM AFTER APRIL 19th ● ● ●

Office use only: Postmark _____ Amt. Paid \$ _____ Check # _____ C.C. # _____ Bal. Due \$ _____



ARABIAN
BREEDERS SWEEPSTAKES

ARABIAN BREEDERS SWEEPSTAKES

Join the **GREEN** Movement

2022 ALLOCATED REGIONAL PRIZE MONEY CLASSES

ARABIAN SWEEPSTAKES CLASSES

Arabian Yearling Colt/Gelding	\$2,000
Arabian Yearling Filly	\$2,000
Arabian Gelding AOTH	\$1,000
Arabian Mares AOTH	\$1,000
Arabian English Pl Jr Horse	\$1,000
Arabian English Pl AAOTR	\$1,000
Arabian Country English Pl Jr Horse	\$1,000
Arabian Country English Pl AAOTR	\$1,000
Arabian Hunter Pl Jr Horse	\$1,000
Arabian Hunter Pl AAOTR	\$1,000
Arabian Western Pl Jr Horse	\$1,000
Arabian Western Pl AAOTR	\$1,000
Arabian Reining Jr Horse	\$1,000
Arabian Reining AAOTR	\$1,000
Arabian Western Trail Jr Horse	\$ 600
Arabian Western Trail AAOTR	\$ 600
Arabian Working Cow Jr Horse	\$ 350
Arabian Working Cow AAOTR	\$ 350
Arabian Cutting Jr Horse	\$ 350
Arabian Cutting Non-Pro	\$ 350
**Arabian SH Under Saddle AOTR	\$ 350
^Arabian Dressage Second Level AOTR	\$ 350
Arabian Regular Working Hunter AOTR	\$ 350

HALF- ARABIAN/ANGLO-ARABIAN SWEEPSTAKES CLASSES

HA/AA Yearling Colt/Gelding	\$2,000
HA/AA Yearling Filly	\$2,000
HA/AA Gelding AOTH	\$1,000
HA/AA Mares AOTH	\$1,000
HA/AA English Pl Jr Horse	\$1,000
HA/AA English Pl AAOTR	\$1,000
HA/AA Country English Pl Jr Horse	\$1,000
HA/AA Country English Pl AAOTR	\$1,000
HA/AA Hunter Pl Jr Horse	\$1,000
HA/AA Hunter Pl AAOTR	\$1,000
HA/AA Western Pl Jr Horse	\$1,000
HA/AA Western Pl AAOTR	\$1,000
HA/AA Reining Jr Horse	\$1,000
HA/AA Reining AAOTR	\$1,000
HA/AA Western Trail Jr Horse	\$ 600
HA/AA Western Trail AAOTR	\$ 600
HA/AA Working Cow Jr Horse	\$ 350
HA/AA Working Cow AAOTR	\$ 350
HA/AA Cutting Jr Horse	\$ 350
HA/AA Cutting Non-Pro	\$ 350
**HA/AA SH Under Saddle AOTR	\$ 350
^HA/AA Dressage Second Level AOTR	\$ 350
HA/AA Regular Working Hunter AOTR	\$ 350

If fewer than nine horses are in the class, 50% round up will be eligible for prize money.

Sweepstakes AAOTR classes are eligible to be split into multiple age divisions. Leveling classes will receive prize money when offered. Splitting AAOTR classes is discouraged as this reduces the Sweepstakes payout for each class split.

** Sweepstakes classes eligible to be split into Saddle/Pleasure, Stock/Hunter and/or multiple age divisions (age splits must be all inclusive). Sport Horse Classes may be split by Dressage or Hunter Type.

^At Regional Shows, the highest test will be used. At the Regional Level, these classes can be combined as Arabian/Half-Arabian/Anglo-Arabian.

	<u>\$2,000 Classes</u>	<u>\$1,000 Classes</u>	<u>\$600 Classes</u>	<u>\$350 Classes</u>
Champion	\$ 750	\$350	\$250	\$125
Reserve Champion	\$ 500	\$200	\$125	\$ 75
Remaining Top Five	\$ 250	\$150	\$ 75	\$ 50

Contact AHA at (303)696-4500, #4 or visit our website at ArabianHorses.org for additional information regarding the Sweepstakes Program.

REGION 12 GENERAL RULES & REGULATIONS

- 1. USEF MEMBERSHIP STATEMENT:** Life, senior active and junior active members shall be eligible to participate in all classes at Regular Competitions, Eventing Competitions at the Modified Level or above and Combined Driving Competitions at the Advanced Level, Dressage, Reining and Vaulting Competitions and Endurance Rides. A nonmember may participate as a handler, rider, driver, owner, lessee, agent, coach or trainer at Regular Competitions, Eventing Competitions, Dressage Competitions, Reining Competitions and Combined Driving Competitions upon payment of a \$45 Show Pass fee. Participants in the following classes are exempted from the Requirements of this rule: 1) leadline; 2) exhibitions; 3) games and races; 4) classes for 4-H members; 5) walk trot (exception: Friesian performance FR222) and academy classes (academy classes are classes limited to horses used regularly in a lesson program); 6) USDF introductory level tests, pas de deux and quadrille classes; 7) NRHA Endorsed Reining Competitions. 8) Opportunity classes, 9) citizens of other nations who have proof, in English, of current membership in good standing of their own National Federation, 10) USEA beginner novice division; and 11) assistant handlers in Dressage Sport Horse Breeding classes.
- 2. USEF FEES:** Every horse in this competition shall pay a \$23 Fee (\$15 fee for Drugs & Medication and an \$8 fee for USEF).
- 3. USEF RULES:** EVERY CLASS OFFERED HEREIN WHICH IS COVERED BY THE RULES AND SPECIFICATIONS OF THE CURRENT USEF RULE BOOK WILL BE CONDUCTED AND JUDGED IN ACCORDANCE THEREWITH. See USEF Rule AR for Arabian Horse rules, class descriptions & judging specifications. Changes in USEF rules will automatically become a part of this Prize List. Show Committee reserves right to make such changes in procedure, personnel, rules & regulations as deemed by them to be in the best interest of the show. USEF considers Regional Show, Hunter/Jumper and Dressage classes to be inclusive as a single show.
- 4. ARENAS - Descriptions & Admission:** No person permitted in arena during classes except judges, assistants, exhibitors in class & show photographer. Headers not permitted in arena until summoned by order of Judge. All arenas have custom blended, all weather, GGT footing. Arena measurements: WEC Grand Arena: 320' x 400', Indoor 1: 171' x 530', Indoor 4: 192' x 525', & Hunter 3 & 4: 175' x 300'
- 5. AGE OF HORSE:** Horses, except in Yearling Sweepstakes classes, must be 2 years of age to enter Mare and Stallion Championship Breeding Classes. Geldings must be 1 year old to enter In Hand Championship Classes. For competition purposes any horse is considered to be 1 year old on the first day of January following the actual day of foaling.
- 6. AHA MEMBERSHIP STATEMENT:** Each competitor (this includes at least one recorded owner and all trainers, drivers, riders, halter handlers, coaches and the person(s) signing the entry blank in an Arabian Horse Association recognized Arabian Division, at the time of entry into a competition, must submit a copy of a valid AHA membership/competition card, join AHA or pay an AHA Single Event Membership fee per competitor. When an agent signs for the owner at an AHA recognized competition, both the owner and agent must be members of AHA or pay the AHA Single Event Membership. Single Event Membership is not acceptable at AHA Regional or National competitions. Exhibitors in Walk-Trot classes are exempt from AHA membership requirements at qualifying competitions, but must have an AHA membership with competition card at AHA Regional and National competitions. Exhibitors in Lead Line classes or parent/guardians signing for minors are exempt from AHA membership requirements. (BOD 5/12)
- 7. AOTR/AOTD/JOTR/AAOTR/AATR CLASSES:** All riders 19 years or older in amateur owner classes must have in their possession amateur certification issued by USEF or make application for such certification at least one hour prior to showing in these classes. Applications may be secured from the Show Secretary. Leased horses may not be shown by Lessee in amateur owner classes, unless Lessee and Lessor are members of the same family. Combined ownership is allowed in amateurowner classes only if all owners are members of the same family. See USEF GR 123 for definition of "family." USEF Farm Registration Certificate must accompany entries made in farm name that will be shown in Amateur Owner classes. Horses entered in amateur owner and JOTR classes must be registered in the name of exhibitor or a member of exhibitor's family. The sale of a horse does not eliminate this registration requirement (contracts of sale or bill of sale will not be accepted) USEF AR 101.2.
- 8. ARRIVAL TIME:** Stalls available **2:00 PM on Monday, May 2, 2022.** You may make arrangements with the barn manager for early arrivals at a fee of \$30.00 per stall, per day, used for any purpose, including: tack, feed, dressing room, sitting area, etc. Early arrival fees will be charged at the show when verified by Show Management. Exhibitors arriving prior to 2:00 p.m. on Monday, May 2, will be charged a fee of \$30 per stall, per day used for any purpose. **EARLY AR- RIVAL STALLS ARE LIMITED AND MAY NOT BE YOUR SHOW STALLS.**
- 9. ATTIRE:** Riders & handlers must be dressed appropriately. Show Committee may bar any entry or person from entering the ring if not suitably attired to appear before an audience. Headers in driving classes must be properly attired. A white smock is usual.
- 10. AWARDS:** Top five awards will be made regardless of the number of entries in a class. However, only awards made to the top 50% of the class (rounded up and not to exceed 5 awards) will receive Breeders Sweepstakes payout points, AHA horse achievement awards, high point horse achievement award, high point achievement award and distance award points. All awards not claimed by the close of the awards room on the last day of classes, will be forfeited. Awards will not be mailed to exhibitors after the event.
- 11. CALL FOR CLASSES:** Classes will be called promptly. There will be 3 calls for classes whenever possible. The first two calls will be made at reasonable intervals. The third & final call will be made while ribbons are being awarded in preceding class. Exception: First class of each session should be at the gate at the scheduled time for commencement of the session. In classes where horses compete collectively, two minutes will be allowed after first horse in class enters ring, after which time the gate will be closed. Exhibitors are requested to come to warm-up ring 15 minutes prior to class. However, it may become necessary to limit horses & number of attendants in warm-up ring to those showing in next class.
- 12. CAMPERS / RV SLIPS / GOLF CARTS:** Reserve only through WEC at www.worldequestriancenter.com. Under Ocala, click Golf Cart Rentals for both.
- 13. COVID-19 ACTION PLAN:** Every Region 12 exhibitor and participant agrees to abide by the US Equestrian Federation COVID-19 Action Plan Requirements. Due to the Covid-19 pandemic, all programs, properties, events and related specifications are subject to change in accordance with federal, state and local laws and regulations. The plan can be found here: <https://www.usef.org/media/coronavirus-resources>.
- 14. CROSS ENTRIES:** Cross entries at these shows are prohibited between the Country English Pleasure classes and the English Pleasure and Pleasure Driving classes at the same show.
- 15. CRUELTY TO OR THE ABUSE OF A HORSE BY ANY PERSON AT THESE RECOGNIZED SHOWS ARE FORBIDDEN.** Excessive use of a whip on any horse in a stall, runway, schooling area, show ring or elsewhere on the show grounds, before or during a show, by any person, constitutes a violation and renders the offender subject to penalty.
- 16. DEPARTURE TIME:** All horses and equipment must be clear of the grounds by Noon on Monday, May 9, 2022.
- 17. DISCIPLINE:** Exhibitors are hereby notified that the AHA Board of Directors will strictly enforce and actively support all AHA, USEF and/or CEF rules regarding sportsmanship, conduct & courtesy at all AHA Recognized shows and events. This includes but is not limited to Rules that govern owners, exhibitors, agents, trainers, managers, riders, drivers, handlers, competition officials, competition employees & members of the families of the above, individual members of AHA or any person who acts in a manner in violation of the Rules or deemed prejudicial to its best interests. Any AHA and/or USEF violations committed will be subject to the AHA, USEF and/or CEF penalties.
- 18. DISPUTES:** Disputes, if any, over Regional Classes which cannot be settled by the Region 12 Show Committee shall be referred to the AHA National and Regional Classes Committee.

19. DISQUALIFICATIONS: All horses doctored in any way, artificially, improperly or unfairly prepared or tampered with before coming into the show arena will be disqualified, if it is ascertained that any exhibitor has made, or caused to be made, a false statement in regard to any animal or article exhibited, or if any exhibitor shall attempt to interfere with the Judges in the performance of their duties, he/ she shall be excluded from competing or exhibiting. In the case of any animal being disqualified, the winner of the next succeeding prize in class shall take the prize that has been awarded to such disqualified animal & the alternate for that class shall move up to a placing.

20. DIVISION OF CLASSES: Classes will be split at the discretion of Show Management. Class splits will be decided upon the number of entries with consideration of arena size and location. Class splits will be posted at the Show Office.

Exception: Sweepstakes Sport Horse Under Saddle AOTR classes will not be further split by age, as they have already been split by type.

21. DOGS/ANIMALS LEASH REQUIREMENTS: Dogs must be kept on a leash at all times while on property. Any dog that is deemed aggressive by WEC staff or security will be asked to be removed from property or put away in the owner's residence.

22. EGYPTIAN RELATED CLASSES: See page 34 for list of classes and rules regarding these classes. NOTE: These classes are not recognized by AHA nor USEF.

23. ELIGIBILITY: Refer to the current Qualification requirements on the AHA website.

24. ENTRIES: Pre-entries close April 1, 2022. Email entries will be accepted, if sent as one (1) complete document. Entries postmarked after April 1st will be charged a \$50 per horse post entry fee. If making a late entry, do not mail to the Show Secretary after April 19th. Bring it to the show, being sure the late entry is made before the show starts at 8 am on Wednesday, May 4th. Entries must be accompanied by full payment in order to be processed. Open checks sent with entries will be filled out and deposited when entry is processed. Entries sent with no payment will be considered post entries and charged the post entry fees. Due to bookkeeping procedures, fees cannot be split between exhibitors. Entries must be properly made on the official entry form in the name of the legal owner only, giving the legal owner's complete address. Any deviation between Registration paper & entry form must have a valid reason, i.e., contract, lease, bill of sale; copies of which must accompany entries (For AOTR/JOTR classes refer to Rule #7). Entries postmarked by closing date will be sent an email acknowledgement. Entries must be signed by the owner/agent, the trainer, and by ALL riders/drivers/handlers. If under age 18, a parent/guardian or the trainer must sign entry blank on minor's behalf, signing their name. "Junior (Minor) Exhibitor Consent" must also be completed. **JUNIORS ARE NOT ALLOWED TO HAVE THEIR NAME SIGNED ON ENTRY FORMS!!** Exhibitors are responsible for their own errors and those of their agents in the preparation of entry blanks. Packets/exhibitor numbers will not be released until all entries are complete.

25. EQUITATION: All classes shall be conducted in accordance with current USEF rules as modified by AHA. Equitation rules are found in the current AHA Handbook. Formal attire is permitted, but not required, in performance classes held after 6:00 p.m.

26. FARRIER: Any Farrier other than the Official Show Farrier must pay a Commercial Vendor Fee of \$350 and set up in a designated area for farriers. Exhibitors are cautioned that the USEF Steward and the judges are the final authorities on measuring the shoe and/or foot.

27. FEED & BEDDING: Shavings can be ordered on your entry forms. **NO OUTSIDE SHAVINGS ARE ALLOWED TO BE BROUGHT ON THE WEC GROUNDS (a fee will be applied to anyone not following these restrictions).** Additional shavings and feed can be ordered through the show office.

28. HALTER CLASSES: The one specified person assisting with entrance of in-hand horses into the ring, in the designated controlled paddock, will be allowed to use only the same length whip and appendages as are currently allowed for the individual handling the horse. **Rule reference AR114.2: Whips are to be no longer than 6' including snapper/lash/appendage. Small appendages (no more than 12 inches in length) of ribbon, plastic, etc. are permitted.** The designated person will not hit or use any other objects, such as trash cans, walls, etc. to make any noise. In addition, the use of plastic or paper bags of any type or size is prohibited in assisting with entrance(s) into the arena. Should this rule/policy be violated, a warning card may be issued to both the handler and the designated person or groom who initiates this violation. Order of go will be posted by horse's birth date. Horses must enter arena in assigned order at a walk and proceed at a trot after entering the gate until lined up. Horses to be inspected for signs of abuse by designated Steward prior to entrance into ring for judging. Manner of inspection will be at the discretion of Show Management. Purebred Stallions & Mares and Yearling Colts & Fillies will be lined up in the order selected by each respective judge. All halter classes will use the "In Ring" procedure.

29. HEALTH REQUIREMENTS: Florida regulations require that all equines be covered by official interstate health certificates, issued by a licensed veterinarian, showing that the animals are free from any symptoms of any infectious or communicable disease. The certificate shall include the name of the owner and address, destination in Florida, number of horses examined, the name, registration number (s), if any, tattoo, if any, sex, age, rectal temperature, color, and markings of each animal listed. Health certificates will become void after 30 days from issue. Health certificates must show animals to be negative to an equine infectious anemia test within the past 12 months. Date of test and approved laboratory must be shown on health certificate. Horses entering the grounds must be accompanied by documentation of Equine Influenza Virus and Equine Herpes Virus (Rhinopneumonitis) vaccinations within six months prior to entering the stables. Horses not in compliance with this rule may be required to leave the competition grounds upon request by Competition Management. Documentation should consist of one of the following methods mentioned below. The frequency of vaccine administration should be per the vaccine manufacturers' or veterinarian's recommendations. It is recommended that vaccines are administered by or under the direction of a veterinarian. 2. In the case of vaccines administered by a veterinarian, the exhibitor, upon request by Competition Management, must provide documentation from the veterinarian on documenting that the horse in question received the vaccinations; name of the vaccines and date of vaccine administration. 3. In the case of vaccines administered by a person other than a veterinarian, the exhibitor, upon request by Competition Management, must provide a receipt of the vaccine purchase which is signed by the owner, or agent with care, custody, and control of the horse; name, serial number and expiration date of the vaccine; and date of vaccine administration. 4. In the case of a horse that is unable to receive either of the vaccinations due to a history of adverse reactions, the exhibitor, upon request by Competition Management, must provide a letter from the veterinarian on official letterhead stating that the horse in question cannot be vaccinated due to medical concerns and a log of temperatures taken twice daily for the seven days prior to entering the competition grounds. These horses must also have their temperature taken and logged twice daily while on the competition grounds. The log of temperatures should be provided to the Competition Management, steward, or technical delegate when requested. 5. Competition Management may not amend or enhance vaccination requirements without prior approval of the Veterinary Committee.

30. IDENTIFICATION NUMBERS: Every horse in the show will be assigned an identification number and this number must be worn by exhibitors when the horse is being shown. Any exhibitor using a wrong number or having no number may be penalized at the Judge's discretion.

31. INDEMNITY & NON-RESPONSIBILITY CLAUSE: All entries are accepted with the understanding that Region 12 and the World Equestrian Center will not be held responsible for any loss, damage or injury to any horse exhibited or any article of any kind. All horses shall be under the control and direction of the Show Commission but solely at the risk of the exhibitor, who will be responsible for any loss, damage or injury to any person, animal or property occasioned by him, his agents or employees, or by any animal owned or exhibited by him, and shall indemnify Region 12 and the World Equestrian Center against any and all loss, damages and liability thus occasioned, including attorney fees, which may be incurred as a result thereof. Submitting of an entry form to Show Secretary shall constitute an acceptance of each person signing same of the provision herein set forth.

32. JUDGING SYSTEMS: All Region 12 classes will be judged by the AHA MOS system described in AHA Handbook with the exception of Dressage, Western Dressage, Hunter/Jumper and Sport Horse. The call judge will call the gaits in all Regional performance classes. Judges' cards will be posted after each session.

33. JUNIOR EXHIBITORS: Children eligible for Junior Exhibitor classes shall not have reached their 19th birthday as of December 1st of the previous year.

34. JUNIOR HORSE CLASSES: Junior horses are five years of age and under.

35. MOTORIZED VEHICLE STATEMENT: Minors who do not have a valid driver's license which allows them to operate a motorized vehicle in the state in which they reside will not be permitted to operate a motorized vehicle of any kind, including, but not limited to, golf carts, motorcycles, scooters, or farm utility vehicles, on the competition grounds of licensed competitions. Minors who have a valid temporary license may operate the above described motorized vehicles as long as they are accompanied by an adult with a valid driver's license. The parent/legal guardian or individual who signs the entry blank as a parent or guardian of a minor operating a motorized vehicle in violation of this rule are solely responsible for any damages, claims, losses or actions resulting from that operation. Violations of this rule will be cause for penalties against those responsible for the child committing the offense. Wheelchairs and other mobility assistance devices for individuals with disabilities are exempt from this rule. The unsafe use of personal electronic transport devices, as determined by the competition officials and management in their sole discretion, that do not require a driver's license to operate, including but not limited to segways, hover boards, and single wheeled scooters is prohibited on competition grounds. Operating such devices in areas where people gather may be deemed "unsafe use" if there is a risk of harm to others. If the operator of the device is a minor, the parent/legal guardian or individual who signs the entry blank as a parent or guardian of a minor operating the device in violation of this rule is accountable and may be subject to penalties. Wheelchairs and other mobility assistance devices for individuals with disabilities are exempt from this rule.

36. OFFICIALS: In the event that due to illness or failure of a Show Official to attend this show or perform his duties, the Show Management reserves the right to substitute a Show Official. No one shall approach or contact a Judge with regard to a decision unless they first obtain permission from the Show Steward who may arrange an appointment with the Judge at a proper time & place.

37. PA SYSTEM: Due to unforeseen problems with any mechanical device, the PA system & class calls over that system are considered a courtesy. The exhibitor is responsible to have his horse at the gate at the prescribed time. While every effort will be made to maintain a working PA system, no refund will be made, section changed, or protest upheld based on a PA failure.

38. POST ENTRIES: Post Entries accepted for all classes except Dressage. Dressage post entries will only be allowed at the discretion of management if ride times are available. Post entries will be charged an add'l fee of \$50 per horse for entries postmarked after April 1st and received before the show starts. Once the show starts, **all new entries** will pay a post entry fee of \$50 per class if entered by the preceding session, for a total of \$115 per class. Post entries using Messaging or Text Messages are not accepted at all. **ALL CLASSES FOR THE MORNING SESSIONS MUST BE ENTERED BY 6PM THE EVENING BEFORE.**

Official start of show is 8:00 AM, Wednesday, May 4, 2022

If an entry fails to enter by the above guidelines, then a courtesy class entry fee of \$200 per class will be charged.

39. PROFESSIONAL SERVICES or consultations performed by Show Vet or Farrier outside the show ring shall be on private fee basis.

40. PROTECTIVE HEADGEAR: Any rider may wear protective headgear in any division or class without penalty from the judge. USEF strongly encourages all riders to wear protective headgear. It is the responsibility of the rider, parent, guardian, or trainer of the junior exhibitor to see that the headgear worn complies with safety standards and is properly fitted and in good condition. Refer to current USEF Rule Book.

41. QUALIFICATIONS: See AHA Qualification chart.

42. REFUNDS: All fees (except Office Fees & 4% credit card fees) cancelled before the April 1st deadline will be refunded. Refunds for CLASS ENTRY FEES ONLY will be made after that date upon presentation to the Show Secretary a signed and dated Vet's Certificate on the veterinarian's letterhead, **at the time the horse is scratched from the class. STALL FEES ARE NON-REFUNDABLE ONCE THEY ARE ORDERED—NO REFUND MADE AT THE SHOW. All refunds will be mailed within 30 days of the show's ending date.**

SCRATCH FORM: Scratches using Messaging or Text Message are not accepted at all.. No credit will be given for scratched classes unless another class is entered, by the same horse, at the time of the scratch.

43. REGISTRATION REQUIREMENTS: Horses to be shown in classes designated for Purebreds (Arabian) must be registered with the Arabian Horse Association, Inc., or the Canadian Arabian Horse Registry; or, if under one year of age, be eligible for registry, and registration applied for and must be entered under full registered name. Horses to be shown in classes designated for Half-Arabian/Anglo-Arabian (HA/AA) must be registered with the Arabian Horse Association, Inc.; or be eligible for registry & registration applied for and must be entered under full registered name. **NOTE:** For competition purposes, ANY horse is considered to be one year old on the first day of January following the actual date of foaling. Therefore, a Certificate of Registration MUST have been issued for horses entered in the Sweepstakes Yearling Classes.

44. RETURNED CHECKS/DECLINED CREDIT CARDS: Exhibitors who fails to settle indebtedness to this show will automatically be barred from taking part whatsoever in any Recognized Show until settlement is made. In addition, \$100 will be assessed each time a check is returned unpaid or \$65 each time a credit card is declined. If management must avail itself of the remedies under the USEF rules, an additional \$100 penalty will be assessed for a total of \$200/\$150 (maximum). After 2nd time NSF check is received, exhibitor must have cash or certified bank check. In addition, any horse(s) entered with a returned check or declined credit card will be subject to post entry fees, unless all fees paid by the returned check/declined credit card are paid in full by the pre-entry closing date. **PREMIUM STALLING WILL NOT BE ASSIGNED UNLESS FINANCIAL OBLIGATIONS HAVE BEEN MET IN FULL.**

45. RIDER/DRIVER CLARIFICATION: Please note that rider/drivers /handler cannot be changed once a class starts. With a sectioned class, class is not over until the final is run. Therefore, a rider/driver/handler who performs in section A or B must also ride/drive/handle in the final class. Likewise, the same rider/driver/ handler cannot perform in both section A & B of the same class on two different horses.

46. SAFE SPORT STATEMENT: Effective immediately, any competition with the start date of September 1, 2020 and later will be required to include the following Safe Sport statement in the Rules and Regulation section of the prize list: Reminder: All USEF Life and Senior Active members, as well as participants who have regular contact with minor athletes, are required to comply with the U.S. Center for SafeSport training requirement to be eligible to participate in the competition. All participants must adhere to the U.S. Center for SafeSport Code, USEF Safe Sport Policy, and the Minor Athlete Abuse Prevention Policies. More information about these can be found at <http://www.usef.org>.

47. SECURITY: WEC 24-hour Security: 352.414.7960

48. SHARPS CONTAINERS: Sharps Containers: USEF GR1210.4 Competition management shall place a minimum of one Sharps Container per each competition, whether or not stabling is provided. Additionally, at least one Sharps Container per fifty occupied stalls for the disposal of needles and other disposable sharp instruments in convenient locations in barns housing competition horses.

49. SHOW OFFICE HOURS:

Monday, May 2	4:00 - 9:00 pm	Trainer appts. (6 or more owners) and General Check-In.
Tuesday, May 3	9:00 am - 5:00 pm 1:00 pm - 8:00 pm	Trainer appointments General Check-In

On show days, the office will open one (1) hour before the first session of each day and will close nightly at 9 PM or at the beginning of the last class of the day, whichever comes first. The office will close one hour following the last class on Sunday. **The Show Office will not be open on Monday after the show.** Any variations in the schedule will be announced and posted on the show office door. Exhibitors are requested to report to show office as soon as possible after arrival to pick up show packets, correct any pending items, or make entries. Trainers with six or more owners are encouraged to make an appointment.

50. **SHOW TABS:** Any exhibitor wishing to add classes or make changes in entries at the show office will be required to leave credit card information or a signed check payable to "Region 12". Show Tabs must be closed out and settled by 6:00 p.m. on Sunday. Those accounts that have not been settled by exhibitors will be charged a \$25 closing fee by the show office, checks will be filled out, and the accounts will be closed. For your convenience, we suggest that you audit your Show Tab and make settlement at the earliest possible time to avoid delays and to obtain account information.
51. **STABLING:** All stalls have doors and are permanent concrete stalls with stable comfort mattress systems and fans in a climate-controlled barn, 12'X12' and 12'X14'. Stalls may not be occupied by more than one horse at a time.
52. **STALLS - BARN DAMAGE:** Exhibitors will be financially responsible for any damage to their stalls on the premises. Do not put nails into the side-walls. Stalls must be vacated in their original condition. Stalls may not be structurally altered in any way. ALL CHARGES FOR DAMAGES THAT WEC CHARGES REGION 12 SHOW WILL BE BILLED BACK TO THE EXHIBITOR. This charge will be automatically added to your final invoice at the Show Secretary's office. Charges from the WEC billed to the Region 12 Show for removal of lumber or other items used for decorating purposes will be billed back to the exhibitor after the conclusion of the show. A \$50 clean up fee/stall will be charged for stalls with trash left behind.
53. **STALLS - PREMIUM:** Region 12 Premium Stalls will be assigned by the Region 12 Stabling Manager, based on Sponsorship Level and previous sponsor history. Overall pattern to optimize the use of barns, number of horses and payment for stalls being made in full prior to the closing date of the show. Failure to receive payment in full for any reason, will remove the exhibitor from the premium stalling areas that are being made available for the 2022 Show. Questions - please contact either your designated Sponsorship or Stabling Point of Contact.
54. **STALLIONS:** May be shown by Ladies or Junior Exhibitors in all classes except Walk/Trot. No HA/AA stallion, two years or older, may be shown in any In Hand class open to HA/AAs. HA/AA Stallions may be shown in performance- classes. HA/AA Stallions may be shown in all Sport Horse Classes.
55. **TACK CHANGES** must be reported to the Paddock Manager at least two classes ahead to permit proper notification to ring officials. A maximum three- minute hold will be allowed. Exhibitor requesting hold must notify gate promptly when tack change has been completed so class can enter ring without unnecessary delay. All tack changes must be made in paddock area. Your cooperation will help minimize delays between classes.
56. **UPDATES:** Any corrections or changes to the class schedule or rules will be published on Region 12 web site: www.aharegion12.com or during the show by postings at the Show Office.
57. **TBA CLASSES:** TBA classes may be any class on the AHA class list or that is recognized by AHA . The TBA classes must not be a duplicate of any other classes. TBAs are given on a first come first served basis only and must be reserved with the show secretary and **must be approved by the show committee**. Show management reserves the right to allocate TBA slots in a manner to facilitate the flow of the show. If a TBA class is not requested the class number will be canceled and the next class will begin immediately. There will be 10 TBA Classes available.

Region 12 Events and Dates

REGION 12 40 MILE CTR CHAMPIONSHIP
02/04/2022
FLORIDA HORSE PARK
OCALA, FL
www.distanceriding.org

ALABAMA & LOUISIANA ARABIAN HORSE SHOW
03/24/2022 - 03/28/2022
WEST MONROE, LA
www.alabamaraabian.com

OCALA ARABIAN ANNUAL AMATEUR SHOW
04/2/2022 - 04/03/2022
WORLD EQUESTRIAN CENTER
OCALA, FL
www.oaha.org

SPRING FLING VALUE SHOW
04/03/2022
GARRISON ARENA
PENDLETON, SC
www.wcaha.org

NCAHA/HAHA QUALIFYING SHOW A/B
04/08/22 - 04/10/22
HUNT HORSE COMPLEX
RALEIGH, NC
WWW.NCAHA.COM

ANNUAL MAGNOLIA SPRING CLASSIC A & B
04/22/2022-04/24/2022
GEORGIA NATIONAL FAIRGROUNDS
PERRY, GA
www.magnoliaaha.org

REGION 12 CHAMPIONSHIP
05/04/2022 - 05/08/2022
WORLD EQUESTRIAN CENTER OCALA
OCALA, FL
www.aharegion12.com

REGION 12 100 MILE ENDURANCE
05/07/2022
ASHVILLE, NC

PALMETTO SPORT HORSE CLASSIC A & B
06/03/2022-06/05/2022
CLEMSON, SC
www.magnoliaaha.org

ARABIAN SPORT HORSE GATOR CUP
06/10/2022-06/12/2022
NEWBERRY, FL

SUMMER SADDLE UP AVS & OPEN HORSE SHOW
07/30/22 - 07/31/22
PENDLETON, SC
rlobermiller@gmail.com

MUSIC CITY FALL FESTIVAL OF HORSES VALUE SHOW
09/10/2022 - 09/11/2022
JAMES E WARD AG CENTER
LEBANON, TN
nashfad@aol.com

ORLANDO ARABIAN SPORT HORSE SPOOKTACULAR
10/21/2022-10/23/2022
APOPKA, FL

AHAF HOLIDAY FESTIVAL A & B
11/24/2022 - 11/27/2022
WORLD EQUESTRIAN CENTER OCALA
OCALA, FL
www.ahafloida.org

SPOTLIGHT FUTURITY ENTRY AND STALLION INFORMATION

All Spotlight Futurity class entry owners must complete a W-9 form and submit it with show entries.

Show exhibitor numbers will not be given out until a completed W-9 form is received.

Futurity Nominated Stallions who have come to the Auction to be presented, but are not entered in the show, must also complete an entry form and submit it to the show secretary, complete with signatures, office fees, and health papers.

Stalls are free for Futurity Nominated Stallions if they are not exhibiting in the show.

NOTE: Spotlight registration number must be included on your entry form.

Please go to www.spotlightfuturity.com to obtain your number. If you need assistance, please contact: Kenna Burbeck - 678-523-1955

<p>Form W-9 (Rev. October 2018) Department of the Treasury Internal Revenue Service</p>	<p>Request for Taxpayer Identification Number and Certification</p> <p>► Go to www.irs.gov/FormW9 for instructions and the latest information.</p>	<p>Give Form to the requester. Do not send to the IRS.</p>
--	---	--

Print or type. See Specific Instructions on page 3.	<p>1 Name (as shown on your income tax return). Name is required on this line; do not leave this line blank.</p> <p>2 Business name/disregarded entity name, if different from above</p> <p>3 Check appropriate box for federal tax classification of the person whose name is entered on line 1. Check only one of the following seven boxes.</p> <p><input type="checkbox"/> Individual/sole proprietor or single-member LLC <input type="checkbox"/> C Corporation <input type="checkbox"/> S Corporation <input type="checkbox"/> Partnership <input type="checkbox"/> Trust/estate</p> <p><input type="checkbox"/> Limited liability company. Enter the tax classification (C=C corporation, S=S corporation, P=Partnership) ► _____</p> <p>Note: Check the appropriate box in the line above for the tax classification of the single-member owner. Do not check LLC if the LLC is classified as a single-member LLC that is disregarded from the owner unless the owner of the LLC is another LLC that is not disregarded from the owner for U.S. federal tax purposes. Otherwise, a single-member LLC that is disregarded from the owner should check the appropriate box for the tax classification of its owner.</p> <p><input type="checkbox"/> Other (see instructions) ► _____</p>	<p>4 Exemptions (codes apply only to certain entities, not individuals; see instructions on page 3):</p> <p>Exempt payee code (if any) _____</p> <p>Exemption from FATCA reporting code (if any) _____</p> <p><small>(Applies to accounts maintained outside the U.S.)</small></p>
	<p>5 Address (number, street, and apt. or suite no.) See instructions.</p> <p>6 City, state, and ZIP code</p> <p>7 List account number(s) here (optional)</p>	<p>Requester's name and address (optional)</p>

Part I Taxpayer Identification Number (TIN)

Enter your TIN in the appropriate box. The TIN provided must match the name given on line 1 to avoid backup withholding. For individuals, this is generally your social security number (SSN). However, for a resident alien, sole proprietor, or disregarded entity, see the instructions for Part I, later. For other entities, it is your employer identification number (EIN). If you do not have a number, see *How to get a TIN*, later.

Note: If the account is in more than one name, see the instructions for line 1. Also see *What Name and Number To Give the Requester* for guidelines on whose number to enter.

Social security number					
<table style="width: 100%; border-collapse: collapse;"> <tr> <td style="width: 25%; border: 1px solid black; height: 20px;"></td> <td style="width: 5%; border: 1px solid black; text-align: center;">-</td> <td style="width: 25%; border: 1px solid black; height: 20px;"></td> <td style="width: 5%; border: 1px solid black; text-align: center;">-</td> <td style="width: 40%; border: 1px solid black; height: 20px;"></td> </tr> </table>		-		-	
	-		-		
or					
Employer identification number					
<table style="width: 100%; border-collapse: collapse;"> <tr> <td style="width: 25%; border: 1px solid black; height: 20px;"></td> <td style="width: 5%; border: 1px solid black; text-align: center;">-</td> <td style="width: 70%; border: 1px solid black; height: 20px;"></td> </tr> </table>		-			
	-				

Part II Certification

Under penalties of perjury, I certify that:

- The number shown on this form is my correct taxpayer identification number (or I am waiting for a number to be issued to me); and
- I am not subject to backup withholding because: (a) I am exempt from backup withholding, or (b) I have not been notified by the Internal Revenue Service (IRS) that I am subject to backup withholding as a result of a failure to report all interest or dividends, or (c) the IRS has notified me that I am no longer subject to backup withholding; and
- I am a U.S. citizen or other U.S. person (defined below); and
- The FATCA code(s) entered on this form (if any) indicating that I am exempt from FATCA reporting is correct.

Certification instructions. You must cross out item 2 above if you have been notified by the IRS that you are currently subject to backup withholding because you have failed to report all interest and dividends on your tax return. For real estate transactions, item 2 does not apply. For mortgage interest paid, acquisition or abandonment of secured property, cancellation of debt, contributions to an individual retirement arrangement (IRA), and generally, payments other than interest and dividends, you are not required to sign the certification, but you must provide your correct TIN. See the instructions for Part II, later.

Sign Here	Signature of U.S. person ►	Date ►
------------------	----------------------------	--------

General Instructions

Section references are to the Internal Revenue Code unless otherwise noted.

Future developments. For the latest information about developments related to Form W-9 and its instructions, such as legislation enacted after they were published, go to www.irs.gov/FormW9.

Purpose of Form

An individual or entity (Form W-9 requester) who is required to file an information return with the IRS must obtain your correct taxpayer identification number (TIN) which may be your social security number (SSN), individual taxpayer identification number (ITIN), adoption taxpayer identification number (ATIN), or employer identification number (EIN), to report on an information return the amount paid to you, or other amount reportable on an information return. Examples of information returns include, but are not limited to, the following.

- Form 1099-INT (interest earned or paid)
- Form 1099-DIV (dividends, including those from stocks or mutual funds)
- Form 1099-MISC (various types of income, prizes, awards, or gross proceeds)
- Form 1099-B (stock or mutual fund sales and certain other transactions by brokers)
- Form 1099-S (proceeds from real estate transactions)
- Form 1099-K (merchant card and third party network transactions)
- Form 1098 (home mortgage interest), 1098-E (student loan interest), 1098-T (tuition)
- Form 1099-C (canceled debt)
- Form 1099-A (acquisition or abandonment of secured property)

Use Form W-9 only if you are a U.S. person (including a resident alien), to provide your correct TIN.

If you do not return Form W-9 to the requester with a TIN, you might be subject to backup withholding. See What is backup withholding, later.

THANK YOU GRAND ARENA SPONSOR

REGION XII CHAMPIONSHIP HORSE SHOW



2022
WORLD
EQUESTRIAN CENTER™

OCALA, FLORIDA

Mail To:
 Ringside Productions
 P.O. Box 508
 Bonne Terre, MO 63628
 Phone: 314-717-7683
 Email: ryan@ringsideproductionsllc.com

REGION XII CHAMPIONSHIP SHOW

May 4th – 8th, 2022

World Equestrian Center—Ocala, FL



Online Entries Are Now Available At:
www.ringsideproductionsllc.com

PRE-ENTRY DEADLINE APRIL 1st, 2022

All entries must be complete including correct fees & signed waivers. Memberships must be current, and all Registration Transfers must be complete or pay an Incomplete Entry Fee of \$10.

Name of First Horse	Registration Number	DOB	Sex	Color	Spotlight Reg. #	Sweepstakes <input type="checkbox"/> Yes <input type="checkbox"/> No
	Sire	Dam	USEF Horse ID#	USDF Horse ID #	Entry Fees	
Rider/Diver/Handler	AHA #	USDF#	Class Numbers			\$
	USEF/EC #					
Rider/Diver/Handler	AHA #	USDF#	Class Numbers			\$
	USEF/EC #					

FOR MORE THAN TWO RIDERS WITH SAME HORSE, USE NEXT TABLE, LEAVING HORSE DATA BLANK

Name of Second Horse	Registration Number	DOB	Sex	Color	Spotlight Reg. #	Sweepstakes <input type="checkbox"/> Yes <input type="checkbox"/> No
	Sire	Dam	USEF Horse ID #	USDF Horse ID #	Entry Fees	
Rider/Diver/Handler	AHA #	USDF #	Class Numbers			\$
	USEF/EC #					
Rider/Diver/Handler	AHA #	USDF #	Class Numbers			\$
	USEF/EC #					

Each person signing this entry form acknowledges that he/she has read the front and reverse side of this entry form and agrees to the applicable terms, conditions, waivers and consent as set forth herein. Each person agrees that the information is accurate to the best of his/her knowledge. All OWNERS, RIDERS, DRIVERS & HANDLERS MUST SIGN ON THE BACK. Minor entrants must also have parent/guardian signature(s) on the back.

TOTAL CLASS FEES \$ _____

OWNER (exactly as it appears on registration papers) **ONLY ONE OWNER PER ENTRY FORM**

Name _____ AHA # _____
 Address _____ USEF / EC # _____
 City, State, Zip _____ Phone _____
 e-mail _____ Owner USDF # _____

TRAINER _____ AHA # _____
 Address _____ USEF / EC # _____
 City, State, Zip _____ Phone _____
 E-mail _____ Walk Trot Rider's Birth date: _____
 Your entry Acknowledgment will be sent via email with an attachment.

Amateur Owner Relationship to Horse Owner _____
 Emergency Phone: _____

STABLE WITH _____
 (Send request for joint stabling in the same envelope or use form on Page 35.)

All Credit Card Info must be complete. (See Declined Credit Card Fee, Rule #43)

Credit Card info: VISA / MC / Amex _____ - _____ - _____

Expiration Date ____/____/____ CVV2 Code _____ Billing Zip Code _____

Required Fees Per Horse:	
Horse Stalls @ \$165 each	\$ _____
Tack Stalls @ \$165 each	\$ _____
Office Fee @ \$30	\$ _____
AHA 9-90/Results Fee @ \$25	\$ _____
USEF Drug & Med @ \$23 ((\$15 Drug; \$8 Admin.)	\$ _____

Post Entry Fee \$50 (after 4/1)	\$ _____
Early Arrival Fee \$30 (Per Horse/Per Day)	\$ _____
Diamond Sponsor \$5000	\$ _____
Gold Sponsor \$1200	\$ _____
Silver Sponsor \$600	\$ _____
Bronze Sponsor \$250	\$ _____
Garland Sponsor \$65	\$ _____
TBA Class Fee: \$100	\$ _____
Spotlight Fut. Off. Fee \$20	\$ _____
Add'l. Hunter Warm Ups \$20	\$ _____
USEF Show Pass \$45	\$ _____
Shavings \$9.50/bag	\$ _____
Credit Card Fee 4%	\$ _____

Total Fees: \$ _____

Make Checks Payable To:
 Region XII

ENTRY AGREEMENT

I have read the rules concerning competitions as printed in the Arabian Horse Association (AHA) Handbook / Directory and Competition Prize List and agree to be bound by and subject to those Rules.

AHA ASSUMPTION OF RISK, RELEASE AND INDEMNIFICATION This document waives very important legal rights. Read it carefully before signing.

In consideration for AHA permitting me to participate in this Competition, and by signing the entry blank, I agree as follows:

I AGREE that I choose to participate voluntarily in this Competition, as a rider, driver, handler, lessee, owner, agent, coach, trainer, junior exhibitor, or as a parent or guardian of a junior exhibitor. I AM FULLY AWARE AND ACKNOWLEDGE THAT HORSE SPORTS AND PARTICIPATION IN THIS COMPETITION INVOLVE SERIOUS RISK OF HARM INCLUDING, BUT NOT LIMITED TO, RISKS OF ACCIDENT, SERIOUS BODILY INJURY, INCLUDING DEATH, BROKEN BONES, HEAD INJURIES, TRAUMA, PAIN, AND SUFFERING, AND PROPERTY DAMAGE. I ASSUME ALL RISKS OF HARM TO ME, MY HORSE OR MY PROPERTY.

I AGREE as a Horse Show Participant (or Parent/Guardian of Participant if a minor) to waive all claims which may otherwise arise from, including but not limited to infectious bacteria, viruses, fungi/mold, parasites or other agents which may be present at the Horse Show (and most other outdoor locations) and can cause infection in humans, as well as in animals.

I AGREE for myself, my heirs, executors, administrators, successors and assigns to release AHA, the Competition, the facilities leased by the Competition and the owner(s) of the facilities, and all of their respective officers, officials, directors, employees, agents, personnel, volunteers, affiliated organizations and insurers (collectively, the "Released Parties") from any and all claims for damage, loss, or injury to myself, other persons, horses or other property belonging to me to the fullest extent permitted by law that arises out of or relates in any way to the Competition and my participation in the Competition INCLUDING, BUT NOT LIMITED TO, DAMAGES, LOSS, OR INJURY RESULTING FROM ANY ACTS, FAILURE TO ACT, NEGLIGENCE OR NEGLIGENCE OF OTHER ENTRANTS, THE RELEASED PARTIES, THEIR CONTRACTORS OR INVITEES, as well as for theft, vandalism, fire, other casualty damage, or damage arising out of any defects in the premises.

I AGREE to indemnify and hold harmless (that is pay all losses, damages, attorneys fees and costs of) the Released Parties from and against any and all claims, demands, penalties, actions, losses, costs, damages, injuries, liabilities and obligations (including attorneys fees) of whatsoever kind and nature, which may be asserted against or incurred by any of them as a result of (1) my participation in the Competition or (2) any act, failure to act, or neglect (a) by me, my agents, employees, riders, handlers, trainers, coaches, drivers, contractors or invitees, or (b) by any animal owned or exhibited by me or in my custody or control.

I AGREE and represent that I am qualified and eligible to enter and/or participate in the Competition, and every horse I am entering is qualified and eligible as entered.

I AGREE to accept AS FINAL any decision of AHA, the Show Commission or Show Officials concerning my qualification or the qualification of my horse to enter the Competition or any results of the Competition, except to the extent that the Rules of AHA, the Competition, EC or USEF Equestrian permit a protest or hearing of such decisions. Should a hearing be requested, I agree to accept AS FINAL the decision of the particular hearing body. I agree to release, hold harmless and not to sue AHA, the Competition Sponsor, their officers, directors, employees, volunteers or members concerning any decision of AHA, the Competition, its Show Commission, Show Officials or any hearing body that relates to my qualifications or my horse(s)' qualifications to enter the Competition or any results of the Competition.

I AGREE that AHA has the sole right to control, sell, supervise or give away (or assign to others the right to do so) the exclusive rights to broadcast, televise, reproduce, transmit and disseminate all or part of this event, and I agree that AHA may use or assign, in any way AHA sees fit, photographs, films, videos, audios, cablecasts, or other likenesses of me and my horse taken during the course of the Competition for the promotion, coverage or benefit of the Competition or AHA. Those likenesses shall not be used to advertise a product and they may not be used in such a way which implies endorsement of any company, product, product category or service. I hereby expressly and irrevocably waive and release any rights in connection with such use, including any claim to compensation, invasion of privacy, right of publicity, or to misappropriation.

By signing below as a parent or guardian of a junior exhibitor, I consent to the child's participation and agree to all of the above provisions, and further agree to assume all of the obligations of this AHA Assumption of Risk, Release and Indemnification personally and on behalf of the child.

This AHA Assumption of Risk, Release and Indemnification is governed by the Laws of the State of Colorado and is intended to be interpreted as broadly as possible. I agree that exclusive jurisdiction and venue (place) for any legal action against AHA, its officers, directors, employees, volunteers or agents shall be in the local district courts or the federal court of the State of Colorado. If any part of this agreement is determined to be unenforceable, all other parts shall remain effect.

USEF FEDERATION ENTRY AGREEMENT

By entering a Federation-licensed Competition and signing this entry blank as the Owner, Lessee, Trainer, Manager, Agent, Coach, Driver, Rider, Handler, Vaultor or Longeur and on behalf of myself and my principals, representatives, employees and agents, I agree that I am subject to the Bylaws and Rules of The United States Equestrian Federation, Inc. (the "Federation") and the local rules of the Arabian Horse Association _____ (competition). I agree to be bound by the Bylaws and Rules of the Federation and of the competition. I will accept as final the decision of the Hearing Committee on any question arising under the Rules, and agree to release and hold harmless the competition, the Federation, their officials, directors and employees for any action taken under the Rules. I represent that I am eligible to enter and/or participate under the Rules, and every horse I am entering is eligible as entered.

I also agree that as a condition of and in consideration of acceptance of entry, the Federation and/or the Competition may use or assign photographs, videos, audios, cable - casts, broadcasts, internet, film, new media or other likenesses of me and my horse taken during the course of the competition for the promotion, coverage or benefit of the competition, sport, or the Federation. Those likenesses shall not be used to advertise a product and they may not be used in such a way as to jeopardize amateur status. I hereby expressly and irrevocably waive and release any rights in connection with such use, including any claim to compensation, invasion of privacy, right of publicity, or to misappropriation. The construction and application of Federation rules are governed by the laws of the State of New York, and any action instituted against the Federation must be filed in New York State. See GR908.4.

I HAVE CAREFULLY READ THIS DOCUMENT IN ITS ENTIRETY, UNDERSTAND ALL OF ITS TERMS AND CONDITIONS, AND KNOW IT CONTAINS AN ASSUMPTION OF RISK, RELEASE AND WAIVER FROM LIABILITY, AS WELL AS A HOLD HARMLESS AND INDEMNIFICATION OBLIGATIONS.

By signing below, I (as the participant or as the Parent/Legal Guardian of the minor identified below) hereby accept and agree to the terms and conditions of this Agreement in connection with my (or the minor's) participation in any USEF Event. If, despite this Agreement, I, or anyone on my behalf or the minor's behalf, makes a claim for Liability against any of the Released Parties, I will indemnify, defend and hold harmless each of the Released Parties from any such Liabilities as the result of such claim.

BY SIGNING BELOW, I AGREE to be bound by all applicable Federation Rules and all terms and provisions of this entry blank and all terms and provisions of this Prize List. If I am signing and submitting this Agreement electronically, I acknowledge that my electronic signature shall have the same validity, force and effect as if I affixed my signature by my own hand.

Owner ** Mandatory Must be Adult	Print Name	**Adult Signature
Trainer or Custodian of horse @ show ** Mandatory Must be Adult	Print Name	**Adult Signature
Rider 1 ** Mandatory Must be Adult	Print Name	**Adult Signature
Rider 2 ** Mandatory Must be Adult	Print Name	**Adult Signature
Coach – (if applicable) USEF #	Print Name	**Adult Signature
Print Minor Name Here	Print Parent/Guardian Name Here	**Adult Signature
Print Minor Name Here	Print Parent/Guardian Name Here	**Adult Signature
***** EMERGENCY PHONE NUMBER FOR EXHIBITOR		
MUST BE SIGNED IN AT LEAST 3 PLACES BY ADULTS ONLY AHA or USEF/EC Membership is not required for Parents/Guardians signing for minors.		

USEF WAIVER AND RELEASE OF LIABILITY, ASSUMPTION OF RISK AND INDEMNITY AGREEMENT

For and in consideration of United States Equestrian Federation, Inc. dba US Equestrian (“USEF”) allowing me, the undersigned, to participate in any capacity (including as a rider, driver, handler, vaulter, longeur, lessee, owner, agent, coach, official, trainer or volunteer) in a USEF sanctioned, licensed or approved event or activity, including but not limited to equestrian clinics, practices, shows, competitions and related or incidental activities of the Arabian Horse Association Events (“USEF Event” or “USEF Events”); I, for myself, and on behalf of my spouse, children, heirs and next of kin, and any legal and personal representatives, executors, administrators, successors, and assigns, hereby agree to and make the following contractual representations pursuant to this Agreement (the “Agreement”):

A. RULES AND REGULATIONS: I hereby agree to be bound and abide by the rules, regulations, and policies of USEF as published in the USEF Rule Book and on the website at www.usef.org, as amended from time to time.

B. ACKNOWLEDGMENT OF RISK: I knowingly, willingly, and voluntarily acknowledge the inherent risks associated with the sport of equestrian and know that horseback riding and related equestrian activities are inherently dangerous, and that participation in any USEF Event involves risks and dangers including, without limitation, the potential for serious bodily injury (including broken bones, head or neck injuries), sickness and disease (including communicable diseases), trauma, pain & suffering, permanent disability, paralysis and death; loss of or damage to personal property (including my mount & equipment) arising out of the unpredictable behavior of horses; exposure to extreme conditions and circumstances; accidents involving other participants, event staff, volunteers or spectators; contact or collision with other participants and horses, natural or manmade objects; adverse weather conditions; facilities issues and premises conditions; failure of protective equipment (including helmets); inadequate safety measures; participants of varying skill levels; situations beyond the immediate control of the USEF Event organizers and competition management; and other undefined, not readily foreseeable and presently unknown risks and dangers (“Risks”).

EQUINE ACTIVITY LIABILITY ACT WARNING:

CAUTION: HORSEBACK RIDING AND EQUINE ACTIVITIES CAN BE DANGEROUS. RIDE AT YOUR OWN RISK.

Under the laws of most States, an equine activity sponsor or equine professional is not liable for any injury to, or the death of, a participant in equine activities resulting from the inherent risks of equine activities.

C. ASSUMPTION OF RISK: I understand that the aforementioned Risks may be caused in whole or in part or result directly or indirectly from the negligence of my own actions or inactions, the actions or inactions of others participating in the USEF Events, or the negligent acts or omissions of the Released Parties defined below, and I hereby voluntarily and knowingly assume all such Risks and responsibility for any damages, liabilities, losses, or expenses that I incur as a result of my participation in any USEF Events. I also agree to be responsible for any injury or damage caused by me, my horse, my employees or contractors under my direction and control at any USEF Event.

D. WAIVER AND RELEASE OF LIABILITY, HOLD HARMLESS AND INDEMNITY: In conjunction with my participation in any USEF Event, I hereby release, waive and covenant not to sue, and further agree to indemnify, defend and hold harmless the following parties: USEF, USEF Recognized Affiliate Associations, the United States Olympic & Paralympic Committee (USOPC), USEF clubs, members, Event participants (including athletes/riders, coaches, trainers, judges/officials, and other personnel), the Event owner, licensee, and competition managers; the promoters, sponsors, or advertisers of any USEF Event; any charity or other beneficiary which may benefit from the USEF Event; the owners, managers, or lessors of any facilities or premises where a USEF Event may be held; and all directors, officers, employees, agents, contractors, and volunteers of any of the aforementioned parties (**Individually and Collectively, the “Released Parties” or “Event Organizers”**), with respect to any liability, claim(s), demand(s), cause(s) of action, damage(s), loss, or expense (including court costs and reasonable attorney fees) of any kind or nature (“Liability”) which may arise out of, result from, or relate in any way to my participation in the USEF Events, including claims for Liability caused in whole or in part by the negligent acts or omissions of the Released Parties.

E. COMPLETE AGREEMENT AND SEVERABILITY CLAUSE: This Agreement represents the complete understanding between the parties regarding these issues and no oral representations, statements or inducements have been made apart from this Agreement. If any provision of this Agreement is held to be unlawful, void, or for any reason unenforceable, then that provision shall be deemed severable from this Agreement and shall not affect the validity and enforceability of any remaining provisions.

I HAVE CAREFULLY READ THIS DOCUMENT IN ITS ENTIRETY, UNDERSTAND ALL OF ITS TERMS AND CONDITIONS, AND KNOW IT CONTAINS AN ASSUMPTION OF RISK, RELEASE AND WAIVER FROM LIABILITY, AS WELL AS A HOLD HARMLESS AND INDEMNIFICATION OBLIGATIONS.

By signing below, I (as the participant or as the Parent/Legal Guardian of the minor identified below) hereby accept and agree to the terms and conditions of this Agreement in connection with my (or the minor’s) participation in any USEF Event. If, despite this Agreement, I, or anyone on my behalf or the minor’s behalf, makes a claim for Liability against any of the Released Parties, I will indemnify, defend and hold harmless each of the Released Parties from any such Liabilities as the result of such claim.

The parties agree that this agreement may be electronically signed. The parties agree that the electronic signatures appearing on this agreement are the same as handwritten signatures for the purposes of validity, enforceability, and admissibility.

Owner ** Mandatory Must be Adult	Print Name	**Adult Signature
Trainer or Custodian of horse @ show ** Mandatory Must be Adult	Print Name	**Adult Signature
Rider 1 ** Mandatory Must be Adult	Print Name	**Adult Signature
Rider 2 ** Mandatory Must be Adult	Print Name	**Adult Signature
Coach – (if applicable) USEF #	Print Name	**Adult Signature
Print Minor Name Here	Print Parent/Guardian Name Here	**Adult Signature
Print Minor Name Here	Print Parent/Guardian Name Here	**Adult Signature
***** EMERGENCY PHONE NUMBER FOR EXHIBITOR		
MUST BE SIGNED IN AT LEAST 3 PLACES BY <u>ADULTS ONLY</u> AHA or USEF/EC Membership is not required for Parents/Guardians signing for minors.		



FEDERATION ENTRY AGREEMENT

By entering a Federation-licensed Competition and signing this entry blank as the Owner, Lessee, Trainer, Manager, Agent, Coach, Driver, Rider, Handler, Vaultler or Longeur and on behalf of myself and my principals, representatives, employees and agents, I agree that I am subject to the Bylaws and Rules of The United States Equestrian Federation, Inc. (the "Federation") and the local rules of _____(Competition). I agree to be bound by the Bylaws and Rules of the Federation and of the competition. I will accept as final the decision of the Hearing Committee on any question arising under the Rules, and agree to release and hold harmless the competition, the Federation, their officials, directors and employees for any action taken under the Rules. I represent that I am eligible to enter and/or participate under the Rules, and every horse I am entering is eligible as entered. I also agree that as a condition of and in consideration of acceptance of entry, the Federation and/or the Competition may use or assign photographs, videos, audios, cable - casts, broadcasts, internet, film, new media or other likenesses of me and my horse taken during the course of the competition for the promotion, coverage or benefit of the competition, sport, or the Federation. Those likenesses shall not be used to advertise a product and they may not be used in such a way as to jeopardize amateur status. I hereby expressly and irrevocably waive and release any rights in connection with such use, including any claim to compensation, invasion of privacy, right of publicity, or to misappropriation. The construction and application of Federation rules are governed by the laws of the State of New York, and any action instituted against the Federation must be filed in New York State. See GR908.4.

BY SIGNING BELOW, I AGREE that I have read, understand, and agree to be bound by all applicable Federation Bylaws, rules, and policies including the USEF Safe Sport Policy and Minor Athlete Abuse Prevention Policies (MAAPP) as published at www.usef.org, as amended from time to time, as well as all terms and provisions of this Prize List. If I am signing and submitting this Agreement electronically, I acknowledge that my electronic signature shall have the same validity, force and effect as if I affixed my signature by my own hand.

RIDER/DRIVER/HANDLER/VAULTER/LONGEUR (mandatory)

Signature: _____

Print Name: _____

TRAINER (mandatory)

Signature: _____

Print Name: _____

OWNER/AGENT (mandatory)

Signature: _____

Print Name: _____

COACH (if applicable)

Signature: _____

Print Name: _____

Parent/Guardian Signature: (Required if Rider/Driver/Handler/Vaultler/Longeur is a minor) _____

Print Parent//Guardian Name: _____ Emergency Contact Phone No. _____

Is Rider/Driver/Vaultler a U.S. Citizen: Yes No

Regional Qualification Form

Horse Name: _____

Reg Class # Qualifying for	Qualifying Class Name	Show Name & Date
-------------------------------	-----------------------	------------------

Reg Class # Qualifying for	Qualifying Class Name	Show Name & Date
-------------------------------	-----------------------	------------------

Reg Class # Qualifying for	Qualifying Class Name	Show Name & Date
-------------------------------	-----------------------	------------------

Reg Class # Qualifying for	Qualifying Class Name	Show Name & Date
-------------------------------	-----------------------	------------------

Horse Name: _____

Reg Class # Qualifying for	Qualifying Class Name	Show Name & Date
-------------------------------	-----------------------	------------------

Reg Class # Qualifying for	Qualifying Class Name	Show Name & Date
-------------------------------	-----------------------	------------------

Reg Class # Qualifying for	Qualifying Class Name	Show Name & Date
-------------------------------	-----------------------	------------------

Reg Class # Qualifying for	Qualifying Class Name	Show Name & Date
-------------------------------	-----------------------	------------------

Join Us for the Region 12
Spotlight Stallion Auction Party

RAJPUJANA

“A TASTE OF ROYAL INDIA”

Wednesday • May 4th • 5:30 p.m.
on the WEC Hotel Terraces

Come show your support for the program and
enjoy Special Food, Drinks, Friends & Fun during
our Live Auction!

Social Hour begins at 5:30 p.m. on Wednesday evening,
with the auction to follow at 6:30 p.m.

For a list of nominated stallions visit
our website at:
WWW.SPOTLIGHTFUTURITY.COM



Spotlight
Futurity

2022 Region 12 Tentative Class Schedule

Judges: Brian Ferguson Bob Gordon Scott Brumfield

** Classes restricted to horses who have previously enrolled in the Spotlight Futurity program

\$ = Allocated Regional Prize Money Classes

Tuesday at 6:00pm in Mezzanine Arena #4 - Exhibitor/Trainer Meeting followed by the Region 12 Annual Meeting

Wed. Morning Session - May 4, 2022 - 7:30 am – Hunter 4 Arena

Draws for Orders of Go will be Tuesday at 6 p.m. in the Show Office

1	1389	Reg 12 A/HA/AA In-hand Eng/WestTrail, Open
2	1391	Reg 12 A/HA/AA In-hand Eng/West Trail, ATH
3	211	Reg 12 Arabian Western Trail Horse, Open
4	646	Reg 12 HA/AA Western Trail Horse, Open
5	214	Reg 12 Arabian Western Trail Horse, AAOTR
6	649	Reg 12 HA/AA Western Trail Horse, AAOTR
7	217	Reg 12 Arabian Western Trail Horse, ATR
8	652	Reg 12 HA/AA Western Trail Horse, ATR
9	180	Reg 12 Arabian English Trail Horse, Open
10	692	Reg 12 HA/AA English Trail Horse, Open
11	226	Reg 12 Arabian Reining Horse Open
12	661	Reg 12 HA/AA Reining Horse Open
13	231	Reg 12 Arabian Reining Horse ATR
14	666	Reg 12 HA/AA Reining Horse ATR
15	3007	Reg 12 Arabian Ranch Horse Riding, Open
16	3027	Reg 12 HA/AA Ranch Horse Riding, Open
17	3009	Reg 12 Arabian Ranch Horse Riding, ATR
18	3029	Reg 12 HA/AA Ranch Horse Riding, ATR
19	1372	Reg 12 A/HA/AA Showmanship in Hand, AATH
20	1359	Reg 12 A/HA/AA Western Horsemanship, AATR
21		TBA

Wednesday Afternoon - 1 Hour after morning session - Indoor Arena 4

Draws for Orders of Go will be Tuesday at 6 p.m. in the Show Office

22		TBA
23	2086	Reg 12 Arabian Stallion Breeding 2 YO, Open
24	3084	Reg 12 HA/AA Mare Breeding 2 YO, Open
25	2087	Reg 12 HA/AA Geldings in Hand 2 YO, Open
26	3083	Reg 12 Arabian Geldings in Hand 2 YO, Open
27	403	Reg 12 HA/AA Mare Breeding Saddle/Pleas Type 3 & Over
28	405	Reg 12 HA/AA Mare Breeding Stock/Hunter Type 3 & Over
29		<i>Reg XII Spotlight Futurity Yrlg Colts Auction Class, AOTH**</i>
30	453	Reg 12 HA/AA Gelding in Hand Saddle/Pleas Type 3 & Over
31	455	Reg 12 HA/AA Gelding in Hand Stock/Hunter Type 3 & Over
32	1079	Reg 12 HA/AA Yearling Fillies Breeders Sweepstakes
33	4	Reg 12 Arabian Mare Breeding 2 & Over, AOTH
34		<i>Reg XII Spotlight Futurity Yrlg Fillies Auction Class, AOTH**</i>

Thursday Morning Session - May 5, 2022 - 8:00 am - Indoor Arena 4

35	578	Reg 12 HA/AA Country Pleasure Driving, AOTD
36	1646	Reg 12 Arabian Country English Pleasure, AAOTR 19-54
37	306	Reg 12 Arabian Hunter Pleasure, Junior Horse
38	1637	Reg 12 HA/AA Western Pleasure, AAOTR 19-54
39	173	Reg 12 Arabian Ladies Side Saddle Western, Open
40		<i>Reg XII Spotlight Futurity English Pleas Maturity 5 YO, ATR**</i>
41	1644	Reg 12 Arabian Hunter Pleasure, AAOTR 19-54
42	734	Reg 12 HA/AA Hunter Pleasure, Open
43	2637	Reg 12 HA/AA Country English Pleasure, ATR Select Rider
44	908	Reg 12 A/HA/AA Saddle Seat Eq. Walk/Trot 10 & Under
45		TBA

Thursday Afternoon - 1 Hour after Morning Session - Indoor Arena 4

46	29	Reg 12 Arabian Gelding In Hand 2 & Over, AOTH
47	117	Reg 12 Arabian Pleasure Driving, Open
48	2347	Reg 12 HA/AA Ranch Rail Pleasure, ATR
49	2150	Reg 12 HA/AA Country English Pleasure, JOTR
50	1736	Reg 12 Arabian Ranch Rail Pleasure, ATR
51		<i>Reg XII Spotlight Futurity Hunter Pleasure Maturity, 5 YO ATR**</i>
52	1646	Reg 12 Arabian Country English Pleasure, AAOTR 55+
53	1638	Reg 12 HA/AA Hunter Pleasure, JOTR
54	1647	Reg 12 Arabian English Pleasure, AAOTR
55	608	Reg 12 HA/AA Ladies Side Saddle English, Open
56	3137	Reg 12 HA/AA Western Pleasure, ATR Select Rider
57	591	Reg 12 HA/AA Mounted Native Costume, Open
58	1649	Reg 12 Arabian Western Pleasure, JOTR
59	895	Reg 12 A/HA/AA Country English Pleasure Walk/Trot, 10 & Under
60		<i>Reg XII Spotlight Futurity Western Pleas Maturity 5 YO, ATR**</i>
61	2115	Reg 12 Arabian Country English Pleasure, JTR
62		TBA

Thursday Evening - 1 Hour after Afternoon Session - Grand Outdoor Arena

63	96	Reg 12 Arabian Country English Pleasure, Open
64	558	Reg 12 HA/AA Country English Pleasure, AATR
65	397	Reg 12 Arabian Western Pleasure, AATR
66	322	Reg 12 Arabian English Show Hack, AATR
67	91	Reg 12 Arabian English Pleasure, Junior Horse
68	750	Reg 12 HA/AA Hunter Pleasure, AATR
69	151	Reg 12 Arabian Mounted Native Costume, Open
70	506	Reg 12 HA/AA Park Horse, ATR
71		<i>Reg XII Spotlight Futurity Yearling Colts, ATH Sec A/B**</i>

NOTE: All Halter classes will use the "In Ring" Procedure.

NOTE: Halter classes will use the Comparative Scoring System



Region 12 Celebration & Spotlight Stallion Auction

Wednesday Evening, May 4th at 5:30 pm at the
Grand Hotel Arena.

ALL ARE WELCOME!

**Exhibitor/Trainer Meeting
followed by the
Region 12 Annual Meeting
Tuesday at 6:00pm
in Mezzanine Arena #4.**

2022 Region 12 Tentative Class Schedule - Continued

Judges: Brian Ferguson Bob Gordon Scott Brumfield

** Classes restricted to horses who have previously enrolled in the Spotlight Futurity program

\$ = Allocated Regional Prize Money Classes

Friday Morning Session - May 6, 2022, - 8:00 am - Indoor Arena 4

72	17	Reg 12 Arabian Stallion Breeding 2 & Over, AOTH
73	27	Reg 12 Arabian Gelding In Hand 3 & Over, Open
74	2088	Reg 12 Arabian Mare Breeding 2 YO, Open
75	2	Reg 12 Arabian Yearling Fillies, Open
76	15	Reg 12 Arabian Yearling Colts, Open
77		<i>Reg XII Spotlight Futurity, 2 YO Colts, ATH **</i>
78	562	Reg 12 HA/AA Pleasure Driving, Open
79	755	Reg 12 HA/AA English Show Hack, Open
80	2163	Reg 12 HA/AA Western Pleasure, JOTR
81	2947	Reg 12 HA/AA Hunter Pleasure, ATR Select Rider
82	637	Reg 12 HA/AA Western Pleasure, Junior Horse
83		TBA

Saturday Morning - Region 12 Egyptian Classic - 9:00 am - Hunter 4 Arena See page 34 for list of classes and class rules.

Saturday Morning Session - May 7, 2022 - 8:00 am - Indoor Arena 4

109	1076	Reg 12 Arabian Yearling Fillies Breeders Sweepstakes
110	1157	Reg 12 HA/AA Performance Halter Mares, 3 & Over
111		TBA
112	1637	Reg 12 HA/AA Western Pleasure, AAOTR 55+
113	2107	Reg 12 Arabian English Pleasure, JOTR
114	205	Reg 12 Arabian Western Pleasure, Junior Horse
115		<i>Reg XII Spotlight Futurity English Pleas 3 & 4 YO, Open **</i>
116	2152	Reg 12 HA/AA Country English Pleasure, JTR
117	359	Reg 12 HA/AA English Pleasure, AATR
118	1636	Reg 12 Arabian Hunter Pleasure, JTR
119	532	Reg 12 HA/AA English Pleasure, Junior Horse
120		TBA

FOLLOWING CLASS 83 - Spotlight Futurity Right Holder Meeting Held at the Mezzanine Arena 4.

Friday Afternoon - 1 Hour after Morning Session - Indoor Arena 4

84	409	Reg 12 HA/AA Mare Breeding Saddle/Pleas Type 2+, AOTH
85	413	Reg 12 HA/AA Mare Breeding Stock/ Hunt Type 2+, AOTH
86	459	Reg 12 HA/AA Gelding in Hand Saddle/Pleas Type 2+, AOTH
87	463	Reg 12 HA/AA Gelding in Hand Stock/Hunter Type 2+, AOTH
88		<i>Reg XII Spotlight Futurity, 2-Year-Old Geldings, ATH **</i>
89	131	Reg 12 Arabian Country Pleasure Driving, Open
90	2437	Reg 12 HA/AA English Pleasure, ATR Select Rider
91	291	Reg 12 Arabian Hunter Pleasure, Open
92	358	Reg 12 Arabian English Pleasure, AATR
93		<i>Reg XII Spotlight Futurity Western Pleasure 3 & 4 YO, Open**</i>
94	1734	Reg 12 Arabian Ranch Rail Pleasure, Open
95	613	Reg 12 HA/AA Ladies Side Saddle Western, Open
96	2345	Reg 12 HA/AA Ranch Rail Pleasure, Open
97	1641	Reg 12 HA/AA Country English Pleasure, AAOTR 55+
98		TBA

Saturday Afternoon - 1 Hour after Morning Session - Indoor Arena 4

121	122	Reg 12 Arabian Pleasure Driving, ATD
122	1754	Reg 12 Arabian English Pleasure, ATR Select Rider
123	1643	Reg 12 Arabian Western Pleasure, AAOTR 55+
124	112	Reg 12 Arabian Country English Pleasure, Junior Horse
125	1635	Reg 12 HA/AA Hunter Pleasure, JTR
126	1643	Reg 12 Arabian Western Pleasure, AAOTR 19-54
127	557	Reg 12 HA/AA Country English Pleasure, Junior Horse
128	1639	Reg 12 HA/AA Hunter Pleasure, AAOTR 55+
129	157	Reg 12 Arabian Mounted Native Costume, ATR
130	316	Reg 12 Arabian English Show Hack, Open
131	1639	Reg 12 HA/AA Hunter Pleasure, AAOTR 19-54
132	2019	Reg 12 Arabian Performance Halter Stallions, 3 & Over
133		<i>Reg XII Spotlight Futurity Yearling Colts, ATH FINAL **</i>
134		TBA

Friday Evening - 1 Hour following Afternoon Session - Grand Outdoor Arena

99	2	Reg 12 Arabian Mare Breeding 3 & Over, Open
100	576	Reg 12 HA/AA Country Pleasure Driving, Open
101	1937	Reg 12 Arabian Western Pleasure ATR Select Rider
102	516	Reg 12 HA/AA English Pleasure, Open
103	926	Reg 12 A/HA/AA Saddle Seat Equitation, JTR
104	1837	Reg 12 Arabian Country English Pleasure, ATR Select Rider
105	621	Reg 12 HA/AA Western Pleasure, Open
106	307	Reg 12 Arabian Hunter Pleasure, AATR
107	61	Reg 12 Arabian Park Horse, Open
108		<i>Reg XII Spotlight Futurity Yearling Fillies, ATH Sec A/B **</i>

Saturday Evening - 1 Hour following Afternoon Session - Grand Outdoor Arena

135	15	Reg 12 Arabian Stallion Breeding 3 & Over, Open
136		<i>Reg XII Spotlight Futurity Yearling Fillies ATH - FINAL **</i>
137	541	Reg 12 HA/AA Country English Pleasure, Open
138	2144	Reg 12 HA/AA English Pleasure, JOTR
139	2237	Reg 12 Arabian Hunter Pleasure, ATR Select Rider
140	501	Reg 12 HA/AA Park Horse, Open
141	595	Reg 12 HA/AA Mounted Native Costume, ATR
142	168	Reg 12 Arabian Ladies Side Saddle English, Open
143	191	Reg 12 Arabian Western Pleasure, Open
144	113	Reg 12 Arabian Country English Pleasure, AATR
145	76	Reg 12 Arabian English Pleasure, Open

**Spotlight Futurity Sire and Breeder of Distinction Awards Presentation
Region 12 Scholarship Awards Presentation**

**NOTE: All Halter classes will use the "In Ring" Procedure
NOTE: Halter classes will use the Comparative Scoring System**

ONLINE ENTRIES ARE NOW AVAILABLE AT:

www.ringsideproductionsllc.com

2022 Region 12 Tentative Class Schedule – Continued

Judges: Brian Ferguson Bob Gordon Scott Brumfield

** Classes restricted to horses who have previously enrolled in the Spotlight Futurity program

\$ = Allocated Regional Prize Money Classes

Sunday Morning Session - May 8, 2022 - 8:00 am - Indoor Arena 4

146	1447	Reg 12 HA/AA Performance Halter Geldings, 3 & Over
147	2079	Reg 12 Arabian Performance Halter Geldings, 3 & Over
148	1075	Reg 12 Arabian Yearling Colts/Geldings Breeders Sweepstakes
149	919	Reg 12 A/HA/AA Showmanship in Hand, JTH
150	133	Reg 12 Arabian Country Pleasure Driving, AOTD
151	1641	Reg 12 HA/AA Country English Pleasure, AAOTR 19-54
152	749	Reg 12 HA/AA Hunter Pleasure, Junior Horse
153	584	Reg 12 HA/AA English Pleasure, AAOTR
154	322	Reg 12 Arabian English Show Hack, JTR
155	638	Reg 12 HA/AA Western Pleasure, AATR
156	2146	Reg 12 HA/AA English Pleasure, JTR
157	898	Reg 12 A/HA/AA Western Pleasure Walk/Jog 10 & Under
158		Reg XII Spotlight Futurity Hunter Pleasure 3 & 4 YO, Open **
159	66	Reg 12 Arabian Park Horse, ATR
160	1262	Reg 12 Walk Trot Pleasure 11 and Over
161	2112	Reg 12 Arabian Country English Pleasure, JOTR
162		Reg 12 A/HA/AA Leadline - Rider 2-6 YO Exhibition - No Charge
163		TBA

Sunday Afternoon - 1 hour after Morning Session - Indoor Arena 4

164	30	Reg 12 Arabian Yearling Geldings, AAOTH
165		Reg XII Spotlight Futurity 2-Year-Old Fillies, ATH **
166	1513	Reg 12 Arabian Performance Halter Mares, 3 & Over
167	1078	Reg 12 HA/AA Yearling Colts/Geldings Breeders Sweepstakes
168	567	Reg 12 HA/AA Pleasure Driving, ATD
169	2135	Reg 12 Arabian Hunter Pleasure, JOTR
170	893	Reg 12 A/HA/AA English Pleasure Walk/Trot 10 & Under
171	1178	Reg 12 Arabian Western Pleasure, JTR
172	901	Reg 12 A/HA/AA Hunter Pleasure Walk/Trot 10 & Under
173	2108	Reg 12 Arabian English Pleasure, JTR
174	2165	Reg 12 HA/AA Western Pleasure, JTR
175	760	Reg 12 HA/AA English Show Hack, ATR
176	913	Reg 12 A/HA/AA Western Seat Equitation Walk/Trot, 10 & Under
177	1644	Reg 12 Arabian Hunter Pleasure, AAOTR 55+
178	1265	Reg 12 Walk Trot Equitation 11 and Over
179	1185	Reg 12 A/HA/AA Western Horsemanship, JTR
180		TBA

Region 12 Scoring

Region 12 Championship performance classes will utilize the MOS Scoring System as described in the AHA Handbook, with the exception of Dressage, Western Dressage, Hunter/Jumper and Sport Horse. Halter classes will use the Comparative score cards. The emergency backup system for scoring will be the Three Judge Total Points System.

Region 12 Awards

Top Five Awards will be made regardless of the number of entries in a class. However, only awards made to the top 50% of the class (rounded up and not to exceed 5 awards) will receive Arabian Breeders Sweepstakes payout, AHA Horse Achievement Award, Amateur Achievement Awards, High Point Horse Achievement Award, High Point Amateur Achievement Award and Distance Award Points. **Please Note:** All awards not claimed by the close of the awards room on the last day of classes, will be forfeited. Awards will not be mailed to exhibitors after the event.

Champion.....Ribbon and Garland
 Reserve Champion.....Ribbon and Garland
 Remaining Top Five Ribbon

Region 12 TBA Class Information

TBA classes may be any class on the AHA class list or that is recognized by AHA. TBA classes must not be a duplicate of any other classes. TBAs are given on a first come first served basis only, must be reserved with the show secretary and **must be approved by the show committee**. Show management reserves the right to allocate TBA slots in a manner to facilitate the flow of the show. If a TBA slot is not filled, the class number will be cancelled and the next class will begin immediately.

Region 12 Spotlight Futurity Rules

1. All Spotlight finals classes to be judged under the Comparative Method.
2. AOTH owners who are 65 or older and/or who have medical issues (as verified by a doctor's certificate) can designate another amateur to show their entry. This certificate must be submitted and confirmed received by the Program prior to the start of the class session. If you have any questions, please contact: **Kenna at the number below.**
3. Semi Final classes for the open Spotlight yearling classes will be run during the Wednesday morning session. Top Twenty Finalist will be picked and only the Top Ten will go forward to the finals class. Please consult your prize list.
4. All amateur handlers and/or riders must hold current USEF and AHA membership cards. No professional handlers to show in any Spotlight halter class. Professionals and amateurs can show in the Spotlight Three- and Four-Year-Old Junior Horse performance classes. Five-year-old performance classes are ATR only.
5. All Spotlight owners are required to complete a W-9 form and leave with the Show Secretary prior to any prize money to be awarded. It is the goal of the committee to have all payments made within thirty days of the closing date of the show. A W-9 form has been included in our prize list for your easy access.
6. If you need to verify your entry to confirm that you are eligible to compete in the Spotlight Program, please contact: **Kenna at the number below** or check our nominated mare listing located on our website: www.spotlightfuturity.com > Program Information > Mares Nominations. A copy of the Spotlight rules in their entirety can also be found on our website.

NOTE: Spotlight registration number must be included on your entry form. Please go to www.spotlightfuturity.com to obtain your number. If you need assistance, please contact: Kenna Burbeck @ 678-523-1955

Class Specs for Spotlight Performance Classes

All Spotlight Futurity Performance classes are restricted to horses that have previously been nominated into the Spotlight Futurity.

- Cls. 115 - Spotlight Futurity English Pleas, 3 & 4 YO, Open**
 Open to three- and four-year-old Spotlight nominated horses. Will follow USEF and AHA rules and class specifications for English Pleasure Junior Horse; full bridle, snaffle bit and martingale are optional. Country English Pleasure and English Pleasure horses may enter this class.
- Cls. 40 - Spotlight Futurity English Pleas Maturity, 5 YO - ATR**
 Open to five-year-old Spotlight nominated horses. Will follow USEF and AHA rules and class specifications for English Pleasure ATR. Country English Pleasure and English Pleasure horses may enter this class.
- Cls. 158 - Spotlight Futurity Hunter Pleasure, 3 & 4 YO, Open**
 Open to three- and four-year-old Spotlight nominated horses. Will follow USEF and AHA rules and class specifications for Hunter Pleasure Junior Horse.
- Cls. 51 - Spotlight Futurity Hunter Pleasure Maturity, 5 YO - ATR**
 Open to five-year-old Spotlight nominated horses. Will follow USEF and AHA rules and class specifications for Hunter Pleasure Junior Horse.
- Cls. 93 - Spotlight Futurity Western Pleasure, 3 & 4 YO, Open**
 Open to three- and four-year-old Spotlight nominated horses. Will follow USEF and AHA rules and class specifications for Western Pleasure Junior Horse.
- Cls. 60 - Spotlight Futurity Western Pleasure Maturity, 5 YO - ATR**
 Open to five-year-old Spotlight nominated horses. Will follow USEF and AHA rules and class specifications for Western Pleasure ATR.

SPOTLIGHT FUTURITY AUCTION

Section II. F

a. Spotlight Futurity English Pleasure 3 & 4 YO Open. Open to three and four year old Spotlight nominated horses. Will follow USEF and AHA rules and class specifications for Country English Pleasure Junior Horse; full bridle, snaffle bit and martingale are optional. Country English Pleasure and English Pleasure horse may enter this class. September 2015.

Cross entries are prohibited between the Spotlight Futurity Hunter Pleasure 3 & 4 YO, Open, and the Spotlight Futurity English Pleasure class at the same competition.

Cross entries are prohibited between Spotlight Futurity Western Pleasure, 3 & 4 YO, Open, and the Spotlight Futurity English Pleasure class at the same competition.

b. Spotlight Futurity English Pleasure Maturity, 5 YO- ATR. Open to five year old Spotlight nominated horses. Will follow USEF and AHA rules and class specifications for Country English Pleasure Junior Horse; full bridle, snaffle bit and martingale are optional. Country English Pleasure and English Pleasure horse may enter this class. September 2015.

Cross entries are prohibited between the Spotlight Futurity Hunter Pleasure Maturity 5 YO -ATR and Spotlight Futurity English Pleasure Maturity class at the same competition.

Cross entries are prohibited between the Spotlight Futurity Western Pleasure Maturity 5 YO -ATR and the Spotlight Futurity English Pleasure Maturity Class at the same competition.

These two amendments will ensure that we have appropriate representation of CEP/ EP horses in the two Spotlight CEP/EP classes. We want the horses in the classes to truly represent the specifications and function of a saddleseat horse. This amendment should take effect immediately as it does not impact nominations or breeding but performance of our horses age 3 and older. Furthermore, it only prohibits cross entering at the same competition. (AS AN EXAMPLE, if a horse at 3yrs of age is shown as a hunter at the May 2022 show and then matures into more of a CEP horse - it could enter and show at the May 2023 show in the EP futurity but will not be able to show in the hunter spotlight futurity class at that same show.)



www.spotlightfuturity.com

2022 REGION 12 CLASSES BY DIVISION

ARABIAN HALTER & PERFORMANCE HALTER

- 75 Yearling Fillies, Open
- 74 Mare Breeding 2 YO, Open
- 33 Mare Breeding 2 & Over, AOTH \$
- 99 Mare Breeding 3 & Over, Open
- 26 Gelding in Hand 2 YO, Open
- 73 Gelding In Hand 3 & Over, Open
- 46 Gelding In Hand 2 & Over, AOTH \$
- 164 Yearling Geldings, AAOTH
- 76 Yearling Colts, Open
- 23 Stallion Breeding 2 YO, Open
- 72 Stallion Breeding 2 & Over, AOTH
- 135 Stallion Breeding 3 & Over, Open
- 109 Yearling Fillies Breeders Sweepstakes \$
- 148 Yearling Colts/Gelding Breeders Sweepstakes \$
- 166 Performance Halter Mares, 3 & Over
- 132 Performance Halter Stallions, 3 & Over
- 147 Performance Halter Geldings, 3 & Over

ARABIAN PERFORMANCE CLASSES

- 63 Country English Pleasure, Open
- 124 Country English Pleasure, Junior Horse \$
- 61 Country English Pleasure JTR
- 161 Country English Pleasure, JOTR
- 104 Country English Pleasure, ATR Select Rider
- 144 Country English Pleasure, AATR
- 36 Country English Pleasure, AAOTR, 19-54 \$
- 52 Country English Pleasure, AAOTR, 55+ \$
- 47 Driving - Pleasure Driving, Open
- 121 Driving - Pleasure Driving, ATD
- 89 Driving - Country Pleasure Driving, Open
- 150 Driving - Country Pleasure Driving, AOTD
- 145 English Pleasure, Open
- 67 English Pleasure, Junior Horse \$
- 173 English Pleasure, JTR
- 113 English Pleasure, JOTR
- 122 English Pleasure, ATR Select Rider
- 92 English Pleasure, AATR
- 54 English Pleasure, AAOTR \$
- 130 English Show Hack, Open
- 154 English Show Hack, JTR
- 66 English Show Hack, AATR
- 91 Hunter Pleasure, Open
- 37 Hunter Pleasure, Junior Horse \$
- 118 Hunter Pleasure, JTR
- 169 Hunter Pleasure, JOTR
- 139 Hunter Pleasure, ATR Select Rider
- 106 Hunter Pleasure, AATR
- 41 Hunter Pleasure, AAOTR, 19-54 \$
- 177 Hunter Pleasure, AAOTR, 55+ \$
- 39 Ladies Side Saddle Western, Open
- 142 Ladies Side Saddle English, Open
- 69 Mounted Native Costume, Open
- 129 Mounted Native Costume, ATR
- 107 Park Horse, Open
- 159 Park Horse, ATR
- 15 Ranch Horse Riding, Open
- 17 Ranch Horse Riding, ATR
- 94 Ranch Horse Rail Pleasure, Open
- 50 Ranch Horse Rail Pleasure, ATR
- 11 Reining Horse, Open
- 13 Reining Horse, ATR
- 3 Trail - Western Trail Horse, Open
- 5 Trail - Western Trail Horse, AAOTR \$
- 7 Trail - Western Trail Horse, ATR
- 9 Trail - English Trail Horse, Open
- 143 Western Pleasure, Open
- 114 Western Pleasure, Junior Horse \$
- 171 Western Pleasure, JTR
- 58 Western Pleasure, JOTR
- 101 Western Pleasure, ATR Select Rider
- 65 Western Pleasure, AATR
- 126 Western Pleasure, AAOTR, 19-54 \$
- 123 Western Pleasure, AAOTR, 55+ \$

SPOTLIGHT FUTURITY CLASSES

- 108 Spotlight Futurity Yearling Fillies, ATH
- 71 Spotlight Futurity Yearling Colts, ATH
- 88 Spotlight Futurity 2-Year-Old Geldings, ATH
- 77 Spotlight Futurity 2-Year-Old Colts, ATH
- 165 Spotlight Futurity 2-Year-Old Fillies, ATH
- 29 Spotlight Futurity Yrling Colts Auction Class, AOTH
- 34 Spotlight Futurity Yrling Fillies Auction Class, AOTH
- 115 Spotlight Futurity English PL 3 & 4 YO, Open
- 40 Spotlight Futurity English PL Maturity 5 YO, ATR
- 158 Spotlight Futurity Hunter PL 3 & 4 YO, Open
- 51 Spotlight Futurity Hunter PL Maturity, 5 YO, ATR
- 93 Spotlight Futurity Western PL 3 & 4 YO, Open
- 60 Spotlight Futurity Western PL Maturity 5 YO, ATR

Equitation - Horsemanship - In Hand Trail Showmanship – Walk-Trot and Lead Line Open to Arabians, Half Arabians or Anglo Arabians

- 1 In Hand Trail, Open
- 2 In Hand Trail, ATH
- 103 Saddle Seat Equitation, JTR
- 44 Saddle Seat Equitation W/T 10 & Under
- 176 Western Seat Equitation W/T 10 & Under
- 59 Country English Pleasure W/T 10 & Under
- 157 Western Pleasure W/J 10 & Under
- 170 English Pleasure W/T 10 & Under
- 172 Hunter Pleasure W/T 10 & Under
- 149 Showmanship in Hand, JTH
- 19 Showmanship in Hand, AATH
- 179 Western Horsemanship, JTR
- 20 Western Horsemanship, AATR
- 162 Lead Line 2 – 6 Exhibition – No Charge for this Class
- 160 Pleasure Walk/Trot, 11 & Over
- 178 Equitation Walk/Trot, 11 & Over

\$ Indicates Breeders Sweepstakes classes

All Halter Classes Will Use The "In Ring" Procedure



HALF-ARABIAN HALTER & PERFORMANCE HALTER

- 24 Mare Breeding 2 YO, Open
- 27 Mare Breeding Saddle/Pleas Type 3 & Over
- 28 Mare Breeding Stock/Hunter Type 3 & Over
- 84 Mare Breeding Saddle/Pleas Type 2 +, AOTH \$
- 85 Mare Breeding Stock/Hunt Type 2 +, AOTH \$
- 25 Geldings in Hand 2 YO, Open
- 30 Gelding in Hand Saddle/Pleas Type 3 & Over
- 31 Gelding in Hand Stock/Hunter Type 3 & Over
- 86 Gelding in Hand Saddle/Pleas Type 2 +, AOTH \$
- 87 Gelding in Hand Stock/Hunt Type 2 +, AOTH \$
- 32 Yearling Fillies Breeders Sweepstakes \$
- 167 Yearling Colts/Geldings Breeders Sweepstakes \$
- 110 Performance Halter Mares, 3 & Over
- 146 Performance Halter Geldings, 3 & Over

HA/AA PERFORMANCE CLASSES

- 137 Country English Pleasure, Open
- 127 Country English Pleasure, Junior Horse \$
- 116 Country English Pleasure, JTR
- 49 Country English Pleasure, JOTR
- 43 Country English Pleasure, ATR Select Rider
- 64 Country English Pleasure, AATR
- 154 Country English Pleasure, AAOTR, 19-54 \$
- 97 Country English Pleasure, AAOTR, 55+ \$
- 78 Driving - Pleasure Driving, Open
- 168 Driving - Pleasure Driving, ATD
- 100 Driving - Country Pleasure Driving, Open
- 35 Driving - Country Pleasure Driving, AOTD
- 102 English Pleasure, Open
- 119 English Pleasure, Junior Horse \$
- 156 English Pleasure, JTR
- 138 English Pleasure, JOTR
- 90 English Pleasure, ATR Select Rider
- 117 English Pleasure, AATR
- 153 English Pleasure, AAOTR \$
- 79 English Show Hack, Open
- 175 English Show Hack, ATR
- 42 Hunter Pleasure, Open
- 152 Hunter Pleasure, Junior Horse \$
- 125 Hunter Pleasure, JTR
- 53 Hunter Pleasure, JOTR
- 81 Hunter Pleasure, ATR Select Rider
- 68 Hunter Pleasure, AATR
- 131 Hunter Pleasure, AAOTR, 19-54 \$
- 128 Hunter Pleasure, AAOTR, 55+ \$
- 95 Ladies Side Saddle Western, Open
- 55 Ladies Side Saddle English, Open
- 57 Mounted Native Costume, Open
- 141 Mounted Native Costume, ATR
- 140 Park Horse, Open
- 70 Park Horse, ATR
- 16 Ranch Horse Riding, Open
- 18 Ranch Horse Riding, ATR
- 96 Ranch Horse Rail Pleasure, Open
- 48 Ranch Horse Rail Pleasure, ATR
- 12 Reining Horse, Open
- 14 Reining Horse, ATR
- 4 Western Trail Horse, Open
- 6 Western Trail Horse, AAOTR \$
- 8 Western Trail Horse ATR
- 10 English Trail Horse, Open
- 105 Western Pleasure, Open
- 82 Western Pleasure, Junior Horse \$
- 174 Western Pleasure, JTR
- 80 Western Pleasure, JOTR
- 56 Western Pleasure, ATR Select Rider
- 155 Western Pleasure, AATR
- 38 Western Pleasure, AAOTR, 19-54 \$
- 112 Western Pleasure, AAOTR, 55+ \$

2022 Dressage & Sport Horse Schedule

Dressage Judges: Anne Gribbons, Karen Winn & Lisa El-Ramey
Hunter/Jumper Judges: Douglas Bruce & Robin Swinderman Mitchell

Wednesday, May 4, 2022, 8:00 AM Judges: Gribbons & Winn - Indoor Arena 1

301	903	A/HA/AA USDF Intro Level Walk/Trot 10 & Under
302	1401	Arabian USEF Training Level Test 3 Open
303	1403	Arabian USEF Training Level Test 3 JTR
304	1403	Arabian USEF Training Level Test 3 ATR
305	1503	HA/AA USEF Training Level Test 3 AATR
306	1511	HA/AA USEF First Level Test 3 Open
307	1406	Arabian USEF First Level Test 3 AATR
308	1408	HA/AA USEF First Level Test 3 JTR
309	1408	HA/AA USEF First Level Test 3 ATR
310	1806	A/HA/AA USEF Second Level Test 3 AOTR
311	1808	A/HA/AA USEF Second Level Test 3 Open
312	816	A/HA/AA USEF Third Level Test 3 Open
313	828	A/HA/AA USEF Fourth Level Test 3 ATR
314	883	A/HA/AA FEI Prix St Georges Open
315	888	A/HA/AA FEI Intermediate II Open
316	2202	A/HA/AA WDAA Intro Level Test 4 Open
317	2314	A/HA/AA WDAA Basic Level Test 4 ATR
318	2402	A/HA/AA WDAA Level 1 Test 4 Open
319	2514	A/HA/AA WDAA Level 2 Test 4 ATR
320	2552	A/HA/AA WDAA Level 3 Test 4 Open
321	1439	A/HA/AA Dressage Seat JTR
322	430	A/HA/AA Dressage Seat Equitation AATR

Thursday, May 5, 2022, 8:00 AM Judges: Gribbons & Winn - Indoor Arena 1

325	1383	A/HA/AA USDF Intro Level Walk/Trot 11 & Over
326	1501	HA/AA USEF Training Level Test 3 Open
327	1503	HA/AA USEF Training Level Test 3 JTR
328	1403	Arabian USEF Training Level Test 3 AATR
329	1503	HA/HA USEF Training Level Test 3 ATR
330	848	A/HA/AA USEF Training Level Test 3 Jr Horse
331	1411	Arabian USEF First Level Test 3 Open
332	1408	HA/AA USEF First Level Test 3 AATR
333	1406	Arabian USEF First Level Test 3 JTR
334	1408	Arabian USEF First Level Test 3 ATR
335	1814	A/HA/AA USEF Second Level Test 3 ATR
336	821	A/HA/AA USEF Third Level Test 3 ATR
337	824	A/HA/AA USEF Fourth Level Test 3 Open
338	1427	A/HA/AA FEI Prix St Georges ATR
339	887	A/HA/AA FEI Intermediate I Open
340	889	A/HA/AA FEI Grand Prix Open
341	2214	A/HA/AA WDAA Intro Level Test 4 ATR
342	2302	A/HA/AA WDAA Basic Level Test 4 Open
343	2414	A/HA/AA WDAA Level 1 Test 4 ATR
344	2502	A/HA/AA WDAA Level 2 Test 4 Open
345	2570	A/HA/AA WDAA Level 4 Test 4 Open
346	348	Arabian SH Show Hack Open
347	1051	HA/AA SH Show Hack Open

Note: Depending on the number of entries, dressage classes may not be held on the days indicated. The one ride option will be used.

Post entries: Post entries will be allowed at the discretion of management if a ride time is available. See rule #38 in the prize list for post entry rules.

Whips: Prohibited in regular champ. classes. Caller may be used if provided by exhibitor.

Protective Headgear Rules for Dressage: Refer to USEF Rule DR120.

Friday, May 6th, 2022 8:00 AM Judges: Winn & El-Ramey - Indoor Arena 1

401	2921	HA/AA SHIH Geldings Open—Dressage Type
402	2929	HA/AA SHIH Geldings 1 & Over AATH—Dressage Type
403	2933	HA/AA SHIH Geldings JTH—Dressage Type
404	2881	HA/AA SHIH Mares Open—Dressage Type
405	2889	HA/AA SHIH Mares 1 & Over AATH—Dressage Type
406	2893	HA/AA SHIH Mares JTH—Dressage Type
407	2901	HA/AA SHIH Stallions Open—Dressage Type
408	2909	HA/AA SHIH Stallions ATH—Dressage Type
CLASSES 401-408 WILL RUN CONCURRENTLY WITH 409-416		
409	2801	Arabian SHIH Geldings Open—Dressage Type
410	2809	Arabian SHIH Geldings 1 & Over AATH—Dressage Type
411	2813	Arabian SHIH Geldings JTH—Dressage Type
412	2761	Arabian SHIH Mares Open—Dressage Type
413	2769	Arabian SHIH Mares 1 & Over AATH—Dressage Type
414	2773	Arabian SHIH Mares JTH—Dressage Type
415	2781	Arabian SHIH Stallions Open—Dressage Type
416	2789	Arabian SHIH Stallions 1 & Over ATH—Dressage Type

BREAK - 1 HOUR AFTER CLASS 416 ENDS

417	1262	A/HA/AA Sport Horse U/S Walk/Trot 11 & Over—Dressage Type
418	776	HA/AA Sport Horse U/S AOTR—Dressage Type \$
419	370	PB Sport Horse U/S JTR—Dressage Type
420	780	HA/AA Sport Horse U/S Jr Horse—Dressage Type—Dressage Type
421	352	PB Sport Horse Show Hack ATR—Dressage Type
422	1107	HA/AA Sport Horse U/S AATR—Dressage Type
423	336	PB Sport Horse U/S Open—Dressage Type
424	788	HA/AA Sport Horse U/S JTR—Dressage Type—Dressage Type
425	1051	PB Sport Horse U/S Jr Horse—Dressage Type
426	1087	PB Sport Horse U/S AATR—Dressage Type
427	774	HA/AA Sport Horse U/S Open—Dressage Type
428	338	PB Sport Horse U/S AOTR—Dressage Type \$
429	1055	HA/AA Sport Horse Show Hack ATR

Saturday, May 7th, 2022, 8:00 AM Judges: Bruce & Mitchell Indoor Arena 1

431	1696	A/HA/AA Sport Horse Showmanship ATH
432	2861	HA/AA SHIH Geldings Open—Hunter Type
433	2851	HA/AA SHIH Geldings 1 & Over AATH—Hunter Type
434	2873	HA/AA SHIH Geldings JTH—Hunter Type
435	2821	HA/AA SHIH Mares Open—Hunter Type
436	2831	HA/AA SHIH Mares 1 & Over AATH—Hunter Type
437	2833	HA/AA SHIH Mares JTH—Hunter Type—Hunter Type
438	2841	HA/AA SHIH Stallions Open—Hunter Type
439	2849	HA/AA SHIH Stallions ATH—Hunter Type
CLASSES 431-439 WILL RUN CONCURRENTLY WITH 440-447		
440	2741	Arabian SHIH Geldings Open—Hunter Type
441	2751	Arabian SHIH Geldings 1 & Over AATH—Hunter Type
442	2753	Arabian SHIH Geldings JTH—Hunter Type
443	2701	Arabian SHIH Mares Open—Hunter Type
444	2711	Arabian SHIH Mares 1 & Over AATH—Hunter Type
445	2713	Arabian SHIH Mares JTH—Hunter Type
446	2721	Arabian SHIH Stallions Open—Hunter Type
447	2729	Arabian SHIH Stallions ATH—Hunter Type

BREAK - 1 HOUR AFTER CLASS 447 ENDS

448	915	A/HA/AA Hunter Seat Equitation W/T NTJ 10 & Under
449	2197	A/HA/AA Hunter Seat Equitation NTJ JTR 14-18
450	338	Arabian Sport Horse U/S AOTR—Hunter Type \$
451	780	HA/AA Sport Horse U/S Jr Horse—Hunter Type
452	370	Arabian Sport Horse U/S JTR—Hunter Type
453	1107	HA/AA Sport Horse U/S AATR—Hunter Type
454	336	Arabian Sport Horse U/S Open—Hunter Type
455	788	HA/AA Sport Horse U/S JTR—Hunter Type
456	342	Arabian Sport Horse U/S Jr Horse—Hunter Type
457	1262	A/HA/AA SH Walk/Trot Pl. 11 & Over—Hunter Type
458	776	HA/AA Sport Horse U/S AOTR—Hunter Type \$
459	1087	Arabian Sport Horse U/S AATR—Hunter Type
460	774	HA/AA Sport Horse U/S Open—Hunter Type
461	942	A/HA/AA Hunter Seat Equitation NTJ JTR 13 & Under
462	1358	A/HA/AA Hunter Seat Equitation NTJ AATR

ATTENTION DRESSAGE EXHIBITORS

Each competitor is responsible for supplying management with correct applicable numbers (USDF and USEF) for horse, owner, rider, and trainer, before the day(s) of the competition. The scores of competitors who fail to supply correct numbers may not be counted toward national awards.

2022 REGION 12 DRESSAGE & SPORT HORSE CLASSES BY DIVISION

Arabian Dressage Classes

- 302 **Arabian** Training Level, Test 3, Open
 303 **Arabian** Training Level, Test 3, JTR
 304 **Arabian** Training Level, Test 3, ATR
 328 **Arabian** Training Level, Test 3, AATR
 307 **Arabian** First Level Test 3, AATR
 331 **Arabian** First Level, Test 3, Open
 333 **Arabian** First Level Test 3, JTR
 334 **Arabian** First Level, Test 3, ATR

HA/AA Dressage Classes

- 305 **HA/AA** Training Level, Test 3, AATR
 326 **HA/AA** Training Level, Test 3, Open
 327 **HA/AA** Training Level, Test 3, JTR
 329 **HA/AA** Training Level, Test 3, ATR
 306 **HA/AA** First Level, Test 3, Open
 308 **HA/AA** First Level, Test 3, JTR
 309 **HA/AA** First Level, Test 3, ATR
 332 **HA/AA** First Level, Test 3, AATR

A/HA/AA Dressage Classes

- 301 **A/HA/AA** USDF Intro Level W/T 10 & Under
 325 **A/HA/AA** USDF Intro Level W/T 11 & Over
 330 **A/HA/AA** Training Level, Test 3, Junior Horse
 310 **A/HA/AA** Second Level, Test 3, AOTR \$
 311 **A/HA/AA** Second Level Test 3, Open
 335 **A/HA/AA** Second Level, Test 3, ATR
 312 **A/HA/AA** Third Level, Test 3, ATR
 336 **A/HA/AA** Third Level, Test 3, Open
 313 **A/HA/AA** Fourth Level, Test 3, Open
 337 **A/HA/AA** Fourth Level, Test 3, ATR
 314 **A/HA/AA** Prix St. Georges, Open
 338 **A/HA/AA** Prix St. Georges, ATR
 339 **A/HA/AA** Intermediate I, Open
 315 **A/HA/AA** Intermediate II, Open
 340 **A/HA/AA** Grand Prix, Open
 321 **A/HA/AA** Dressage Seat Equitation, JTR
 322 **A/HA/AA** Dressage Seat Equitation, AATR

A/HA/AA Western Dressage Classes

- 316 **A/HA/AA** Western Dressage Intro Test 4, Open
 341 **A/HA/AA** Western Dressage Intro Test 4, ATR
 342 **A/HA/AA** Western Dressage Basic Level Test 4, Open
 317 **A/HA/AA** Western Dressage Basic Level Test 4, ATR
 318 **A/HA/AA** Western Dressage Level 1, Test 4, Open
 343 **A/HA/AA** Western Dressage Level 1, Test 4, ATR
 344 **A/HA/AA** Western Dressage Level 2, Test 4, Open
 319 **A/HA/AA** Western Dressage Level 2, Test 4, ATR
 320 **A/HA/AA** Western Dressage Level 3, Test 4, Open
 345 **A/HA/AA** Western Dressage Level 4, Test 4, Open

Arabian Sport Horse Classes

Dressage Type

- 409 Arabian SHIH Geldings, Open - Dressage Type
 410 Arabian SHIH Geldings, 1+ AATH - Dressage Type
 411 Arabian SHIH Geldings, JTH - Dressage Type
 412 Arabian SHIH Mares, Open - Dressage Type
 413 Arabian SHIH Mares, 1 & Over AATH - Dress. Type
 414 Arabian SHIH Mares, JTH - Dressage Type
 415 Arabian SHIH Stallions, Open - Dressage Type
 416 Arabian SHIH Stallions, ATH - Dressage Type
 423 Arabian Sport Horse U/S, Open - Dressage Type
 425 Arabian Sport Horse U/S Junior Horse - Dress. Type
 419 Arabian Sport Horse U/S, JTR - Dressage Type
 426 Arabian Sport Horse U/S, AATR - Dressage Type
 428 Arabian Sport Horse U/S, AOTR - Dressage Type \$
 346 Arabian Sport Horse Show Hack, Open
 421 Arabian Sport Horse Show Hack, ATR

Hunter Type

- 440 Arabian SHIH Geldings, Open - Hunter Type
 441 Arabian SHIH Geldings, 1 & Over AATH - Hunter Type
 442 Arabian SHIH Geldings, JTH - Hunter Type
 443 Arabian SHIH Mares, Open - Hunter Type
 444 Arabian SHIH Mares, 1 & Over AATH - Hunter Type
 445 Arabian SHIH Mares, JTH - Hunter Type
 446 Arabian SHIH Stallions, Open - Hunter Type
 447 Arabian SHIH Stallions, ATH - Hunter Type
 454 Arabian Sport Horse U/S, Open - Hunter Type
 456 Arabian Sport Horse U/S, Junior Horse - Hunter Type
 452 Arabian Sport Horse U/S, JTR - Hunter Type
 458 Arabian Sport Horse U/S, AATR - Hunter Type
 450 Arabian Sport Horse U/S, AOTR - Hunter Type \$

SPORT HORSE JUDGING ASSIGNMENTS

Sport Horse Judging Assignments for Friday

Winn- HA In Hand-Arabian Under Saddle-Show Hack
 El-Ramey- Arabian In Hand-HA Under Saddle-Show Hack

Sport Horse Judging Assignments for Saturday -

Bruce- Arabian In Hand/HA Under Saddle
 Classes 448 & 461 (Equitation classes)
 Mitchell- HA In Hand/Arabian Under Saddle
 Classes 431, 449, 460 (Showmanship and Eq Classes)

HA/AA Sport Horse Classes

Dressage Type

- 401 HA/AA SHIH Geldings, Open - Dressage Type
 402 HA/AA SHIH Geldings, 1+ AATH - Dressage Type
 403 HA/AA SHIH Geldings, JTH - Dressage Type
 404 HA/AA SHIH Mares, Open - Dressage Type
 405 HA/AA SHIH Mares, 1 & Over AATH - Dressage Type
 406 HA/AA SHIH Mares, JTH - Dressage Type
 407 HA/AA SHIH Stallions, Open - Dressage Type
 408 HA/AA SHIH Stallions, ATH - Dressage Type
 427 HA/AA Sport Horse U/S, Open - Dressage Type
 420 HA/AA Sport Horse U/S, Junior Horse - Dressage Type
 424 HA/AA Sport Horse U/S, JTR - Dressage Type
 422 HA/AA Sport Horse U/S, AATR - Dressage Type
 418 HA/AA Sport Horse U/S, AOTR - Dressage Type \$
 347 HA/AA Sport Horse Show Hack, Open
 429 HA/AA Sport Horse Show Hack, ATR

Hunter Type

- 432 HA/AA SHIH Geldings, Open - Hunter Type
 433 HA/AA SHIH Geldings, 1 & Over, AATH - Hunter Type
 434 HA/AA SHIH Geldings, JTH - Hunter Type
 435 HA/AA SHIH Mares, Open - Hunter Type
 436 HA/AA SHIH Mares, 1 & Over AATH - Hunter Type
 437 HA/AA SHIH Mares, JTH - Hunter Type
 438 HA/AA SHIH Stallions, Open - Hunter Type
 439 HA/AA SHIH Stallions, ATH - Hunter Type
 460 HA/AA Sport Horse U/S, Open - Hunter Type
 451 HA/AA Sport Horse U/S, Junior Horse - Hunter Type
 455 HA/AA Sport Horse U/S, JTR - Hunter Type
 453 HA/AA Sport Horse U/S, AATR - Hunter Type
 458 HA/AA Sport Horse U/S, AOTR - Hunter Type \$

W/T-- SH SHOWMANSHIP -- EQUITATION NTJ CLASSES

- 417 A/HA/AA SH U/S Walk Trot 11 & Over--Dressage Type
 457 A/HA/AA SH Walk/Trot Pl. 11 & Over--Hunter Type
 431 Reg 12 A/HA/AA Sport Horse Showmanship ATH
 448 A/HA/AA Hunter Seat Eq. Walk/Trot NTJ 10 & Under
 461 A/HA/AA Hunter Seat Eq. NTJ, JTR 13 & Under
 449 A/HA/AA Hunter Seat Equitation NTJ, JTR 14 - 18
 462 A/HA/AA Hunter Seat Eq. NTJ, AATR

◀◀◀ IMPORTANT SPORT HORSE NOTICE ▶▶▶

All Sport Horse in Hand Class post entries close at Noon on Tuesday, May 3, 2022. Times will be assigned and posted. Conflicts must be resolved during the hours of 6:00 - 8:00 p.m. (or after the last dressageride) prior to showing with the Sport Horse Manager, Marie Taylor, at the Sport Horse show office located in Arena 1. Failure to show in your assigned time slot will result in elimination.

2022 Accommodations & Services

AREA HOTELS

Host Hotel - Hilton Ocala - 352.854.1400

Studio 6 Ocala - 325.629.0091 Use Code: Region 12 Arab

Springhill Suites by Marriott - 352.500.0501
 Homewood Suites by Hilton - 352.369.4610
 Holiday Inn & Suites - 352.861.8400

Comfort Suites Ocala North - 352.482.0800
 Fairfield Inn & Suites by Marriott - 352.861.8400
 Courtyard by Marriott - 352.237.8000

~ ~ ~

Golf Carts - RV Slips - Reserve through WEC at worldequestriancenter.com
 Under Ocala click Golf Cart Rentals for both

~ ~ ~

LIVE STREAMING/VIDEO SERVICES - SeeHorse Video

Contact: 317.984.5286 or orders@seehorsevideo.com

2022 Region 12 Hunter/Jumper Division

Classes to be held in Indoor Arena 1

Hunter / Jumper Judge: Douglas Bruce

Course Designer – Marie Taylor

All Hunter classes will be conducted in accordance with USEF Art AR-10. All Jumpers classes to be judged in accordance with USEF Art. AR-11. Time Second Jump Off (Table II Section 2B). Touches not to count. In order to show in Under Saddle Class of the division, you must show in half of the number of fence classes to receive points toward the Championship. Schooling times will be posted in the Show Office.

Fees: Warm-up - \$20 per round

Classes - \$65

Division Classes - \$100

7:00 - 7:20 AM Open Warm Up

7:20 - 7:45 AM Hunter Hack Warm Up

Sunday, May 7, 2022, 8:00 AM

501		Reg 12 A/HA/AA Hunter Warm-up	519.1	783	Reg 12 HA/AA Regular Working Hunter JTR 2' 6", Sec A
502	361	Reg 12 Arabian Hunter Hack, Open, 2'	519.2	783	Reg 12 HA/AA Regular Working Hunter JTR 2' 6", Sec B
503	365	Reg 12 Arabian Hunter Hack, AATR, 2'	519.3	718	Reg 12 HA/AA Regular Working Hunter JTR Under Saddle
504	2141	Reg 12 Arabian Hunter Hack, JTR, 2'	519.4	784	Reg 12 HA/AA Regular Working Hunter JTR Champion/Reserve
505	368	Reg 12 Arabian Hunter Hack, Jr. Horse 2'	520.1	270	Reg 12 Arabian Regular Working Hunter AATR 2' 6", Sec A
506	767	Reg 12 HA/AA Hunter Hack, Open, 2'	520.2	270	Reg 12 Arabian Regular Working Hunter ATAR 2' 6", Sec B
507	771	Reg 12 HA/AA Hunter Hack, AATR, 2'	520.3	273	Reg 12 Arabian Regular Working Hunter AATR Under Saddle
508	2179	Reg 12 HA/AA Hunter Hack, JTR, 2'	520.4	271	Reg 12 Arabian Regular Working Hunter AATR Champion/Reserve
509	765	Reg 12 HA/AA Hunter Hack, Jr. Horse 2'	521.1	715	Reg 12 HA/AA Regular Working Hunter AATR 2' 6", Sec A
510		Reg 12 A/HA/AA Warm Up Cross Rails	521.2	715	Reg 12 HA/AA Regular Working Hunter AATR 2' 6", Sec B
510.1	439	Reg 12 Arabian Working Hunter 18" Cross Rails, Open Sec A	521.3	718	Reg 12 HA/AA Regular Working Hunter AATR Under Saddle
510.2	439	Reg 12 Arabian Working Hunter 18" Cross Rails, Open Sec B	521.4	716	Reg 12 HA/AA Regular Working Hunter AATR Champion/ Reserve
510.3	398	Reg 12 Arabian Working Hunter 18" Cross Rails U/S Open	522.1	277	Reg 12 Arabian Green Working Hunter Open 2' 6", Sec A
510.4	442	Reg 12 Arabian Working Hunter 18" Cross Rails Champion/Reserve	522.2	277	Reg 12 Arabian Green Working Hunter Open 2' 6", Sec B
511.1	445	Reg 12 HA/AA Working Hunter 18" Cross Rails, Open, Sec A	522.3	279	Reg 12 Arabian Green Working Hunter Open Under Saddle
511.2	445	Reg 12 HA/AA Working Hunter 18" Cross Rails, Open, Sec B	522.4	278	Reg 12 Arabian Green Working Hunter Open Champion/Reserve
511.3	399	Reg 12 HA/AA Working Hunter 18" Cross Rails U/S, Open	523.1	723	Reg 12 HA/AA Green Working Hunter Open 2' 6", Sec A
511.4	448	Reg 12 HA/AA Working Hunter 18" Cross Rails, Open, Champion/Reserve	523.2	723	Reg 12 HA/AA Green Working Hunter Open 2' 6", Sec B
512		Reg 12 A/HA/AA Warm Up 2' to 2'3"	523.3	731	Reg 12 HA/AA Green Working Hunter Open Under Saddle
512.1	2056	Reg 12 Arabian Working 2' Hunter, Open, Sec A	523.4	724	Reg 12 HA/AA Green Working Hunter Champion/Reserve
512.2	2056	Reg 12 Arabian Working 2' Hunter, Open, Sec B	524	2187	Reg 12 A/HA/AA Hunter Seat Equitation O/F JTR 2' 6"
512.3	2057	Reg 12 Arabian Working 2' Hunter U/S Open	525	1380	Reg 12 A/HA/AA Hunter Seat Equitation O/F AATR 2' 6"
512.4	2058	Reg 12 Arabian Working 2' Hunter Open Champion/Reserve	526		Reg 12 A/HA/AA Warm Up 2'9"
513.1	3012	Reg 12 HA/AA Working 2' Hunter, Open, Sec A	526.1	267	Reg 12 Arabian Regular Working Hunter AOTR 2' 9", Sec A
513.2	3012	Reg 12 HA/AA Working 2' Hunter, Open, Sec B	526.2	267	Reg 12 Arabian Regular Working Hunter AOTR 2' 9", Sec B
513.3	3013	Reg 12 HA/AA Working 2' Hunter U/S Open	526.3	273	Reg 12 Arabian Regular Working Hunter AOTR Under Saddle
513.4	3014	Reg 12 HA/AA Working 2' Hunter Open Champion/Reserve	526.4	268	Reg 12 Arabian Regular Working Hunter AOTR Champion/Reserve
514.1	346	Reg 12 Arabian Modified Working Hunter ATR 2' 3", Sec A	527.1	712	Reg 12 HA/AA Regular Working Hunter AOTR 2' 9", Sec A
514.2	346	Reg 12 Arabian Modified Working Hunter ATR 2' 3", Sec B	527.2	712	Reg 12 HA/AA Regular Working Hunter AOTR 2' 9", Sec B
514.3	2391	Reg 12 Arabian Modified Working Hunter ATR Under Saddle	527.3	718	Reg 12 HA/AA Regular Working Hunter AOTR Under Saddle
514.4	355	Reg 12 Arabian Modified Working Hunter ATR Champion/Reserve	527.4	713	Reg 12 HA/AA Regular Working Hunter AOTR Champion/Reserve
515.1	842	Reg 12 HA/AA Modified Working Hunter ATR 2' 3", Sec A	528.1	265	Reg 12 Arabian Regular Working Hunter Open 3', Sec A
515.2	842	Reg 12 HA/AA Modified Working Hunter ATR 2' 3", Sec B	528.2	265	Reg 12 Arabian Regular Working Hunter Open 3', Sec B
515.3	2394	Reg 12 HA/AA Modified Working Hunter ATR Under Saddle	528.3	273	Reg 12 Arabian Regular Working Hunter Open Under Saddle
515.4	844	Reg 12 HA/AA Modified Working Hunter ATR Champion/Reserve	528.4	266	Reg 12 Arabian Regular Working Hunter Open Champion/Reserve
516		Reg 12 A/HA/AA Warm Up 2'6"	529.1	710	Reg 12 HA/AA Regular Working Hunter Open 3', Sec A
516.1	276	Reg 12 Arab 14.2 & Under Working Hunter Open, 2' 6", Sec A	529.2	710	Reg 12 HA/AA Regular Working Hunter Open 3', Sec B
516.2	276	Reg 12 Arab 14.2 & Under Working Hunter Open, 2' 6", Sec B	529.3	718	Reg 12 HA/AA Regular Working Hunter Open Under Saddle
516.3	310	Reg 12 Arab 14.2 & Under Working Hunter U/S Open	529.4	711	Reg 12 HA/AA Regular Working Hunter Open Champion/Reserve
516.4	289	Reg 12 Arab 14.2 & Under Working Hunter Open Champion/Reserve	530	286	Reg 12 Arabian Jumper Novice - .8m
517.1	721	Reg 12 HA/AA 14.2 & Under Working Hunter Open, 2' 6", Sec A	531	782	Reg 12 HA/AA Jumper Novice - .8m
517.2	721	Reg 12 HA/AA 14.2 & Under Working Hunter Open, 2' 6", Sec B	532	285	Reg 12 Arabian Jumper ATR Level 3 - 1m
517.3	857	Reg 12 HA/AA 14.2 & Under Working Hunter U/S Open	533	730	Reg 12 HA/AA Jumper ATR Level 3 - 1m
517.4	722	Reg 12 HA/AA 14.2 & Under Working Hunter Open Champion/Reserve	534	281	Reg 12 Arabian Jumper Open Level 3 - 1m
518.1	329	Reg 12 Arabian Regular Working Hunter JTR 2' 6", Sec A	535	726	Reg 12 HA/AA Jumper Open Level 3 - 1m
518.2	329	Reg 12 Arabian Regular Working Hunter JTR 2' 6", Sec B			
518.3	273	Reg 12 Arabian Regular Working Hunter JTR Under Saddle			
518.4	330	Reg 12 Arabian Regular Working Hunter JTR Champion/Reserve			

2022 CLASSIC EGYPTIAN CHAMPIONSHIPS

Saturday May 7th, 2022

Hunter 4 Arena – Time: 9.00 a.m.

Region XII CEC Judge: Chen Kedar, HaYogev, Israel

TENTATIVE SCHEDULE

START TIME: 9.00 A.M.

- 601 Reg. 12 Champion World Class Yearling Fillies 2021
- 602 Reg. 12 Champion World Class Junior Mares 2019/2020
- 603 Reg. 12 Champion Egyptian Heritage Yearling Fillies 2021
- 604 Reg. 12 Champion Egyptian Heritage Junior Mares 2019/2020
- 605 Reg. 12 Champion Straight Egyptian Yearling Fillies 2021
- 606 Reg. 12 Champion Straight Egyptian Junior Mares 2019/2020
- 607 Reg. 12 Champion World Class Yearling Colts 2021
- 608 Reg. 12 Champion World Class Junior Stallion 2019/2020
- 609 Reg. 12 Champion Egyptian Heritage Yearling Colts 2021
- 610 Reg. 12 Champion Egyptian Heritage Junior Stallion 2019/2020
- 611 Reg. 12 Champion Straight Egyptian Yearling Colts 2021
- 612 Reg. 12 Champion Straight Egyptian Junior Stallion 2019/2020
- 613 Reg. 12 Champion World Class Mares, 4 & Older
- 614 Reg. 12 Champion Egyptian Heritage Mares, 4 & Older
- 615 Reg. 12 Champion Straight Egyptian Mare, 4 & Older
- 616 Reg. 12 Champion World Class Stallions, 4 & Older
- 617 Reg. 12 Champion Egyptian Heritage Stallions, 4 & Older
- 618 Reg. 12 Champion Straight Egyptian Stallions, 4 & Older

12.30 p.m./ 1.30 pm. LUNCH

- 619 **The Pyramid Society – EBC Fillies, yearlings ATH** TPS appointed judge TBA
- 620 **The Pyramid Society – EBC Colts, yearlings ATH** TPS appointed judge TBA
Ridden Demonstration of Egyptian related horses (10-15 mins)
- 621 Reg.12 Champion Egyptian Heritage & Straight Egyptian ATH Gelding
- 622 Reg. 12 Champion Egyptian Stallion Legacy Yearling Class 2021
- 623 Grand Champion Yearling Filly/Colt
- 624 Grand Champion World Class Mares / Stallion
- 625 Grand Champion Egyptian Heritage Mare / Stallion
- 626 Grand Champion Straight Egyptian Mare / Stallion
- 627 **Reg. 12 PRIME TIME HALTER AOTH**

POST SHOW CELEBRATION AND DISCUSSION

4.00 Wine / Beer and Appetizers

“The Secret Sauce: How Successful Breeders Use Straight Egyptian Blood”

with

Chen & Eliko Kedar, Ariela Arabians, Israel

Manuel Durini, Medrano Arabians, Ecuador

George Z, Hennessy Arabians, USA

Frank Hennessy, Hennessy Arabians, USA

OPEN DISCUSSION FORMAT

DEFINITIONS

World Class One Straight Egyptian in the first four generations of the pedigree. Percentages of blood, as a qualifier, will NOT be accepted.

Egyptian Heritage One parent, dam or sire, must be Straight Egyptian.

Straight Egyptian Recognized as Straight Egyptian by The Pyramid Society of the United States.

**Anyone needing help determining whether their horse qualifies of these classes,
should contact Bridgette Orwig for assistance at: puregoldarab@aol.com**

PRIZES FOR EGYPTIAN CLASSES

Champion and Reserve Champion + Top Five
awarded in each Championship class.

Class 621 – Champion and Reserve Champion plus Top Five will receive ribbons, neck garlands and \$2,500.00 prize money awarded as follows:

Champion \$1,750.00 Reserve Champion \$750.00

Class 622 – Class open to **ALL 2021** get of Region 12 Spotlight Futurity **Straight Egyptian Stallions**:

Champion \$1,750.00 Reserve Champion \$750.00

Class 623 – Grand Champion and Reserve Grand Champion will receive ribbons, neck garlands and \$3,000.00 awarded as follows:

\$2200.00 Grand Champion \$800.00 Reserve Grand Champion

Class 624, 625, 626 – Grand Champions and Reserve Grand Champions will receive ribbons, neck garlands and \$5,000.00 awarded as follows:

70% Grand Champion 30% Reserve Grand Champion

Class 627 – Winner will receive \$1000.00

RULES GOVERNING EGYPTIAN CLASSES

1. All horses must be purebred Arabians and registered with the Arabian Horse Association.
2. No qualifications are needed to enter, but all entry requirements are the same for Egyptian classes as they are for other Region XII classes.
3. Classes to be judged using the Single Judge Comparative System. See Region 12 Schedule of Rules for details.
4. **Class 619** and **Class 620** entries must meet EBC rules, as per The Pyramid Society EBC Program. For details go to The Pyramid Society website. These classes will be judged by a Pyramid Society appointed judge.
5. To enter **Class 623**, you must have received a Champion or Reserve ribbon in class 601, 603, 605, 607, 609, 611.
6. To enter **Class 624**, you must have received a Champion or Reserve ribbon in class 602, 608, 613, 616.
7. To enter **Class 625**, you must have received a Champion or Reserve ribbon in class 604, 610, 614, 617.
8. To enter **Class 626**, you must have received a Champion or Reserve ribbon in class 606, 612, 615 or 618.

CLASSIC EGYPTIAN CHAMPIONSHIPS ENTRY FORM

Saturday, May 8th, 2022
Held at the Region 12 Championship Show

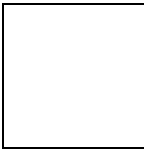
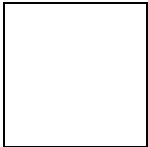

Horses Registered Name: _____ Registration Number: _____

Sire: _____ Dam: _____ Breeder: _____

Foaling Date: _____ Horse Sex: _____ Color: _____

CLASS #	HANDLER'S FULL NAME	ENTRY FEES

OWNER _____
 AHA # _____ USEF # _____
 ADDRESS _____
 CITY _____ STATE _____ ZIP _____
 PHONE _____
 EMAIL _____

TOTAL ENTRY FEES	
Horse Stalls @ \$165	
Tack Stalls @ \$165	
Office Fee @ \$30	
Shavings @ \$9.50/bag	
TOTAL DUE	
Credit Card Serv. Fee—Total Due x .04%	
TOTAL CREDIT CARD CHARGE	

TRAINER _____
 AHA# _____ USEF # _____
 ADDRESS _____
 CITY/STATE/ZIP _____
 EMAIL _____

HANDLER _____
 AHA# _____ USEF # _____
 ADDRESS _____
 CITY/STATE/ZIP _____
 EMAIL _____

HANDLER _____
 AHA# _____ USEF # _____
 ADDRESS _____
 CITY/STATE/ZIP _____
 EMAIL _____

Entries Close April 1st, 2022
 Post Entries Accepted

*If paying by credit card, please complete the Credit Card form on page 9 and submit with entries.

- Checklist for Complete Entries:**
- Entry Blank with current memberships.
 - Signatures for Owner/Trainer/Handler on all waivers.
 - Payment—All Entries must be paid in full

Mail to:
Ryan Chambers
 P.O. Box 508
 Bonne Terre, MO 63628
 314-717-7683
 ryan@ringsideproductionsllc.com

Must have arrival date for pre-ordered shavings: _____

CLASSIC EGYPTIAN CHAMPIONSHIPS ONLY

(NOT RECOGNIZED BY AHA, USEF)

Release, Assumption of Risk, Waiver and Indemnification

**This document waives important legal rights. Read it carefully before signing.
Signatures below indicate that you have read and understand the above.**

SIGNATURES REQUIRED IN THREE (3) PLACES BELOW.

UNSIGNED ENTRIES WILL NOT BE ACCEPTED. CAREFULLY READ THIS AGREEMENT BEFORE SIGNING.

Every entry made on this entry blank shall constitute an agreement and affirmation that all participants (which shall include, without limitation, the owner, lessee, trainer, manager, agent, coach, driver, rider, handler and the horse) for themselves, their principals, representatives, employees and agents: (1) shall be subject to the rules of the Region 12 Championship show, including those posted in this Prize List, and on the Region 12 website; (2) represent that every horse, rider, driver and handler is eligible as entered; (3) agree to be bound by the rules of the Region 12 Championship Show, and will accept as final the decision of the show committee on any question arising under said rules, and agree to hold Region 12, its officers, directors and employees harmless for any action taken; and (4) agree that they participate voluntarily in the competition fully aware that horse sports and the competition involve inherent dangerous risk of serious injury or death and by participating they expressly assume any and all risks of injury or loss, and they agree to indemnify and hold the World Equestrian Center Ocala and Region 12 and their officers, directors, employees and agents harmless from and against all claims including for any injury or loss suffered during, or in connection with the competition, whether or not such claim, injury or loss resulted, directly or indirectly, from the negligent acts or omissions of said officers, directors, employees or agents of Region 12.

I also agree that as condition of and in consideration of acceptance of entry, the competition may use or assign photographs, videos, audios, cablecast, or other likenesses of me and my horse taken during the course of the competition for the promotion coverage or benefit of the competition. Those likenesses shall not be used to advertise a product and they may not be used in such a way as to jeopardize amateur status. I hereby expressly and irrevocably waive and release any rights in connection with such use, including any claim to compensation, invasion of privacy, right of publicity, or to misappropriation.

BY SIGNING BELOW, I AGREE to be bound by all applicable Region 12 Championship Rules and all terms and provisions of this entry blank. If I am signing and submitting this Agreement electronically, I acknowledge that my electronic signature shall have the same validity, force and effect as if I affixed my signature by my own hand.

EMERGENCY CONTACT PHONE NUMBER(S) DURING SHOW: _____

Owner (Mandatory)	Print Name	Sign X	An Adult must sign their name for Minor. You must be 18 to be listed as a Trainer. Handler US Citizen Yes ____ No ____ Handler US Citizen Yes ____ No ____
Trainer (Mandatory)	Print Name	Sign X	
1 st Handler (Mandatory)	Print Name	Sign X	
2nd Handler (Mandatory)	Print Name	Sign X	
Parental Consent for Minor	Minor Name	Parent/ Guardian Name Here	Sign X

USDF Membership Benefits: USDF is dedicated to education, the recognition of achievement, and promotion of dressage. For details on member benefits, including educational programs, awards, and other opportunities, refer to the *USDF Member Guide* or the USDF website at www.usdf.org.

**This
competition
is recognized
by USDF
for 2022**

Membership Requirements for USEF-licensed/USDF-recognized Competitions: Owners and riders, including foreign riders and owners who are not residents of the US, wishing to participate in a USEF-licensed/USDF-recognized competition as a rider or owner/lessee, must have either a USDF Group Membership (GM), Participating Membership (PM), or have a USDF Non-Member (NM) identification number and pay the USDF Non-Member (NM) fee. (Note: USDF Business Members can own horses but cannot compete as riders with their USDF Business Membership.)

Horses competing at USEF-licensed/USDF-recognized competitions must have either a USDF Horse Identification (HID) number or a USDF Lifetime Horse Registration (LHR). Proper credentials or verification certificates must be presented to the competition secretary.

Riders and owners wishing to participate in a USEF-licensed/USDF-recognized competition, and not able to present the competition secretary with verification of a USDF membership or NM identification, and USDF LHR or USDF HID, must complete a USDF Competition Affidavit Form and pay the \$5 affidavit filing fee. A copy of a completed affidavit form from another competition may also be used for verification purposes for up to 60 days. (Exception: Affidavits cannot be used at Great American Insurance Group/USDF Regional Dressage Championships.)

Exceptions:

- Horses competing only in Individual Breed Classes (IBCs) at DSHB competitions, sires and dams of horses in DSHB group classes, where those sires or dams are not actually competing in the same competition, horses competing only in breed restricted dressage or DSHB classes at Regular Competitions (e.g. all Arabian, all Friesian, or all Morgan classes), or in USDF Introductory Level tests, pas de deux or quadrille, are exempt from this requirement. Also exempt are horses ridden in leadline, exhibitions, games and races, classes for 4-H members, walk-trot, academy, and opportunity classes.
- Riders and owners/lessees competing only in classes which are exempt from the USDF HID requirements are also exempt from the USDF NM identification number and NM fee requirements. Also exempt are handlers of horses competing in DSHB In-Hand or Group classes.

Memberships Defined

Participating Membership (PM): A membership issued to an individual directly by USDF. The membership year is December 1 through November 30. PMs are available for 1-year (\$90), 5-years (\$360), or life (\$1,800). A USDF Youth Participating Membership (YPM) is available for individuals who have not reached their 21st birthday by December 1 of the current membership year (\$72). A PM allows the member to compete at USEF-licensed/USDF-recognized competitions and to participate as a rider and/or owner/lessee for all Adequan®/USDF Year-End Awards and the Great American Insurance Group/USDF Regional Dressage Championship program.

Group Membership (GM): A membership issued to an individual by USDF when the member name and dues are submitted to USDF through an affiliate Group Member Organization (GMO). The GM year begins December 1 and ends November 30. A GM allows the member to compete at USEF-licensed/USDF-recognized competitions and participate in the USDF Rider Awards Program and the USDF Regional Schooling Show Awards Program.

Business Membership (BM): A membership that runs December 1 through November 30 and is issued to a business or organization directly by USDF. The USDF BM (\$240) offers a wider variety of advertising benefits. BMs satisfy requirements of horse ownership only.

Non-Member (NM) Identification Number: For each USDF NM owner/lessee and USDF NM rider there will be a USDF NM fee of \$35 per competition that must be collected by the show secretary and submitted to USDF, along with the USDF Report of Fees document and the \$5 affidavit fee and Competition Affidavit Form if the person cannot provide a copy of their USDF NM card. Owners/lessees or riders exempt from the NM number requirements are also exempt from paying the USDF NM fee. If there are multiple owners of a horse and all are NMs, only one of the owners must pay the NM fee. If the horse has at least one owner who is a current USDF PM, GM, or BM there is no NM fee assessed. Competition management will be invoiced for all applicable USDF NM fees not received with the USDF post-competition paperwork, along with a report listing all USDF NMs. Competition management is then required to submit the NM fees within 30 days to the USDF. An individual with a USDF NM identification number is not eligible for any USDF membership benefits. Once a USDF NM number has been assigned, a USDF NM card can be obtained from the USDF website.

Horse Identification (HID) Number: A one-time tracking number for horses (\$35). Scores earned by a horse with an HID number will be recorded, but will NOT be counted towards Adequan®/USDF Year-End Awards. A horse with an HID number is not eligible to compete in Great American Insurance Group/USDF Regional qualifying or championship classes. An HID number can be upgraded to a Lifetime Horse Registration (LHR) for a fee of \$80. If a horse has a USDF LHR it does not need an HID number. An HID number is a one-time fee that does not need to be renewed.

Lifetime Horse Registration (LHR): A horse with an LHR (\$115) is eligible for Adequan®/USDF Year-End Awards, and eligible to compete in Great American Insurance Group/USDF Regional qualifying and championship classes, assuming requirements for the owner and rider are met. If a horse has an LHR it does not need an HID number. An LHR does not need to be renewed.

How to Join USDF

Applications for USDF Participating Membership (PM), Business Membership (BM), Horse Identification (HID) number, and Lifetime Horse Registration (LHR) may be found in the following locations:

- On the USDF website: www.usdf.org. You can submit the application online or download the form and fax or mail it to the USDF office.
- In the show office at USEF-licensed/USDF-recognized competitions classified by USEF as Dressage Competitions, and Regular Competitions which are open to all breeds.
- By calling or writing the USDF office at (859) 971-2277, 4051 Iron Works Parkway, Lexington, KY 40511

The effective date of membership is the date the form and correct fees are received in the USDF office or, if applying at a competition, the date accepted by the competition secretary, provided the application is signed and dated by the competition secretary, member, and/or horse owner on that same day.



The Markel difference

at the shows and in the barns

Whether you ride for pleasure or competitively, owning a horse is a substantial commitment. The horse people at Lisa Seger Insurance can help you protect the emotional and financial investment you've made.

Lisa Seger Insurance offers:

- Horse mortality & medical/surgical plans
- Independent trainer/instructor liability policy
- Farm package & liability only policies
- Excess/umbrella liability



With the many options available for insurance in today's market, I am here to assist you in securing the right coverage to meet your specific needs. I look forward to hearing from you and look forward to seeing you at the shows and in the barns.

Sincerely,

Pagan

Pagan Gilman

+1.770.283.7344 | pagan@lisasegerinsurance.com

www.lisasegerinsurance.com

Products and services are provided by one or more of the Insurance companies under the Markel North America Insurance Group and policyholder services are provided by the underwriting manager Markel Service, Incorporated, national producer number 27585. Terms and conditions for rate and coverage may vary. Markel® is a registered trademark of the Markel Corporation. ©2022 Markel Service, Incorporated. All rights reserved.



Region 12 Stable Request Form

Organizing these notes helps the show office and stall manager sort stalls for trainers and their customers, eliminating duplicates and ensuring all customers are stabled together.

	Owner	# Horse Stalls	# Tack Stalls	# Shavings	Must Have Arrival Date
1					
2					
3					
4					
5					
6					
7					
8					
9					
10					
11					
12					
13					
14					
15					
16					
17					
18					
19					
20					
21					
22					
23					
24					
25					
Stall - Tack - Shaving TOTALS					

Trainer: _____ Cell phone _____

EMAIL: _____ Contact Person: _____

Special Stabling Request:

Arabian Horse Association Show Recognition

Competition Sponsor: Region XII Arabian Horse Association

AHA Recognition Show/Recording Number: 221215565

The Arabian Horse Association is a major equine association serving members in the United States and Canada. It registers and maintains a database of more than one million Arabian, Half-Arabian and Anglo-Arabian horses and administers more than \$2.5 million in annual prize money. AHA produces championship events, recognizes over 375 Arabian horse shows and distance rides annually and provides activities and programs that promote breeding and ownership. For information about Arabian, Half-Arabian and Anglo-Arabian horses, call 303-696-4500, e-mail info@ArabianHorses.org or visit ArabianHorses.org.



The Judges & Stewards Commission is responsible for handling written and signed complaints relating to judges' and stewards' conduct within the United States. AHA members or exhibitors, and/or accompanied by a filing fee (Procedures 2-90). Other comments, suggestions, questions, inquiries are encouraged when appropriate (no filing fee required). Write: Judges & Stewards Commission, PO Box 446249, Aurora, CO 80044-0249 (303) 696-4537

Join AHA through your local club for the following great member benefits:

- Reduced rate for competition privileges across a variety of disciplines for local, regional and national AHA-approved shows and rides
- Peace of mind with 1 million in personal liability insurance through Equisure
- Preferred rates on horse registrations and transfers
- Preferred rates on Arabian Horse DataSource, the world's largest online Arabian horse resource
- Numerous opportunities to participate in award recognition and prize money programs
- Show circuits for AHA members at local, regional and national levels

Contact your local club: Contact Region 12 Director: Laurie Salmi - laurie@level59.com



Arabian Horse Association 10805 East Bethany Drive Aurora, CO 80014 303.696.4500 303.696.4599 fax ArabianHorses.org
AHA 00002 (06-01-20)

USEF Competition Name: **Region XII Championship Show**

USEF#: **2207**

Competition Division(s) and Rating(s): **"N" in A/HA/AA, Junior Exhibitor A/HA/AA USEF Dressage**

MAAP MINOR ATHLETE ABUSE PREVENTION

LEARN ABOUT MAAP POLICIES



SafeSport Training



One-On-One Interactions



Local Travel



Social Media and Electronic Communications



Read about these and more at usef.org/MAAPP

REPORT MAAP POLICY VIOLATIONS



usef.org/safe-sport/reporting
859-225-6915



U.S. CENTER FOR
SAFESPORT



WORLD EQUESTRIAN CENTER OCALA

1390 NW 80th Court Road - Ocala, FL 34482 - Customer Service - #352.414.7900

**Directions: Upon arriving in Ocala from the North or from the South on Florida I-75,
Exit on W Hwy 326 going west to NW 70th Avenue, turn left and follow to WEC.
NW 70th Avenue will turn into NW 80th Court Road**

***** Things to Remember *****

- **Pre-Entry Deadline is APRIL 1, 2022 - Post Entries Accepted**
- **Check the Session by Session closing times for late class entries, Rule #38**
- **Are Health papers up to date (Coggins, Vaccine, Health Certs)**
- **Golf Carts & RV Slips - Reserve through WEC at worldequestriancenter.com**
Under Ocala, click Golf Cart Rental for both
- **Stalls available 2:00 pm Monday MAY 2, 2022**
- **Stalls must be vacated by Noon on Monday, May 9, 2022**
- **Complete and submit the Stable Request Form**
- **Junior and Amateur Riders - Be sure to include your date of birth on your entry**
- **Dogs must be on a 6-foot leash or confined at all times**
- **Spotlight Futurity classes will use Junior Horse Class specs**
- **No parking in loading areas**
- **No unlicensed golf cart drivers**
- **Be sure to include your arrival date on your Entry Form and the Stable Request form**
- **Please Note: No outside shavings are allowed to be brought onto the grounds**
- **SECURITY: WEC 24-hour Security—352.414.7960**



**ONLINE ENTRIES ARE NOW AVAILABLE AT:
www.ringsideproductionsllc.com**





Hilton
HILTON OCALA

**HILTON OCALA
HOST HOTEL OF THE
REGION XII
ARABIAN & HALF-ARABIAN
CHAMPIONSHIP HORSE SHOW**

The Hilton Ocala is a full service hotel conveniently located 8 miles from World Equestrian Center at I-75 and SR 200. As host hotel, we're offering exhibitors a preferred rate of \$139.

- Close proximity to restaurants, grocery stores & 2 malls
- Trailers and RV friendly parking
- Conveniently located near Lowe's and Home Depot
- Full service restaurant and bar serving breakfast, dinner and cocktails
- Only 4.2 miles from Historic Downtown Ocala
- Lushly landscaped pool area
- Indoor and outdoor fitness equipment and outdoor walking trail
- Preferred rates for Region XII exhibitors
- Pet friendly



Hurry, our special Region XII exhibitors rate of \$139 expires April 11, 2022. Call 800-774-1500 and mention rate code ARCS22. Or booking online at <https://group.hilton.com/xx7s6y>

For more information, visit us at www.hiltonocala.com.

