

# FLOATING GLASS SHELF INSTALLATION INSTRUCTIONS



## NEEDED

Insulation / Gaffa Tape

1 x Caulking Gun

## INCLUDED

1 x Adhesive

Stabiliser Blocks

Spatula

**IMPORTANT: Protect the shower floor until adhesive has fully cured in case of the unlikely event that shelf/shower is disturbed and the shelf falls.**

Crest Showers Floating Glass Shower Shelf can be installed in any corner of a glass or tile wall. If two shelves are installed in the same corner, ideal shelf heights off the floor are 1200 & 1600mm. When installed in different corners, an ideal height is 1400mm off the floor. When installing onto Seratone, Hardiglaze or similar, apply insulation/gaffa tape to the liner then adhere the stabiliser block on top of the tape. This makes the blocks easier to remove and protects the wall board surface.

We DO NOT recommend installing these on FLAT acrylic liners, due to adhesion difficulties. They are however, compatible with CREST moulded liners. If you do wish to use on an acrylic surface, ensure the acrylic liner where you are mounting the shelf is roughened with sandpaper and extra time is taken before shelf is used.

1. PREPARATION: Clean area shelf is being adhered to ensuring it is free of any dust, soap scum, cleaners or any other substance.
2. APPLY STABILISER BLOCKS: Use a level to determine the shelf position and apply stabiliser blocks by removing the adhesive backing and pressing them firmly onto the wall.
3. LEVEL THE SHELF: Place the shelf in position to confirm that it is level. If required, adjust the stabiliser blocks to suit. Optional - apply masking tape to shelf/wall to prevent beeding of the adhesive onto the wall or shelf.
4. APPLY ADHESIVE: Remove shelf from trial position and put a thin bead of adhesive down both edges of shelf
5. PLACEMENT: Carefully place shelf on stabiliser blocks and gently push into corner. Remove any excess adhesive. Check the level and add additional blocks to top of shelf to hold in place while adhesive cures.
6. CLEANING: Clean up adhesive with spatula. Remove Insulation/Gaffa tape.
7. CURING: After 48 hours remove stabiliser blocks.

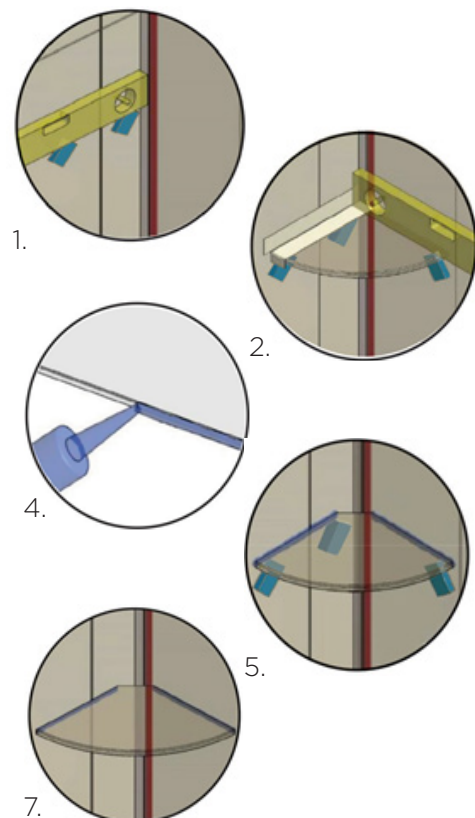

# crest showers

Scan QR Code For Video Installation Instructions

