

# Moss Beach

Potential Phased Transportation Projects &  
Recommendations for Cypress Point

Joe LaClair, Planning Manager  
San Mateo County Planning and Building

# Overview

- Share approach to achieving long-term vision for coastside mobility through phased improvements
- Share recommendations under consideration and discussion as part of proposed development in Moss Beach (Cypress Point)

# Phasing-in Improvements



Implementation of improvements supporting long-term vision



Be nimble in the face of a changing funding landscape



Allow for more data collection, evaluation, and exploration of demonstration projects and other new ideas

# Phase 1 (0 – 5 years)

- 🏠 Proposed development
- 🚶 Ped X-ing improvements
- 🚶 Sidewalk
- 🚗 Roadway striping/signage
- 🚌 Bus stop improvements
- 🚦 Intersection control (to be determined)
- 🔄 Roundabout (Cypress Ave)
- 🛣️ Roadway reconfiguration



- Infrastructure improvements as part of new development
  - Cypress Ave roundabout
  - ICE for California Ave and Etheldore/Vallemar
- Ongoing operations and maintenance, small scale capital improvements
- Data collection, evaluation, grant writing

# Phase 2 (5 – 10 years)

- 
- Proposed development
  - Ped X-ing improvements
  - Sidewalk, ped linear improvements
  - Roadway striping/signage
  - Bus stop improvements
  - Intersection control (to be determined)
  - Roundabout
  - Roadway reconfiguration
  - Parking
  - Bike parking
  - Bikeway
  - Parallel Trail
  - One-way orientation of Carlos

- Grant-funded projects pursued as part of Connect the Coastside, County Active Transportation Plan, C/CAG Bicycle and Pedestrian Plan, others
- Implement temporary improvements as needed for proof of concept
- Work with SamTrans to improve bus service
- Approval from appropriate agencies (Caltrans, etc.)

# Phase 3 (10+ years)

- Proposed development
- Ped X-ing improvements
- Sidewalk or linear improvements
- Roadway striping/signage
- Bus stop improvements, transit freq.
- Intersection control (to be determined)
- Roundabout
- Roadway reconfiguration
- Parking
- Bike parking
- Bikeway
- Parallel Trail, CA Coastal Trail
- One-way orientation of Carlos
- Park and Ride

- Implementation of long-range plan visions through funds from grants, local taxes, and fees
- Larger-scale capital projects
- Continue collecting data to evaluate progress toward vision



# Focusing on Phase 1



Proposed improvements as part of Cypress Point



Focus on low-cost, high-impact improvements that further vision in long-range planning documents



Informed by feedback by MCC, community meetings, site visit, and internal review



Conceptual with continued study and discussion

# On-site strategies to encourage walking, bicycling, and transit use

- Clear and inviting pedestrian site access from Sierra
- Internal wayfinding to clarify routes to destinations
- Covered long and short-term bicycle parking with transportation information kiosk, bike repair station





# On-site strategies to encourage walking, bicycling, and transit use

## Route 17



- Provision of low-cost bicycle tubes and other repair materials
- Transit subsidies and promoting participation in C/CAG pilot program for rideshare to transit
- Unbundled parking costs

# Making it easy to walk downtown along Sierra / Stetson / California

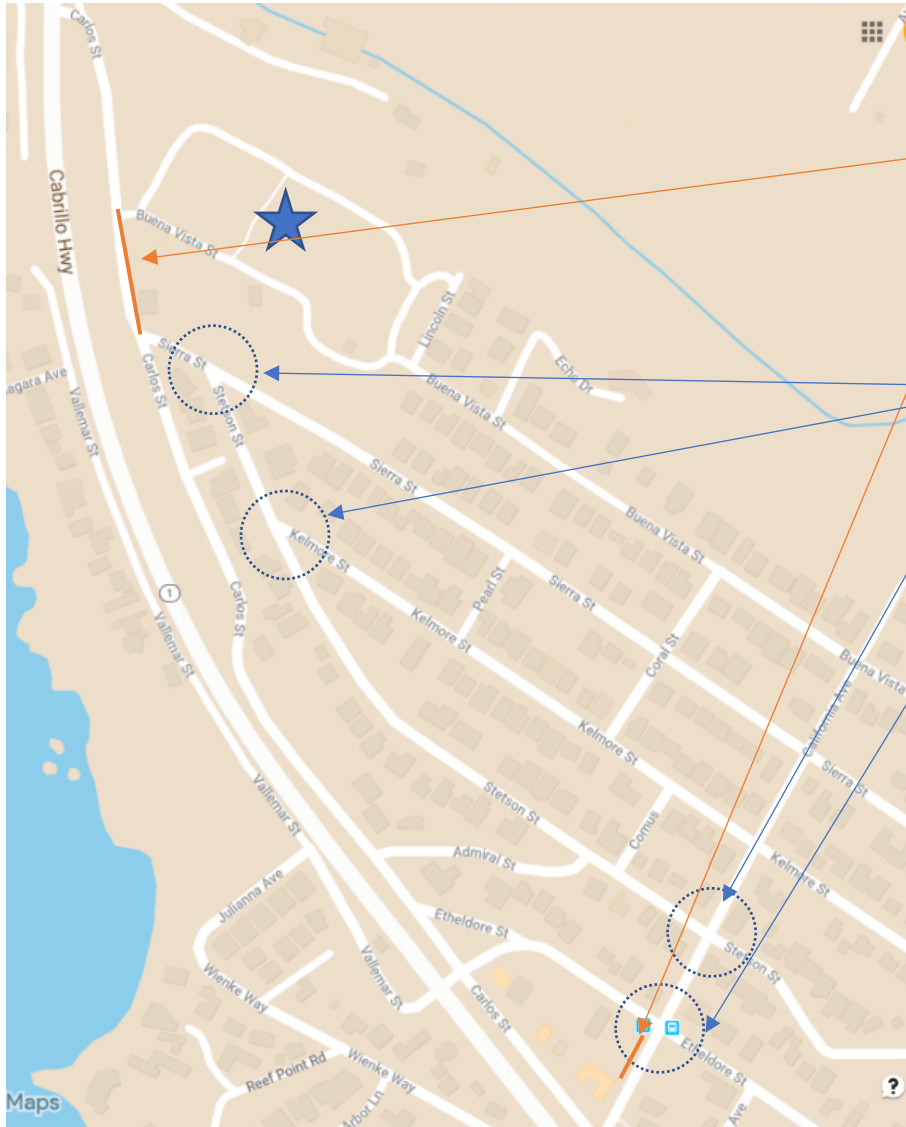

New sidewalks on Carlos (Project to Sierra) and California Ave (Etheldore south where missing)

High visibility marked crosswalks, advanced stop/yield bars, and improved ramps

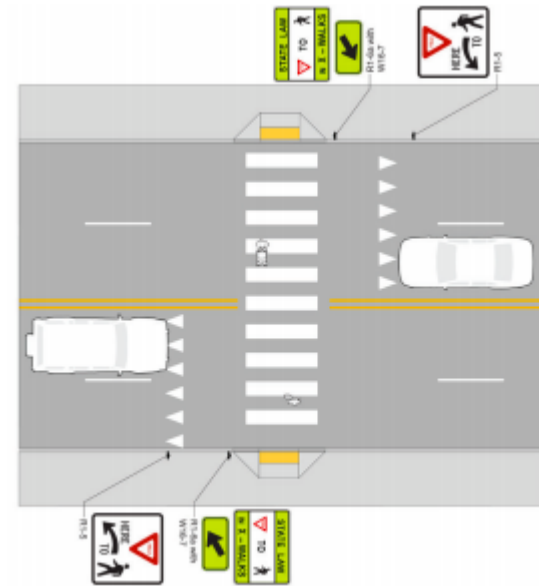

# Improve bus stops at California and Etheldore

Add ADA-compliant concrete pads and bus benches at both bus stops on California and Etheldore

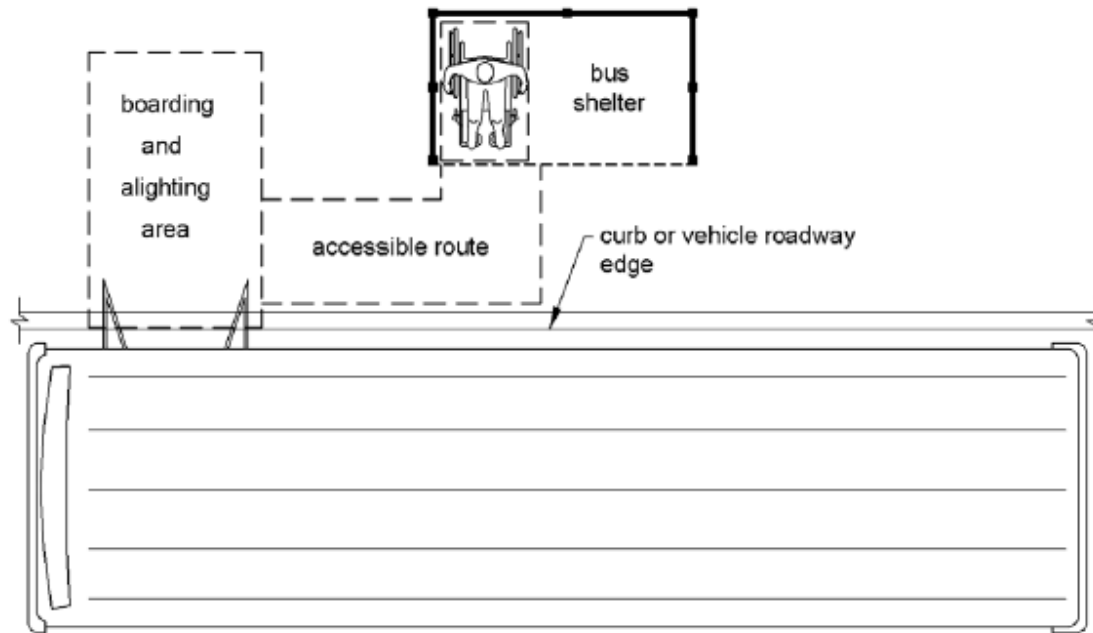

# Improve conditions at Carlos St and Highway 1

- Incorporate findings from Highway 1 Safety and Mobility Study, Phase 2
- Carlos St
  - Right-turn only to northbound Highway 1
  - Painted median on Carlos to narrow ingress/egress and channelize right turns as feasible to create an acceleration lane to increase sight distance
- Highway 1
  - Clear landscaping south of Carlos to increase sight distance
  - Work with Caltrans to install painted medians with left-turn bay southbound onto Carlos St and northbound onto Lighthouse driveway

# Phase 1 - Carlos St / Highway 1

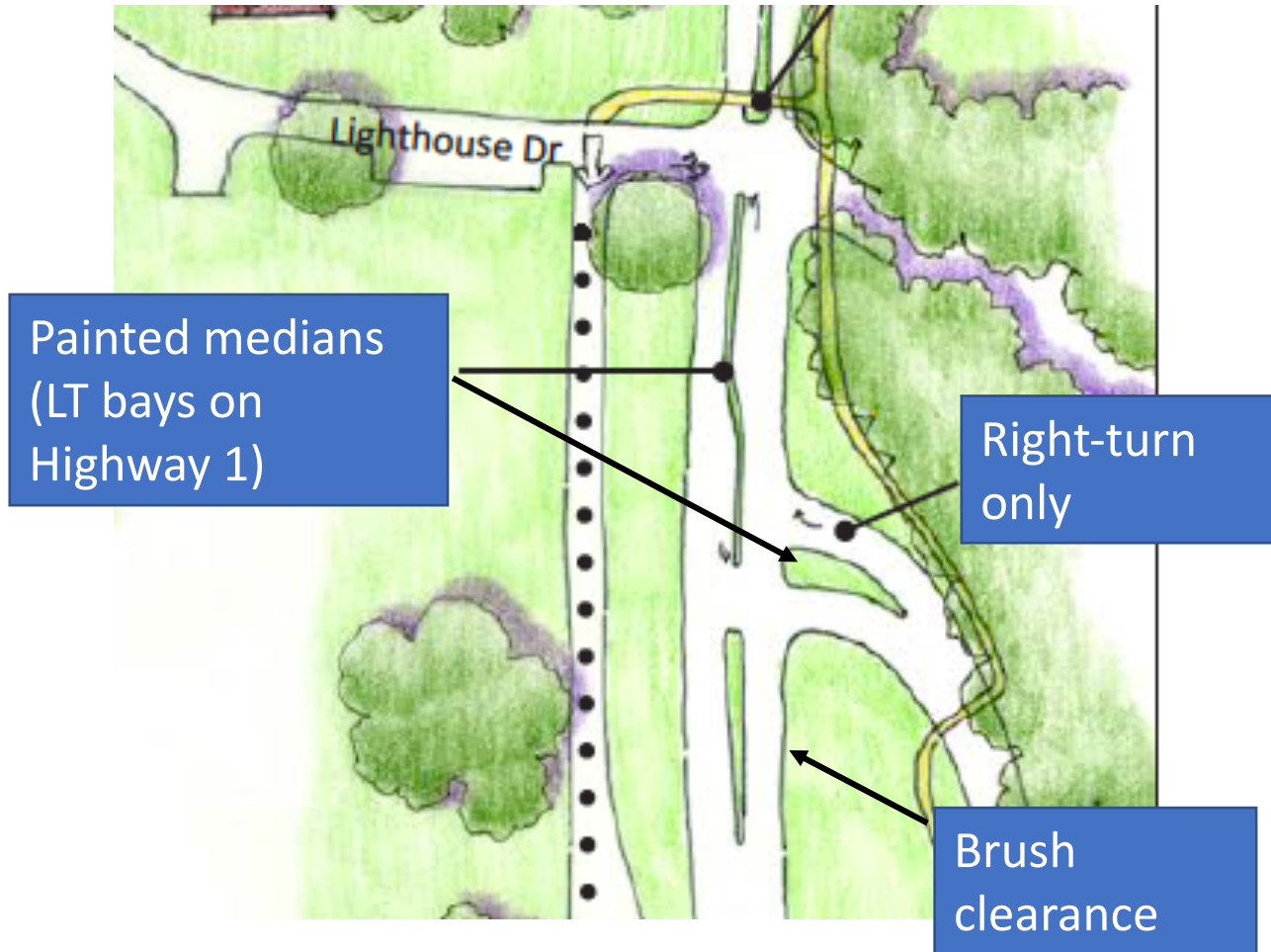

# Improving conditions for drivers

Continue studying corridor-level scenarios to improve conditions for drivers without compromising safety or vision for active transportation

- Cypress Avenue roundabout
- Based on ICE findings, implement best long-term solution at Etheldore/Vallemar or California Ave
- Incorporation of future Parallel Trail
- Addressing future pedestrian crossings of Highway 1
- Managing vehicular flow to create safer left-turns

# Example: Etheldore / Vallemar Roundabout (Highway 1 Safety & Mobility Study, Phase 2)

Etheldore/Vallemar Street

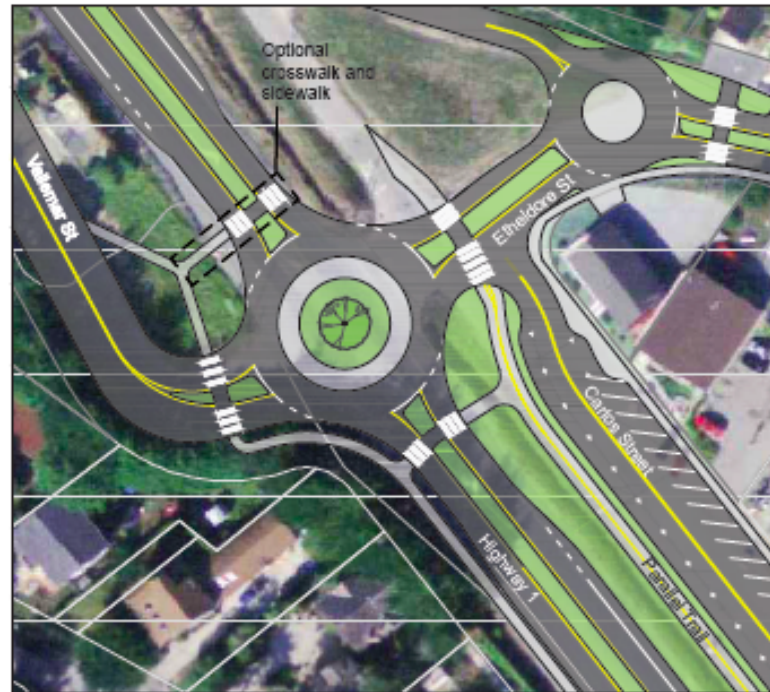

*The drawing illustrates a roundabout at the north entry to central Moss Beach and to Carlos Street, a parallel frontage road that serves as the community's main street. A smaller mini-circle northeast of the roundabout enables vehicles exiting Carlos Street to easily make u-turns back to the highway. Formal diagonal parking and parallel parking is marked on Carlos Street. The Parallel Trail passes through on the west side of Carlos and crosses the slow speed intersection created by the roundabout.*

Example:  
Roundabout  
at California  
(Wallwork Draft  
Design)

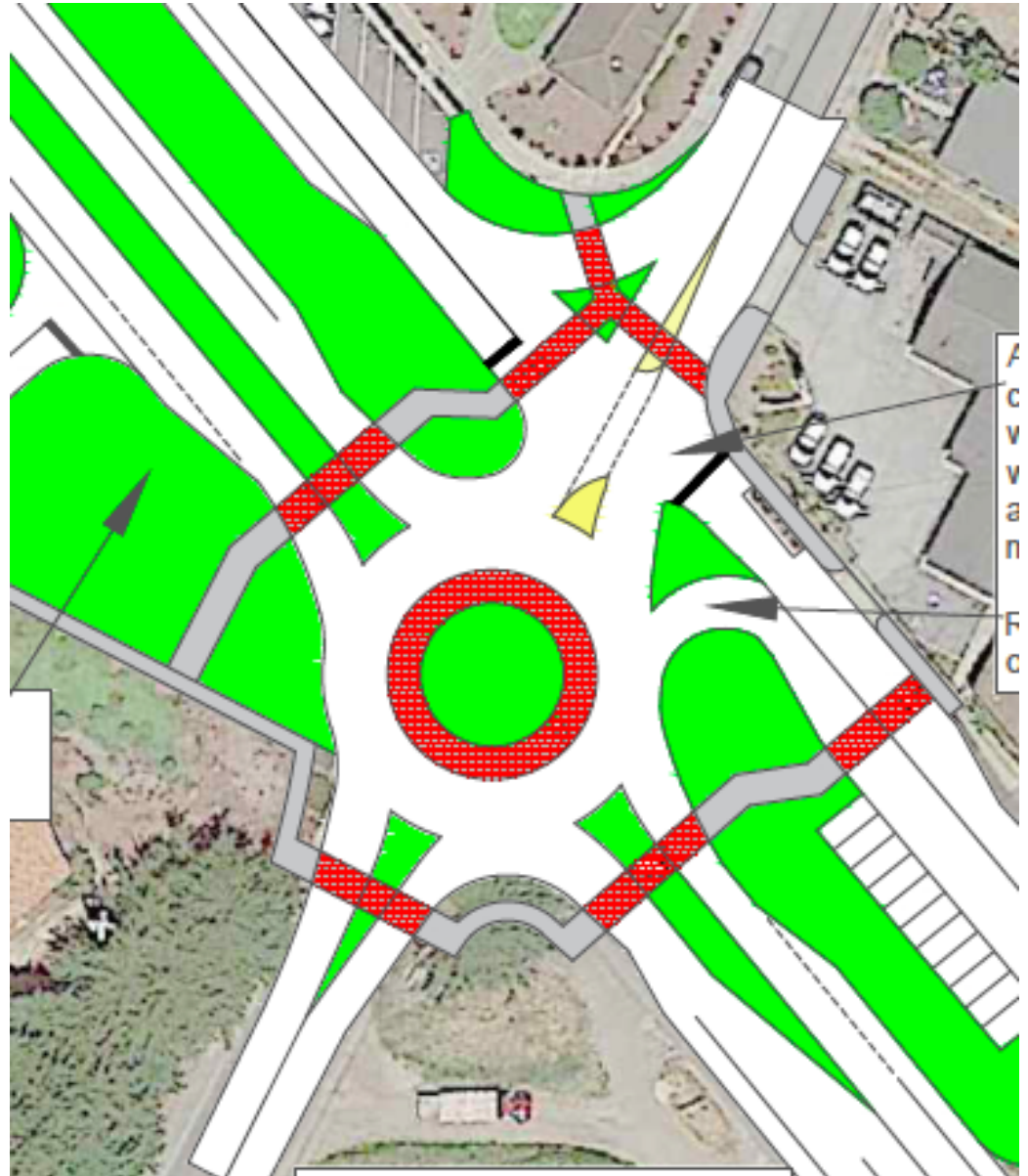



# Next Steps

- June 10th Planning Commission meeting for Cypress Point for LCP amendment
  - Moves project to next phase
  - Continued study and refinement of transportation improvements if amendment moves forward
- Continued community engagement and project refinement for Connect the Coastside
  - 5/30 from 10:30 am – 12 pm for overview meeting
  - 6/15 from 6:30 pm – 8 pm for Moss Beach, Montara focus meeting