



PLN2017-00320

Harbor Village  
RV Park

corner Hwy 1 &  
Capistrano Rd,  
Princeton

RV Park

view  
easement

OCEAN VIEW CORRIDOR

Harbor Village &  
Oceano Hotel

This remaining harbor view from southbound Hwy 1 is protected by Clear View Easement with 5-ft height limit, including landscaping.



RV site is in full view from northbound Hwy 1 & Capistrano Rd.



## RV Park project rendering



Applicant has appealed Planning Commission approval to BoS, objecting to 3 Conditions of Approval.

- Reduce size of the existing sign at Hwy 1 & Capistrano Rd to maximum 6 ft high & 9 ft wide.



Monument sign at rear entrance to Harbor Village is 6'H x 9'W

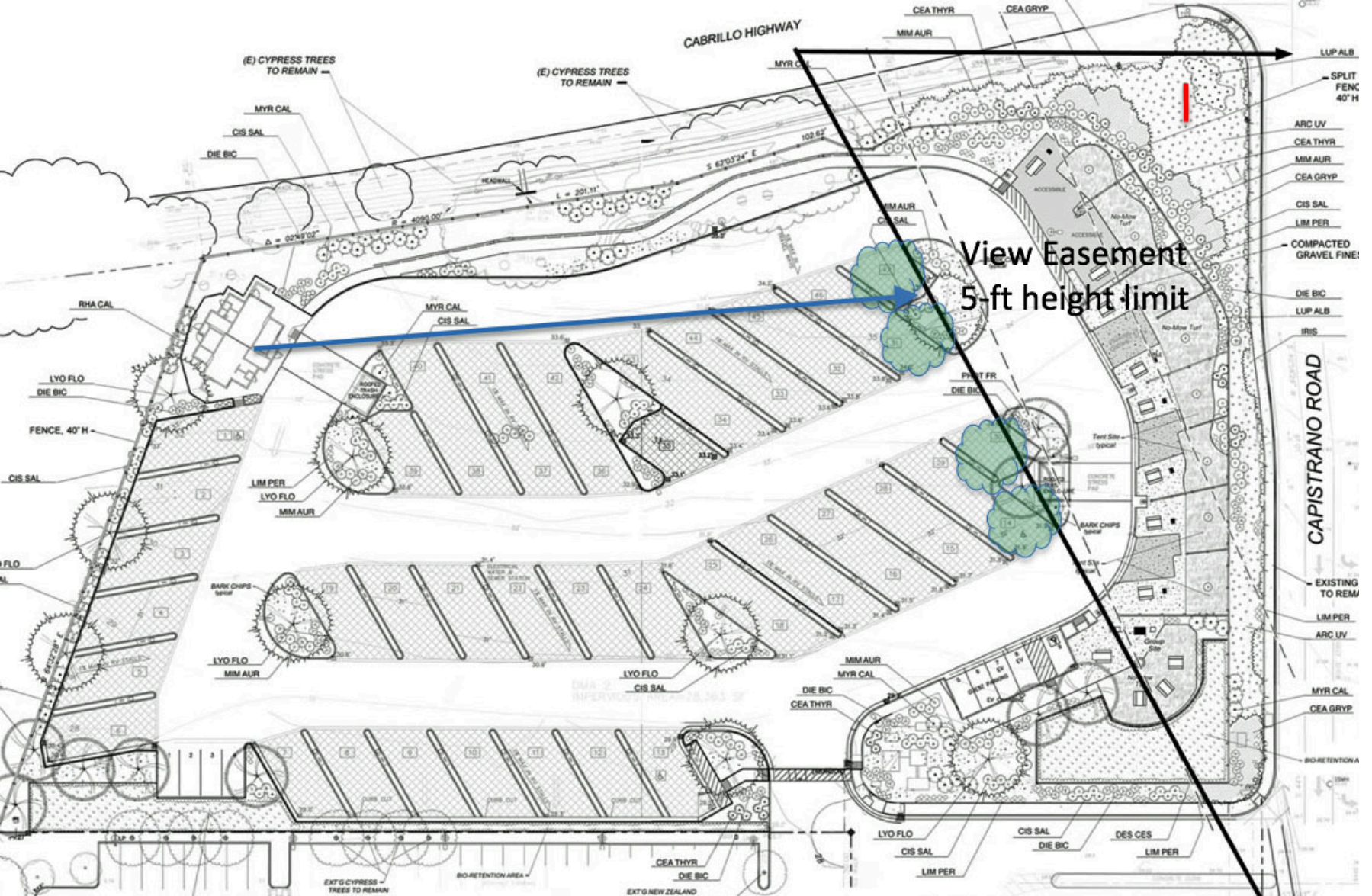

- Move restroom/laundry building to face the edge of the view easement at the end of the upper row of RVs (blue arrow) -- (screens row of RVs, more convenient to tent users, avoids impacts to cypress trees)
- Delete 2 RV spaces at the end of the lower row of RVs, and provide robust landscape screening, outside the view easement. (green tree symbols)