

DIST	COUNTY	ROUTE	POST MILE TOTAL PROJECT	SHEET NO. SH
04	SM	1	32.51 TO 32.71	3

REGISTERED CIVIL ENGINEER

PLANS APPROVAL DATE
 STATE OF CALIFORNIA -
 DEPARTMENT OF TRANSPORTATION

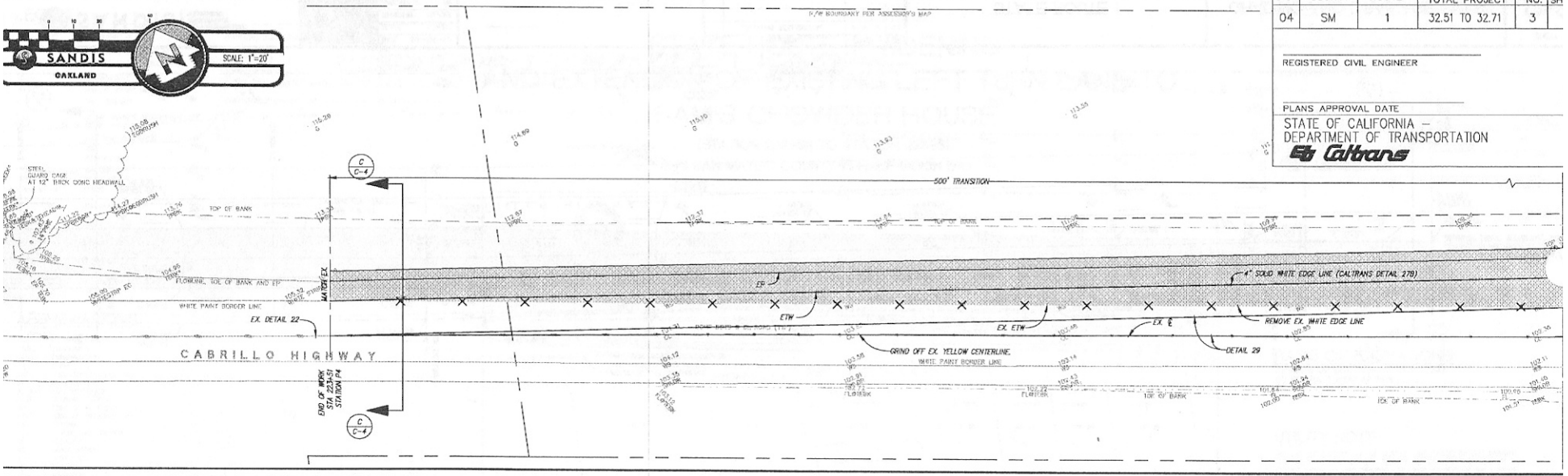

- STRIPING NOTES:**
- ALL STRIPING SHALL CONFORM TO THE LATEST CALTRANS STANDARDS.
 - ALL TRAFFIC STRIPES AND PAVEMENT SHALL BE INSTALLED WITH HIGH REFLECTIVITY MATERIAL.
 - THE EXISTING CENTERLINE WITHIN THE TWO WAY LEFT TURN AND MEDIAN ISLAND SHALL BE REMOVED. LEFT TURN ARROWS IN TWO WAY LEFT TURN LANE SHALL FOLLOW CA MUTCD FIGURE 30-7.

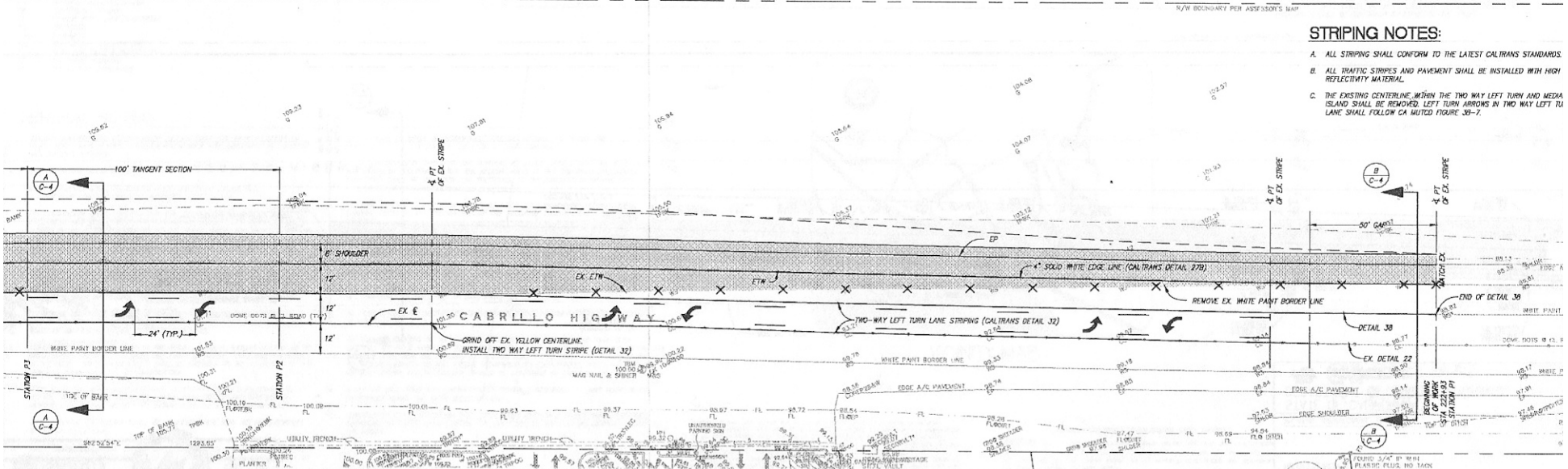

	DATE 01-04-13 SCALE 1"=20' DRAWN BY GL/RE APPROVED BY JMW DRAWING NO 612051	DATE _____ JEFFREY MICHAEL SETERA R.C.E. NO. 42703, EXPIRES 6-30-14	<table border="1"> <thead> <tr> <th>No.</th> <th>REVISION</th> <th>DATE</th> <th>BY</th> </tr> </thead> <tbody> <tr> <td>1</td> <td>CALTRANS RESUBMITTAL</td> <td>4-3-13</td> <td>RS</td> </tr> </tbody> </table>	No.	REVISION	DATE	BY	1	CALTRANS RESUBMITTAL	4-3-13	RS	STATE ROUTE 1 HALF MOON BAY CALIFORNIA	STRIPING PLAN	SHEET C-3 3 OF 4 SH
	No.	REVISION	DATE	BY										
1	CALTRANS RESUBMITTAL	4-3-13	RS											

P:\612051\PLAN SR13[C-3]_orig Date: Apr 16, 2013 - 12:38 PM

PLN 2013-00203