



INSTRUCTIONS MANUAL LINE T392

THIS PANIC DEVICE MANUAL MUST BE PROVIDED TO USER

DESIGNATION OF PARTS

- a. Center case
- b. Rail Case
- c. Front nylon case
- d. Push bar
- e. Cap
- f. Center case screws
- g. Latch bolt cover
- h. Cap screws

A

FRONT PARTS

REAR PARTS

- a. End cap screws
- b. Rear nylon cover
- c. Rail Case
- d. End cap
- e. Push bar
- f. Mounting bracket
- g. Rear lever

B

PANIC DEVICE INSTALLATION (SINGLE DOOR)

1

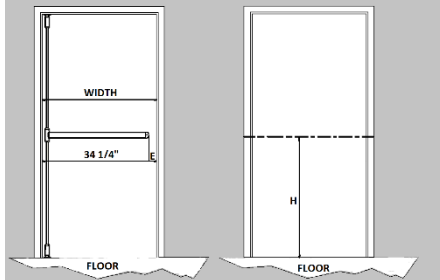

Draw a horizontal line at H between 36" to 43" height. For higher doors over 7', necessarily use H: 43". For doors width less than 3', cut the device to maintain the minimum distance E: 1 1/2". (See steps 4 to 6)

2

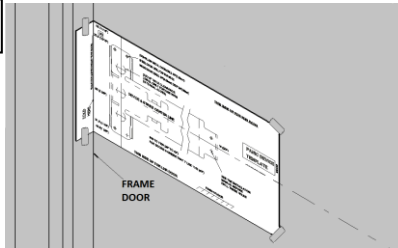

Align the template with the marked line and make the holes as indicated by template panic device. Use scotch tape for fix the template as shown.

3

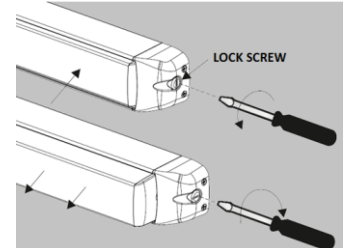

Dogging system: to undogg the push bar, turn a flat screwdriver 90° clockwise; to dogg it, turn tool 90° anticlockwise. Remove both front and rear caps. If cutting is required, follow steps 4, 5 & 6. If not, go on with step 7.

4

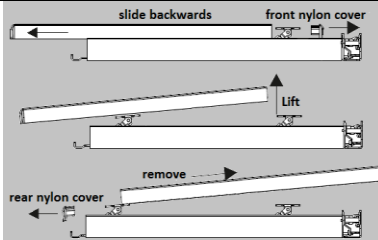

Remove front nylon cover; slide push bar backwards and then remove rear nylon cover. Lift and remove bar as shown.

5

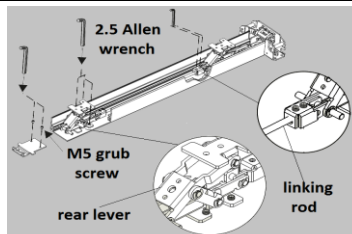

Use a 2.5mm Allen wrench to loosen grub screws that hold the linking rod to the front lever and the mounting bracket. Slide these parts out of the rail case, keeping the front lever fixed in its place.

6

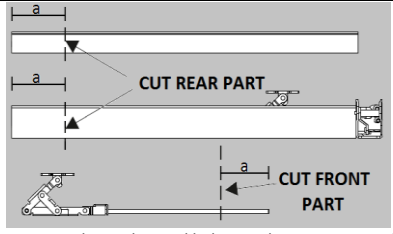

Use a saw to cut rail case, bar and linking rod same measure (a). This size is $a = 3' - \text{width of door}$. Replace rear scissor, mounting bracket and linking rod; and tighten grub screws.

7

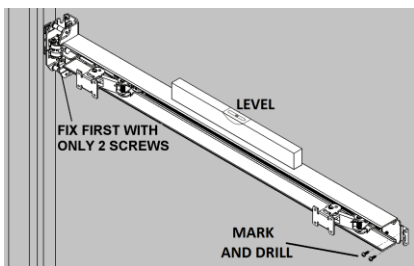

Place the rail case on the door and fix it with only 2 screws (parker 8x1/2" or W5/32"x1/2"), no adjusting at all. Be sure to have it aligned and mark and drill the holes of the mounting bracket. Fix the rest with the same screws.

8

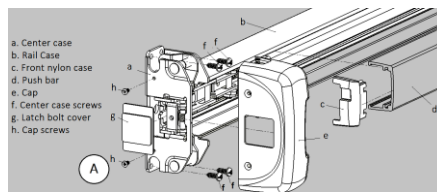

Insert the push bar in opposite direction as shown in 4. Place and fix its covers and end cap. (See figures A and B).

1 PANIC DEVICE INSTALLATION (DOUBLE DOOR)

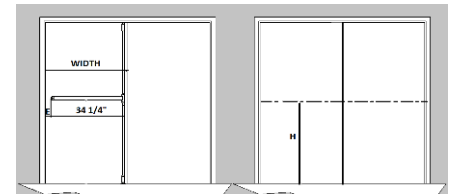

Draw a horizontal line on both doors at "H" between 36" to 43" height. For higher doors over 7', necessarily use H: 43". For doors with less than 3' width, cut the device to maintain the minimum distance E: 1 1/2" (See steps 4 to 6).

2

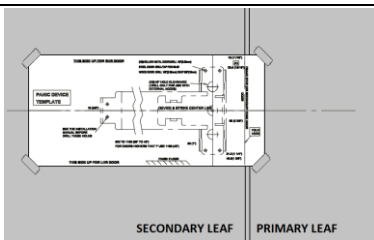

Align the template with the marked line and drill the holes as indicated. Then follow steps 3, 4, 5, 6, 7 and 8. Use scotch tape for fix the template as shown.



- Panic device height projection (2 1/2"/64mm)
- Door application field: Single and double doors
- Weight Max: 440lb.(200kg.)
- Height Max: 8'(2440mm)
- Width Max: 4'(1220mm)
- Temperature: 14°F to 140°F (-10°C a 60°C)

Line T 392: designed for panic door exit. For certificate and further information, please visit our website.

RECOMMENDATIONS

"The safety features of this product comply with UL 305. Any different alteration than the ones specified in these instructions are forbidden".

REMARKS: For double leaf doors, see also T391 assembly instructions.

TOP AND BOTTOM LATCH INSTALLATION

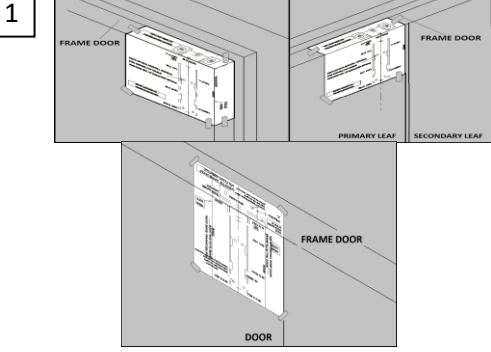

Check the opening orientation of each leaf. Present latch template for top and bottom closures on the door, and drill the holes as shown. Use scotch tape for fix the templates as shown.

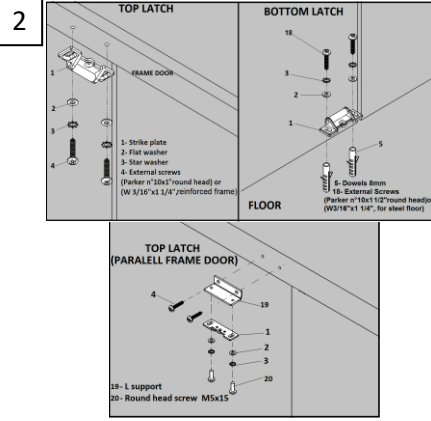

Apply strikes on the frame of door and floor with screws and washers in the shown sequence for each case. It is not necessary to use the adjusting shim by this time.

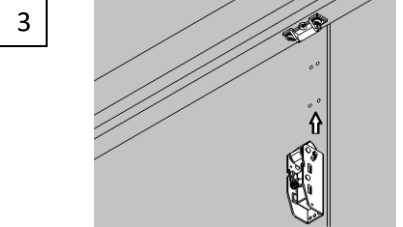

Present and fix both top and bottom latch cases with (Parker n°8x1/2" or W5/32"x1/2").

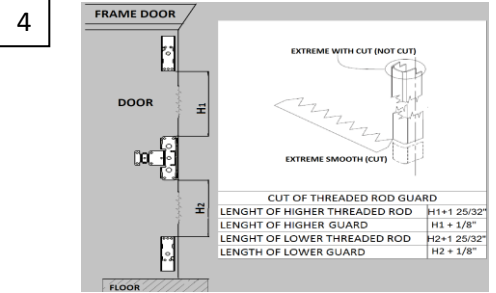

If necessary, cut threaded rods and covers as indicated. Always use the higher threaded rods and guards for up position as shown.

DESIGNATION OF PARTS (TOP AND BOTTOM LATCHES)

COMPONENTS	QUANT.
1 STRIKE	2
2 FLAT WASHER	4
3 STAR-SHAPED WASHER	4
4 SCREW PARKER N°10X1	2
4* SCREW W 3/16"X 5/8"	4
5 SCREW PARKER N°10X1 1/4"	2
5* SCREW W 3/16"X 5/8" (FLAT)	2
6 DOWELS 8mm	3
7 LATCH CASE	2
8 SCREW PARKER N°8X1/2"	14
8* SCREW 5/32"X1/2"	14
9 CAP 392	2
10 CAP 392 SCREW	4
11 GUARD SUPPORT	2
12 SCREW PARKER N°6X1 1/4	4
13 CENTER CAP SCREW	2
14 CENTER CAP CASE	1
15 ROD FIXING SCREW	2
16 THREADED ROD GUARD	2
17 THREADED ROD	2
18 SCREW PARKER N°10X 1 1/2"	2
19 L-SHAPED PLATE (parallel frame door)	1
20 SCREW MSX15 (parallel frame door)	2
21 FRONT CAP COVER	1

Important:
2 additional shims (one for each strike) are included if necessary, but not necessary for a normal installation

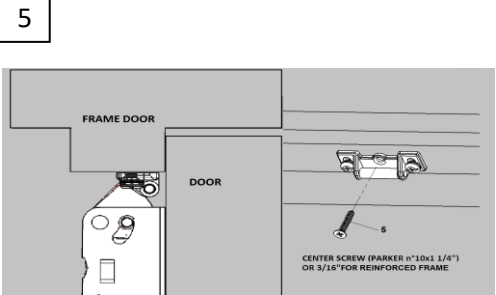

Close the doors. Check top & bottom strikes for their definitive position, with no gaps between the rollers and the latch bolts. Mark and drill the center holes and fix the strikes with the center fixing screw. In case of parallel frames, it is recommend drill/tap BSW 3/16"-24 the L-shaped plate by removing it from the frame.

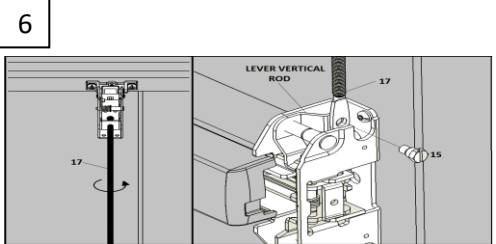

Screw both threaded rods to the upper and lower latch cases until the hole in the opposite tip matches with the one in the panic device lever. Fix the rod fixing screws (15) and adjust until they stop. Verify that both closures fully release the strikes simultaneously. If necessary, screw/unscREW threaded rods.

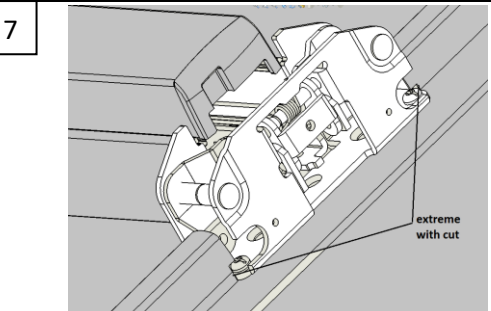

Place the rod guards according to the image, then both caps (9), (14) and the latch cover (21), fixing them with their screws.

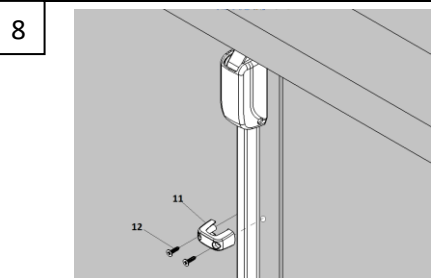

Present the rod guide according to the distance indicated in the "designation of parts" figure; mark and drill two $\approx 3/32"$ holes and fix the guide.

Outside trims series (optional):
T800-XX / T850-XX / T870-XX

Special Tools Required:

- 1/8" (3.25mm) diameter drill bit
- 3/32" (2.5mm) diameter drill bit
- 1/2" (12mm) diameter drill bit (for outside trim)
- #25 (3.75mm) drill bit
- BSW 3/16"-24 drill/tap
- BSW 5/32"-32 drill/tap
- 2.5 Allen wrench
- Level
- Hack saw