

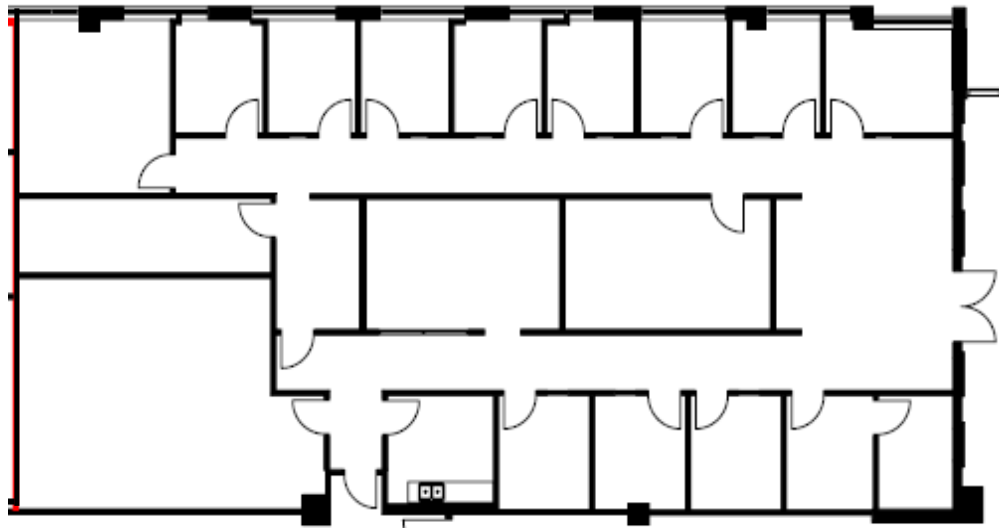

# FLAGLER STATION

**BUILDING 1100**  
**10451 NW 117TH AVE**

**Suite 115** | 3,605 RSF



FULL FLOOR



LEASING CONTACT:

**Eric Groffman**  
+1 786 390 7497  
eric.groffman@cbre.com

**Cameron Tallon**  
+1 407 284 7455  
cameron.tallon@cbre.com

**Emily Brais**  
+1 305 733 4092  
emily.brais@cbre.com

**CBRE**