

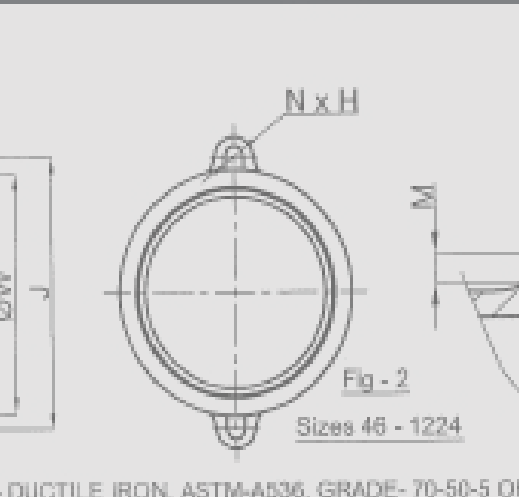

Quality – Service – Commitment – Delivered.

C110 DUCTILE IRON PUSH-ON FITTINGS



C110 DUCTILE IRON PUSH-ON FITTINGS BASIC SPECIFICATIONS

- SIZES:**
 - 4" - 24"
- MATERIAL:**
 - Ductile Iron ASTM A536, Grade 65-45-12, 60-42-10 or 70-50-05.
- PRESSURE:**
 - 350 PSI Water Working Pressure 4" - 24"
- TESTING:**
 - In accordance with ANSI/AWWA C110/A21.10
 - In accordance with UL - FM requirements.
 - All fittings are hydrostatically tested in accordance with SIGMA Quality Management Standard.
 - All fittings are heat coded to ensure traceability and verification of metallurgical properties in accordance with SIGMA Quality Management Standards.
- LAYING LENGTH:**
 - In accordance with ANSI/AWWA C110/A21.10.
- DEFLECTION:**
 - Up to 5 degrees, in accordance with TYTON JOINT bell design.
- CEMENT LINING:**
 - Double cement lined in accordance with ANSI/AWWA C104 / A21.4.
- COATING:**
 - Interior of fitting is seal coated (asphaltic material) in accordance with ANSI AWWA C104/A21.4 and NSF61 approved.
 - Exterior of fitting is seal coated (asphaltic material) in accordance with ANSI/AWWA C110/A21.10 and NSF61 approved.
- GASKETS:**
 - Dual hardness SBR in accordance with ANSI/AWWA C111/A21.11.
 - Also available in EPDM, NBR and CR.
- JOINT:**
 - TYTON JOINT design
- APPROVALS:**
 - 4"-16" Underwriters Laboratories listed and Factory Mutual Approved.
- STANDARDS:**
 - Certified to NSF61 Standard including Annex G & 372.
 - ANSI/AWWA C110/A21.10 for Full Body Ductile Iron Push-On Fittings for water and other liquids.
- INSTALLATION:**
 - Per ANSI/AWWA C600 and C111 using DIP conforming to C150/C151 and PVC pipe conforming to C900/C905.

TABLE OF CONTENTS



INDEX**BENDS**

90° Bends	5
45° Bends	5
22 1/2° Bends	5
11 1/4° Bends	5
Adapters (PO X Flange)	9

TEES	6
-------------------	---

Caps	7
------------	---

Plugs	7
-------------	---

CROSSES	7
----------------------	---

Tees (PO X Flange)	8
--------------------------	---

Gaskets	8
---------------	---

REDUCERS	9
-----------------------	---



C110 Push On Joint Fittings

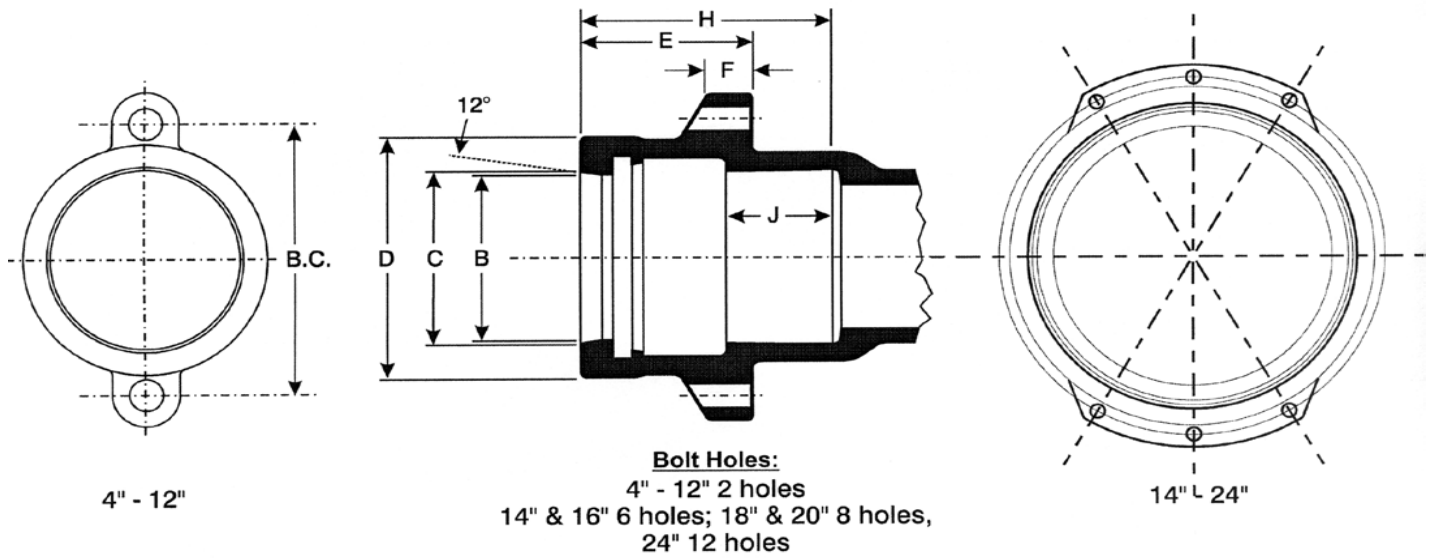

Bell Specifications for C110 Full Body Cast Iron/Ductile Iron Push On Fittings

Size	B	D	B.C.	H	J	E	F
4	4.90	7.08	8.00	4.00	1.72	2.58	1.25
6	7.00	9.28	10.16	4.00	1.72	2.40	1.25
8	9.15	11.85	12.56	4.50	1.86	3.00	1.25
10	11.20	13.68	14.94	4.50	2.06	2.88	1.25
12	13.30	16.06	17.16	5.00	2.36	3.25	1.25
14	15.44	19.75	18.75	5.00	2.48	3.50	1.25
16	17.54	20.14	23.88	6.00	2.98	3.50	1.25
18	19.64	23.75	25.00	6.00	3.50	3.50	1.25
20	21.74	26.00	27.25	6.00	3.80	3.75	1.25
24	25.94	30.50	32.00	6.00	3.80	3.75	1.25

Dimensions in inches
 Weights in pounds



90° Bends

Diameter	Part No.	A	R	T	Weight
4	XPB490	6.5	4.50	.52	57
6	XPB690	8.0	6.00	.55	92
8	XPB890	9.0	7.00	.60	148
10	XPB1090	11.0	9.00	.68	227
12	XPB1290	12.0	10.00	.75	282
14	XPB1490	14.0	11.50	.66	495
16	XPB1690	15.0	12.50	.70	552
18	XPB1890	16.5	14.00	.75	790
20	XPB2090	18.0	15.50	.80	1,035
24	XPB2490	22.0	18.50	.89	1,690

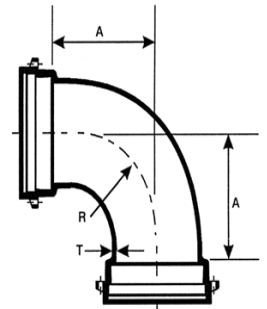

PO x PO Bend 90°

45° Bends

Diameter	Part No.	A	R	T	Weight
4	XPB445	4.0	4.81	.52	55
6	XPB645	5.0	7.25	.55	86
8	XPB845	5.5	8.44	.60	135
10	XPB1045	6.5	10.88	.68	187
12	XPB1245	7.5	13.25	.75	267
14	XPB1445	7.5	12.06	.66	400
16	XPB1645	8.0	13.25	.70	443
18	XPB1845	8.5	14.50	.75	625
20	XPB2045	9.5	16.88	.80	765
24	XPB2445	11.0	18.12	.89	1,180

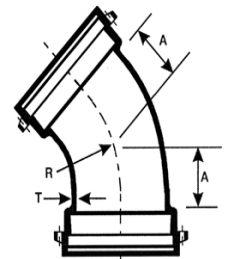

PO x PO Bend 45°

22-1/2° Bends

Diameter	Part No.	A	R	T	Weight
4	XPB422	4.0	10.06	.52	61
6	XPB622	5.0	15.06	.55	90
8	XPB822	5.5	17.62	.60	136
10	XPB1022	6.5	22.62	.68	175
12	XPB1222	7.5	27.62	.75	265
14	XPB1422	7.5	25.12	.66	400
16	XPB1622	8.0	27.62	.70	427
18	XPB1822	8.5	30.19	.75	625
20	XPB2022	9.5	35.19	.80	765
24	XPB2422	11.0	37.69	.89	1,180

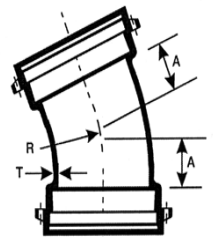

PO x PO Bend 22-1/2°

11-1/4° Bends

Diameter	Part No.	A	R	T	Weight
4	XPB411	4.0	20.31	.52	57
6	XPB611	5.0	30.50	.55	85
8	XPB811	5.5	35.50	.60	135
10	XPB1011	6.5	45.69	.68	177
12	XPB1211	7.5	55.81	.75	259
14	XPB1411	7.5	50.75	.66	400
16	XPB1611	8.0	55.81	.70	454
18	XPB1811	8.5	60.94	.75	625
20	XPB2011	9.5	71.06	.80	765
24	XPB2411	11.0	76.12	.89	1,180

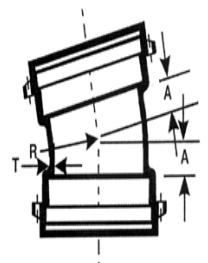

PO x PO Bend 11-1/4°



Dimensions in inches
Weights in pounds

C110 Push On Joint Fittings

Tees

Run	Br	Item No.		H	J	T	T1	Approx. Weight
		CI	DI					
4	4	CPT44	XPT44	6.50	6.50	.52	.52	88
6	4	CPT64	XPT64	8.00	8.00	.55	.52	136
6	6	CPT66	XPT64	8.00	8.00	.55	.55	142
8	4	CPT84	XPT84	9.00	9.00	.60	.52	190
8	6	CPT86	XPT86	9.00	9.00	.60	.55	196
8	8	CPT88	XPT88	9.00	9.00	.60	.60	213
10	4	CPT104	XPT104	11.00	11.00	.68	.52	298
10	6	CPT106	XPT106	11.00	11.00	.68	.55	275
10	8	CPT108	XPT108	11.00	11.00	.68	.60	302
10	10	CPT1010	XPT1010	11.00	11.00	.80	.80	327
12	4	CPT124	XPT124	12.00	12.00	.75	.52	380
12	6	CPT126	XPT126	12.00	12.00	.75	.55	379
12	8	CPT128	XPT128	12.00	12.00	.75	.60	392
12	10	CPT1210	XPT1210	12.00	12.00	.87	.80	452
12	12	CPT1212	XPT1212	12.00	12.00	.87	.87	474
14	6	CPT146	XPT146	14.00	14.00	.66	.55	602
14	8	CPT148	XPT148	14.00	14.00	.66	.60	618
14	10	CPT1410	XPT1410	14.00	14.00	.66	.68	620
14	12	CPT1412	XPT1412	14.00	14.00	.82	.75	625
14	14	CPT1414	XPT1414	14.00	14.00	.82	.82	784
16	6	CPT166	XPT166	15.00	15.00	.70	.55	639
16	8	CPT168	XPT168	15.00	15.00	.70	.60	633
16	10	CPT1610	XPT1610	15.00	15.00	.70	.68	688
16	12	CPT1612	XPT1612	15.00	15.00	.70	.75	679
16	14	CPT1614	XPT1614	15.00	15.00	.89	.82	888
16	16	CPT1616	XPT1616	15.00	15.00	.89	.89	849
18	6	CPT186	XPT186	13.00	15.50	.75	.55	836
18	8	CPT188	XPT188	13.00	15.50	.75	.60	840
18	10	CPT1810	XPT1810	13.00	15.50	.75	.68	860
18	12	CPT1812	XPT1812	13.00	15.50	.75	.75	888
18	14	CPT1814	XPT1814	16.50	16.50	.75	.66	1,100
18	16	CPT1816	XPT1816	16.50	16.50	.96	.89	1,125
18	18	CPT1818	XPT1818	16.50	16.50	.96	.96	1,145
20	6	CPT206	XPT206	14.00	17.00	.80	.55	1,020
20	8	CPT208	XPT208	14.00	17.00	.80	.60	1,030
20	10	CPT2010	XPT2010	14.00	17.00	.80	.68	1,050
20	12	CPT2012	XPT2012	14.00	17.00	.80	.75	1,070
20	14	CPT2014	XPT2014	14.00	17.00	.80	.66	1,105
20	16	CPT2016	XPT2016	18.00	18.00	.80	.70	1,365
20	18	CPT2018	XPT2018	18.00	18.00	1.03	.96	1,380
20	20	CPT2020	XPT2020	18.00	18.00	1.03	1.03	1,440
24	6	CPT246	XPT246	15.00	19.00	.89	.55	1,240
24	8	CPT248	XPT248	15.00	19.00	.89	.60	1,270
24	10	CPT2410	XPT2410	15.00	19.00	.89	.68	1,300
24	12	CPT2412	XPT2412	15.00	19.00	.89	.75	1,330
24	14	CPT2414	XPT2414	15.00	19.00	.89	.66	1,360
24	16	CPT2416	XPT2416	15.00	19.00	.89	.70	1,450
24	18	CPT2418	XPT2418	22.00	22.00	.89	.75	1,915
24	20	CPT2420	XPT2420	22.00	22.00	1.16	1.03	1,950
24	24	CPT2424	XPT2424	22.00	22.00	1.16	1.16	2,250

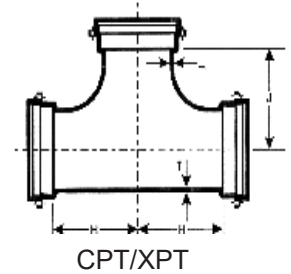

Full Body Cast Iron and Ductile Iron Push-On Caps

Cap Size	Cast Iron		Ductile Iron		T	Approx. Weight
	Dished Item No.	Tapped Item No.	Dished Item No.	Tapped Item No.		
4	CPK4	CPTK4	XPK4	XPTK4	.60	25
6	CPK6	CPTK6	XPK6	XPTK6	.65	41
8	CPK8	CPTK8	XPK8	XPTK8	.70	67
10	CPK10	CPTK10	XPK10	XPTK10	.75	85
12	CPK12	CPTK12	XPK12	XPTK12	.75	115
14	CPK14	CPTK14	XPK14	XPTK14	1.00	186
16	CPK16	CPTK16	XPK16	XPTK16	1.11	255
18	CPK18	CPTK18	XPK18	XPTK18	1.25	301
20	CPK20	CPTK20	XPK20	XPTK20	1.40	330
24	CPK24	CPTK24	XPK24	XPTK24	1.50	500

Dimensions in inches
Weights in pounds



Full Body Cast Iron and Ductile Iron Push-On Plugs

Plug Size	Cast Iron		Ductile Iron		T	Approx. Weight
	Dished Item No.	Tapped Item No.	Dished Item No.	Tapped Item No.		
4	CPP4	CPTP4	XPP4	XPTP4	.60	17
6	CPP6	CPTP6	XPP6	XPTP6	.65	32
8	CPP8	CPTP8	XPP8	XPTP8	.70	48
10	CPP10	CPTP10	XPP10	XPTP10	.75	68
12	CPP12	CPTP12	XPP12	XPTP12	.75	86
14	CPP14	CPTP14	XPP14	XPTP14	1.00	130
16	CPP16	CPTP16	XPP16	XPTP16	1.11	167
18	CPP18	CPTP18	XPP18	XPTP18	1.25	245
20	CPP20	CPTP20	XPP20	XPTP20	1.40	275
24	CPP24	CPTP24	XPP24	XPTP24	1.50	400

Crosses

Run	Branch	Item Number		H	J	T	T1	Weight
		CI	DI					
4	4	CPC44	XPC44	6.50	6.50	.52	.52	109
6	4	CPC64	XPC64	8.00	8.00	.55	.52	150
6	6	CPC66	XPC66	8.00	8.00	.55	.55	172
8	4	CPC84	XPC84	9.00	9.00	.60	.52	214
8	6	CPC86	XPC86	9.00	9.00	.60	.55	250
8	8	CPC88	XPC88	9.00	9.00	.60	.60	263
10	4	CPC104	XPC104	11.00	11.00	.68	.52	314
10	6	CPC106	XPC106	11.00	11.00	.68	.55	294
10	8	CPC108	XPC108	11.00	11.00	.68	.60	326
10	10	CPC1010	XPC1010	11.00	11.00	.80	.80	353
12	4	CPC124	XPC124	12.00	12.00	.75	.52	405
12	6	CPC126	XPC126	12.00	12.00	.75	.55	405
12	8	CPC128	XPC128	12.00	12.00	.75	.60	442
12	10	CPC1210	XPC1210	12.00	12.00	.87	.80	522
12	12	CPC1212	XPC1212	12.00	12.00	.87	.87	558
14	6	CPC146	XPC146	14.00	14.00	.66	.55	630
14	8	CPC148	XPC148	14.00	14.00	.66	.60	671
14	10	CPC1410	XPC1410	14.00	14.00	.66	.68	695
14	12	CPC1412	XPC1412	14.00	14.00	.82	.75	750
14	14	CPC1414	XPC1414	14.00	14.00	.82	.82	860
16	6	CPC166	XPC166	15.00	15.00	.70	.55	790
16	8	CPC168	XPC168	15.00	15.00	.70	.60	835
16	10	CPC1610	XPC1610	15.00	15.00	.70	.68	900
16	12	CPC1612	XPC1612	15.00	15.00	.70	.75	807
16	14	CPC1614	XPC1614	15.00	15.00	.89	.82	1060
16	16	CPC1616	XPC1616	15.00	15.00	.89	.89	981
18	6	CPC186	XPC186	13.00	15.50	.75	.55	845
18	8	CPC188	XPC188	13.00	15.50	.75	.60	880
18	10	CPC1810	XPC1810	13.00	15.50	.75	.68	940
18	12	CPC1812	XPC1812	13.00	15.50	.75	.75	1,065
18	14	CPC1814	XPC1814	16.50	16.50	.75	.66	1,200
18	16	CPC1816	XPC1816	16.50	16.50	.96	.89	1,370
18	18	CPC1818	XPC1818	16.50	16.50	.96	.96	1,400
20	6	CPC206	XPC206	14.00	17.00	.80	.55	1,100
20	8	CPC208	XPC208	14.00	17.00	.80	.60	1,150
20	10	CPC2010	XPC2010	14.00	17.00	.80	.68	1,180
20	12	CPC2012	XPC2012	14.00	17.00	.80	.75	1,200
20	14	CPC2014	XPC2014	14.00	17.00	.80	.66	1,250
20	16	CPC2016	XPC2016	18.00	18.00	.80	.70	1,620
20	18	CPC2018	XPC2018	18.00	18.00	1.03	.96	1,700
20	20	CPC2020	XPC2020	18.00	18.00	1.03	1.03	1,900
24	6	CPC246	XPC246	15.00	19.00	.89	.55	1,320
24	8	CPC248	XPC248	15.00	19.00	.89	.60	1,350
24	10	CPC2410	XPC2410	15.00	19.00	.89	.68	1,390
24	12	CPC2412	XPC2412	15.00	19.00	.89	.75	1,420
24	14	CPC2414	XPC2414	15.00	19.00	.89	.66	1,470
24	16	CPC2416	XPC2416	15.00	19.00	.89	.70	1,670
24	18	CPC2418	XPC2418	22.00	22.00	.89	.75	2,200
24	20	CPC2420	XPC2420	22.00	22.00	1.16	1.03	2,350
24	24	CPC2424	XPC2424	22.00	22.00	1.16	1.16	2,500

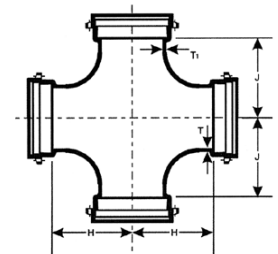

CPC/XPC



Dimensions in inches
Weights in pounds

C110 Push On Joint Fittings

Tees (PO x Flange)

Run	Branch	Item Number		H	J	T	T1	Weight
		CI	DI					
4	4	CPF44	XPF44	6.50	6.50	.52	13	88
6	4	CPF64	XPF64	8.00	8.00	.55	14	136
6	6	CPF66	XPF66	8.00	8.00	.55	14	130
8	4	CPF84	XPF84	9.00	9.00	.60	15	190
8	6	CPF86	XPF86	9.00	9.00	.60	15	186
8	8	CPF88	XPF88	9.00	9.00	.60	15	230
10	4	CPF104	XPF104	11.00	11.00	.68	17	298
10	6	CPF106	XPF106	11.00	11.00	.68	17	310
10	8	CPF108	XPF108	11.00	11.00	.68	17	327
10	10	CPF1010	XPF1010	11.00	11.00	.80	20	332
12	4	CPF124	XPF124	12.00	12.00	.75	19	380
12	6	CPF126	XPF126	12.00	12.00	.75	19	390
12	8	CPF128	XPF128	12.00	12.00	.75	19	412
12	10	CPF1210	XPF1210	12.00	12.00	.87	22	460
12	12	CPF1212	XPF1212	12.00	12.00	.87	22	495
14	6	CPF146	XPF146	14.00	14.00	.66	17	602
14	8	CPF148	XPF148	14.00	14.00	.66	17	618
14	10	CPF1410	XPF1410	14.00	14.00	.66	17	620
14	12	CPF1412	XPF1412	14.00	14.00	.82	21	625
14	14	CPF1414	XPF1414	14.00	14.00	.82	21	784
16	6	CPF166	XPF166	15.00	15.00	.70	18	752
16	8	CPF168	XPF168	15.00	15.00	.70	18	785
16	10	CPF1610	XPF1610	15.00	15.00	.70	18	795
16	12	CPF1612	XPF1612	15.00	15.00	.70	18	830
16	14	CPF1614	XPF1614	15.00	15.00	.89	23	888
16	16	CPF1616	XPF1616	15.00	15.00	.89	23	920
18	6	CPF186	XPF186	13.00	15.50	.75	19	836
18	8	CPF188	XPF188	13.00	15.50	.75	19	840
18	10	CPF1810	XPF1810	13.00	15.50	.75	19	862
18	12	CPF1812	XPF1812	13.00	15.50	.75	19	888
18	14	CPF1814	XPF1814	16.50	16.50	.75	19	1,100
18	16	CPF1816	XPF1816	16.50	16.50	.96	24	1,125
18	18	CPF1818	XPF1818	16.50	16.50	.96	24	1,145
20	6	CPF206	XPF206	14.00	17.00	.80	20	1,020
20	8	CPF208	XPF208	14.00	17.00	.80	20	1,029
20	10	CPF2010	XPF2010	14.00	17.00	.80	20	1,049
20	12	CPF2012	XPF2012	14.00	17.00	.80	20	1,070
20	14	CPF2014	XPF2014	14.00	17.00	.80	20	1,105
20	16	CPF2016	XPF2016	18.00	18.00	.80	20	1,365
20	18	CPF2018	XPF2018	18.00	18.00	1.03	26	1,380
20	20	CPF2020	XPF2020	18.00	18.00	1.03	26	1,440
24	6	CPF246	XPF246	15.00	19.00	.89	23	1,240
24	8	CPF248	XPF248	15.00	19.00	.89	23	1,270
24	10	CPF2410	XPF2410	15.00	19.00	.89	23	1,300
24	12	CPF2412	XPF2412	15.00	19.00	.89	23	1,330
24	14	CPF2414	XPF2414	15.00	19.00	.89	23	1,360
24	16	CPF2416	XPF2416	15.00	19.00	.89	23	1,450
24	18	CPF2418	XPF2418	22.00	22.00	.89	23	1,915
24	20	CPF2420	XPF2420	22.00	22.00	1.16	29	1,950
24	24	CPF2424	XPF2424	22.00	22.00	1.16	29	2,250

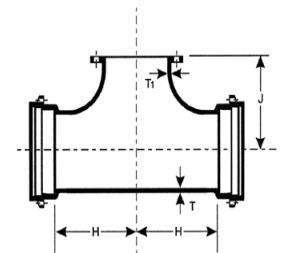

CPF/XPF

GASKETS for Full Body Cast Iron & Ductile Iron Push-On Fittings

Cap Size	Item No.	Approx Weight
4	PG4	.30
6	PG6	.50
8	PG8	.75
10	PG10	.80
12	PG12	1.00
14	PG14	1.30
16	PG16	1.45
18	PG18	
20	PG20	
24	PG24	

Dimensions in inches
Weights in pounds



Reducers

Size	Size	Item No.		L in.	T in.	T1 in.	Approx. Weight
		CI	DI				DI
6	4	CPR64	XPR64	9	.55	.52	60
8	4	CPR84	XPR84	11	.60	.52	80
8	6	CPR86	XPR86	11	.60	.55	105
10	4	CPRI04	XPR104	12	.68	.52	105
10	6	CPR106	XPR106	12	.68	.55	138
10	8	CPR108	XPR108	12	.68	.60	153
12	4	CPR124	XPR124	14	.75	.52	135
12	6	CPR126	XPR126	14	.75	.55	165
12	8	CPR128	XPR128	14	.75	.60	184
12	10	CPR1210	XPR1210	14	.75	.68	212
14	6	CPR146	XPR146	16	.66	.55	200
14	8	CPR148	XPR148	16	.66	.60	220
14	10	CPR1410	XPR1410	16	.66	.68	240
14	12	CPR1412	XPR1412	16	.66	.75	270
16	6	CPR166	XPR166	18	.70	.55	287
16	8	CPR168	XPR168	18	.70	.60	260
16	10	CPR1610	XPR1610	18	.70	.68	337
16	12	CPR1612	XPR1612	18	.70	.75	391
16	14	CPR1614	XPR1614	18	.70	.66	370
18	8	CPR188	XPR188	19	.75	.60	310
18	10	CPR1810	XPR1810	19	.75	.68	340
18	12	CPR1812	XPR1812	19	.75	.75	370
18	14	CPR1814	XPR1814	19	.75	.66	420
18	16	CPR1816	XPR1816	19	.75	.70	455
20	10	CPR2010	XPR2010	20	.80	.68	395
20	12	CPR2012	XPR2012	20	.80	.75	425
20	14	CPR2014	XPR2014	20	.80	.66	475
20	16	CPR2016	XPR2016	20	.80	.70	515
20	18	CPR2410	XPR2018	20	.80	.75	560
24	12	CPR2412	XPR2412	24	.89	.75	575
24	14	CPR2414	XPR2414	24	.89	.66	635
24	16	CPR2416	XPR2416	24	.89	.70	675
24	18	CPR2418	XPR2418	24	.89	.75	725
24	20	CPR2420	XPR2420	24	.89	.80	775

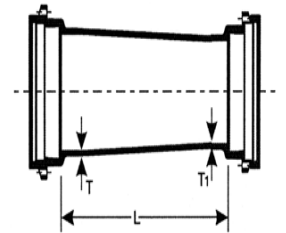

CPR/XPR

PO x Flange Adapters

Diameter	Item Number		L	T	Weight
	CI	DI			
4	CPFA4	XPFA4	8.0	.52	45
6	CPFA6	XPFA6	8.0	.55	60
8	CPFA8	XPFA8	8.0	.60	97
10	CPFA10	XPFA10	8.0	.68	128
12	CPFA12	XPFA12	8.0	.75	172
14	CPFA14	XPFA14	8.0	.66	275
16	CPFA16	XPFA16	8.0	.70	292
18	CPFA18	XPFA18	8.0	.75	385
20	CPFA20	XPFA20	8.0	.80	440
24	CPFA24	XPFA24	8.0	.89	700

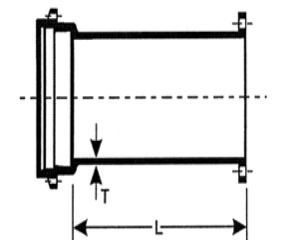

CPF/XPF



Dimensions in inches
Weights in pounds

C110 Push On Joint Fittings Non-Standard Items:

C110 Push On Joint Fittings Non-Standard Items:

Item No.	Description
•XPFF86	C110 DI 8" X 8" X 6" PO X FLG X FLG TEE
•XPFF88	C110 DI 8" X 8" X 8" PO X FLG X FLG TEE
•XPK10	C110 DI 10" PO CAP
•XPK12	C110 DI 12" PO CAP
•XPK4	C110 DI 4" PO CAP
•XPK6	C110 DI 6" PO CAP
•XPK8	C110 DI 8" PO CAP
•XPK12	C110 DI 12" PO CAP
•XPPS24	C110 DI 24" PO PLUG W/ SET SCREWS
•XPPS6	C110 DI 6" PO PLUG W/ SET SCREWS
•XPQ128	C110 DI 12" X 8" PO X PE OFFSET
•XPQ418	C110 DI 4" X 18" PO X PE OFFSET
•XPQ618	C110 DI 6" X 18" PO X PE OFFSET
•XPQ818	C110 DI 8" X 18" PO X PE OFFSET
•XPTK10	C110 DI 10" PO CAP (TAPPED)
•XPTK12	C110 DI 12" PO CAP (TAPPED)
•XPTK4	C110 DI 4" PO CAP (TAPPED)
•XPTK6	C110 DI 6" PO CAP (TAPPED)
•XPTK8	C110 DI 8" PO CAP (TAPPED)

Note: Contact SIGMA for more information on non-standard fittings



LOCATIONS

Northeast Region

Cream Ridge, New Jersey (HQ)

700 Goldman Drive
Cream Ridge, NJ 08514
Phone (800) 999-2550
Fax (609) 758-1158
crmcsr@sigmaco.com

REPCO

395 Boul. Labbé Nord
Victoriaville, Qc G6P 1B1
Phone (888) 744-6262
Fax (819) 758-1153
jboucher@repco.ca

Concord Supply

2353 Bowman Street
Innisfil, Ontario L9S 3V6
Phone (877) 436-3800
Fax (705) 436-6338
tanya@concordsupply.ca

Midwest Region

Sauk Village, Illinois

21699 Torrence Avenue
Sauk Village, IL 60411
Phone (888) 999-0420
Fax (708) 758-6790
chicsr@sigmaco.com

Southeast Region

Alexander City, Alabama

1500 Highway 22 W
Alexander City, AL 35010
Phone (800) 824-4513
Fax (256) 234-4956
alxcsr@sigmaco.com

Southwest Region

Houston, Texas

5000 Askins Lane
Houston, TX 77093
Phone (800) 999-0109
Fax (281) 987-0200
htncsr@sigmaco.com

Western Region

Ontario, California

4652 E. Guasti Road
Ontario, CA 91761
Phone (800) 688-6230
Fax (909) 391-2033
ontcsr@sigmaco.com

Auburn, Washington (Branch)

902 W Main Street
Auburn, WA 98001
Phone (800) 688-6230
Fax (909) 391-2033
ontcsr@sigmaco.com

www.sigmaco.com

Terms and Conditions of Sales available at our website.

AWWA Ductile Iron Fittings



- 2-64" C153 Ductile Iron Mechanical Joint Fittings
- 2-48" C110 Ductile Iron Mechanical Joint Fittings
- 2-64" C110 Ductile Iron Flanged Fittings
- 3-24" C153 Ductile Iron Push-On Fittings
- 4-24" C110 Ductile Iron Push-On Fittings
- 3-36" Ductile Iron Mechanical Joint Connector
- C116 Fusion Bonded Epoxy Lining Available
- PROTECTO 401® Ceramic Epoxy Lining Available

Visit our website for available special coatings. <http://www.sigmaco.com/fittings-coatings-linings/>

Mechanical Joint Accessories

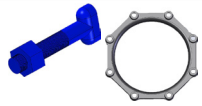

- Prepackaged and Loose Mechanical Joint Accessories
- SIGMASEAL™ Improved Mechanical Joint Gasket
- Snap-On Multi-Purpose Gasket for Ductile Iron or PVC Pressure Pipes
- OMNI-SLEEVE™ Improved Wall Penetration Sleeve
- Specialty Bolts and Nuts for Mechanical Joint Assemblies

ONE-LOK™ Wedge Action Restraints

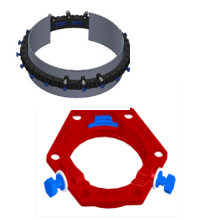

- 3-48" ONE-LOK D-SLDE Domestic Wedge Restraint for Ductile Iron Pipe
- 3-64" ONE-LOK SLDE Wedge Restraint for Ductile Iron Pipe (Import)
- 4-48" ONE-LOK T-SLDE Tandem Wedge Restraint for High Pressure Ductile Iron Pipe
- 3-36" ONE-LOK D-SLCE Domestic Wedge Restraint for PVC Pipe
- 3-12" ONE-LOK SLC Wedge Restraint for PVC Pipe (Import)
- 3-60" ONE-LOK SLCE Wedge Restraint for PVC Pipe (Import)
- 3-42" ONE-LOK SLDEH Wedge Harness Restraint for Ductile Iron Pipe
- 4-12" /16" /20" ONE-LOK SLDM Wedge Restraint for Oversized Cast Iron Pipe
- 4-36" ONE-LOK SSLD Split Wedge Restraint for Installed Ductile Iron Pipe & Fitting
- 4-36" ONE-LOK SSLDH Split Wedge Harness Restraint for Installed Ductile Iron Pipe
- 4-12" ONE-LOK SLCEH Wedge Harness Restraint for AWWA C900 PVC Pipe

Visit our website for available special coatings. <http://www.sigmaco.com/pipe-restraint-product-coatings-linings/>

PV-LOK™ Serration Lock Restraints

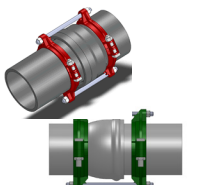

- 4-48" PV-LOK PWM Serrated Restraint for Ductile Iron Fitting & AWWA C900/905 PVC Pipe
- 4-48" PV-LOK PWP Serrated Bell Joint Restraint for AWWA C900/905 PVC Pipe
- 4-12" PV-LOK D-PWP Domestic Serrated Bell Joint Restraint for AWWA C900 PVC Pipe
- 4-12" PV-LOK PVPF Restraint for AWWA C900/905 PVC Pipe & PVC Fitting
- 4-12" PV-LOK PWH Serrated Harness Restraint for AWWA C900 PVC Pipe
- 2-12" PV-LOK PVM Serrated Restraint for Ductile Iron & IPS OD PVC pipe
- 2-12" PV-LOK PVP Serrated Bell Joint Restraint for IPS OD PVC Pipe
- 4-8" PV-LOK PVPF Serrated Restraint for IPS OD PVC Pipe & PVC Fitting
- 4-12" PV-LOK PWP Serrated Bell Joint Restraint for Ductile Iron Pipe

Visit our website for available special coatings. <http://www.sigmaco.com/pipe-restraint-product-coatings-linings/>

HDPE (Raven) Products



- Rotational Molded Meter Boxes & Pits
- Optional White Interior Available
- Light & Medium Duty Load Capacities
- Extensive Nationwide Inventory
- Rotational Molded Oil-Water Separators
- OEM Service Available

Municipal Construction Castings



- Manhole Rings and Covers
- Curb and Meter Boxes
- Frames and Grates
- Storm Inlets
- Valve Boxes, Risers, and Extensions

Products for the Ductile Iron Fabricator



- 3-64" High Hub Threaded Flanges
- 3-48" Tapped High Hub Threaded Flanges
- 3-36" Extra Heavy 250lb Drilled Threaded Flanges
- 3-48" Threaded MJ Bell Adapters
- 3-48" MJ x PE Bell adapter
- 3-48" Anchor Flanges
- 3-16" Filler Flanges

Extended Range Products



- Flange-Pak™ Prepackaged Flange Accessory Sets
- Polyethylene Encasement for Ductile Iron Pipe
- Copper Tubing Products
- Tracer Wire & Detectable/Non-Detectable Marking Tape
- Pipe Joint Lubricant & Hydraulic Cement
- Socket Clamps and Tie Rod Accessories
- Boxlok Valve Box Alignment Device
- Cast Iron Companion Flanges

Flange Adapters

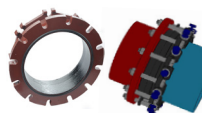

- 3-36" SIGMAFLANGE Flange Adapter Sleeve for PVC and Ductile Iron Pipe
- 2-48" ZIP FLANGE Set Screw Style Flange Adapter
- 3-12" SIGMAFLANGE Universal Joint for Flanged Fittings, Flanged Pipes & Valves