

HVH250-090S-IPM-OC Motor Specifications

Rating Conditions

Max coolant inlet temp 90 C
Min coolant flow rate 8 l/m
Min peak operating time 30 sec

Bus voltage Up to 700VDC
Weight cartridge only ~35 kG
Weight with housing ~50 kG
Rotating mass 0.054kG-M²
Cooling media Dexron VI
Maximum current 300 Arms

The torque and power ratings are based on specific operating conditions. There are several variables that may change the performance and the motor must be evaluated in its final application to determine the actual performance. All specifications are subject to change.

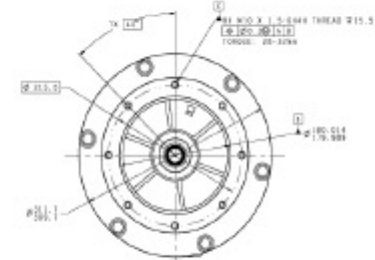
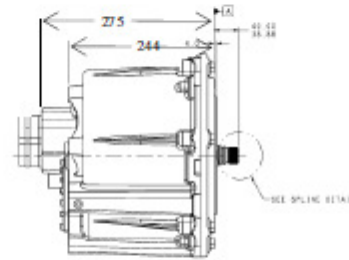
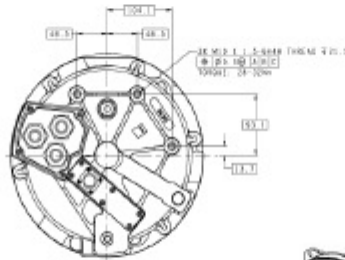

Cartridge

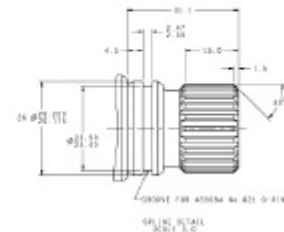

INVOLUTE SPLINE DATA
FILLET ROOT SIDE FIT
NUMBER OF TEETH.....24
MODULE.....1.850
PRESSURE ANGLE.....20.00°
PITCH DIAMETER (REF).....24.000

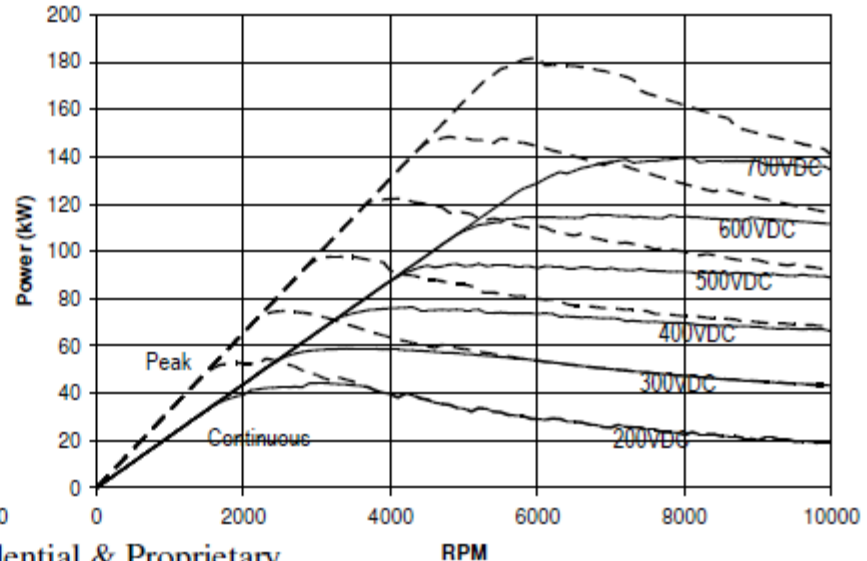
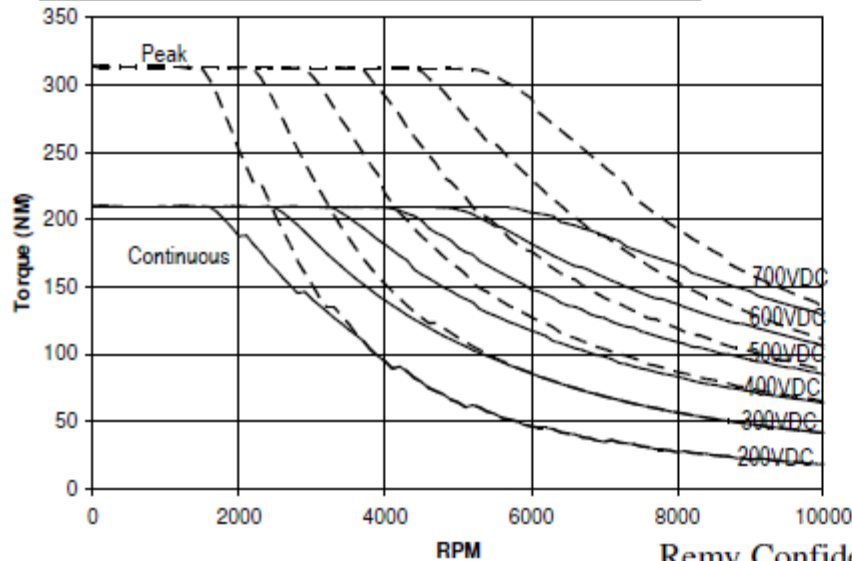

Remy Confidential & Proprietary
HVH250 Specifications 101008

Preliminary

Remy

HVH250-090P-IPM-OC Motor Specifications

Rating Conditions

Max coolant inlet temp 90 C
 Min coolant flow rate 8 l/m
 Min peak operating time 30 sec

Bus voltage Up to 700VDC
 Weight cartridge only ~35 kG
 Weight with housing ~50 kG
 Rotating mass 0.054kG-M^2
 Cooling media Dexron VI
 Maximum current 600 Arms

The torque and power ratings are based on specific operating conditions. There are several variables that may change the performance and the motor must be evaluated in its final application to determine the actual performance. All specifications are subject to change.

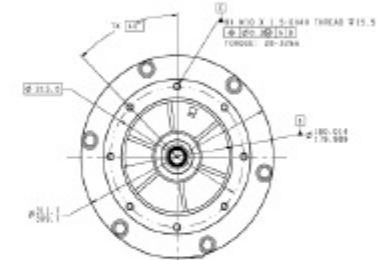
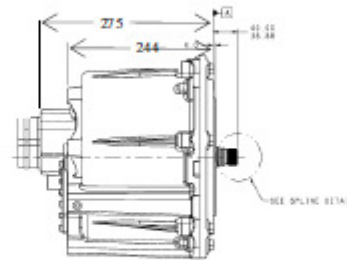
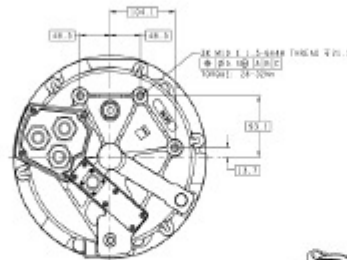

Cartridge

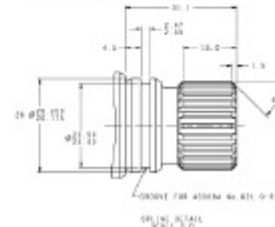

INVOLUTE SPLINE DATA
 FILLET ROOT SIDE FIT
 NUMBER OF TEETH 24
 MODULE 1.500
 PRESSURE ANGLE 20.0°
 PITCH DIAMETER (REF) 24.000

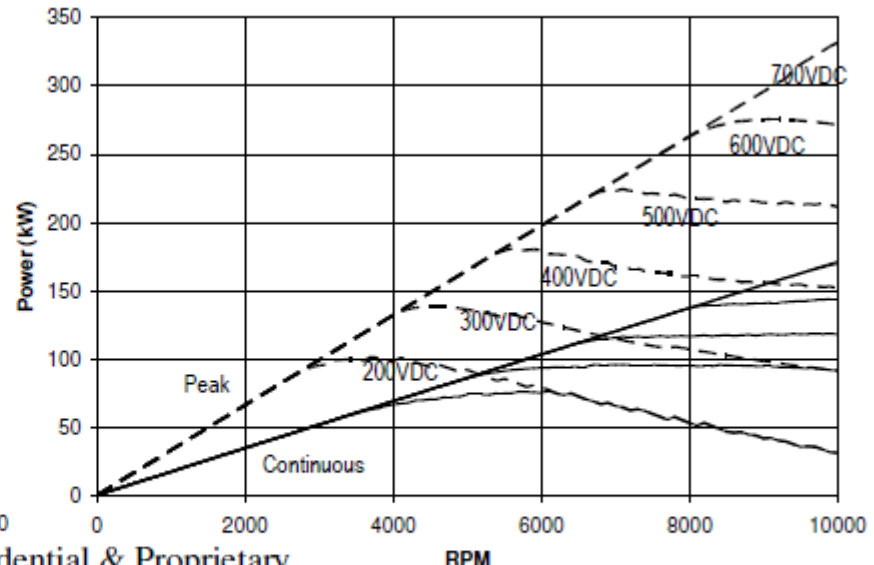
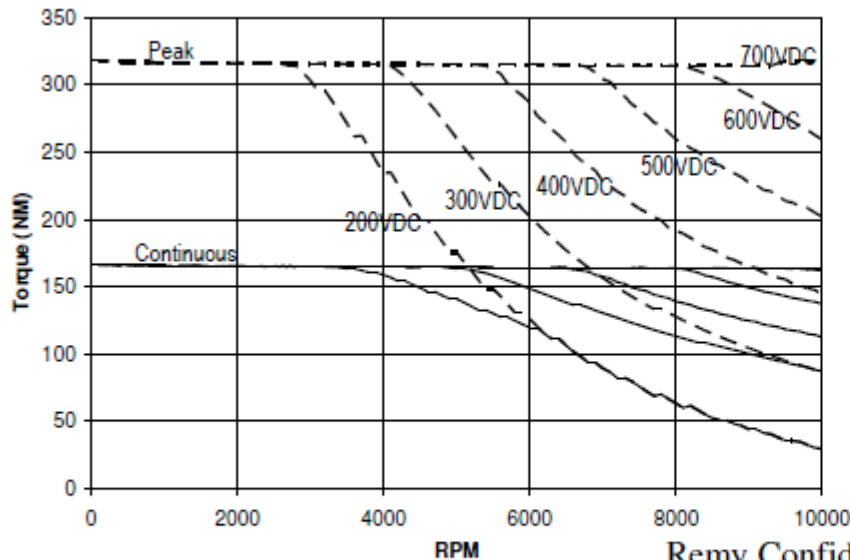

Remy Confidential & Proprietary
 HVH250 Specifications 101008

Preliminary

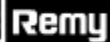

HVH250-115S-IPM-OC Motor Specifications

Rating Conditions

Max coolant inlet temp 90 C
Min coolant flow rate 8 l/m
Min peak operating time 30 sec

Bus voltage Up to 700VDC
Weight cartridge only ~42 kG
Weight with housing ~57 kG
Rotating mass 0.069kG-M²
Cooling media Dexron VI
Maximum current 300 Arms

The torque and power ratings are based on specific operating conditions. There are several variables that may change the performance and the motor must be evaluated in its final application to determine the actual performance. All specifications are subject to change.

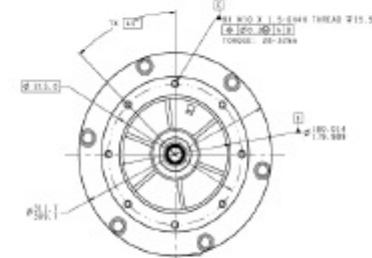
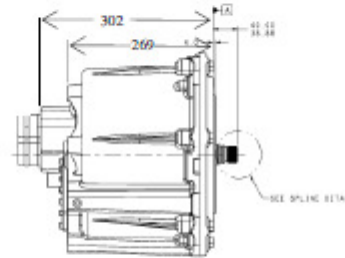
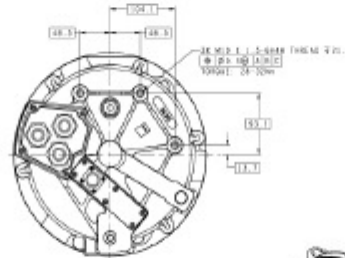

Cartridge

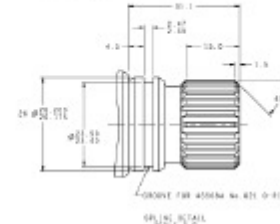

INVOLUTE SPLINE DATA
FILLET ROOT SIDE FIT
NUMBER OF TEETH 24
MODULE 1.850
PITCH DIAMETER (REF) 24.000

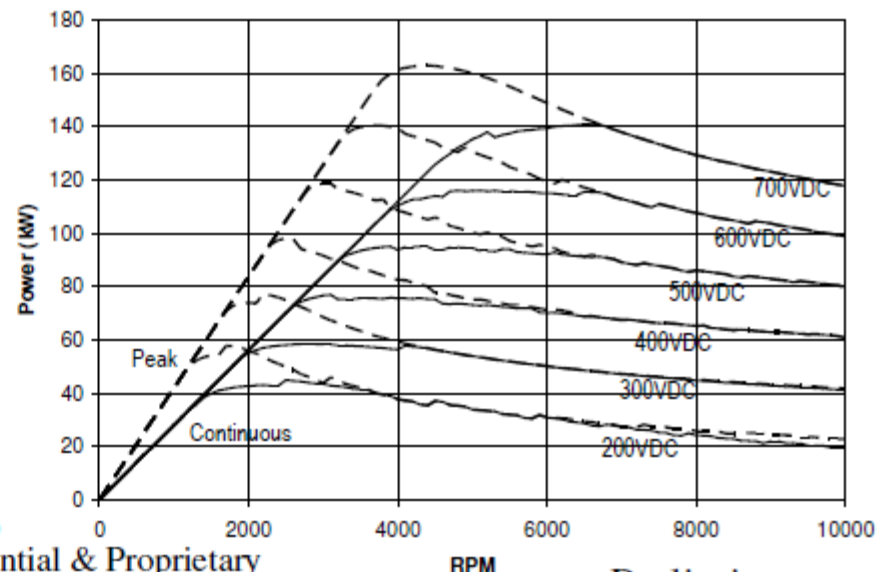
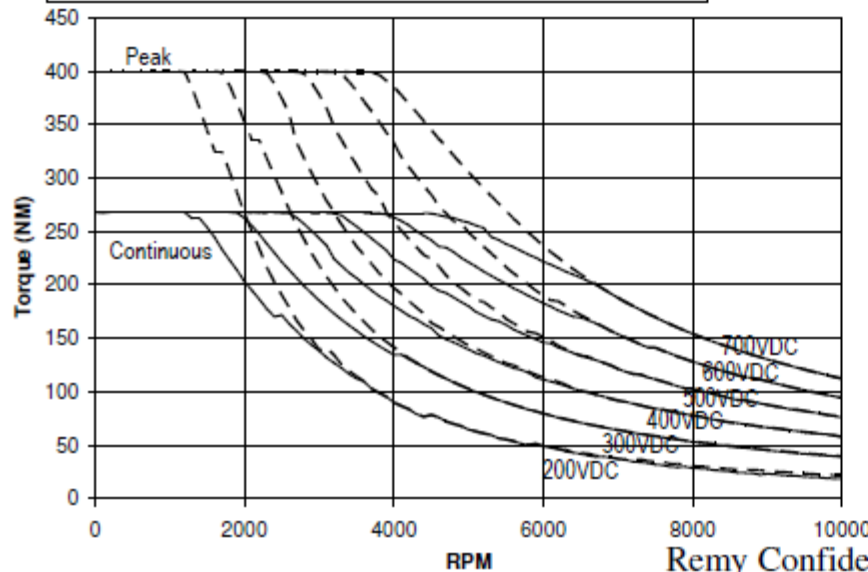

Remy Confidential & Proprietary
HVH250 Specifications 101008

RPM

Preliminary



HVH250-115P-IPM-OC Motor Specifications

Rating Conditions

Max coolant inlet temp 90 C
Min coolant flow rate 8 l/m
Min peak operating time 30 sec

Bus voltage Up to 700VDC
Weight cartridge only ~42 kG
Weight with housing ~57 kG
Rotating mass 0.069kG-M²
Cooling media Dexron VI
Maximum current 600 Arms

The torque and power ratings are based on specific operating conditions. There are several variables that may change the performance and the motor must be evaluated in its final application to determine the actual performance. All specifications are subject to change.

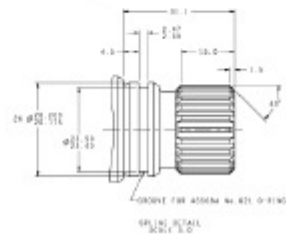
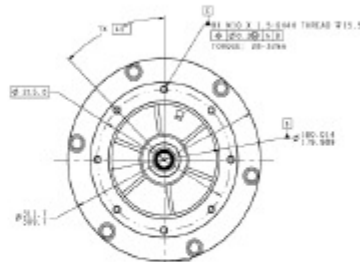
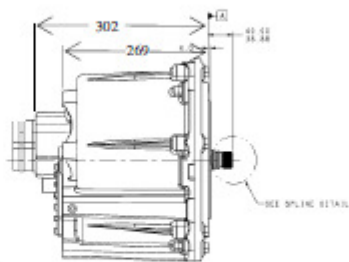
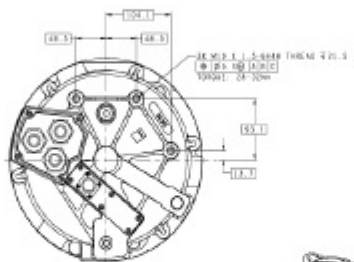

INVOLUTE SPLINE DATA
FILLET ROOT SIDE F11
NUMBER OF TEETH.....24
MODULE.....1.850
PITCH DIAMETER (REF).....24.600

Cartridge

