

# A

**1 BEDROOM + DEN, 1 BATH**  
 INTERIOR 603 - 607 SQ FT  
 EXTERIOR 62 - 75 SQ FT

**VUE6**  
 Pursuit of Higher Living



In our continuing effort to improve and maintain the high standard of the VUE6 development, the developer reserves the right to modify or change plans, specifications, features and prices without notice. Materials may be substituted with equivalent or better at the developer's sole discretion. All dimensions and sizes are approximate and are based on architectural measurements. As reverse and/or mirrored plans occur throughout the development, please see architectural plans. Please refer to the disclosure statement for specific offering details. Marketing + Sales powered by Amanti Marketing Group. E.&O.E. Privacy Policy.

**TERRASPHERE**

B

2 BEDROOM + DEN, 2 BATH  
INTERIOR 956 SQ FT  
EXTERIOR 71 SQ FT

VUE6  
Pursuit of Higher Living

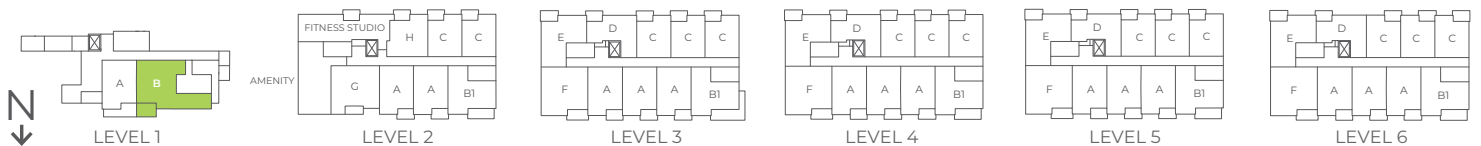

In our continuing effort to improve and maintain the high standard of the VUE6 development, the developer reserves the right to modify or change plans, specifications, features and prices without notice. Materials may be substituted with equivalent or better at the developer's sole discretion. All dimensions and sizes are approximate and are based on architectural measurements. As reverse and/or mirrored plans occur throughout the development, please see architectural plans. Please refer to the disclosure statement for specific offering details. Marketing + Sales powered by Amanti Marketing Group. E.&O.E. Privacy Policy.

TERRASPHERE

# B1

**1 BEDROOM + DEN, 1 BATH**  
 INTERIOR 684 SQ FT  
 EXTERIOR 100 - 168 SQ FT

# VUE6

Pursuit of Higher Living



C

**1 BEDROOM + DEN, 1 BATH**  
 INTERIOR 518 - 522 SQ FT  
 EXTERIOR 62 SQ FT

**VUE6**  
 Pursuit of Higher Living

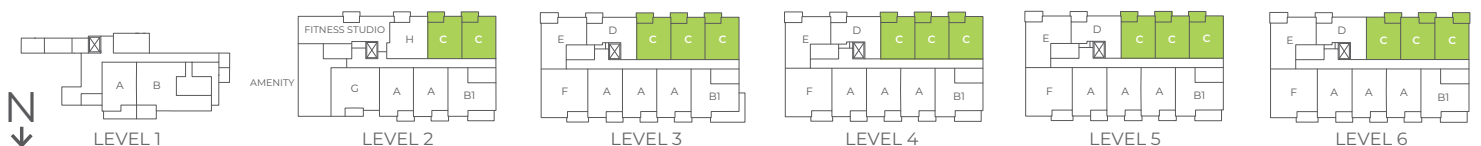

In our continuing effort to improve and maintain the high standard of the VUE6 development, the developer reserves the right to modify or change plans, specifications, features and prices without notice. Materials may be substituted with equivalent or better at the developer's sole discretion. All dimensions and sizes are approximate and are based on architectural measurements. As reverse and/or mirrored plans occur throughout the development, please see architectural plans. Please refer to the disclosure statement for specific offering details. Marketing + Sales powered by Amanti Marketing Group. E.&O.E. Privacy Policy.

**TERRASPHERE**

# D

**1 BEDROOM, 1 BATH**  
 INTERIOR 577 SQ FT  
 EXTERIOR 61 SQ FT

**VUE6**  
 Pursuit of Higher Living

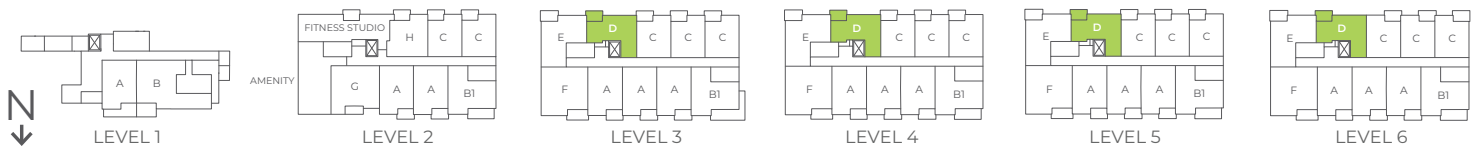

In our continuing effort to improve and maintain the high standard of the VUE6 development, the developer reserves the right to modify or change plans, specifications, features and prices without notice. Materials may be substituted with equivalent or better at the developer's sole discretion. All dimensions and sizes are approximate and are based on architectural measurements. As reverse and/or mirrored plans occur throughout the development, please see architectural plans. Please refer to the disclosure statement for specific offering details. Marketing + Sales powered by Amanti Marketing Group. E.&O.E. Privacy Policy.

**TERRASPHERE**

# E

**1 BEDROOM, 1 BATH**  
 INTERIOR 683 SQ FT  
 EXTERIOR 65 SQ FT

**VUE6**  
 Pursuit of Higher Living

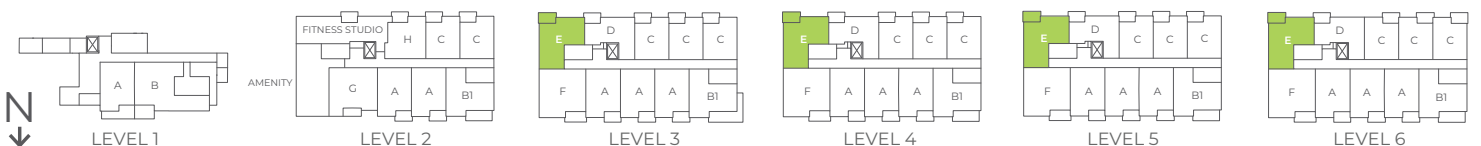

In our continuing effort to improve and maintain the high standard of the VUE6 development, the developer reserves the right to modify or change plans, specifications, features and prices without notice. Materials may be substituted with equivalent or better at the developer's sole discretion. All dimensions and sizes are approximate and are based on architectural measurements. As reverse and/or mirrored plans occur throughout the development, please see architectural plans. Please refer to the disclosure statement for specific offering details. Marketing + Sales powered by Amanti Marketing Group. E.&O.E. Privacy Policy.

**TERRASPHERE**

F

**2 BEDROOM, 2 BATH**  
 INTERIOR 824 SQ FT  
 EXTERIOR 79 SQ FT

**VUE6**  
 Pursuit of Higher Living

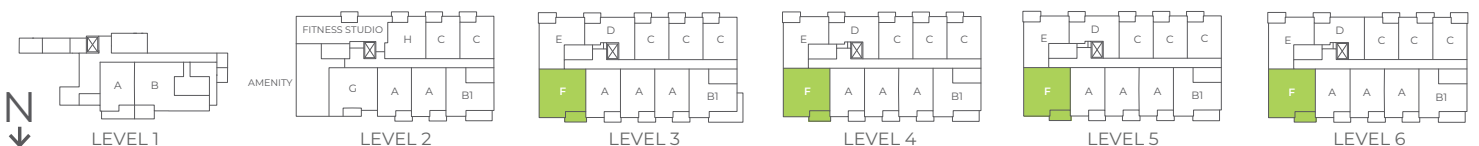



**2 BEDROOM + DEN, 2 BATH**  
 INTERIOR 805 SQ FT  
 EXTERIOR 56 SQ FT

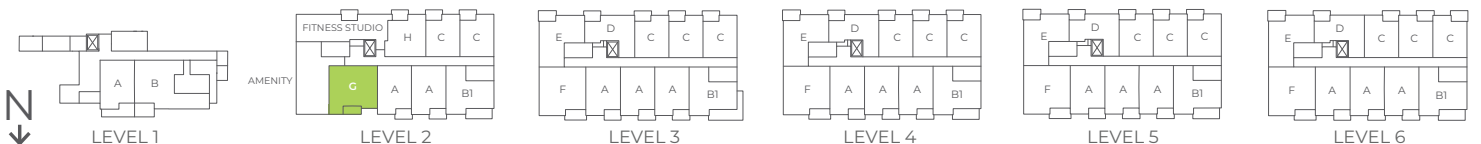





**1 BEDROOM + DEN, 1 BATH**  
INTERIOR 599 SQ FT  
EXTERIOR 61 SQ FT

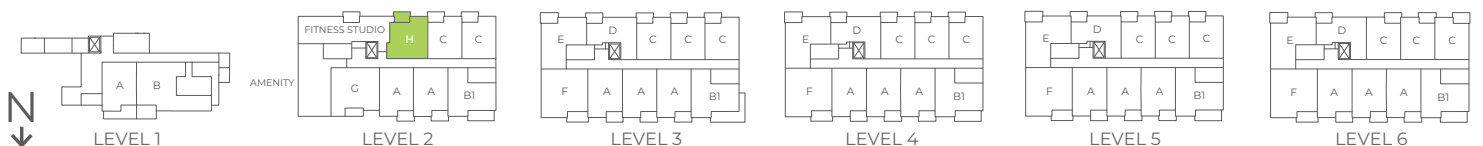

In our continuing effort to improve and maintain the high standard of the VUE6 development, the developer reserves the right to modify or change plans, specifications, features and prices without notice. Materials may be substituted with equivalent or better at the developer's sole discretion. All dimensions and sizes are approximate and are based on architectural measurements. As reverse and/or mirrored plans occur throughout the development, please see architectural plans. Please refer to the disclosure statement for specific offering details. Marketing + Sales powered by Amanti Marketing Group. E.&O.E. Privacy Policy.

