

SHLF User Guide

English

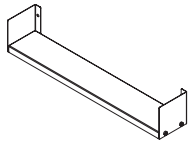

SHLF 1 S 55
55 x 10 x 10 cm
0,9kg
2 x mount holes
Max load: 5kg

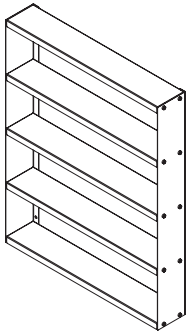

SHLF 5 S 55
55 x 10 x 70 cm
4,5kg
4 x mount holes
Max load: 10kg

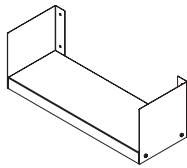

SHLF 1 55
55 x 20 x 20 cm
2,1kg
4 x mount holes
Max load: 10kg

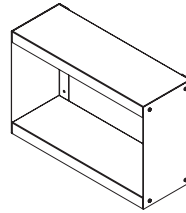

SHLF 2 55
55 x 20 x 37 cm
4,1kg
4 x mount holes
Max load: 10kg

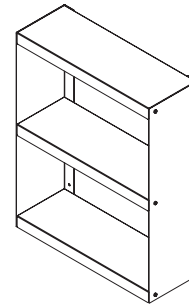

SHLF 3 55
55 x 20 x 70 cm
6,7kg
4 x mount holes
Max load: 15kg

SHLF:

SHLF is a Danish-produced simple steel shelf and a multifunctional furniture collection with contemporary elements. SHLF is a hybrid in any space, any home, and any project, allowing the user to construct and observe the possibilities of combinations and the wish for visual heftiness. The pieces have the potential to become their own individual wall sculpture when build up. the raw stainless steel shelves are designed to integrate into any space—as kitchen modules, office storage, or a full-wall bookshelf. SHLF is made of smooth brushed stainless steel, and the elements are assembled with visible bolts. The shelves are designed to be flipped, offering flexibility to transform and function as shelf-trays. Focused on a locally produced collection, SHLF is designed with simplicity, both within the product and the production process.

Material:

The SHLF collection is made of raw, untreated stainless steel, known for its exceptional durability, strength, and resistance to corrosion. The surface of the collection is naturally smooth, featuring a brushed finish that resists oxidants, rust, and most environmental conditions. Unlike other metals, stainless steel does not develop surface oxidation over time, maintaining its appearance with minimal maintenance. Regular cleaning helps preserve its brushed finish and luster. Minor surface marks or variations are characteristic of the raw, untreated stainless steel material, enhancing its unique aesthetic. Please note that due to the material, some parts may have minor scratches from the production process. Additionally, there is a slight difference in appearance between the outer brushed surface and the inner surface.

Production:

The SHLF collection is locally produced in Denmark. The raw stainless steel collection has had all unnecessary production steps removed, focusing on a simple, non-chemical surface finish.

Wall type:

Carefully check your wall type before mounting the shelves. The included wall screws/rawl plugs are only suitable for brick and concrete walls. For walls made of other materials, use appropriate screws/rawl plugs.

Wall mount:

The SHLF collection is designed to be mounted in nearly infinite combinations, both vertically and horizontally. Each piece can be placed next to, on top of, or individually from each other, depending on the desired look and need. Use a spirit level or a laser when mounting the pieces for a precise setup.

Load information:

The load capacity is listed below each item at the top of this page and in the SHLF Assembly Manual. The load capacity is determined by the strength of the included screws/rawl plugs mounted into a brick/concrete wall. If the included screws/rawl plugs are replaced or if the wall is of another, weaker material, the maximum load capacity may change.

Safety information:

Please refer to the specifications, data, and safety information for each version in the SHLF Assembly Manual. Always follow the assembly, installation and maintenance instructions, or consult a professional if you have any doubts about hardware or installation.

Care:

Wipe with a wet cloth and neutral soap, and then wipe off excess water with a tea towel until dry. To remove hard stains, we recommend using mineral spirits or rubbing alcohol. Do not clean with chlorine or chlorine-based chemicals, as this will cause the surface to rust. It's also recommended to avoid fluorine, iodine, bromine, or chloride in cleaners. Other objects can cause rust on stainless steel.

SHLF Assembly Manual

SHLF 1 S 55

55 x 10 x 10 cm

0,9kg

2 x mount holes

Max load: 5kg

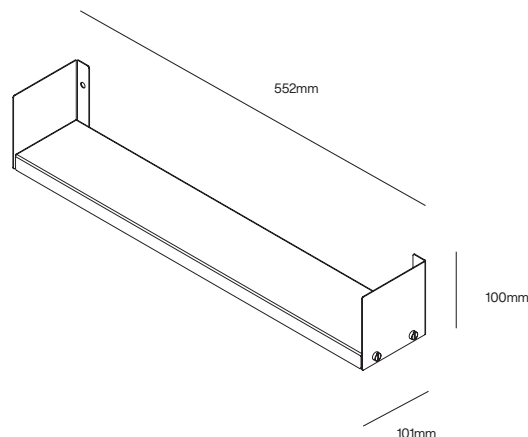

Attention:

Carefully check your wall type before mounting the shelf. The included wall screws/rawlplugs are only useful for brick and concrete walls. For walls made of other materials, use appropriate screws/rawlplugs of your own. If you have any doubts about your wall type, screws, or installation, always consult a professional.

Included assembly kit:

2 x side panels

1 x shelf

4 x bolt + nut (M6x10mm)

2 x brick/concrete wall screw (TX20) + rawlplug

Allen key *(Included if you have chosen the socket head/allen bolts for your SHLF)*

You will need:

10mm spanner

Flat head screwdriver *(Only if you have chosen hex bolts for your SHLF)*

Ø6 drill bit

Drilling machine

Laser or spirit level

Load Capacity:

Please note the maximum load capacity is 5 kg when evenly spread across the shelf. The weight capacity is determined by the strength of the included screws/rawlplugs.

Safety information:

Do not exceed the maximum weight capacity of 5kg. Ensure the shelf is securely mounted to the wall using appropriate screws and rawlplugs suitable for your wall type. Keep out of reach of children and do not allow climbing or any other activity on the shelf. Regularly check for loose screws or signs of wear and tighten immediately if necessary. Always follow the installation and maintenance instructions, or consult a professional if you have any doubts about hardware or installation.

Step 1:

Attach the two side panels to the shelf with the included bolts on both sides. Tighten the bolts to the nut using a flat-head screwdriver or hex/allen key and a spanner.

Note: Handle all parts of the shelf with care during assembly to avoid scratches and damage to the surface.

Step 2:

Use a spirit level or laser when measuring/marketing wall holes and aligning the shelf.

Drill two 45mm deep holes in the wall with a Ø6 drill bit and insert the rawlplugs. Then, use the included (or wall appropriate screws) screws to mount the shelf in the two top holes. Ensure the screws are securely fastened in the rawlplugs.

Note: Mount the top screws first and use your spirit level vertically to adjust the shelf.

Step 3:

Use a spirit level vertically on the shelf and adjust if needed.

Step 4:

Enjoy your SHLF!

SHLF Assembly Manual

Step 1:

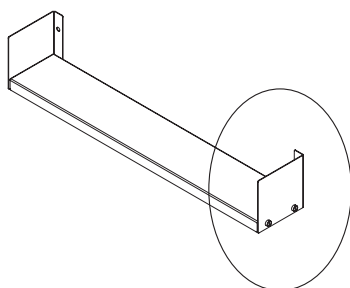

Step 2:



Step 3:

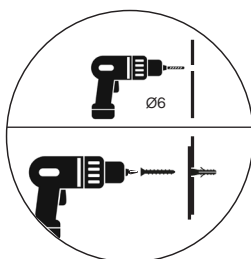
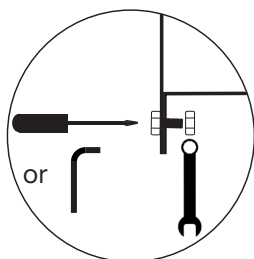
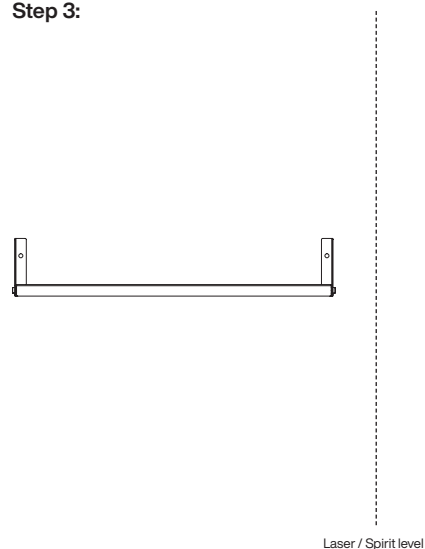

SHLF Mount Inspiration

